

LISTA DE APLICACIONES - BUYERS GUIDE

151161-117



8 424073 081223

Qty: 660

Weight: 4.170

O.E.M.	MAKE
190 6416	IVECO

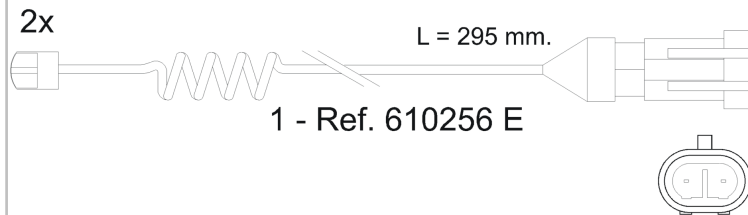
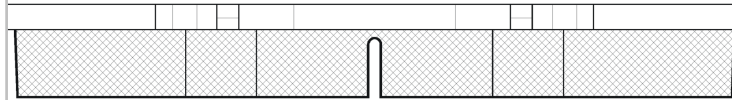
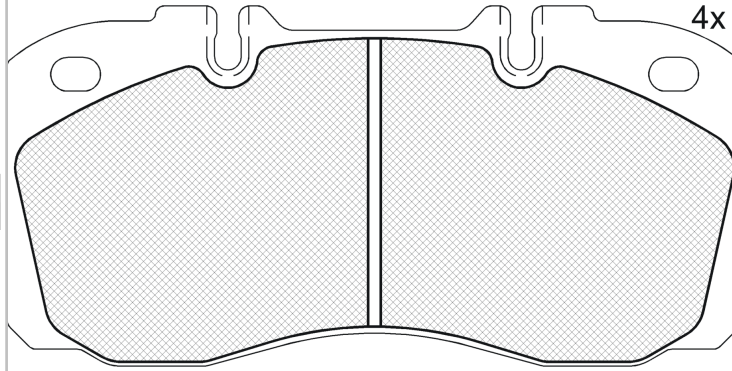

151161-117



90R-01179/689



Brembo 2x60

174.7x85.4x22

WVA	MAKE
29122	IVECO



Trac.	CC	Kw	CV
-------	----	----	----



Front / Rear

IVECO

10.00-07.07

Municipal Vehicle

75 E 15 tector (F4AE0481C)	Diesel		3922	110	149	09.00-07.07	■
120 E 22 tector (F4AE3681B)	Diesel		5883	160	218	09.06-07.07	■
100 E 25 W tector (F4AE3681D)	Diesel		5883	185	251	05.06-07.07	■

DAILY IV 05.06-08.11

Dump Truck (Volquete-N2 Segment)

60C15 (F1CE0481F)	Diesel	RWD	2998	107	146	05.06-08.11	■
60C18 (F1CE0481H)	Diesel	RWD	2998	130	176	05.06-08.11	■

DAILY IV 05.06-03.12

Platform/Chassis (LCVs-N1 Segment)

60C15, 60C15 /P, 60C15 D, 60C15 D/P (F1CE0481F)	Diesel	RWD	2998	107	146	05.06-08.11	■
65C15, 65C15 /P, 65C15 D, 65C15 D/P (F1CE0481F)	Diesel	RWD	2998	107	146	05.06-08.11	■
60C18 (F1CE0481H)	Diesel	RWD	2998	130	176	05.06-08.11	■
65C18 (F1CE0481H)	Diesel	RWD	2998	130	176	05.06-08.11	■

DAILY IV 05.06-03.12

Van (LCVs-N1 Segment)

60C15 V (F1CE0481F)	Diesel	RWD	2998	107	146	05.06-08.11	■
65C15 (F1CE0481F)	Diesel	RWD	2998	107	146	05.06-08.11	■
60C18 (F1CE0481H)	Diesel	RWD	2998	130	176	05.06-08.11	■
65C18 (F1CE0481H)	Diesel	RWD	2998	130	176	05.06-08.11	■

EuroCargo I-III 01.91-09.15

Dump Truck

65 E 12 K (8040.25X.4000)	01/97-	Diesel		3908	85	116	01.91-09.15	■	■
75 E 12 K (8040.25X.4000)		Diesel		3908	85	116	01.91-09.15	■	■
65 E 14 K (8040.45.4000)	01/97-	Diesel		3908	100	136	01.91-09.15	■	■

LISTA DE APLICACIONES - BUYERS GUIDE

75 E 14 K (8040.45.4000)	-12/07	Diesel		3908	100	136	01.91-09.15	■	■
75 E 14 K (8040.45.4180)	-12/07	Diesel		3908	100	136	01.91-09.15	■	■
60 E 13 K tector (F4AE0481D)		Diesel		3922	95	130	09.00-09.15	■	
65 E 13 K tector (F4AE0481D)	01/06-	Diesel		3922	95	130	09.00-09.15	■	
75 E 13 K tector (F4AE0481D)		Diesel		3922	95	130	09.00-09.15	■	
60 E 14 K tector (F4AE3481C)		Diesel		3922	103	140	09.06-09.15	■	
65 E 14 K tector (F4AE3481C)		Diesel		3922	103	140	09.06-09.15	■	
75 E 14 K tector (F4AE3481C)	-12/07	Diesel		3922	103	140	09.06-09.15	■	■
60 E 15 K tector (F4AE0481C)		Diesel		3922	110	149	09.00-09.15	■	
65 E 15 K tector (F4AE0481C)		Diesel		3922	110	149	09.00-09.15	■	■
75 E 15 K tector (F4AE0481C)		Diesel		3922	110	149	09.00-09.15	■	■
60 E 16 K tector (F4AE3481D)		Diesel		3922	118	160	09.06-09.15	■	
65 E 16 K tector (F4AE3481D)		Diesel		3922	118	160	09.06-09.15	■	
75 E 16 K tector (F4AE3481D)	-12/07	Diesel		3922	118	160	09.06-09.15	■	■
100 E 17 K tector, 100 E 17 DK tector (F4AE0481A)		Diesel		3922	125	170	09.00-09.15	■	
75 E 17 K, 75 E 18 K tector (F4AE0481A)		Diesel		3922	125	170	09.00-09.15	■	■
75 E 17 K, 75 E 18 K tector (F4AE3481B)		Diesel		3922	125	170	09.00-09.15	■	■
80 E 17 K, 80 E 17 DK tector, 80 E 18 K tector (F4AE0481A)	-12/08	Diesel		3922	125	170	09.00-09.15	■	■
80 E 17 K, 80 E 17 DK tector, 80 E 18 K tector (F4AE3481B)	-12/08	Diesel		3922	125	170	09.00-09.15	■	■
80 E 18 K tector (F4AE3481B)		Diesel		3922	130	177	09.06-09.15	■	■
120 E 18 K tector, 120 E 18 DK tector (F4AE3481A)		Diesel		3922	134	182	09.06-09.15	■	
75 E 15 K (8060.25R.4200 LTC)	01/97-	Diesel		5861	105	143	01.91-09.15	■	■
100 E 18 K tector, 100 E 18 DK tector (F4AE0681E)		Diesel		5883	134	181	09.00-09.15	■	
120 E 18 K tector, 120 E 18 DK tector (F4AE0681E)		Diesel		5883	134	181	09.00-09.15	■	■
75 E 18 K tector (F4AE0681E)	-12/07	Diesel		5883	134	181	09.00-09.15	■	■
80 E 18 K tector, 80 E 18 DK tector (F4AE0681E)	01/06-	Diesel		5883	134	181	09.00-09.15	■	■
90 E 18 K tector, 90 E 18 DK tector (F4AE0681E)		Diesel		5883	134	181	09.00-09.15	■	
100 E 21 K tector, 100 E 21 DK tector (F4AE0681D)		Diesel		5883	154	209	09.00-09.15	■	
120 E 21 K tector (F4AE0681D)		Diesel		5883	154	209	09.00-09.15	■	
80 E 21 K, 80 E 21 DK tector, 80 E 22 K tector (F4AE0681D)		Diesel		5883	154	209	09.00-09.15	■	
80 E 21 K, 80 E 21 DK tector, 80 E 22 K tector (F4AE3681B)		Diesel		5883	154	209	09.00-09.15	■	
90 E 21 K tector, 90 E 21 DK tector (F4AE0681D)		Diesel		5883	154	209	09.00-09.15	■	
100 E 22 K tector (F4AE3681B)		Diesel		5883	160	218	09.06-09.15	■	
100 E 22 tector, 100 E 22 P tector, 100 E 22 FP tector (F4AE3681B)		Diesel		5883	160	218	09.06-09.15	■	■
120 E 22 K tector (F4AE3681B)		Diesel		5883	160	218	09.06-09.15	■	
90 E 22 K tector (F4AE3681B)		Diesel		5883	160	218	09.06-09.15	■	
120 E 24 K tector, 120 E 24 DK tector (F4AE0681B)		Diesel		5883	176	240	09.00-09.15	■	■
120 E 25 K tector, 120 E 25 DK tector (F4AE3681D)		Diesel		5883	185	252	09.06-09.15	■	
120 E 28 K tector (F4AE0681A)		Diesel		5883	202	275	09.00-09.15	■	■
120 E 28 K tector (F4AE3681E)		Diesel		5883	202	275	09.00-09.15	■	■
EuroCargo I-III 01.91-09.15					Platform/Chassis				
65 E 12, 65 E 12 P (8040.25X.4000)	01/97-	Diesel		3908	85	116	01.91-09.15	■	■
75 E 12, 75 E 12 P (8040.25X.4000)	01/97-	Diesel		3908	85	116	01.91-09.15	■	■
65 E 14, 65 E 14 P (8040.45.4000)	01/97-	Diesel		3908	100	136	01.91-09.15	■	■

LISTA DE APLICACIONES - BUYERS GUIDE

75 E 14, 75 E 14 P (8040.45.4000)	01/97-	Diesel		3908	100	136	01.91-09.15	■	■
75 E 14, 75 E 14 P (8040.45.4180)	01/97-	Diesel		3908	100	136	01.91-09.15	■	■
60 E 13 tector, 60 E 13 P tector (F4AE0481D)		Diesel		3922	95	130	09.00-09.15	■	
65 E 13 tector (F4AE0481D)		Diesel		3922	95	130	09.00-09.15	■	■
75 E 13 tector, 75 E 13 P tector (F4AE0481D)		Diesel		3922	95	130	09.00-09.15	■	■
60 E 14 tector, 60 E 14 P tector (F4AE3481C)		Diesel		3922	103	140	09.06-09.15	■	
65 E 14 tector, 65 E 14 P tector (F4AE3481C)		Diesel		3922	103	140	09.06-09.15	■	
75 E 14 tector, 75 E 14 P tector (F4AE3481C)	-12/07	Diesel		3922	103	140	09.06-09.15	■	■
60 E 15 tector, 60 E 15 P tector (F4AE0481C)		Diesel		3922	110	149	09.00-09.15	■	
65 E 15 tector, 65 E 15 P tector (F4AE0481C)		Diesel		3922	110	149	09.00-09.15	■	■
75 E 15 tector, 75 E 15 P tector (F4AE0481C)		Diesel		3922	110	149	09.00-09.15	■	■
80 EL 15 tector (F4AE0481C)		Diesel		3922	110	149	09.00-09.15	■	
60 E 16 tector, 60 E 16 P tector (F4AE3481D)		Diesel		3922	118	160	09.06-09.15	■	
65 E 16 tector, 65 E 16 P tector (F4AE3481D)		Diesel		3922	118	160	09.06-09.15	■	
75 E 16 tector, 75 E 16 P tector (F4AE3481D)	-12/07	Diesel		3922	118	160	09.06-09.15	■	■
100 E 17, 100 E 17 DP tector, 100 E 18 tector (F4AE0481A)		Diesel		3922	125	170	09.00-09.15	■	
100 E 17, 100 E 17 DP tector, 100 E 18 tector (F4AE3481B)		Diesel		3922	125	170	09.00-09.15	■	
75 E 17, 75 E 17 P, 75 E 18 tector (F4AE0481A)		Diesel		3922	125	170	09.00-09.15	■	■
75 E 17, 75 E 17 P, 75 E 18 tector (F4AE3481B)		Diesel		3922	125	170	09.00-09.15	■	■
80 E 17, 80 E 17 D tector, 80 E 17 DP tector, 80 E 18 tector (F4AE0481A)	-12/08	Diesel		3922	125	170	09.00-09.15	■	■
80 E 17, 80 E 17 D tector, 80 E 17 DP tector, 80 E 18 tector (F4AE3481B)	-12/08	Diesel		3922	125	170	09.00-09.15	■	■
80 EL 17 tector, 80 EL 17 P tector (F4AE0481A)		Diesel		3922	125	170	09.00-09.15	■	
80 E 18 tector, 80 E 18 P tector, 80 E 18 FP tector (F4AE3481B)	-12/07	Diesel		3922	130	177	09.06-09.15	■	■
80 EL 18 tector, 80 EL 18 P tector (F4AE3481B)		Diesel		3922	130	177	09.06-09.15	■	
110 E 18 tector, 110 E 18 P tector, 110 EL 18 P tector (F4AE3481A)		Diesel		3922	134	182	09.06-09.15	■	
75 E 15, 75 E 15 P, 80 E 15 (8060.25R.4200 LTC)	01/97-	Diesel		5861	105	143	01.91-09.15	■	■
95 E 15 W (8060.25R.4750)	01/97-	Diesel		5861	105	143	01.91-09.15	■	■
95 E 15 W (8060.25R.4755)	01/97-	Diesel		5861	105	143	01.91-09.15	■	■
95 E 15 W (8060.25R.4760)	01/97-	Diesel		5861	105	143	01.91-09.15	■	■
95 E 15 W (8060.25R.4764)	01/97-	Diesel		5861	105	143	01.91-09.15	■	■
95 E 15 W (8060.45R.5050)	01/97-	Diesel		5861	105	143	01.91-09.15	■	■
95 E 15 W (8060.45R.5051)	01/97-	Diesel		5861	105	143	01.91-09.15	■	■
120 E 21 H (8060.45B.5100)		Diesel		5861	152	207	01.92-09.15	■	
95 E 21 W (8060.45.4700)	01/97-	Diesel		5861	152	207	01.91-09.15	■	■
95 E 21 W (8060.45.4702)	01/97-	Diesel		5861	152	207	01.91-09.15	■	■
95 E 21 W (8060.45.4704)	01/97-	Diesel		5861	152	207	01.91-09.15	■	■
95 E 21 W (8060.45.4706)	01/97-	Diesel		5861	152	207	01.91-09.15	■	■
95 E 21 W (8060.45.4708)	01/97-	Diesel		5861	152	207	01.91-09.15	■	■
95 E 21 W (8060.45.5250)	01/97-	Diesel		5861	152	207	01.91-09.15	■	■
95 E 21 W (8060.45.5251)	01/97-	Diesel		5861	152	207	01.91-09.15	■	■
95 E 21 W (8060.45.5255)	01/97-	Diesel		5861	152	207	01.91-09.15	■	■
90 E 18 tector, 90 E 18 D tector, 90 E 18 DP tector (F4AE0681E)		Diesel		5883	130	177	09.00-09.15	■	
100 E 18 tector, 100 E 18 P tector, 100 E 18 FP tector (F4AE0681D)		Diesel		5883	134	181	09.00-09.15	■	
100 E 18 tector, 100 E 18 P tector, 100 E 18 FP tector (F4AE0681E)		Diesel		5883	134	181	09.00-09.15	■	
100 E 18 W tector, 100 E 18 WS tector (F4AE0681E)		Diesel		5883	134	181	09.00-09.15	■	

LISTA DE APLICACIONES - BUYERS GUIDE

100 E 18 W tector, 100 E 18 WS tector (F4AE3681C)	Diesel		5883	134	181	09.00-09.15	■	
120 E 18 tector, 120 E 18 D tector, 120 E 18 DP tector (F4AE0681D)	Diesel		5883	134	181	09.00-09.15	■	■
120 E 18 tector, 120 E 18 D tector, 120 E 18 DP tector (F4AE0681E)	Diesel		5883	134	181	09.00-09.15	■	■
75 E 18 tector, 75 E 18 P tector (F4AE0681D)	-12/07 Diesel		5883	134	181	09.00-09.15	■	■
75 E 18 tector, 75 E 18 P tector (F4AE0681E)	-12/07 Diesel		5883	134	181	09.00-09.15	■	■
80 E 18 tector, 80 E 18 D tector, 80 E 18 DP tector (F4AE0681D)	01/06- Diesel		5883	134	181	09.00-09.15	■	■
80 E 18 tector, 80 E 18 D tector, 80 E 18 DP tector (F4AE0681E)	01/06- Diesel		5883	134	181	09.00-09.15	■	■
100 E 21, 100 E 21 DP tector, 100 E 22 tector (F4AE0681D)	Diesel		5883	154	209	09.00-09.15	■	■
100 E 21, 100 E 21 DP tector, 100 E 22 tector (F4AE3681B)	Diesel		5883	154	209	09.00-09.15	■	■
100 E 21 W tector, 100 E 21 WS tector (F4AE0681D)	Diesel		5883	154	209	09.00-09.15	■	
120 E 21 tector, 120 E 21 P tector, 120 E 21 FP tector (F4AE0681C)	Diesel		5883	154	209	09.00-09.15	■	
120 E 21 tector, 120 E 21 P tector, 120 E 21 FP tector (F4AE0681D)	Diesel		5883	154	209	09.00-09.15	■	
120 E 21 tector, 120 E 21 P tector, 120 E 21 FP tector (F4AE3681B)	Diesel		5883	154	209	09.00-09.15	■	
80 E 21, 80 E 21 D tector, 80 E 21 DP tector, 80 E 22 tector (F4AE0681D)	Diesel		5883	154	209	09.00-09.15	■	
80 E 21, 80 E 21 D tector, 80 E 21 DP tector, 80 E 22 tector (F4AE3681B)	Diesel		5883	154	209	09.00-09.15	■	
90 E 21, 90 E 21 D tector, 90 E 21 DP tector, 90 E 22 tector (F4AE0681D)	Diesel		5883	154	209	09.00-09.15	■	
90 E 21, 90 E 21 D tector, 90 E 21 DP tector, 90 E 22 tector (F4AE3681B)	Diesel		5883	154	209	09.00-09.15	■	
100 E 22 W tector, 100 E 22 WS tector (F4AE3681B)	Diesel		5883	160	218	09.06-09.15	■	■
110 E 22 tector, 110 E 22 P tector, 110 EL 22 P tector (F4AE3681B)	Diesel		5883	160	217	09.06-09.15	■	
110 E 22 WS tector (F4AE3681B)	Diesel		5883	160	217	05.06-09.15	■	
110 E 22 W tector (F4AE3681B)	Diesel		5883	160	217	05.06-09.15	■	
120 E 22 D tector, 120 E 22 P tector, 120 E 22 FP tector (F4AE3681B)	Diesel		5883	160	218	09.06-09.15	■	
80 E 22 tector, 80 E 22 P tector, 80 E 22FP tector (F4AE3681B)	Diesel		5883	160	218	09.06-09.15	■	
120 E 24, 120 E 24 DP tector, 120 E 25 FP tector (F4AE0681B)	Diesel		5883	176	240	09.00-09.15	■	■
120 E 24, 120 E 24 DP tector, 120 E 25 FP tector (F4AE3681D)	Diesel		5883	176	240	09.00-09.15	■	■
110 E 25 WS tector (F4AE3681D)	Diesel		5883	185	251	05.06-09.15	■	
110 E 25 W tector (F4AE3681D)	Diesel		5883	185	251	05.06-09.15	■	
120 E 28 tector, 120 E 28 P tector, 120 E 28 FP tector (F4AE0681A)	Diesel		5883	202	275	09.00-09.15	■	■
120 E 28 tector, 120 E 28 P tector, 120 E 28 FP tector (F4AE3681E)	Diesel		5883	202	275	09.00-09.15	■	■
EuroCargo I-III 01.91-09.15				Platform/Chassis				
120 E 20 CNG, 120 E 20 P CNG (F4BE0611A)	Gasolina		5883	147	200	09.06-09.15	■	
EuroFire 01.91-				Municipal Vehicle				
75 E 14 (8040.45)	Diesel		3908	100	136	01.91-09.00	■	