

LISTA DE APLICACIONES - BUYERS GUIDE

151640-229



Qty: 944

Weight: 1.873

O.E.M.	MAKE
1 501 265	FORD
1 718 023	FORD
8C1V-2M008-AA	FORD
8C1V-2M008-AB	FORD

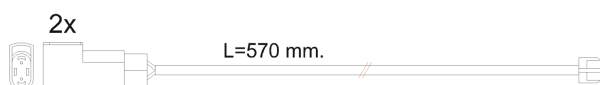
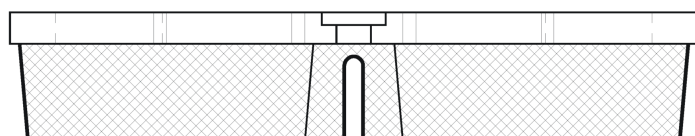
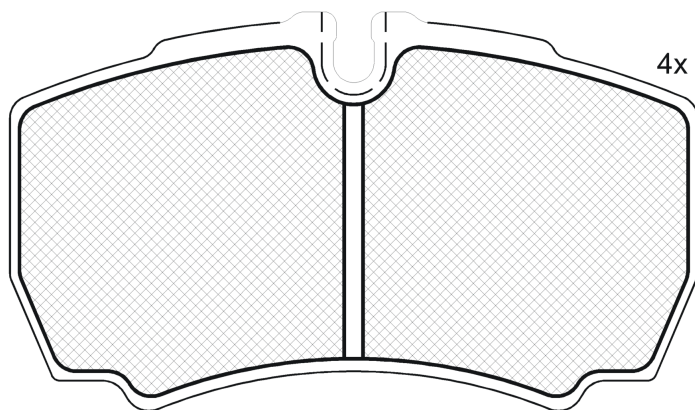

1-Ref. 610463 E

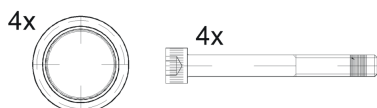

2 - Ref. 690142 E

151640-229



90R-01110/496

Brembo



109.6x63.6x20.3

WVA

29123

MAKE

FORD



Trac.	CC	Kw	CV
-------	----	----	----



Front / Rear

FORD

TRANSIT V (FD_, FB_, FS_, FZ_, FC_) 04.06-

Bus (Minibus-M2-Segment)

Engine	Model	Fuel	Drive	CC	Kw	CV	Period	Front	Rear
2.2 TDCi (P8FA)	Type 460, disc brak.rear axle	Diesel	FWD	2198	63	85	04.06-08.14	■	■
2.2 TDCi (P8FB)	Type 460, disc brak.rear axle	Diesel	FWD	2198	63	85	04.06-08.14	■	■
2.2 TDCi RWD (DRRA)	Type 460	Diesel	RWD	2198	74	100	10.11-08.14	■	■
2.2 TDCi RWD (DRRB)	Type 460	Diesel	RWD	2198	74	100	10.11-08.14	■	■
2.2 TDCi RWD (DRRC)	Type 460	Diesel	RWD	2198	74	100	10.11-08.14	■	■
2.2 TDCi (QVFA)	Type 460, disc brak.rear axle	Diesel	FWD	2198	81	110	04.06-08.14	■	■
2.2 TDCi (SRFA)	Type 460, disc brak.rear axle	Diesel	FWD	2198	85	115	10.08-08.14	■	■
2.2 TDCi (SRFB)	Type 460, disc brak.rear axle	Diesel	FWD	2198	85	115	10.08-08.14	■	■
2.2 TDCi (SRFC)	Type 460, disc brak.rear axle	Diesel	FWD	2198	85	115	10.08-08.14	■	■
2.2 TDCi (SRFD)	Type 460, disc brak.rear axle	Diesel	FWD	2198	85	115	10.08-08.14	■	■
2.2 TDCi (SRFE)	Type 460, disc brak.rear axle	Diesel	FWD	2198	85	115	10.08-08.14	■	■
2.2 TDCi RWD (CYRA)	Type 460	Diesel	RWD	2198	92	125	09.11-12.14	■	■
2.2 TDCi (QWFA)	Type 460, disc brak.rear axle	Diesel	FWD	2198	96	130	04.06-08.14	■	■
2.2 TDCi RWD (USRA)	Type 460	Diesel	RWD	2198	100	135	09.11-08.14	■	■
2.2 TDCi RWD (USRB)	Type 460	Diesel	RWD	2198	100	135	09.11-08.14	■	■
2.2 TDCi (PGFA)	Type 460, disc brak.rear axle	Diesel	FWD	2198	103	140	10.07-08.14	■	■
2.2 TDCi (PGFB)	Type 460, disc brak.rear axle	Diesel	FWD	2198	103	140	10.07-08.14	■	■
2.2 TDCi (UHFA)	Type 460, disc brak.rear axle	Diesel	FWD	2198	103	140	10.07-08.14	■	■
2.2 TDCi (UHFB)	Type 460, disc brak.rear axle	Diesel	FWD	2198	103	140	10.07-08.14	■	■
2.2 TDCi (UHFC)	Type 460, disc brak.rear axle	Diesel	FWD	2198	103	140	10.07-08.14	■	■
2.4 TDCi (PHFA)	Type 460	Diesel	RWD	2402	74	100	04.06-08.14	■	■
2.4 TDCi (PHFC)	Type 460	Diesel	RWD	2402	74	100	04.06-08.14	■	■
2.4 TDCi (JXFA)	Type 460	Diesel	RWD	2402	85	115	04.06-08.14	■	■

LISTA DE APLICACIONES - BUYERS GUIDE

2.4 TDCi (JXFC)	Type 460	Diesel	RWD	2402	85	115	04.06-08.14	■
2.4 TDCi (H9FD)	Type 460	Diesel	RWD	2402	103	140	04.06-08.14	■
2.4 TDCi 4x4 (H9FB)	Type 460	Diesel	4WD	2402	103	140	11.06-08.14	■
3.2 TDCi (SAFA)	Type 460	Diesel	RWD	3199	147	200	02.08-08.14	■
3.2 TDCi (SAFB)	Type 460	Diesel	RWD	3199	147	200	02.08-08.14	■
TRANSIT V (FM_ , FN_ , FF_) 04.06-12.14					Platform/Chassis (LCVs-N1 Segment)			
2.3 16V RWD (GZFA)		Gasolina	RWD	2261	107	145	04.06-08.14	■
2.3 16V RWD (GZFB)		Gasolina	RWD	2261	107	145	04.06-08.14	■
2.3 16V RWD (GZFC)		Gasolina	RWD	2261	107	145	04.06-08.14	■
2.3 16V LPG RWD (GZFC)		Gasol./Gas (LPG)	RWD	2261	107	145	04.06-08.14	■
2.3 16V CNG RWD (GZFC)		Gasol./Gas (CNG)	RWD	2261	100	136	04.06-08.14	■
2.2 TDCi (P8FA)	Type 460, disc brak.rear axle	Diesel	FWD	2198	63	85	04.06-08.14	■
2.2 TDCi (P8FB)	Type 460, disc brak.rear axle	Diesel	FWD	2198	63	85	04.06-08.14	■
2.2 TDCi (DRFA)	Type 460, disc brak.rear axle	Diesel	FWD	2198	74	100	10.11-08.14	■
2.2 TDCi (DRFB)	Type 460, disc brak.rear axle	Diesel	FWD	2198	74	100	10.11-08.14	■
2.2 TDCi (DRFC)	Type 460, disc brak.rear axle	Diesel	FWD	2198	74	100	10.11-08.14	■
2.2 TDCi (DRFD)	Type 460, disc brak.rear axle	Diesel	FWD	2198	74	100	10.11-08.14	■
2.2 TDCi (DRFE)	Type 460, disc brak.rear axle	Diesel	FWD	2198	74	100	10.11-08.14	■
2.2 TDCi RWD (DRRA)	Type 460	Diesel	RWD	2198	74	100	10.11-08.14	■
2.2 TDCi RWD (DRRB)	Type 460	Diesel	RWD	2198	74	100	10.11-08.14	■
2.2 TDCi RWD (DRRC)	Type 460	Diesel	RWD	2198	74	100	10.11-08.14	■
2.2 TDCi (QVFA)	Type 460, disc brak.rear axle	Diesel	FWD	2198	81	110	04.06-08.14	■
2.2 TDCi (SRFA)	Type 460, disc brak.rear axle	Diesel	FWD	2198	85	115	10.08-08.14	■
2.2 TDCi (SRFB)	Type 460, disc brak.rear axle	Diesel	FWD	2198	85	115	10.08-08.14	■
2.2 TDCi (SRFC)	Type 460, disc brak.rear axle	Diesel	FWD	2198	85	115	10.08-08.14	■
2.2 TDCi (SRFD)	Type 460, disc brak.rear axle	Diesel	FWD	2198	85	115	10.08-08.14	■
2.2 TDCi (SRFE)	Type 460, disc brak.rear axle	Diesel	FWD	2198	85	115	10.08-08.14	■
2.2 TDCi (CYFA)	Type 460, disc brak.rear axle	Diesel	FWD	2198	92	125	10.11-08.14	■
2.2 TDCi (CYFB)	Type 460, disc brak.rear axle	Diesel	FWD	2198	92	125	10.11-08.14	■
2.2 TDCi (CYFC)	Type 460, disc brak.rear axle	Diesel	FWD	2198	92	125	10.11-08.14	■
2.2 TDCi (CYFD)	Type 460, disc brak.rear axle	Diesel	FWD	2198	92	125	10.11-08.14	■
2.2 TDCi 4x4 (CYRB)	Type 460	Diesel	4WD	2198	92	125	10.11-08.14	■
2.2 TDCi 4x4 (CYRC)	Type 460	Diesel	4WD	2198	92	125	10.11-08.14	■
2.2 TDCi RWD (CYRA)	Type 460, disc brak.rear axle	Diesel	RWD	2198	92	125	10.11-08.14	■
2.2 TDCi (QWFA)	Type 460, disc brak.rear axle	Diesel	FWD	2198	96	130	04.06-08.14	■
2.2 TDCi (PGFA)	Type 460, disc brak.rear axle	Diesel	FWD	2198	103	140	10.07-09.11	■
2.2 TDCi (PGFB)	Type 460, disc brak.rear axle	Diesel	FWD	2198	103	140	10.07-09.11	■
2.2 TDCi (UHFA)	Type 460, disc brak.rear axle	Diesel	FWD	2198	103	140	10.07-09.11	■
2.2 TDCi (UHFB)	Type 460, disc brak.rear axle	Diesel	FWD	2198	103	140	10.07-09.11	■
2.2 TDCi (UHFC)	Type 460, disc brak.rear axle	Diesel	FWD	2198	103	140	10.07-09.11	■
2.2 TDCi RWD (CVRA)	Type 460, disc brak.rear axle	Diesel	RWD	2198	114	155	10.11-08.14	■
2.2 TDCi RWD (CVRB)	Type 460, disc brak.rear axle	Diesel	RWD	2198	114	155	10.11-08.14	■
2.2 TDCi RWD (CVRC)	Type 460, disc brak.rear axle	Diesel	RWD	2198	114	155	10.11-08.14	■
2.4 TDCi RWD (PHFA)	Type 460	Diesel	RWD	2402	74	100	04.06-08.14	■
2.4 TDCi RWD (PHFC)	Type 460	Diesel	RWD	2402	74	100	04.06-08.14	■
2.4 TDCi RWD (JXFA)	Type 460	Diesel	RWD	2402	85	115	04.06-08.14	■
2.4 TDCi RWD (JXFC)	Type 460	Diesel	RWD	2402	85	115	04.06-08.14	■
2.4 TDCi 4x4 (H9FB)	Type 460	Diesel	4WD	2402	103	140	11.06-08.14	■
2.4 TDCi RWD (H9FD)	Type 460	Diesel	RWD	2402	103	140	04.06-08.14	■

LISTA DE APLICACIONES - BUYERS GUIDE

3.2 TDCi RWD (SAFA)	Type 460	Diesel	RWD	3199	147	200	09.07-08.14	■
3.2 TDCi RWD (SAFB)	Type 460	Diesel	RWD	3199	147	200	09.07-08.14	■
TRANSIT V (FA_) 04.06-					Van (LCVs-N1 Segment)			
2.3 16V RWD (GZFA)		Gasolina	RWD	2261	107	145	04.06-08.14	■
2.3 16V RWD (GZFB)		Gasolina	RWD	2261	107	145	04.06-08.14	■
2.3 16V RWD (GZFC)		Gasolina	RWD	2261	107	145	04.06-08.14	■
2.3 16V LPG RWD (GZFC)		Gasol./Gas (LPG)	RWD	2261	107	145	04.06-08.14	■
2.3 16V CNG RWD (GZFC)		Gasol./Gas (CNG)	RWD	2261	100	136	04.06-08.14	■
2.2 TDCi (P8FA)	Type 460, disc brak.rear axle	Diesel	FWD	2198	63	85	04.06-08.14	■
2.2 TDCi (P8FB)	Type 460, disc brak.rear axle	Diesel	FWD	2198	63	85	04.06-08.14	■
2.2 TDCi (DRFA)	Type 460	Diesel	FWD	2198	74	100	10.11-08.14	■
2.2 TDCi (DRFB)	Type 460	Diesel	FWD	2198	74	100	10.11-08.14	■
2.2 TDCi (DRFC)	Type 460	Diesel	FWD	2198	74	100	10.11-08.14	■
2.2 TDCi (DRFD)	Type 460	Diesel	FWD	2198	74	100	10.11-08.14	■
2.2 TDCi (DRFE)	Type 460	Diesel	FWD	2198	74	100	10.11-08.14	■
2.2 TDCi RWD (DRRA)	Type 460	Diesel	RWD	2198	74	100	10.11-08.14	■
2.2 TDCi RWD (DRRB)	Type 460	Diesel	RWD	2198	74	100	10.11-08.14	■
2.2 TDCi RWD (DRRC)	Type 460	Diesel	RWD	2198	74	100	10.11-08.14	■
2.2 TDCi (QVFA)	Type 460, disc brak.rear axle	Diesel	FWD	2198	81	110	04.06-08.14	■
2.2 TDCi (SRFA)	Type 460, disc brak.rear axle	Diesel	FWD	2198	85	115	10.08-08.14	■
2.2 TDCi (SRFB)	Type 460, disc brak.rear axle	Diesel	FWD	2198	85	115	10.08-08.14	■
2.2 TDCi (SRFC)	Type 460, disc brak.rear axle	Diesel	FWD	2198	85	115	10.08-08.14	■
2.2 TDCi (SRFD)	Type 460, disc brak.rear axle	Diesel	FWD	2198	85	115	10.08-08.14	■
2.2 TDCi (SRFE)	Type 460, disc brak.rear axle	Diesel	FWD	2198	85	115	10.08-08.14	■
2.2 TDCi (CYFA)	Type 460, disc brak.rear axle	Diesel	FWD	2198	92	125	10.11-08.14	■
2.2 TDCi (CYFB)	Type 460, disc brak.rear axle	Diesel	FWD	2198	92	125	10.11-08.14	■
2.2 TDCi (CYFC)	Type 460, disc brak.rear axle	Diesel	FWD	2198	92	125	10.11-08.14	■
2.2 TDCi (CYFD)	Type 460, disc brak.rear axle	Diesel	FWD	2198	92	125	10.11-08.14	■
2.2 TDCi 4x4 (CYRB)	Type 460	Diesel	4WD	2198	92	125	10.11-08.14	■
2.2 TDCi 4x4 (CYRC)	Type 460	Diesel	4WD	2198	92	125	10.11-08.14	■
2.2 TDCi RWD (CYRA)	Type 460	Diesel	RWD	2198	92	125	09.11-12.14	■
2.2 TDCi (QWFA)	Type 460, disc brak.rear axle	Diesel	FWD	2198	96	130	04.06-08.14	■
2.2 TDCi RWD (USRA)		Diesel	RWD	2198	100	136	10.11-08.14	■
2.2 TDCi RWD (USRB)		Diesel	RWD	2198	100	136	10.11-08.14	■
2.2 TDCi (PGFA)	Type 460, disc brak.rear axle	Diesel	FWD	2198	103	140	10.07-08.14	■
2.2 TDCi (PGFB)	Type 460, disc brak.rear axle	Diesel	FWD	2198	103	140	10.07-08.14	■
2.2 TDCi (UHFA)	Type 460, disc brak.rear axle	Diesel	FWD	2198	103	140	10.07-08.14	■
2.2 TDCi (UHFB)	Type 460, disc brak.rear axle	Diesel	FWD	2198	103	140	10.07-08.14	■
2.2 TDCi (UHFC)	Type 460, disc brak.rear axle	Diesel	FWD	2198	103	140	10.07-08.14	■
2.2 TDCi RWD (CVRA)	Type 460	Diesel	RWD	2198	114	155	10.11-08.14	■
2.2 TDCi RWD (CVRB)	Type 460	Diesel	RWD	2198	114	155	10.11-08.14	■
2.2 TDCi RWD (CVRC)	Type 460	Diesel	RWD	2198	114	155	10.11-08.14	■
2.4 TDCi RWD (PHFA)	Type 460	Diesel	RWD	2402	74	100	04.06-08.14	■
2.4 TDCi RWD (PHFC)	Type 460	Diesel	RWD	2402	74	100	04.06-08.14	■
2.4 TDCi RWD (JXFA)	Type 460	Diesel	RWD	2402	85	115	04.06-08.14	■
2.4 TDCi RWD (JXFC)	Type 460	Diesel	RWD	2402	85	115	04.06-08.14	■
2.4 TDCi 4x4 (H9FB)	Type 460	Diesel	4WD	2402	103	140	11.06-08.14	■
2.4 TDCi RWD (H9FB)	Type 460	Diesel	RWD	2402	103	140	04.06-08.14	■
2.4 TDCi RWD (H9FD)	Type 460	Diesel	RWD	2402	103	140	04.06-08.14	■
3.2 TDCi RWD (SAFA)	Type 460	Diesel	RWD	3199	147	200	09.07-08.14	■

LISTA DE APLICACIONES - BUYERS GUIDE

3.2 TDCi RWD (SAFB)	Type 460	Diesel	RWD	3199	147	200	09.07-08.14	■
TRANSIT CONNECT (P65_, P70_, P80_) 06.02-					Box Body/MPV (LCVs-N1 Segment)			
1.8 TDCi (RWPA)		Diesel	FWD	1753	81	110	08.06-12.13	■
1.8 TDCi (RWPB)		Diesel	FWD	1753	81	110	08.06-12.13	■
1.8 TDCi (RWPC)		Diesel	FWD	1753	81	110	08.06-12.13	■
1.8 TDCi (RWPD)		Diesel	FWD	1753	81	110	08.06-12.13	■
TRANSIT TOURNEO III 07.06-08.14					Bus (Minibus-M2-Segment)			
2.2 TDCi (QVFA)	Type 460, disc brak.rear axle	Diesel	FWD	2198	81	110	07.06-08.14	■
2.2 TDCi (SRFA)	Type 460, disc brak.rear axle	Diesel	FWD	2198	85	115	10.08-08.14	■
2.2 TDCi (SRFB)	Type 460, disc brak.rear axle	Diesel	FWD	2198	85	115	10.08-08.14	■
2.2 TDCi (SRFC)	Type 460, disc brak.rear axle	Diesel	FWD	2198	85	115	10.08-08.14	■
2.2 TDCi (SRFD)	Type 460, disc brak.rear axle	Diesel	FWD	2198	85	115	10.08-08.14	■
2.2 TDCi (SRFE)	Type 460, disc brak.rear axle	Diesel	FWD	2198	85	115	10.08-08.14	■
2.2 TDCi (QWFA)	Type 460, disc brak.rear axle	Diesel	FWD	2198	96	131	07.06-08.14	■
2.2 TDCi (PGFA)	Type 460, disc brak.rear axle	Diesel	FWD	2198	103	140	10.07-08.14	■
2.2 TDCi (PGFB)	Type 460, disc brak.rear axle	Diesel	FWD	2198	103	140	10.07-08.14	■
2.2 TDCi (UHFA)	Type 460, disc brak.rear axle	Diesel	FWD	2198	103	140	10.07-08.14	■
2.2 TDCi (UHFB)	Type 460, disc brak.rear axle	Diesel	FWD	2198	103	140	10.07-08.14	■
2.2 TDCi (UHFC)	Type 460, disc brak.rear axle	Diesel	FWD	2198	103	140	10.07-08.14	■