

# LISTA DE APLICACIONES - BUYERS GUIDE

## 151958-117



8 424073 102287

Qty: 660

Weight: 4.970

O.E.M.	MAKE
299 6518 oe	IVECO
299 6520 oe	IVECO
425 592 48 oe	IVECO
425 592 49 oe	IVECO

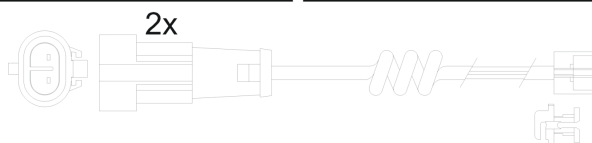
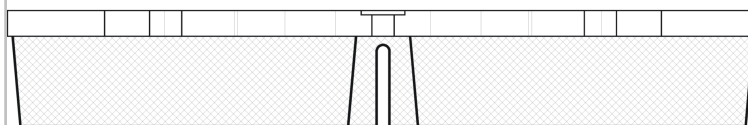
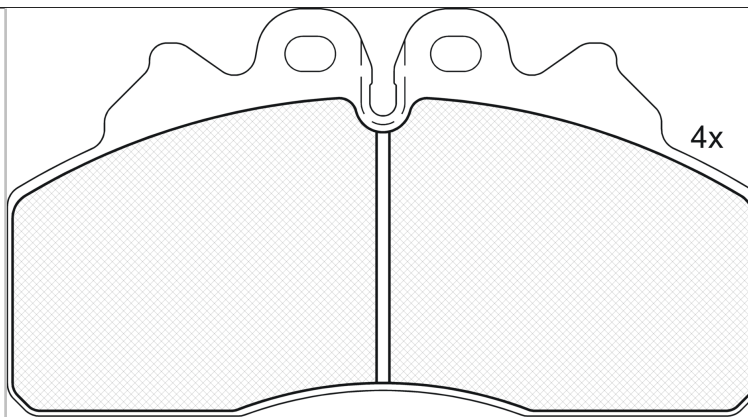

1-Ref. 610471 E

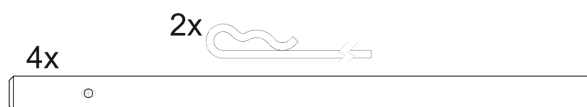

1-Ref. 690236 E

## 151958-117



E 90R-01178/2682

Brembo 2x68

175.45x95.1x27

WVA

29256

MAKE

IVECO



Trac.	CC	Kw	CV
-------	----	----	----



Front / Rear

### IVECO

#### 10.00-07.07

#### Municipal Vehicle

80 E 18 tector (F4AE3481B)	01/08-	Diesel		3922	130	177	09.06-07.07	■	■
----------------------------	--------	--------	--	------	-----	-----	-------------	---	---

#### EuroCargo I-III 01.91-09.15

#### Dump Truck

75 E 14 K tector (F4AE3481C)	01/08-	Diesel		3922	103	140	09.06-09.15	■	■
75 E 16 K tector (F4AE3481D)	01/08-	Diesel		3922	118	160	09.06-09.15	■	■
75 E 18 K tector (F4AE0681E)	01/08-	Diesel		5883	134	181	09.00-09.15	■	■

#### EuroCargo I-III 01.91-09.15

#### Platform/Chassis

75 E 14 tector, 75 E 14 P tector (F4AE3481C)	01/08-	Diesel		3922	103	140	09.06-09.15	■	■
75 E 16 tector, 75 E 16 P tector (F4AE3481D)	01/08-	Diesel		3922	118	160	09.06-09.15	■	■
80 E 18 tector, 80 E 18 P tector, 80 E 18 FP tector (F4AE3481B)	01/08-	Diesel		3922	130	177	09.06-09.15	■	■
75 E 18 tector, 75 E 18 P tector (F4AE0681D)	01/08-	Diesel		5883	134	181	09.00-09.15	■	■
75 E 18 tector, 75 E 18 P tector (F4AE0681E)	01/08-	Diesel		5883	134	181	09.00-09.15	■	■