

LISTA DE APLICACIONES - BUYERS GUIDE

180235-700



8 424073 001085

Qty: 300

Weight: 839

O.E.M.	MAKE
77 01 200 734	RENAULT
77 01 201 159	RENAULT
77 01 201 183	RENAULT
77 01 202 893	RENAULT
86 60 004 598	RENAULT
86 71 016 182	RENAULT

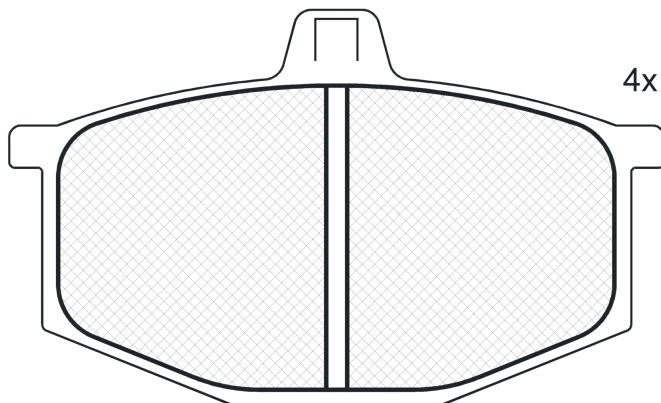

180235-700



Lucas - Girling

93.3x56.4x15.5

WVA

20480

MAKE

RENAULT

180235-700

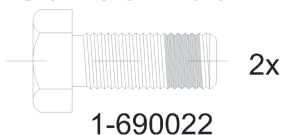

Trac.	CC	Kw	CV	
				Front / Rear

RENAULT

R 4 (R21_, R23_) 09.66-12.93

Box Body/MPV (LCVs-N1 Segment)

1.0 (C1C 708)		Gasolina	FWD	956	25	34	06.87-12.93	■
1.1 (2370, 210B) (688 711)	01/82-	Gasolina	FWD	1108	25	34	10.76-07.89	■
1.1 (2370, 210B) (688 712)	01/82-	Gasolina	FWD	1108	25	34	10.76-07.89	■
1.1 (2370, 210B) (C1E 714)	01/82-	Gasolina	FWD	1108	25	34	10.76-07.89	■
1.1 (2370, 210B) (C1E 718)	01/82-	Gasolina	FWD	1108	25	34	10.76-07.89	■
1.1 (2370, 210B) (C1E 719)	01/82-	Gasolina	FWD	1108	25	34	10.76-07.89	■
1.1 (239B) (C1E 718)		Gasolina	FWD	1108	26	35	07.82-05.89	■
1.1 (239B) (C1E 719)		Gasolina	FWD	1108	26	35	07.82-05.89	■

R 4 (112_) 04.62-12.93

Hatchback (Supermini car-B Segment)

1.0 (112C) (C1C 708)		Gasolina	FWD	956	25	34	06.87-06.93	■
1.0 (689 710)		Gasolina	FWD	956	31	42	12.85-06.93	■
1.1 (1128, S128) (688 712)	01/82-	Gasolina	FWD	1108	25	34	06.78-06.90	■
1.1 (1128, S128) (C1E 714)	01/82-	Gasolina	FWD	1108	25	34	06.78-06.90	■
1.1 (1128, S128) (C1E 719)	01/82-	Gasolina	FWD	1108	25	34	06.78-06.90	■
1.1 (C1E 714)		Gasolina	FWD	1108	32	44	06.86-06.90	■
1.1 (688 712)	01/82-	Gasolina	FWD	1108	33	45	02.78-03.84	■

R 5 (238_) 01.72-12.85

Hatchback Van (LCVs-N1 Segment)

0.8 (2381) (800 710)	01/82-	Gasolina	FWD	845	26	35	10.72-08.84	■
1.0 (2382) (689 710)		Gasolina	FWD	956	32	44	01.72-12.85	■
1.1 (688 713)		Gasolina	FWD	1108	33	45	09.80-12.85	■
1.1 (C1E 726)		Gasolina	FWD	1108	33	45	09.80-12.85	■
1.1 (C1E 750)		Gasolina	FWD	1108	33	45	09.80-12.85	■

LISTA DE APLICACIONES - BUYERS GUIDE

1.1 (C1E 752)		Gasolina	FWD	1108	33	45	09.80-12.85	■
1.1 (C1E 754)		Gasolina	FWD	1108	33	45	09.80-12.85	■
1.3 (2387) (810 726)		Gasolina	FWD	1289	32	44	03.76-08.82	■
R 5 / LE CAR (122_) 01.72-12.85					Hatchback (Supermini car-B Segment)			
0.8 (1221, 1391, 1220) (800 710)	01/82-	Gasolina	FWD	845	26	35	10.72-08.84	■
0.8 (1221, 1391) (800 710)		Gasolina	FWD	845	27	37	01.82-12.84	■
1.0 (1222, 1392) (689 710)		Gasolina	FWD	956	32	44	01.72-12.85	■
1.1 (1227, 1397) (688 713)		Gasolina	FWD	1108	33	45	09.80-12.85	■
1.1 (1227, 1397) (C1E 726)		Gasolina	FWD	1108	33	45	09.80-12.85	■
1.3 (1225) (810 726)		Gasolina	FWD	1289	31	42	09.76-09.79	■
1.3 (1225, 1395) (810 719)		Gasolina	FWD	1289	33	45	06.79-09.84	■
1.3 Automatik (1225, 1395) (810 729)		Gasolina	FWD	1289	40	54	06.79-09.84	■
1.3 (1224, 1394) (810 725)		Gasolina	FWD	1289	47	64	09.75-09.84	■
1.4 Automatik (1229, 1399) (847 712)		Gasolina	FWD	1397	43	59	06.82-09.84	■
1.4 (1229, 1399) (847 725)		Gasolina	FWD	1397	46	63	01.82-12.85	■
1.4 (1229, 1399) (C2J 713)		Gasolina	FWD	1397	46	63	01.82-12.85	■
1.4 Alpine A5 (1223) (840 725)	01/79-	Gasolina	FWD	1397	68	93	09.77-09.81	■
1.4 Alpine Turbo (122B) (840 726)	01/83-	Gasolina	FWD	1397	79	108	10.81-01.85	■
1.4 Alpine Turbo (122B) (C6J 750)	01/83-	Gasolina	FWD	1397	79	108	10.81-01.85	■