

# LISTA DE APLICACIONES - BUYERS GUIDE

**181725**



8 424073 093684

Qty: 300

Weight: 3.260

O.E.M.	MAKE
4E0 698 151	VW
4E0 698 151 A	VW
4E0 698 151 B	AUDI
4E0 698 151 E	VW
4E0 698 151 J	AUDI
4E0 698 151 K	VW
4E4 698 151	AUDI
4E4 698 151 A	AUDI

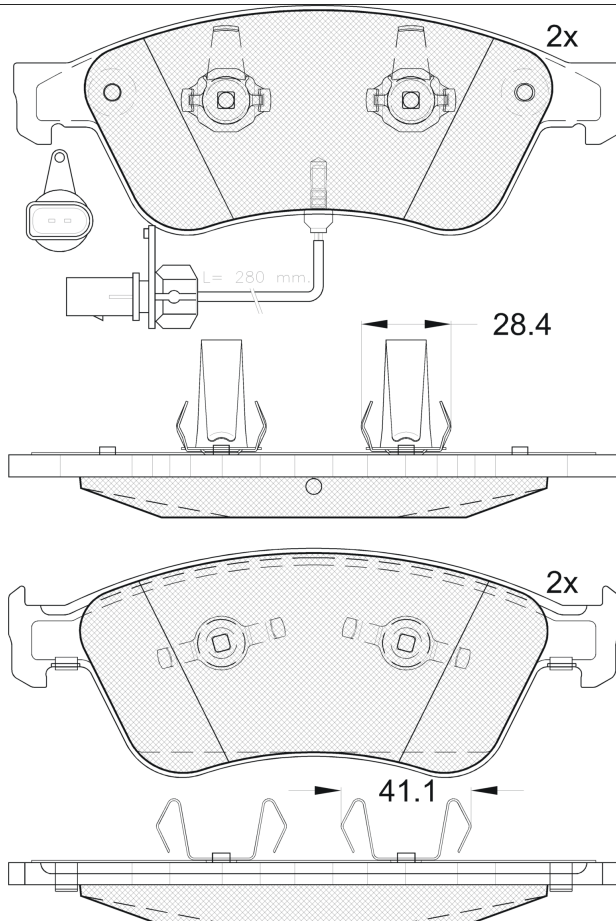

**181725**



**90R-01111/3236**



Ate - Teves

193x72.77x20.5

193.1x72.6x20.5

WVA	FMSI
23682	D1117-7928
23683	
23885	
23887	
23896	
MAKE	
AUDI	
SEAT	
VW	



Trac.	CC	Kw	CV
-------	----	----	----



Front / Rear

## AUDI

### A6 III C6 Avant (4F5) 11.04-08.11

### Estate (Executive car-E Segment)

Engine	Transmission	Drive	CC	Kw	CV	Period	Icon
2.0 TFSI (BPJ)		Gasolina	FWD	1984	125	170 06.05-08.11	■
2.4 (BDW)		Gasolina	FWD	2393	130	177 03.05-10.08	■
2.4 quattro (BDW)		Gasolina	4WD	2393	130	177 03.05-10.08	■
2.8 FSI (CCDA)		Gasolina	FWD	2773	140	190 10.08-08.11	■
2.8 FSI quattro (CCDA)		Gasolina	4WD	2773	140	190 10.08-08.11	■
2.8 FSI (BDX)		Gasolina	FWD	2773	154	210 11.06-10.08	■
2.8 FSI quattro (BDX)		Gasolina	4WD	2773	154	210 06.07-10.08	■
2.8 FSI (CCEA)		Gasolina	FWD	2773	162	220 10.08-08.11	■
2.8 FSI quattro (CCEA)		Gasolina	4WD	2773	162	220 10.08-08.11	■
3.0 (BBJ)		Gasolina	FWD	2976	160	218 03.05-05.06	■
3.0 quattro (BBJ)	PR 1LL, discØ 360	Gasolina	4WD	2976	160	218 03.05-05.06	■
3.0 TFSI quattro (CAJA)	PR 1LL, discØ 360	Gasolina	4WD	2995	213	290 10.08-08.11	■
3.0 TFSI quattro (CCAA)	PR 1LL, discØ 360	Gasolina	4WD	2995	220	299 10.08-08.11	■
3.2 FSI (AUK)		Gasolina	FWD	3123	188	255 03.05-10.08	■
3.2 FSI quattro (AUK)	PR 1LL, discØ 360	Gasolina	4WD	3123	188	255 03.05-10.08	■
3.2 FSI quattro (BKH)	PR 1LL, discØ 360	Gasolina	4WD	3123	188	255 03.05-10.08	■
4.2 quattro (BAT)	PR 1LL, discØ 360	Gasolina	4WD	4163	246	335 03.05-05.06	■
4.2 FSI quattro (BVJ)	PR 1LL, discØ 360	Gasolina	4WD	4163	257	350 06.06-08.11	■
RS6 quattro (BUH)		Gasolina	4WD	4991	426	580 04.08-08.10	■
S6 quattro (BXA)	PR 1LL, discØ 385, discØ 360, PR 1LJ	Gasolina	4WD	5204	320	435 03.06-08.11	■
2.0 TDI (BVG)		Diesel	FWD	1968	89	121 09.05-06.06	■
2.0 TDI (BNA)		Diesel	FWD	1968	100	136 06.05-08.11	■
2.0 TDI (BRF)		Diesel	FWD	1968	100	136 06.05-08.11	■

# LISTA DE APLICACIONES - BUYERS GUIDE

2.0 TDI (CAGB)		Diesel	FWD	1968	100	136	06.05-08.11	■
2.0 TDI (BLB)		Diesel	FWD	1968	103	140	06.05-10.08	■
2.0 TDI (BRE)		Diesel	FWD	1968	103	140	06.05-10.08	■
2.0 TDI (CAHB)		Diesel	FWD	1968	120	163	04.09-08.11	■
2.0 TDI (CAHA)		Diesel	FWD	1968	125	170	10.08-08.11	■
2.7 TDI (BSG)		Diesel	FWD	2698	120	163	03.05-08.11	■
2.7 TDI (CANB)		Diesel	FWD	2698	120	163	03.05-08.11	■
2.7 TDI quattro (BSG)		Diesel	4WD	2698	120	163	06.05-08.11	■
2.7 TDI quattro (CAND)		Diesel	4WD	2698	120	163	06.05-08.11	■
2.7 TDI (BPP)		Diesel	FWD	2698	132	180	03.05-10.08	■
2.7 TDI quattro (BPP)		Diesel	4WD	2698	132	180	11.04-10.08	■
2.7 TDI (CANA)		Diesel	FWD	2698	140	190	10.08-08.11	■
2.7 TDI quattro (CANC)		Diesel	4WD	2698	140	190	10.08-08.11	■
3.0 TDI quattro (BNG)		Diesel	4WD	2967	155	211	03.05-08.11	■
3.0 TDI quattro (CDYB)		Diesel	4WD	2967	155	211	03.05-08.11	■
3.0 TDI quattro (BMK)		Diesel	4WD	2967	165	225	03.05-05.06	■
3.0 TDI		Diesel	FWD	2967	171	232	06.06-08.11	■
3.0 TDI quattro (ASB)	PR 1LL, discØ 360	Diesel	4WD	2967	171	233	06.06-10.08	■
3.0 TDI quattro (CDYA)	PR 1LL, discØ 360	Diesel	4WD	2967	176	240	10.08-08.11	■
3.0 TDI quattro (CDYC)	PR 1LL, discØ 360	Diesel	4WD	2967	176	240	10.08-08.11	■
<b>A6 III Allroad C6 (4FH) 03.06-08.11</b>					<b>Estate (Executive car-E Segment)</b>			
3.0 TFSI quattro (CAJA)		Gasolina	4WD	2995	213	290	10.08-08.11	■
2.7 TDI quattro (CANC)		Diesel	4WD	2698	140	190	10.08-08.11	■
3.0 TDI quattro (CDYA)		Diesel	4WD	2967	176	240	10.08-08.11	■
3.0 TDI quattro (CDYC)		Diesel	4WD	2967	176	240	10.08-08.11	■
<b>A6 III C6 (4F2) 04.04-08.11</b>					<b>Saloon (Executive car-E Segment)</b>			
2.0 TFSI (BPJ)		Gasolina	FWD	1984	125	170	06.05-03.11	■
2.0 TFSI (BYK)		Gasolina	FWD	1984	125	170	06.05-03.11	■
2.4 (BDW)		Gasolina	FWD	2393	130	177	05.04-10.08	■
2.4 quattro (BDW)		Gasolina	4WD	2393	130	177	01.05-10.08	■
2.8 V6		Gasolina	FWD	2771	142	193	07.08-10.08	■
2.8 FSI (CCDA)		Gasolina	FWD	2773	140	190	10.08-03.11	■
2.8 FSI quattro (CCDA)		Gasolina	4WD	2773	140	190	10.08-03.11	■
2.8 FSI (BDX)		Gasolina	FWD	2773	154	210	11.06-10.08	■
2.8 FSI quattro (BDX)		Gasolina	4WD	2773	154	210	06.07-10.08	■
2.8 FSI (CCEA)		Gasolina	FWD	2773	162	220	10.08-03.11	■
2.8 FSI quattro (CCEA)		Gasolina	4WD	2773	162	220	10.08-03.11	■
3.0 (BBJ)		Gasolina	FWD	2976	160	218	08.04-05.06	■
3.0 quattro (BBJ)	PR 1LL, discØ 360	Gasolina	4WD	2976	160	218	05.04-05.06	■
3.0 TFSI quattro (CAJA)	PR 1LL, discØ 360	Gasolina	4WD	2995	213	290	10.08-03.11	■
3.0 TFSI quattro (CCAA)	PR 1LL, discØ 360	Gasolina	4WD	2995	220	299	10.08-03.11	■
3.2 FSI quattro (BYU)	PR 1LL, discØ 360	Gasolina	4WD	3123	183	249	09.06-10.08	■
3.2 FSI (AUK)		Gasolina	FWD	3123	188	255	05.04-05.09	■
3.2 FSI (BKH)		Gasolina	FWD	3123	188	255	05.04-05.09	■
3.2 FSI quattro (AUK)	PR 1LL, discØ 360	Gasolina	4WD	3123	188	255	05.04-10.08	■
3.2 FSI quattro (BKH)	PR 1LL, discØ 360	Gasolina	4WD	3123	188	255	05.04-10.08	■
4.2 quattro (BAT)	PR 1LL, discØ 360	Gasolina	4WD	4163	246	335	05.04-05.06	■
4.2 quattro (BNK)	PR 1LL, discØ 360	Gasolina	4WD	4163	246	335	05.04-05.06	■
4.2 FSI quattro (BVJ)		Gasolina	4WD	4163	257	350	06.06-03.11	■
S6 quattro (BXA)	discØ 385, PR 1LJ	Gasolina	4WD	5204	320	435	03.06-03.11	■
2.0 TDI (BVG)		Diesel	FWD	1968	89	121	09.05-06.06	■

# LISTA DE APLICACIONES - BUYERS GUIDE

2.0 TDI (BNA)		Diesel	FWD	1968	100	136	07.04-03.11	■
2.0 TDI (BRF)		Diesel	FWD	1968	100	136	07.04-03.11	■
2.0 TDI (CAGB)		Diesel	FWD	1968	100	136	07.04-03.11	■
2.0 TDI (BLB)		Diesel	FWD	1968	103	140	07.04-10.08	■
2.0 TDI (BRE)		Diesel	FWD	1968	103	140	07.04-10.08	■
2.0 TDI (CAHB)		Diesel	FWD	1968	120	163	04.09-03.11	■
2.0 TDI (CAHA)		Diesel	FWD	1968	125	170	11.08-03.11	■
2.7 TDI (BSG)		Diesel	FWD	2698	120	163	11.04-03.11	■
2.7 TDI (CANB)		Diesel	FWD	2698	120	163	11.04-03.11	■
2.7 TDI quattro (BSG)		Diesel	4WD	2698	120	163	06.05-03.11	■
2.7 TDI quattro (CAND)		Diesel	4WD	2698	120	163	06.05-03.11	■
2.7 TDI (BPP)		Diesel	FWD	2698	132	180	11.04-10.08	■
2.7 TDI quattro (BPP)		Diesel	4WD	2698	132	180	11.04-10.08	■
2.7 TDI (CANA)		Diesel	FWD	2698	140	190	10.08-03.11	■
2.7 TDI quattro (CANC)		Diesel	4WD	2698	140	190	10.08-03.11	■
3.0 TDI quattro (BNG)		Diesel	4WD	2967	155	211	05.04-03.11	■
3.0 TDI quattro (CDYB)		Diesel	4WD	2967	155	211	05.04-03.11	■
3.0 TDI quattro (BMK)		Diesel	4WD	2967	165	225	05.04-05.06	■
3.0 TDI		Diesel	RWD	2967	171	232	06.06-03.11	■
3.0 TDI quattro (ASB)	PR 1LL, discØ 360	Diesel	4WD	2967	171	233	06.06-10.08	■
3.0 TDI quattro (CDYA)	PR 1LL, discØ 360	Diesel	4WD	2967	176	240	10.08-03.11	■
3.0 TDI quattro (CDYC)	PR 1LL, discØ 360	Diesel	4WD	2967	176	240	10.08-03.11	■
<b>A8 (U.S.A. D2) 09.96-12.02</b>					<b>Saloon (Luxury car-F Segment)</b>			
4.2 40V Quattro SP 17" Long	01/02-	Gasolina	FWD	4195			09.96-	■
6.0 48V Quattro 17/18" Long	01/05-	Gasolina	FWD	5995	331	450	09.96-	■
<b>A8 II D3 (4E2, 4E8) 10.02-12.10</b>					<b>Saloon (Luxury car-F Segment)</b>			
2.8 FSI (BDX)		Gasolina	FWD	2773	154	210	08.07-07.10	■
2.8 FSI		Gasolina	FWD	2773	170	231	01.09-07.10	■
3.0 (BBJ)		Gasolina	FWD	2976	160	218	07.03-05.06	■
3.0 quattro (BBJ)		Gasolina	4WD	2976	160	218	11.03-05.04	■
3.0 (ASN)		Gasolina	FWD	2976	162	220	07.03-05.05	■
3.0 quattro		Gasolina	4WD	2976	162	220	07.03-05.05	■
3.2 FSI (BPK)	PR 1LL, PR 1LM	Gasolina	FWD	3123	191	260	06.05-07.10	■
3.2 FSI quattro (BPK)	PR 1LL, PR 1LM	Gasolina	4WD	3123	191	260	06.05-07.10	■
3.7 quattro (BFL)	PR 1LL, PR 1LM	Gasolina	4WD	3697	206	280	10.02-05.06	■
4.2 FSI quattro (BVJ)	PR 1LL, PR 1LM	Gasolina	4WD	4163	257	350	06.06-07.10	■
4.2 quattro (BFM)	PR 1LL, PR 1LM	Gasolina	4WD	4172	246	335	10.02-07.10	■
4.2 quattro (BGK)	PR 1LL, PR 1LM	Gasolina	4WD	4172	246	335	10.02-07.10	■
S8 quattro (BSM)		Gasolina	4WD	5204	324	441	09.06-07.10	■
S8 quattro (BSM)	not ceramic brakes, PR 1LJ, PR 1LK	Gasolina	4WD	5204	331	450	06.06-07.10	■
6.0 W12 quattro (BHT)	01/04-, not ceramic brakes, PR 1LJ, PR 1LK	Gasolina	4WD	5998	331	450	12.03-07.10	■
6.0 W12 quattro (BSB)	01/04-, not ceramic brakes, PR 1LJ, PR 1LK	Gasolina	4WD	5998	331	450	12.03-07.10	■
6.0 W12 quattro (BTE)	01/04-, not ceramic brakes, PR 1LJ, PR 1LK	Gasolina	4WD	5998	331	450	12.03-07.10	■
3.0 TDI quattro (BNG)		Diesel	4WD	2967	155	211	11.03-07.10	■
3.0 TDI quattro (ASB)		Diesel	4WD	2967	171	233	08.03-07.10	■
4.0 TDI quattro (ASE)	PR 1LL, PR 1LM	Diesel	4WD	3936	202	275	05.03-07.05	■
4.2 TDI quattro (BMC)	PR 1LL, PR 1LM	Diesel	4WD	4134	235	320	01.05-06.05	■
4.2 TDI quattro (BVN)	01/06-, PR 1LL, PR 1LM	Diesel	4WD	4134	240	326	07.05-07.10	■
<b>SEAT</b>								

# LISTA DE APLICACIONES - BUYERS GUIDE

IBIZA III (6L1) 02.02-11.09					Hatchback (Supermini car-B Segment)			
1.9 TDI Joya Racer (ASZ)		Diesel	FWD	1896	112	152	07.03-06.04	■
VW								
PHAETON (3D1, 3D2, 3D3, 3D4, 3D6, 3D7, 3D8, 3D9) 04.02-03.16					Saloon (Luxury car-F Segment)			
3.2 V6 (AYT)	discØ 360, PR 1ZK, PR 1ZL	Gasolina	FWD	3189	177	241	04.02-05.05	■
3.2 V6 (BKL)	discØ 360, PR 1ZK, PR 1ZL	Gasolina	FWD	3189	177	241	04.02-05.05	■
3.2 V6 4motion (BKL)	discØ 360, PR 1ZK, PR 1ZL	Gasolina	4WD	3189	177	241	02.04-11.08	■
3.2 V6 4motion (BRK)	discØ 360, PR 1ZK, PR 1ZL	Gasolina	4WD	3189	177	241	02.04-11.08	■
3.6 V6 4motion (CHNA)	discØ 360, PR 1ZK, PR 1ZL	Gasolina	4WD	3597	206	280	11.08-03.16	■
3.6 V6 4motion (CMVA)	discØ 360, PR 1ZK, PR 1ZL	Gasolina	4WD	3597	206	280	11.08-03.16	■
4.2 V8 4motion (BGH)	discØ 360, PR 1ZK, PR 1ZL	Gasolina	4WD	4172	246	335	05.03-03.16	■
4.2 V8 4motion (BGJ)	discØ 360, PR 1ZK, PR 1ZL	Gasolina	4WD	4172	246	335	05.03-03.16	■
6.0 W12 4motion (BAN)	discØ 360, PR 1ZK, PR 1ZL	Gasolina	4WD	5998	309	420	04.02-12.05	■
6.0 W12 4motion (BAP)	discØ 360, PR 1ZK, PR 1ZL	Gasolina	4WD	5998	309	420	04.02-12.05	■
6.0 W12 4motion (BRN)	discØ 360, PR 1ZK, PR 1ZL	Gasolina	4WD	5998	331	450	05.05-03.16	■
6.0 W12 4motion (BTT)	discØ 360, PR 1ZK, PR 1ZL	Gasolina	4WD	5998	331	450	05.05-03.16	■
3.0 V6 TDI 4motion (BMK)	discØ 360, PR 1ZK, PR 1ZL	Diesel	4WD	2967	165	224	09.04-05.07	■
3.0 V6 TDI 4motion (CARA)	discØ 360, PR 1ZK, PR 1ZL	Diesel	4WD	2967	171	233	06.07-11.08	■
3.0 V6 TDI 4motion (CARB)	discØ 360, PR 1ZK, PR 1ZL	Diesel	4WD	2967	176	240	11.08-03.16	■
3.0 V6 TDI 4motion (CEXA)	discØ 360, PR 1ZK, PR 1ZL	Diesel	4WD	2967	176	240	11.08-03.16	■
3.0 V6 TDI 4motion (CEXB)		Diesel	4WD	2967	180	245	11.13-03.16	■
5.0 V10 TDI 4motion (AJS)	discØ 360, PR 1ZK, PR 1ZL	Diesel	4WD	4921	230	313	11.02-10.06	■