

LISTA DE APLICACIONES - BUYERS GUIDE

181806



8 424073 095985

Qty: 300

Weight: 1.690

O.E.M.	MAKE
05191229AA	DODGE
05191244AA	DODGE
45 05A 879	MITSUBISHI
46 05A 317	MITSUBISHI
46 05A 364	MITSUBISHI
46 05A 486	MITSUBISHI
46 05A 491	MITSUBISHI
46 05A 530	MITSUBISHI
46 05A 557	MITSUBISHI
46 05A 684	MITSUBISHI
46 05A 795	MITSUBISHI
46 05A 879	MITSUBISHI
4605A261	JEEP
68035576AA	JEEP
9H 0M01 5	MITSUBISHI
CW 650 649	MITSUBISHI
CW 650 653	MITSUBISHI
K6802-0494-AB	LANCIA
MN 102 618	MITSUBISHI
MR 527 674	MITSUBISHI
MR 527 675	MITSUBISHI
MR 569 403	MITSUBISHI
MR 727 674	MITSUBISHI
MZ 690 186	MITSUBISHI
MZ 690 348	MITSUBISHI

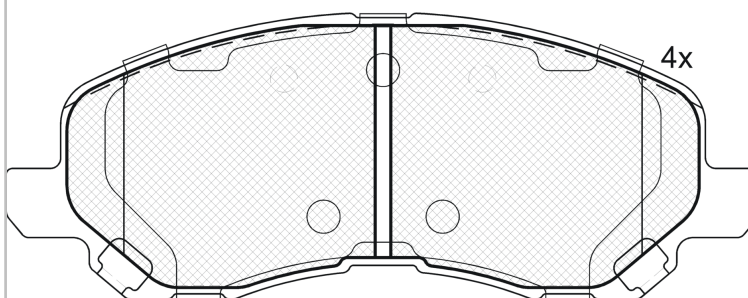

Loose Shims

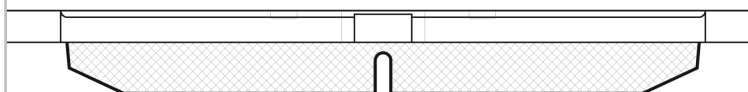

1 - Ref. 610267 E

181806



E 9 90R-01111/279

Akebono

144.9x54.9x15.9

WVA	FMSI
23584	D866-7741
25991	D866-8338
25992	D2057-9290
25993	
MAKE	
BAIC	
BAIC-ORV	
CHRYSLER	
CITROËN	
DODGE	
FIAT	
JEEP	
LANCIA	
MITSUBISHI	
MITSUBISHI (BBDC)	
MITSUBISHI (GAC)	
MITSUBISHI (SOU EAST)	
MITSUBISHI(BJC)	
PEUGEOT	



Trac.	CC	Kw	CV
-------	----	----	----



Front / Rear

BAIC

SENOVA X65 03.15-

SUV ()

2.0 T (B250EFA)	Gasolina	FWD	1992	130	177	03.15-	■
-----------------	----------	-----	------	-----	-----	--------	---

BAIC-ORV

BJ20 09.16-

SUV ()

1.5 T (4A91T)	Gasolina	FWD	1499	110	150	09.16-	■
---------------	----------	-----	------	-----	-----	--------	---

CHRYSLER

200 01.10-

Convertible (Executive car-E Segment)

2.4 (ED3)	BRF,BRG, BR3	Gasolina	FWD	2360	129	175	01.11-12.14	■
2.4 (EDG)	BRF,BRG, BR3	Gasolina	FWD	2360	129	175	01.11-12.14	■
3.6 (ERB)	BRF,BRG, BR3	Gasolina	FWD	3604	211	287	09.11-12.12	■
3.6 Flexfuel	BRF,BRG, BR3	Gasol./Etanol	FWD	3604	211	287	09.10-	■

200 01.10-

Saloon (Executive car-E Segment)

2.4 (ED3)	BRF,BRG, BR3	Gasolina	FWD	2360	129	175	01.11-12.15	■
2.4 (EDG)	BRF,BRG, BR3	Gasolina	FWD	2360	129	175	01.11-12.15	■
3.6 Flexfuel	BRF,BRG, BR3	Gasol./Etanol	FWD	3604	211	287	09.10-	■

200 II 06.14-

Saloon (Executive car-E Segment)

2.4 (EDG)	Gasolina	FWD	2360	129	175	07.14-	■
-----------	----------	-----	------	-----	-----	--------	---

SEBRING III / CIRRUS (JS) 05.07-12.10

Convertible (Executive car-E Segment)

2.4 VVT (ED3)		Gasolina	FWD	2360	125	170	07.07-12.10	■
2.4 (EDG)		Gasolina	FWD	2360	128	174	05.07-12.10	■
2.7 (EER)	01/08-	Gasolina	FWD	2736	137	186	07.07-12.10	■

LISTA DE APLICACIONES - BUYERS GUIDE

2.7 VVT (EER)	01/08-	Gasolina	FWD	2736	141	192	07.07-12.10	■
3.5 (EGG)		Gasolina	FWD	3518	175	238	05.07-12.10	■
2.7 Flexfuel (EER)		Gasol./Etanol	FWD	2736	137	186	05.07-09.10	■
2.0 CRD (ECD)	01/08-	Diesel	FWD	1968	103	140	07.07-12.10	■
SEBRING III / CIRRUS (JS) 09.06-12.10					Saloon (Executive car-E Segment)			
2.0 VVT (ECN)	01/08-	Gasolina	FWD	1998	115	156	07.07-12.10	■
2.4 VVT (ED3)		Gasolina	FWD	2360	125	170	07.07-12.10	■
2.4 VVT (EDG)		Gasolina	FWD	2360	125	170	07.07-12.10	■
2.4 (EDG)		Gasolina	FWD	2360	128	174	09.06-12.10	■
2.4 AWD		Gasolina	FWD	2360	128	174	09.07-12.08	■
2.4 LX	01/08-	Gasolina	FWD	2395	110	150	09.06-	■
2.7 VVT (EER)		Gasolina	FWD	2736	137	186	07.07-09.10	■
2.7 (EER)		Gasolina	FWD	2736	138	188	07.07-12.10	■
2.7 VVT (EER)	01/08-	Gasolina	FWD	2736	141	192	09.06-12.10	■
3.5 (EGF)		Gasolina	FWD	3518	175	238	09.06-12.08	■
2.0 CRD (ECD)	01/08-	Diesel	FWD	1968	103	140	07.07-12.10	■
CITROËN								
C4 AIRCROSS 08.10-					SUV (Mini SUV-J Segment)			
1.5 Flex		Gasolina	FWD	1449	68	93	11.15-	■
1.6 Flex		Gasolina	FWD	1587	81	110	08.10-	■
1.6		Gasolina	FWD	1587	85	115	07.12-	■
1.6 (4A92)		Gasolina	FWD	1590	86	117	04.12-	■
1.6 (NKZ (4A92))		Gasolina	FWD	1590	86	117	04.12-	■
1.6 Flex		Gasolina	FWD	1590	90	122	07.12-	■
2.0		Gasolina	FWD	1998	110	150	04.12-	■
2.0 AWC		Gasolina	4WD	1998	110	150	04.12-	■
1.6 HDi 115 (9HD (DV6C))		Diesel	FWD	1560	84	114	04.12-	■
1.6 HDi 115 AWC (9HL (DV6C))		Diesel	4WD	1560	84	114	05.12-	■
1.8 HDi 150 (4N13)		Diesel	FWD	1798	110	150	04.12-	■
1.8 HDi 150 AWC (4N13)		Diesel	4WD	1798	110	150	04.12-	■
DODGE								
AVENGER II 06.07-					Saloon (Sports car-S Segment)			
2.0 (ECN)	Rim 17	Gasolina	FWD	1998	115	156	06.07-12.11	■
2.4 (EDG)		Gasolina	FWD	2360	125	170	06.07-12.14	■
2.4 (ED3)	Rim 17	Gasolina	FWD	2360	129	175	06.07-12.14	■
2.4 (EDG)	Rim 17	Gasolina	FWD	2360	129	175	06.07-12.14	■
2.7 (EER)	Rim 17	Gasolina	FWD	2736	137	186	06.07-12.11	■
3.5 4WD	01/07-	Gasolina	FWD	3495	175	238	06.07-	■
2.7 Flex-Fuel (EER)	Rim 17	Gasol./Etanol	FWD	2736	139	189	06.07-12.09	■
2.0 CRD (ECD)	Rim 17	Diesel	FWD	1968	103	140	06.07-12.11	■
CALIBER 06.06-					Hatchback (Compact car-C Segment)			
1.8 (EBA)	Rim 17	Gasolina	FWD	1798	110	150	06.06-12.09	■
2.0 (ECN)	Rim 17	Gasolina	FWD	1998	115	156	06.06-	■
2.4 (ED3)	Rim 17	Gasolina	FWD	2359	125	170	10.06-	■
2.4 AWD (ED3)		Gasolina	4WD	2359	125	170	10.06-	■
2.4 (ED3)		Gasolina	FWD	2359	126	172	10.06-	■
2.4 Turbo (ED4)		Gasolina	FWD	2359	217	295	12.07-	■
2.4 AWD		Gasolina	FWD	2360	128	174	09.06-12.07	■
2.4		Gasolina	FWD	2360	213	290	09.07-12.09	■

LISTA DE APLICACIONES - BUYERS GUIDE

2.4 SRT4 AWD (ED4)		Gasolina	4WD	2360	223	303	10.06-	■
2.0 CRD (ECD)		Diesel	FWD	1968	88	120	06.06-11.11	■
2.0 CRD (ECD)		Diesel	FWD	1968	100	136	06.06-11.11	■
2.0 CRD (ECD)	Rim 17	Diesel	FWD	1968	103	140	06.06-	■
2.0 CRD (ECE)	Rim 17	Diesel	FWD	1968	103	140	06.06-	■
2.2 CRD (ENE)	Rim 17	Diesel	FWD	2143	120	163	07.10-11.11	■
FIAT								
DOBLO II (263_) 11.09-					Bus (Minibus-M2-Segment)			
1.3 D Multijet (263AXU1A, 263AYB1A) (330 A1.000)		Diesel	FWD	1248	70	95	03.16-	■
JEEP								
COMPASS (MK49) 08.06-					SUV (Compact SUV-J Segment)			
2.0 (ECN)		Gasolina	FWD	1998	115	156	05.11-	■
2.0 (ECN)		Gasolina	FWD	1998	118	160	08.06-	■
2.4 (ED3)	Rim 17	Gasolina	FWD	2360	125	170	08.06-	■
2.4 (EDG)	Rim 17	Gasolina	FWD	2360	125	170	08.06-	■
2.4 (ERZ)	Rim 17	Gasolina	FWD	2360	125	170	08.06-	■
2.4 4x4 (ED3)	Rim 17	Gasolina	4WD	2360	125	170	09.06-	■
2.4 4x4 (ERZ)	Rim 17	Gasolina	4WD	2360	125	170	09.06-	■
2.0 CRD 4x4 (ECD)		Diesel	4WD	1968	88	120	02.07-	■
2.0 CRD (ECD)	Rim 17	Diesel	FWD	1968	103	140	08.06-	■
2.0 CRD (ECE)	Rim 17	Diesel	FWD	1968	103	140	08.06-	■
2.0 CRD 4x4 (ECE)	Rim 17	Diesel	4WD	1968	103	140	09.06-	■
2.2 CRD (ENE)		Diesel	FWD	2143	100	136	05.11-	■
2.2 CRD 4x4 (ENE)		Diesel	4WD	2143	100	136	05.11-	■
2.2 CRD 4x4 (OM 651.925)		Diesel	4WD	2143	120	163	12.10-	■
PATRIOT (MK74) 02.07-					Closed Off-Road Vehicle (Compact SUV-J Segment)			
2.0 (ECN)		Gasolina	FWD	1998	115	156	01.11-12.17	■
2.0 4x4 (ECN)		Gasolina	4WD	1998	115	156	02.07-12.17	■
2.4 (ED3)		Gasolina	FWD	2360	125	170	06.09-12.17	■
2.4 (EDG)		Gasolina	FWD	2360	125	170	06.09-12.17	■
2.4 4x4 (ED3)	Rim 17	Gasolina	4WD	2360	125	170	01.08-12.17	■
2.4 4x4 (EDG)	Rim 17	Gasolina	4WD	2360	125	170	01.08-12.17	■
2.4 4x4 (ED3)	BRJ,BR1	Gasolina	4WD	2360	128	174	02.07-12.17	■
2.4 Eco + 4x4 (ED3)	Rim 17	Gasol./Gas (LPG)	4WD	2360	125	170	07.08-12.17	■
2.0 CRD 4x4 (ECD)		Diesel	4WD	1968	88	120	02.07-12.17	■
2.0 CRD (ECD)	01/08-	Diesel	FWD	1968	103	140	02.07-12.17	■
2.0 CRD (ECE)	01/08-	Diesel	FWD	1968	103	140	02.07-12.17	■
2.0 CRD 4x4 (ECD)	01/08-, Rim 17	Diesel	4WD	1968	103	140	02.07-12.17	■
2.0 CRD 4x4 (ECE)	01/08-, Rim 17	Diesel	4WD	1968	103	140	02.07-12.17	■
2.2 CRD (ENE)		Diesel	FWD	2143	100	136	01.11-12.17	■
2.2 CRD 4x4 (ENE)	Rim 17	Diesel	4WD	2143	100	136	01.11-12.17	■
2.2 CRD 4x4 (ENE)	Rim 17	Diesel	4WD	2143	120	163	01.11-12.17	■
LANCIA								
FLAVIA III (JS_) 03.12-12.14					Convertible (Executive car-E Segment)			
2.4 (JK, JS) (EDG)		Gasolina	FWD	2360	125	170	03.12-12.14	■
2.4 (JS) (EDG)		Gasolina	FWD	2360	129	175	03.12-12.14	■
MITSUBISHI								

LISTA DE APLICACIONES - BUYERS GUIDE

380 (DB) 04.05-09.08					Saloon (Executive car-E Segment)			
3.8 i		Gasolina	FWD	3828	175	238	04.05-04.08	■
ASX (GA_W_) 06.10-					SUV Van (Compact SUV-J Segment)			
1.8 DI-D 4WD (4N13)		Diesel	4WD	1798	110	150	06.10-	■
ASX (GA_W_) 11.09-					SUV (Compact SUV-J Segment)			
1.6 MIVEC (GA1W) (4A92)	Eq.V_ H-LINE/INFORM	Gasolina	FWD	1590	85	116	05.10-	■
1.6 MIVEC (GA1W) (4A92)	Eq.V_ M-LINE	Gasolina	FWD	1590	86	117	06.10-	■
1.8 (GA3W) (4B10)		Gasolina	FWD	1798	102	139	02.10-	■
1.8 4WD (GA3W)		Gasolina	4WD	1798	102	139	02.10-	■
2.0		Gasolina	FWD	1998	108	147	09.10-12.12	■
2.0 MIVEC (GA2W) (4B11)	Type GA2W	Gasolina	FWD	1998	110	150	06.10-	■
2.0 MIVEC (GA2W) (4J11)	Type GA2W	Gasolina	FWD	1998	110	150	06.10-	■
2.0 MIVEC 4WD (4B11)	Type GA9W, Type GA2W, Eq.V_ M-LINE	Gasolina	4WD	1998	110	150	06.10-	■
2.0 MIVEC 4WD (4J11)	Type GA9W, Type GA2W, Eq.V_ M-LINE	Gasolina	4WD	1998	110	150	06.10-	■
2.0 i 4WD		Gasolina	4WD	1998	114	155	01.10-	■
2.0 i		Gasolina	FWD	1998	118	160	06.10-	■
2.0 i 4WD		Gasolina	4WD	1998	118	160	06.10-	■
1.6 LPG	Eq.V_ H-LINE/INFORM	Gasol./G as (LPG)	FWD	1590	86	117	06.10-	■
1.6 DI-D (9HD)		Diesel	FWD	1560	84	114	07.15-	■
1.6 DI-D 4WD (9HD)		Diesel	4WD	1560	84	114	07.15-	■
1.8 DI-D (GA6W) (4N13)		Diesel	FWD	1798	85	116	06.10-	■
1.8 DI-D 4WD (GA6W) (4N13)		Diesel	4WD	1798	85	116	06.10-	■
1.8 DI-D (GA6W) (4N13)		Diesel	FWD	1798	110	150	06.10-	■
1.8 DI-D 4WD (GA6W) (4N13)		Diesel	4WD	1798	110	150	06.10-	■
2.2 DI-D 4WD (GA8W) (4N14)		Diesel	4WD	2268	110	150	04.13-	■
ECLIPSE II (D3_A) 04.94-04.99					Coupe (Executive car-E Segment)			
2000 GS 16V (D32A) (4G63 (DOHC 16V))		Gasolina	FWD	1997	107	146	12.95-04.99	■
2000 GT 16V (4G63-T (DOHC 16V))		Gasolina	FWD	1997	157	214	12.95-04.99	■
2400 GS 16V (4G64 (16V))		Gasolina	FWD	2389	105	143	09.98-04.99	■
ECLIPSE III (D5_A) 05.99-12.05					Convertible (Executive car-E Segment)			
1.8		Gasolina	FWD	1834	103	141	05.99-03.05	■
2.4 RS (4G64 (16V))	01/01-	Gasolina	FWD	2351	106	144	05.99-03.05	■
2.4 (4G64 (16V))	01/01-	Gasolina	FWD	2351	110	150	05.99-03.05	■
3.0 (6G72 (SOHC 24V))	01/01-	Gasolina	FWD	2972	149	203	05.99-03.05	■
3.0 (6G72 (SOHC 24V))	01/01-	Gasolina	FWD	2972	157	213	05.99-03.05	■
ECLIPSE III (D5_A) 04.99-12.05					Coupe (Executive car-E Segment)			
2.4 (4G64 (16V))	01/01-	Gasolina	FWD	2351	110	150	05.99-03.05	■
3.0 (6G72 (SOHC 24V))	01/01-	Gasolina	FWD	2972	149	203	05.99-03.05	■
3.0 (6G72 (SOHC 24V))	01/01-	Gasolina	FWD	2972	157	213	05.99-03.05	■
ECLIPSE IV 04.05-					Convertible (Executive car-E Segment)			
3.8 (6G75)		Gasolina	FWD	3828	196	267	04.05-12.08	■
ECLIPSE IV (DK_A) 04.05-12.12					Coupe (Executive car-E Segment)			
2.4 GS (4G69)		Gasolina	FWD	2378	120	163	04.05-12.11	■
3.8 GT (6G75)		Gasolina	FWD	3828	192	261	04.05-12.11	■
3.8 (6G75)		Gasolina	FWD	3828	196	267	09.05-12.08	■

LISTA DE APLICACIONES - BUYERS GUIDE

GALANT IX / GRUNDER (DJ_, ED_, EF_) 10.03-					Saloon (Executive car-E Segment)			
2.0 GDi G		Gasolina	FWD	1999	107	145	10.03-	■
2.0 GDi V		Gasolina	FWD	1999	107	145	10.03-	■
2.4 (4G69)		Gasolina	FWD	2378	116	158	10.03-	■
2.4 (4G69)		Gasolina	FWD	2378	118	160	12.04-	■
2.4 (DJ1A)		Gasolina	FWD	2378	121	165	10.03-	■
2.4 GDi Sport 4WD (DJ1A)		Gasolina	4WD	2378	121	165	10.03-	■
3.8 (6G75)		Gasolina	FWD	3828	171	232	10.03-12.09	■
3.8 4WD (6G75)		Gasolina	4WD	3828	171	232	10.03-	■
GALANT VIII / ASPIRE (EA_) 09.96-10.04					Saloon (Executive car-E Segment)			
1.8 GDi (EA1A) (4G93 (GDI))	01/00-	Gasolina	FWD	1834	103	140	11.97-10.01	■
2.0 (EA2A) (4G63 (SOHC 16V))	-12/03	Gasolina	FWD	1997	98	133	09.00-10.04	■
2.0 (EA2A) (4G63 (SOHC 16V))	04/00-	Gasolina	FWD	1997	100	136	09.96-09.00	■
2.0 GDI (EA7A) (4G94 (GDI))	01/00-	Gasolina	FWD	1999	107	146	01.97-10.04	■
2.4 GDI (EA3A) (4G64 (GDI))	-12/03	Gasolina	FWD	2351	106	144	09.00-10.04	■
2.4 GDI (EA3A) (4G64 (GDI))		Gasolina	FWD	2351	110	150	02.99-09.00	■
2.4 GDI		Gasolina	FWD	2378	121	165	10.03-10.04	■
2.5 V6 24V (EA5A) (6A13)	-10/03	Gasolina	FWD	2498	118	160	09.00-10.04	■
2.5 V6 24V (EA5A) (6A13)		Gasolina	FWD	2498	120	163	09.96-09.00	■
2.5 Type S (EC5A) (6A13)	01/00-	Gasolina	FWD	2498	151	205	10.99-10.04	■
3.0 (EA8A) (6G72 (SOHC 24V))		Gasolina	FWD	2972	152	207	01.99-12.03	■
2.0 TDI (EA6A) (4D68 T)	04/00-	Diesel	FWD	1998	66	90	09.96-10.04	■
GALANT VIII / LEGNUM (EA_, EC_) 09.96-10.03					Estate (Executive car-E Segment)			
2.0 (EA2W) (4G63 (SOHC 16V))		Gasolina	FWD	1997	98	133	09.00-10.03	■
2.0 (EA2W) (4G63 (SOHC 16V))	04/00-	Gasolina	FWD	1997	100	136	09.96-09.00	■
2.4 GDI (EA3W) (4G64 (GDI))		Gasolina	FWD	2351	106	144	09.00-10.03	■
2.4 GDI (EA3W) (4G64 (GDI))		Gasolina	FWD	2351	110	150	02.99-10.03	■
2.5 V6 24V (EA5W) (6A13)		Gasolina	FWD	2498	118	160	09.00-10.03	■
2.5 V6 24V (EA5W) (6A13)	03/00-	Gasolina	FWD	2498	120	163	09.96-09.00	■
2.5 V6 24V (EC5W) (6A13TT)		Gasolina	4WD	2498	206	280	09.96-12.02	■
2.0 TDI (EA6W) (4D68 T)	04/00-	Diesel	FWD	1998	66	90	09.96-10.03	■
LANCER III-IV (CJ_, CP_) 09.95-12.03					Saloon (Compact car-C Segment)			
1.8		Gasolina	FWD	1834	91	124	09.95-08.03	■
2.0		Gasolina	FWD	1999	92	125	09.95-08.03	■
2.4 GDI	01/03-	Gasolina	FWD	2351	108	147	09.95-08.03	■
LANCER IV (CS_W, CT_W) 09.03-12.08					Estate (Compact car-C Segment)			
1.6 (4G18)	-12/06	Gasolina	FWD	1584	72	98	09.03-10.08	■
1.8 GDi T	-12/06	Gasolina	FWD	1834	121	165	09.03-10.08	■
2.0 (CS9W) (4G63 (DOHC 16V))	-12/06	Gasolina	FWD	1997	99	135	09.03-12.07	■
2.0	-12/06	Gasolina	FWD	1999	92	125	08.05-10.08	■
2.4 GDI	-12/06	Gasolina	FWD	2350	98	133	09.03-10.08	■
LANCER IV / CEDIA (CS_A, CT_A) 01.00-12.13					Saloon (Compact car-C Segment)			
1.3 (4G13 (16V))	-12/06	Gasolina	FWD	1299	60	82	09.03-12.13	■
1.6 (CS3A) (4G18)	-12/06	Gasolina	FWD	1584	72	98	09.03-12.13	■
1.8	-12/06	Gasolina	FWD	1834	88	121	09.03-	■
1.8 SEi Limited	-12/06	Gasolina	FWD	1834	91	124	09.03-03.07	■
2.0	-12/06	Gasolina	FWD	1997	85	116	09.03-	■
2.0 (CS9A) (4G63 (DOHC 16V))	-12/06	Gasolina	FWD	1997	99	135	12.03-12.13	■
2.0 i (4B11)		Gasolina	FWD	1998	113	154	10.07-12.13	■

LISTA DE APLICACIONES - BUYERS GUIDE

2.0		Gasolina	FWD	1999	85	116	08.03-04.06	■
2.0 (CS6A) (4G94)	-12/06	Gasolina	FWD	1999	92	125	08.03-12.13	■
2.0 GDi (CS6A) (4G94 (GDI))	-12/06	Gasolina	FWD	1999	92	125	09.03-12.13	■
2.4	-12/06	Gasolina	FWD	2350	108	147	09.03-	■
2.4 iVRX	-12/06	Gasolina	FWD	2378	115	156	08.05-	■
LANCER V EX / GALANT FORTIS / LANCER SERIE R / LANCER FORTIS (CY_A, CZ_A) 03.07-					Saloon (Compact car-C Segment)			
1.5 (4A91)		Gasolina	FWD	1499	80	109	06.08-	■
1.6 MIVEC (4A92)		Gasolina	FWD	1590	86	117	05.10-	■
1.8 (CY3A, CY6A) (4B10)		Gasolina	FWD	1798	103	140	05.10-	■
1.8 (CY3A, CY6A) (4B10)		Gasolina	FWD	1798	105	143	02.08-	■
1.8 Mivec (4B10)		Gasolina	FWD	1798	110	150	11.09-	■
2.0 (CY4A) (4B11)		Gasolina	FWD	1998	110	150	01.13-	■
2.0 i Ralliart 4WD (CY4A) (4B11-T/C)		Gasolina	4WD	1998	177	241	10.08-	■
2.4 i		Gasolina	FWD	2360	125	170	10.08-	■
1.5 Bifuel (4A91)		Gasol./Gas (LPG)	FWD	1499	80	109	02.10-	■
1.8 Bifuel (CY3A, CY6A) (4B10)		Gasol./Gas (LPG)	FWD	1798	105	143	01.10-	■
1.8 Flexfuel (CY3A, CY6A) (4B10)		Gasol./Etanol	FWD	1798	103	140	03.09-	■
1.8 Flexfuel (CY3A) (4B10)		Gasol./Etanol	FWD	1798	105	143	01.10-	■
1.8 DI-D (4N13)		Diesel	FWD	1798	85	116	05.10-	■
1.8 DI-D (CY9A) (4N13)		Diesel	FWD	1798	110	150	06.10-	■
2.0 DI-D (CY8A) (BKD)		Diesel	FWD	1968	103	140	01.08-	■
2.0 DI-D (CY8A) (BWC)		Diesel	FWD	1968	103	140	01.08-	■
LANCER V EX Sportback / GALANT FORTIS Sportback (CX_A) 10.07-					Hatchback (Compact car-C Segment)			
1.5 (4A91)		Gasolina	FWD	1499	80	109	06.08-	■
1.6 MIVEC (4A92)		Gasolina	FWD	1590	86	117	05.10-	■
1.8 MIVEC (CX3A, CX6A) (4B10)	01/10-	Gasolina	FWD	1798	103	140	03.09-	■
1.8 (CX3A) (4B10)		Gasolina	FWD	1798	105	143	06.08-	■
2.0 i		Gasolina	FWD	1998	113	154	10.07-	■
2.4 i		Gasolina	FWD	2360	125	170	10.08-	■
1.5 Bifuel (4A91)		Gasol./Gas (LPG)	FWD	1499	80	109	03.10-	■
1.8 Bifuel (CX3A, CX6A) (4B10)		Gasol./Gas (LPG)	FWD	1798	105	143	02.10-	■
1.8 Flex (CX3A, CX6A) (4B10)		Gasol./Etanol	FWD	1798	103	140	03.09-	■
1.8 DI-D (4N13)		Diesel	FWD	1798	85	116	05.10-	■
1.8 DI-D (CX9A) (4N13)		Diesel	FWD	1798	110	150	06.10-	■
2.0 DI-D (CX8A) (BKD)		Diesel	FWD	1968	103	140	06.08-	■
2.0 DI-D (CX8A) (BWC)		Diesel	FWD	1968	103	140	06.08-	■
LANCER CARGO IV (CS_W) 09.03-06.08					Estate Van (Compact car-C Segment)			
1.6 (CS3W) (4G18)	-12/06	Gasolina	FWD	1584	72	98	09.03-06.08	■
2.0 (CS9W)		Gasolina	FWD	1997	99	135	09.03-06.08	■
OUTLANDER II (CW_W) 09.05-12.12					SUV (Compact SUV-J Segment)			
2.4 (CW5W) (4B12)		Gasolina	FWD	2360	125	170	11.06-11.12	■
2.4 4WD (CW5W) (4B12)		Gasolina	4WD	2360	125	170	09.07-11.12	■
3.0		Gasolina	FWD	2998	162	220	11.06-11.12	■
3.0 4WD (CW6W) (6B31)		Gasolina	4WD	2998	162	220	11.06-11.12	■
OUTLANDER / AIRTREK (CU_W) 03.01-07.08					SUV (Compact SUV-J Segment)			
2.0 4WD (CU2W)	-12/04	Gasolina	4WD	1997	93	126	05.03-10.06	■

LISTA DE APLICACIONES - BUYERS GUIDE

2.0 (CU2W) (4G63 (DOHC 16V))	-12/04	Gasolina	FWD	1997	100	136	05.03-10.06	■
2.0 4WD (CU2W) (4G63 (DOHC 16V))	-12/04	Gasolina	4WD	1997	100	136	05.03-10.06	■
2.0 Turbo 4WD (CU2W) (4G63-T (DOHC 16V))	-12/04	Gasolina	4WD	1997	148	201	04.04-10.06	■
2.0 Turbo-R 4WD (CU2W) (4G63 TURBO)	-12/04	Gasolina	4WD	1997	177	241	01.02-10.06	■
2.4 4WD (CU4W) (4G64 (16V))	-12/04	Gasolina	4WD	2351	102	139	05.03-10.06	■
2.4 4WD (CU5W) (4G69)	-12/04	Gasolina	4WD	2378	118	160	11.03-09.07	■
2.4 HDD Mivec (CU5W) (4G69)	-12/04	Gasolina	FWD	2378	118	160	03.01-12.06	■
2.4 4WD (CU5W) (4G69)	-12/04	Gasolina	4WD	2378	119	162	05.03-09.07	■
OUTLANDER III / PHEV III (GF_W, GG_W) 11.10-					SUV Van (Compact SUV-J Segment)			
Di-D 4WD (GF6W)	Rim 16, Europe	Diesel	4WD	2268	110	150	04.13-	■
OUTLANDER III / PHEV III (GG_W, GF_W, ZJ, ZL, ZK) 11.10-					SUV (Compact SUV-J Segment)			
2.0 (4B11)	Rim 16, Europe	Gasolina	FWD	1998	105	143	10.12-	■
2.0	Rim 16, Europe	Gasolina	FWD	1998	106	144	10.12-	■
2.0 (GF2W) (4B11)	Rim 16, Europe	Gasolina	FWD	1998	107	146	10.12-	■
2.0 4WD (GF7W, GF2W) (4B11)	Rim 16, Europe	Gasolina	4WD	1998	107	146	10.12-	■
2.0 (GF7W) (4J11)	Rim 16, Europe	Gasolina	FWD	1998	110	150	08.12-	■
2.0 4WD (GF7W) (4J11)	Rim 16, Europe	Gasolina	4WD	1998	110	150	08.12-	■
2.0 (GF7W) (4J11)	Rim 16, Europe	Gasolina	FWD	1998	112	152	04.13-	■
2.0 (GF7W)	Rim 16, Europe	Gasolina	FWD	1998	118	160	03.13-12.18	■
2.4 4WD (4B12)	Rim 16, Europe	Gasolina	4WD	2360	123	167	10.12-	■
2.4 4WD (GF3W, GF8W) (4B12)	Rim 16, Europe, Europe	Gasolina	4WD	2360	124	169	10.12-	■
2.4 4WD (GF3W, GF8W) (4J12)	Rim 16, Europe, Europe	Gasolina	4WD	2360	124	169	10.12-	■
3.0 4WD (6B31)		Gasolina	4WD	2998	165	224	03.14-	■
3.0 GT		Gasolina	FWD	2998	167	227	08.12-	■
3.0 GT 4WD (6B31)		Gasolina	4WD	2998	167	227	08.12-	■
3.0 4WD (6B31)	Rim 16, Europe	Gasolina	4WD	2998	169	230	03.14-	■
3.0 GT 4WD		Gasolina	4WD	2998	177	240	09.13-12.18	■
2.0 Hybrid 4WD (GG2W) (4B11)	Rim 16, Europe	Gasol./el éc.	4WD	1998	89	121	12.12-	■
2.0 Hybrid 4WD (GG2W) (S61)	Rim 16, Europe	Gasol./el éc.	4WD	1998	89	121	12.12-	■
2.0 Hybrid 4WD (GG2W) (Y61)	Rim 16, Europe	Gasol./el éc.	4WD	1998	89	121	12.12-	■
2.0 Hybrid 4WD (GG2W) (4B11)	Rim 16, Europe	Gasol./el éc.	4WD	1998	139	189	12.12-	■
2.0 Hybrid 4WD (GG2W) (S61)	Rim 16, Europe	Gasol./el éc.	4WD	1998	139	189	12.12-	■
2.0 Hybrid 4WD (GG2W) (Y61)	Rim 16, Europe	Gasol./el éc.	4WD	1998	139	189	12.12-	■
2.0 Hybrid 4WD (GG2W) (4B11)	Rim 16, Europe	Gasol./el éc.	4WD	1998	147	200	01.14-	■
2.0 Hybrid 4WD (GG2W) (S61)	Rim 16, Europe	Gasol./el éc.	4WD	1998	147	200	01.14-	■
2.0 Hybrid 4WD (GG2W) (Y61)	Rim 16, Europe	Gasol./el éc.	4WD	1998	147	200	01.14-	■
2.2 DI-D (GF6W) (4N14)	Rim 16, Europe	Diesel	FWD	2268	110	150	08.12-	■
2.2 DI-D 4WD (GF6W) (4N14)	Rim 16, Europe	Diesel	4WD	2268	110	150	08.12-	■
OUTLANDER III / PHEV III (GF_W, GG_W) 04.13-					Van (Compact SUV-J Segment)			
2.2 DI-D	Rim 16, Europe	Diesel	RWD	2268	110	150	04.13-	■
SPACCE RUNNER / RVR II (N6_W) 08.99-01.03					MPV (Mini MPV-M1 Segment)			
2.0 (N63W) (4G63 (SOHC 16V))		Gasolina	FWD	1997	98	133	05.00-08.02	■
2.0 (N63W) (4G63 (SOHC 16V))	05/00-	Gasolina	FWD	1997	100	136	08.99-08.02	■
2.4 GDI (N64W) (4G64 (GDI))	01/00-	Gasolina	FWD	2351	108	147	08.99-08.02	■
2.4 GDI (N64W) (4G64 (GDI))	05/00-	Gasolina	FWD	2351	110	150	08.99-01.03	■
MITSUBISHI (BBDC)								

LISTA DE APLICACIONES - BUYERS GUIDE

OUTLANDER (CU_W) 01.04-					Hatchback (Compact SUV-J Segment)			
2.4	Gasolina	FWD	2378	121	162	07.06-	■	
2.4	Gasolina	FWD	2378	121	162	07.06-		
MITSUBISHI (GAC)								
ASX 11.12-					Hatchback (Compact SUV-J Segment)			
1.6	Gasolina	FWD	1590	91	124	11.12-	■	
2.0	Gasolina	FWD	1998	123	167	11.12-		
2.0	Gasolina	FWD	1998	123	167	11.12-	■	
MITSUBISHI (SOU EAST)								
GALANT 09.06-					Saloon (Compact car-C Segment)			
2.0	Gasolina	FWD	1998	118	160	09.09-	■	
LANCER EX 11.09-					Saloon (Supermini car-B Segment)			
1.8	Gasolina	FWD	1798	110	150	11.09-	■	
2.0	Gasolina	FWD	1998	125	170	11.09-		
MITSUBISHI(BJC)								
OUTLANDER 01.04-01.07					Hatchback (Compact SUV-J Segment)			
2.4	Gasolina	FWD	2378	121	162	01.04-03.06	■	
2.4	Gasolina	FWD	2378	121	162	01.04-03.06		
PEUGEOT								
4008 05.12-					SUV (Mini SUV-J Segment)			
1.6	Gasolina	FWD	1590	86	117	05.12-	■	
2.0 (4B11)	Gasolina	FWD	1998	110	150	05.13-		
2.0 AWC (4B11)	Gasolina	4WD	1998	110	150	05.12-		
1.6 HDi (9HD (DV6C))	Diesel	FWD	1560	84	114	05.12-		
1.6 HDi AWC (9HD (DV6C))	Diesel	4WD	1560	84	114	05.12-		
1.8 HDi	Diesel	FWD	1798	110	150	05.12-		
1.8 HDi AWC (6HZ (4N13))	Diesel	4WD	1798	110	150	05.12-		