

# LISTA DE APLICACIONES - BUYERS GUIDE

182361



8 424073 192004

Qty: 300

Weight: 390

O.E.M.	MAKE
1003460-00-B	Tesla
1003460-00-D	Tesla
420 698 451 A	AUDI
420 698 451 D	AUDI
4D43-2B926-BA	ASTON MARTIN
4G43-2C562-BA	ASTON MARTIN
4G7Z-2B684-AA	JAGUAR
4S0 698 451 C	AUDI
4S0 698 451 H	AUDI
4S0 698 451 M	AUDI
4S0 698 451 N	AUDI
C2C 13267	JAGUAR
C2C 13800	JAGUAR
T2R16102	JAGUAR
TR2 16102	JAGUAR

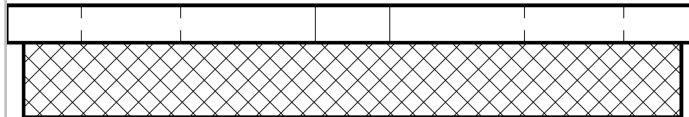
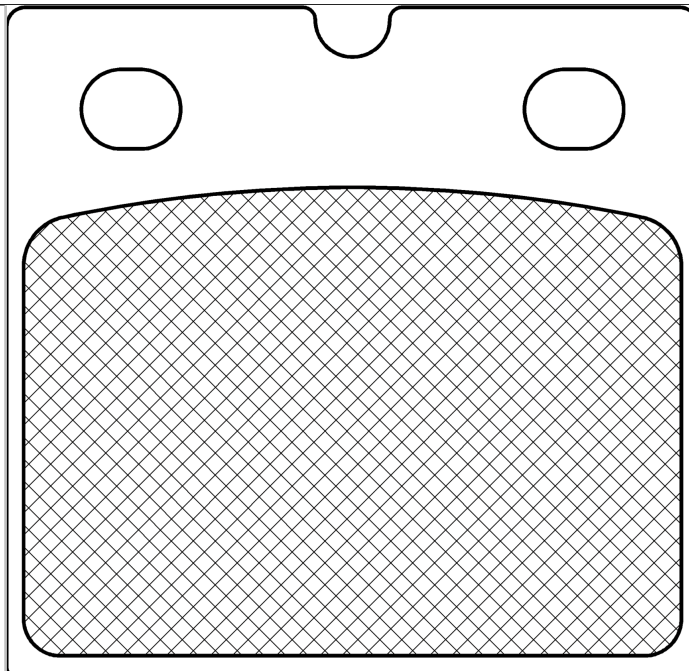

4x

182361

E 9 90R-02A0111/4156



Brembo

55.7x53.6x9

WVA	FMSI
20610	D971-7872
24044	D971-9047
MAKE	
ASTON MARTIN	
AUDI	
FORD	
FORD USA	
JAGUAR	
MASERATI	
Tesla	



Trac.

CC

Kw

CV



Front / Rear

## ASTON MARTIN

### DB9 Vantage 01.04-10.16

						Coupe (Grand Tourer-S Segment)			
6.0 V12 (AM3)	Performance M	Gasolina	RWD	5935	331	450	01.04-10.16		■
6.0 V12 (AM3)	Performance M	Gasolina	RWD	5935	350	476	01.08-07.12		■
6.0 V12 (AM11)	Performance M	Gasolina	RWD	5935	380	517	07.12-10.16		■
6.0 V12 (AM11)	Performance M	Gasolina	RWD	5935	403	548	04.15-10.16		■

### DB9 Volante 04.04-10.16

						Convertible (Grand Tourer-S Segment)			
6.0 V12 (AM3)	Performance M	Gasolina	RWD	5935	331	450	04.04-07.12		■
6.0 V12 (AM3)	Performance M	Gasolina	RWD	5935	350	476	09.05-07.12		■
6.0 V12 (AM11)	Performance M	Gasolina	RWD	5935	380	517	07.12-10.16		■
6.0 (AM11)	Performance M	Gasolina	RWD	5935	403	548	09.15-10.16		■

### DBS II Vantage 09.07-

						Coupe (Sports car-S Segment)			
6.0 V12 (AM4R9)	Performance M	Gasolina	RWD	5935	380	517	09.07-		■

### DBS II Volante 09.07-

						Convertible (Sports car-S Segment)			
6.0 V12 (AM4R9)	Performance M	Gasolina	RWD	5935	380	517	09.07-		■

### RAPIDE 03.10-

						Hatchback (Luxury car-F Segment)			
6.0 (AM16)	Performance M	Gasolina	RWD	5935	350	476	03.10-09.13		■
6.0 (AM4R9)	Performance M	Gasolina	RWD	5935	350	476	03.10-09.13		■
6.0 S (AM11)	Performance M	Gasolina	RWD	5935	410	558	02.13-02.14		■
6.0 S (AM29)	Performance M	Gasolina	RWD	5935	410	558	02.13-02.14		■
6.0 S (AM29)	Performance M	Gasolina	RWD	5935	412	560	08.14-		■

### VANQUISH II Volante 09.13-

						Convertible (Grand Tourer-S Segment)			
6.0 (AM11)	Performance M	Gasolina	RWD	5935	421	573	09.13-		■

# LISTA DE APLICACIONES - BUYERS GUIDE

6.0 (AM29)	Performance M	Gasolina	RWD	5935	423	575	09.14-	■
6.0 (AM29)	Performance M	Gasolina	RWD	5935	424	576	05.14-	■
<b>VANQUISH II Vantage 10.12-</b>					<b>Coupe (Grand Tourer-S Segment)</b>			
6.0 (AM11)	Performance M	Gasolina	RWD	5935	421	573	10.12-	■
6.0 (AM310) (AM29)	Performance M	Gasolina	RWD	5935	424	577	05.14-	■
<b>VANTAGE Vantage 10.05-</b>					<b>Coupe (Grand Tourer-S Segment)</b>			
4.3 (AM05)	Performance M	Gasolina	RWD	4280	283	385	10.05-12.08	■
4.3 (AM6U5)	Performance M	Gasolina	RWD	4280	283	385	10.05-12.08	■
4.3 N400 (AM05)	Performance M	Gasolina	RWD	4280	298	405	01.08-12.10	■
4.7 V8 (AM15)	Performance M	Gasolina	RWD	4735	313	426	10.08-07.18	■
4.7 V8S (AM15)	Performance M	Gasolina	RWD	4735	321	437	06.11-07.18	■
6.0 V12 (AM10)	Performance M	Gasolina	RWD	5935	380	517	09.09-12.13	■
6.0 V12S (AM28)	Performance M	Gasolina	RWD	5935	421	573	01.13-	■
<b>VANTAGE Volante 04.07-</b>					<b>Convertible (Grand Tourer-S Segment)</b>			
4.3 (AM05)	Performance M	Gasolina	RWD	4280	283	385	04.07-12.08	■
4.3 (AM6U5)	Performance M	Gasolina	RWD	4280	283	385	04.07-12.08	■
4.3 (AM05)	Performance M	Gasolina	RWD	4280	298	405	01.08-12.10	■
4.7 V8 (AM15)	Performance M	Gasolina	RWD	4735	313	426	10.08-07.18	■
4.7 S (AM15)	Performance M	Gasolina	RWD	4735	321	437	01.11-	■
6.0 (AM10)	Performance M	Gasolina	RWD	5935	380	517	01.12-	■
6.0 V12S (AM28)	Performance M	Gasolina	RWD	5935	421	573	04.14-	■
<b>VIRAGE III Vantage 02.11-</b>					<b>Coupe (Sports car-S Segment)</b>			
6.0 (AM4R9)	Performance M	Gasolina	RWD	5935	365	496	06.11-08.12	■
5.9	Performance M	Gasolina	FWD	5935	380	517	06.11-	■
<b>VIRAGE III Volante 02.11-12.14</b>					<b>Convertible (Sports car-S Segment)</b>			
6.0 (AM4R9)	Performance M	Gasolina	RWD	5935	365	496	06.11-08.12	■
<b>ZAGATO 05.12-</b>					<b>Coupe (Sports car-S Segment)</b>			
6.0 V12 (AM4R9)	Performance M	Gasolina	RWD	5935	380	517	05.12-	■
<b>AUDI</b>								
<b>R8 (422, 423) 04.07-08.16</b>					<b>Coupe (Sports car-S Segment)</b>			
4.2 FSI quattro (BYH)	Performance M	Gasolina	4WD	4163	309	420	04.07-09.10	■
4.2 FSI quattro (CNDA)	Performance M	Gasolina	4WD	4163	316	430	07.10-07.15	■
5.2 FSI quattro (BUJ)	Performance M	Gasolina	4WD	5204	386	525	04.09-07.15	■
5.2 FSI quattro (CTYA)	Performance M	Gasolina	4WD	5204	386	525	04.09-07.15	■
5.2 FSI quattro (CTPA)	Performance M	Gasolina	4WD	5204	404	549	05.12-07.15	■
5.2 FSI quattro (CMPA)	Performance M	Gasolina	4WD	5204	412	560	11.10-07.15	■
5.2 FSI quattro (CTPB)	Performance M	Gasolina	4WD	5204	419	570	07.14-07.15	■
<b>R8 II (4S3, 4SP) 07.15-</b>					<b>Coupe (Sports car-S Segment)</b>			
5.2 FSI (DKAB)	PR 1KY, PR 2ED, PR A8U, Performance M	Gasolina	RWD	5204	397	540	09.17-	■
5.2 FSI quattro (CSPB)	-01/16, PR 1KY, PR 2ED, PR A8U, Performance M	Gasolina	4WD	5204	397	540	07.15-	■
5.2 FSI		Gasolina	RWD	5204	419	570	06.21-	
5.2 FSI quattro (DKAC)	PR 1KY, PR 2ED, PR A8U, Performance M	Gasolina	4WD	5204	419	570	09.18-	■
5.2 FSI quattro (CSPA)	-01/16, PR 1KY, PR 2ED, PR A8U, Performance M	Gasolina	4WD	5204	449	610	07.15-	■
5.2 FSI quattro (DKAA)	-01/16, PR 1KY, PR 2ED, PR A8U, Performance M	Gasolina	4WD	5204	449	610	07.15-	■
5.2 FSI quattro (DMWA)	PR 1KY, PR 2ED, PR A8U, Performance M	Gasolina	4WD	5204	456	620	09.18-	■

# LISTA DE APLICACIONES - BUYERS GUIDE

R8 II Spyder (4S9, 4SR) 05.16-						Convertible (Sports car-S Segment)			
5.2 FSI (DKAB)	PR 1KY, PR 2ED, PR A8U, Performance M	Gasolina	RWD	5204	397	540	09.17-		■
5.2 FSI quattro (CSPB)	PR 1KY, PR 2ED, PR A8U, Canada, Performance M	Gasolina	4WD	5204	397	540	05.16-11.21		■
5.2 FSI quattro (DKAB)	PR 1KY, PR 2ED, PR A8U, Canada, Performance M	Gasolina	4WD	5204	397	540	05.16-11.21		■
5.2 FSI		Gasolina	RWD	5204	419	570	06.21-		
5.2 FSI quattro (DKAC)	Performance M	Gasolina	4WD	5204	419	570	09.18-		■
5.2 FSI quattro (CSPA)	PR 1KY, PR 2ED, PR A8U, Performance M	Gasolina	4WD	5204	449	610	05.17-		■
5.2 FSI quattro (DKAA)	PR 1KY, PR 2ED, PR A8U, Performance M	Gasolina	4WD	5204	449	610	05.17-		■
5.2 FSI quattro (DMWA)	Performance M	Gasolina	4WD	5204	456	620	09.18-		■
R8 Spyder (427, 429) 02.10-08.16						Convertible (Sports car-S Segment)			
4.2 FSI quattro (CNDA)	PR 1KY, PR 2ED, Performance M	Gasolina	4WD	4163	316	430	09.10-07.15		■
5.2 FSI quattro (BUJ)	PR 1KY, PR 2ED, Performance M	Gasolina	4WD	5204	386	525	02.10-07.15		■
5.2 FSI quattro (CTYA)	PR 1KY, PR 2ED, Performance M	Gasolina	4WD	5204	386	525	02.10-07.15		■
5.2 FSI		Gasolina	4WD	5204	404	540	07.12-07.15		
5.2 FSI quattro (CMPA)	PR 1KY, PR 2ED, Performance M	Gasolina	4WD	5204	412	560	11.11-07.15		■
5.2 FSI		Gasolina	4WD	5204	419	570	07.12-07.15		
FORD									
GT 06.03-						Coupe (Grand Tourer-S Segment)			
5.4		Gasolina	RWD	5403	368	500	06.03-12.06		■
FORD USA									
GT (U.S.A.) 06.03-12.06						Coupe (Grand Tourer-S Segment)			
5.4		Gasolina	RWD	5403	410	557	06.03-12.06		■
JAGUAR									
F-TYPE (X152) 10.12-						Convertible (Sports car-S Segment)			
2.0 Ti4 (PT204)	Performance M	Gasolina	RWD	1997	221	300	07.17-		■
3.0 SCV6 (306PS)	Performance M	Gasolina	RWD	2995	250	340	10.12-		■
3.0 SCV6 S (306PS)	Performance M	Gasolina	RWD	2995	280	380	10.12-		■
3.0 SCV6 S AWD (306PS)	Performance M	Gasolina	4WD	2995	280	380	12.14-		■
SCV6 400 SPORT (306PS)	Performance M	Gasolina	RWD	2995	294	400	11.16-		■
SCV6 400 SPORT AWD (306PS)	Performance M	Gasolina	4WD	2995	294	400	11.16-		■
5.0 SCV8 P450 (AJ133G2)	Performance M	Gasolina	RWD	5000	331	450	12.19-		■
5.0 SCV8 P450 AWD (AJ133G2)	Performance M	Gasolina	4WD	5000	331	450	12.19-		■
5.0 SCV8 S (508PS)	Performance M	Gasolina	RWD	5000	364	495	10.12-		■
5.0 SCV8 R (508PS)	Performance M	Gasolina	RWD	5000	405	551	10.13-		■
5.0 SCV8 R AWD (508PS)	Performance M	Gasolina	4WD	5000	405	551	12.14-		■
5.0 SCV8 SVR (508PS)	Performance M	Gasolina	RWD	5000	423	575	05.15-		■
5.0 SCV8 SVR / SCV8 P575 R AWD (508PS)	Performance M	Gasolina	4WD	5000	423	575	12.15-		■
5.0 SCV8 SVR / SCV8 P575 R AWD (AJ133G2)	Performance M	Gasolina	4WD	5000	423	575	12.15-		■
F-TYPE (X152) 09.13-						Coupe (Sports car-S Segment)			
3.0 SCV6 (306PS)	Performance M	Gasolina	RWD	2995	250	340	10.13-		■
3.0 SCV6 S (306PS)	Performance M	Gasolina	RWD	2995	280	380	10.13-		■
3.0 SCV6 S AWD (306PS)	Performance M	Gasolina	4WD	2995	280	380	12.14-		■
3.0 SCV6 400 SPORT (306PS)	Performance M	Gasolina	RWD	2995	294	400	11.16-		■
3.0 SCV6 400 SPORT AWD (306PS)	Performance M	Gasolina	4WD	2995	294	400	11.16-		■

# LISTA DE APLICACIONES - BUYERS GUIDE

5.0 SCV8 P450 (AJ133G2)	Performance M	Gasolina	RWD	5000	331	450	12.19-	■
5.0 SCV8 P450 AWD (AJ133G2)	Performance M	Gasolina	4WD	5000	331	450	12.19-	■
5.0 SCV8 R (508PS)	Performance M	Gasolina	RWD	5000	405	551	10.13-	■
5.0 SCV8 R AWD (508PS)	Performance M	Gasolina	4WD	5000	405	551	12.14-	■
5.0 SCV8 SVR / SCV8 P575 R AWD (508PS)	Performance M	Gasolina	4WD	5000	423	575	12.15-	■
5.0 SCV8 SVR / SCV8 P575 R AWD (AJ133G2)	Performance M	Gasolina	4WD	5000	423	575	12.15-	■
<b>S-TYPE II (X200) 10.98-12.08</b>					<b>Saloon (Executive car-E Segment)</b>			
2.5 V6 (AJ25)	Performance M	Gasolina	RWD	2497	147	200	04.02-10.07	■
2.5 V6 (JB (AJ-V6))	Performance M	Gasolina	RWD	2497	147	200	04.02-10.07	■
4.2 V8 (AJ8FT)	Performance M	Gasolina	RWD	4196	219	298	04.02-10.07	■
R 4,2 V8 (AJ8FT)	Performance M	Gasolina	RWD	4196	291	396	04.02-10.07	■
4.2 Supercharged (AJ8FT)	Performance M	Gasolina	RWD	4196	298	405	11.01-12.08	■
2.7 D (AJD)	Performance M	Diesel	RWD	2720	152	207	06.04-10.07	■
<b>XJ (X350, X358) 03.03-03.09</b>					<b>Saloon (Luxury car-F Segment)</b>			
R 4.2 (AJ33SC)	-ch G49700, Performance M	Gasolina	RWD	4196	291	395	03.03-03.09	■
R 4.2 (AJ8FT)	-ch G49700, Performance M	Gasolina	RWD	4196	291	395	03.03-03.09	■
<b>XK II (X150) 03.06-07.14</b>					<b>Convertible (Grand Tourer-S Segment)</b>			
3.6 (RG (AJ-V8))	Performance brakes, Performance M	Gasolina	RWD	3555	190	258	10.07-07.14	■
4.2	Performance brakes, Performance M	Gasolina	FWD	4196	218	296	09.07-12.09	■
4.2 XK8 (AJ8FT)	Performance brakes, Performance M	Gasolina	RWD	4196	219	298	03.06-07.14	■
4.2 XK (AJ8FT)	Performance brakes, Performance M	Gasolina	RWD	4196	224	305	02.08-07.14	■
4.2	Performance brakes, Performance M	Gasolina	RWD	4196	291	396	09.07-12.09	■
4.2 XKR (SV8TS)	Performance brakes, Performance M	Gasolina	RWD	4196	306	416	03.06-07.14	■
4.2 XKR (SV8TS)	Performance brakes, Performance M	Gasolina	RWD	4196	313	426	08.06-07.14	■
5.0 V8 (508PN)	Performance brakes, Performance M	Gasolina	RWD	5000	283	385	01.09-07.14	■
5.0 XKR (508PS)	Performance brakes, Performance M	Gasolina	RWD	5000	375	510	01.09-07.14	■
5.0 XKR-S (508PS)	Performance brakes, Performance M	Gasolina	RWD	5000	405	550	01.11-07.14	■
<b>XK II (X150) 03.06-12.14</b>					<b>Coupe (Grand Tourer-S Segment)</b>			
3.6 (RG (AJ-V8))	Performance brakes, Performance M	Gasolina	RWD	3555	190	258	07.07-07.14	■
4.2	Performance brakes, Performance M	Gasolina	FWD	4196	218	296	09.07-12.09	■
4.2 XK8 (AJ8FT)	Performance brakes, Performance M	Gasolina	RWD	4196	219	298	03.06-07.14	■
4.2 XK (AJ8FT)	Performance brakes, Performance M	Gasolina	RWD	4196	224	305	02.08-07.14	■
4.2 XKR (AJ8FT)	Performance brakes, Performance M	Gasolina	RWD	4196	291	396	03.06-07.14	■
4.2 XKR (SV8TS)	Performance brakes, Performance M	Gasolina	RWD	4196	306	416	03.06-07.14	■
4.2 XKR (SV8TS)	Performance brakes, Performance M	Gasolina	RWD	4196	313	426	08.06-07.14	■
5.0 V8 (508PN)	Performance M	Gasolina	RWD	5000	283	385	01.09-07.14	■
5.0 XKR (508PS)	Performance brakes, Performance M	Gasolina	RWD	5000	375	510	01.09-07.14	■
5.0 XKR (508PS)	Performance M	Gasolina	RWD	5000	390	530	09.10-07.14	■
5.0 XKR-S (508PS)	Performance brakes, Performance M	Gasolina	RWD	5000	405	550	01.11-07.14	■
<b>MASERATI</b>								

# LISTA DE APLICACIONES - BUYERS GUIDE

QUATTROPORTE V 03.04-					Saloon (Sports car-S Segment)			
4.2 (M139 A)	Performance M	Gasolina	RWD	4244	295	400	03.04-	■
4.7 S (M 139 R)	Performance M	Gasolina	RWD	4691	317	431	06.08-	■
4.7 GT S (M 139 L)	Performance M	Gasolina	RWD	4691	323	439	06.08-	■
4.7 GT S (M 139 S)	Performance M	Gasolina	RWD	4691	323	439	06.08-	■
Tesla								
MODEL S (5YJS) 09.12-					Hatchback (Luxury car-F Segment)			
60 (L1S)	Performance M	Eléctrico	RWD		225	306	11.13-09.14	■
60 (L1S)	Performance M	Eléctrico	RWD		235	320	11.16-	■
70 (L1S)	Performance M	Eléctrico	RWD		235	320	09.15-	■
75 (L1S)	Performance M	Eléctrico	RWD		235	320	11.16-	■
60D AWD (L2S)	Performance M	Eléctrico	4WD		245	334	06.16-	■
70D AWD (L2S)	Performance M	Eléctrico	4WD		245	334	04.15-	■
75D AWD	Performance M	Eléctrico	4WD		245	333	06.16-	■
85 (L1S)	Performance M	Eléctrico	RWD		270	367	09.12-02.16	■
90		Eléctrico	RWD		270	367	09.12-02.16	
60D AWD (L2S)	Performance M	Eléctrico	4WD		276	376	10.14-04.15	■
85D AWD (L2S)	Performance M	Eléctrico	4WD		276	376	10.14-02.16	■
85D AWD (L2S)	Performance M	Eléctrico	4WD		279	379	10.14-02.16	■
60 (L1S)	Performance M	Eléctrico	RWD		283	385	10.14-	■
85 (L1S)	Performance M	Eléctrico	RWD		283	385	02.15-02.16	■
60 (L1S)	Performance M	Eléctrico	RWD		285	388	11.13-	■
70 (L1S)	Performance M	Eléctrico	RWD		285	388	09.15-	■
75 (L1S)	Performance M	Eléctrico	RWD		285	388	11.16-	■
85 (L1S)	Performance M	Eléctrico	RWD		285	388	09.12-02.16	■
90		Eléctrico	RWD		285	388	11.15-	■
85D AWD (L2S)	Performance M	Eléctrico	4WD		290	394	10.14-07.15	■
100D AWD (L2S)	Performance M	Eléctrico	4WD		310	422	06.17-	■
85D AWD (L2S)	Performance M	Eléctrico	4WD		310	421	04.15-02.16	■
90D AWD (L2S)	Performance M	Eléctrico	4WD		310	422	09.15-	■
P85 (L1S)	Performance M	Eléctrico	RWD		310	421	11.13-12.14	■
P90D AWD		Eléctrico	4WD		345	469	09.15-	
P90D AWD (L2S)	Performance M	Eléctrico	4WD		346	471	09.15-	■
P85 (L1S)	Performance M	Eléctrico	RWD		350	476	05.13-12.14	■
100D AWD (L2S)	Performance M	Eléctrico	4WD		386	525	06.17-	■
60D AWD (L2S)	Performance M	Eléctrico	4WD		386	525	10.14-	■
70D AWD (L2S)	Performance M	Eléctrico	4WD		386	525	09.15-	■
75D AWD (L2S)	Performance M	Eléctrico	4WD		386	525	06.16-	■
85D AWD (L2S)	Performance M	Eléctrico	4WD		386	525	10.14-02.16	■
90D AWD (L2S)	Performance M	Eléctrico	4WD		386	525	09.15-	■
EV AWD		Eléctrico	4WD		386	525	06.19-	■
P90D AWD (L2S)	Performance M	Eléctrico	4WD		397	540	09.15-	■
P100D AWD (L2S)	Performance M	Eléctrico	4WD		450	612	10.16-	■
P85D AWD (L2S)	Performance M	Eléctrico	4WD		515	700	10.14-02.16	■
P85D AWD (L2S)	Performance M	Eléctrico	4WD		543	738	10.14-10.15	■
EV AWD		Eléctrico	4WD		568	772	06.19-	■
P100D AWD (L2S)	Performance M	Eléctrico	4WD		568	772	10.16-	■
P85D AWD (L2S)	Performance M	Eléctrico	4WD		568	772	09.15-02.16	■
P90D AWD	Performance M	Eléctrico	4WD		568	772	09.15-	■

# LISTA DE APLICACIONES - BUYERS GUIDE

MODEL X (5YJX) 09.13-					Hatchback (Luxury Crossover SUV-J Segment)			
100D AWD (L2S)	Performance M	Eléctrico	4WD		386	525	08.17-	■
60D AWD (L2S)	Performance M	Eléctrico	4WD		386	525	06.16-	■
75D AWD (L2S)	Performance M	Eléctrico	4WD		386	525	06.16-	■
90D AWD (L2S)	Performance M	Eléctrico	4WD		386	525	09.15-	■
EV AWD		Eléctrico	4WD		386	525	06.19-	■
EV AWD		Eléctrico	4WD		413	562	06.19-	■
EV AWD		Eléctrico	4WD		421	573	09.19-	■
EV AWD		Eléctrico	4WD		568	772	06.19-	■
P100D AWD (L2S)	Performance M	Eléctrico	4WD		568	772	10.16-	■
P90D AWD (L2S)	Performance M	Eléctrico	4WD		568	772	09.15-	■
EV AWD		Eléctrico	4WD		585	796	06.19-	■
EV AWD		Eléctrico	4WD		599	815	09.20-	■