

LISTA DE APLICACIONES - BUYERS GUIDE

31380-6767



8 424073 104113

Weight: 17.215

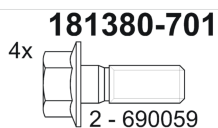
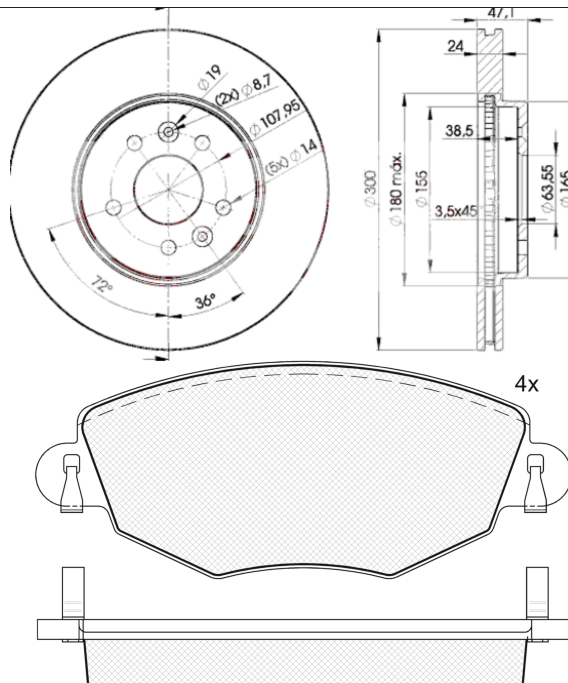

31380-6767



Bosch

148.9x60.6x18.5

Ø300x24x47.2

WVA

23279

MAKE

FORD

JAGUAR



Trac.

CC

Kw

CV



Front / Rear

FORD

MONDEO III (B5Y) 10.00-03.07

Hatchback (Large family car-D Segment)

1.8 16V (CGBA)		Gasolina	FWD	1798	81	110	10.00-03.07	■
1.8 16V (CGBA)		Gasolina	FWD	1798	81	110	10.00-03.07	■
1.8 16V (CGBB)		Gasolina	FWD	1798	81	110	10.00-03.07	■
1.8 16V (CGBB)		Gasolina	FWD	1798	81	110	10.00-03.07	■
1.8 16V (CHBA)		Gasolina	FWD	1798	92	125	10.00-03.07	■
1.8 16V (CHBA)		Gasolina	FWD	1798	92	125	10.00-03.07	■
1.8 16V (CHBB)		Gasolina	FWD	1798	92	125	10.00-03.07	■
1.8 16V (CHBB)		Gasolina	FWD	1798	92	125	10.00-03.07	■
1.8 SCi (CFBA)		Gasolina	FWD	1798	96	130	06.03-03.07	■
1.8 SCi (CFBA)		Gasolina	FWD	1798	96	130	06.03-03.07	■
2.0 16V (CJBA)		Gasolina	FWD	1999	107	146	10.00-03.07	■
2.0 16V (CJBA)		Gasolina	FWD	1999	107	146	10.00-03.07	■
2.0 16V (CJBB)		Gasolina	FWD	1999	107	146	10.00-03.07	■
2.0 16V (CJBB)		Gasolina	FWD	1999	107	146	10.00-03.07	■
2.5 V6 24V (LCBD)		Gasolina	FWD	2495	125	170	10.00-03.07	■
2.5 V6 24V (LCBD)		Gasolina	FWD	2495	125	170	10.00-03.07	■
3.0 V6 24V (REBA)		Gasolina	FWD	2967	150	204	09.04-03.07	■
3.0 V6 24V (REBA)		Gasolina	FWD	2967	150	204	09.04-03.07	■
ST220 (MEBA)		Gasolina	FWD	2967	166	226	04.02-03.07	■
ST220 (MEBA)		Gasolina	FWD	2967	166	226	04.02-03.07	■
2.0 16V DI / TDDi / TDCi (D5BA)		Diesel	FWD	1998	66	90	10.00-03.07	■
2.0 16V DI / TDDi / TDCi (D5BA)		Diesel	FWD	1998	66	90	10.00-03.07	■
2.0 16V DI / TDDi / TDCi (SDBA)		Diesel	FWD	1998	66	90	10.00-03.07	■

LISTA DE APLICACIONES - BUYERS GUIDE

2.0 16V DI / TDDi / TDCi (SDBA)	Diesel	FWD	1998	66	90	10.00-03.07	■
2.0 16V TDDi / TDCi (D6BA)	Diesel	FWD	1998	85	115	10.00-03.07	■
2.0 16V TDDi / TDCi (D6BA)	Diesel	FWD	1998	85	115	10.00-03.07	■
2.0 16V TDDi / TDCi (HJBA)	Diesel	FWD	1998	85	115	10.00-03.07	■
2.0 16V TDDi / TDCi (HJBA)	Diesel	FWD	1998	85	115	10.00-03.07	■
2.0 16V TDDi / TDCi (HJBB)	Diesel	FWD	1998	85	115	10.00-03.07	■
2.0 16V TDDi / TDCi (HJBB)	Diesel	FWD	1998	85	115	10.00-03.07	■
2.0 16V TDDi / TDCi (HJBC)	Diesel	FWD	1998	85	115	10.00-03.07	■
2.0 16V TDDi / TDCi (HJBC)	Diesel	FWD	1998	85	115	10.00-03.07	■
2.0 TDCi	Diesel	RWD	1998	92	125	02.03-06.05	■
2.0 TDCi	Diesel	RWD	1998	92	125	02.03-06.05	■
2.0 TDCi (FMBA)	Diesel	FWD	1998	96	130	10.01-03.07	■
2.0 TDCi (FMBA)	Diesel	FWD	1998	96	130	10.01-03.07	■
2.0 TDCi (N7BA)	Diesel	FWD	1998	96	130	10.01-03.07	■
2.0 TDCi (N7BA)	Diesel	FWD	1998	96	130	10.01-03.07	■
2.0 TDCi (N7BB)	Diesel	FWD	1998	96	130	10.01-03.07	■
2.0 TDCi (N7BB)	Diesel	FWD	1998	96	130	10.01-03.07	■
2.2 TDCi (QJBC)	Diesel	FWD	2198	110	150	09.04-03.07	■
2.2 TDCi (QJBC)	Diesel	FWD	2198	110	150	09.04-03.07	■
2.2 TDCi (QJBD)	Diesel	FWD	2198	110	150	09.04-03.07	■
2.2 TDCi (QJBD)	Diesel	FWD	2198	110	150	09.04-03.07	■
2.2 TDCi (QJBA)	Diesel	FWD	2198	114	155	09.04-03.07	■
2.2 TDCi (QJBA)	Diesel	FWD	2198	114	155	09.04-03.07	■
2.2 TDCi (QJBB)	Diesel	FWD	2198	114	155	09.04-03.07	■
2.2 TDCi (QJBB)	Diesel	FWD	2198	114	155	09.04-03.07	■
MONDEO III (B4Y) 10.00-09.07				Saloon (Large family car-D Segment)			
1.8 16V (CGBA)	Gasolina	FWD	1798	81	110	10.00-03.07	■
1.8 16V (CGBA)	Gasolina	FWD	1798	81	110	10.00-03.07	■
1.8 16V (CGBB)	Gasolina	FWD	1798	81	110	10.00-03.07	■
1.8 16V (CGBB)	Gasolina	FWD	1798	81	110	10.00-03.07	■
1.8 16V (CHBA)	Gasolina	FWD	1798	92	125	10.00-03.07	■
1.8 16V (CHBA)	Gasolina	FWD	1798	92	125	10.00-03.07	■
1.8 16V (CHBB)	Gasolina	FWD	1798	92	125	10.00-03.07	■
1.8 16V (CHBB)	Gasolina	FWD	1798	92	125	10.00-03.07	■
1.8 SCi (CFBA)	Gasolina	FWD	1798	96	130	06.03-03.07	■
1.8 SCi (CFBA)	Gasolina	FWD	1798	96	130	06.03-03.07	■
2.0 16V (CJBA)	Gasolina	FWD	1999	107	146	10.00-03.07	■
2.0 16V (CJBA)	Gasolina	FWD	1999	107	146	10.00-03.07	■
2.0 16V (CJBB)	Gasolina	FWD	1999	107	146	10.00-03.07	■
2.0 16V (CJBB)	Gasolina	FWD	1999	107	146	10.00-03.07	■
2.5 V6 24V (LCBD)	Gasolina	FWD	2495	125	170	10.00-03.07	■
2.5 V6 24V (LCBD)	Gasolina	FWD	2495	125	170	10.00-03.07	■
3.0 V6 24V (REBA)	Gasolina	FWD	2967	150	204	09.04-03.07	■
3.0 V6 24V (REBA)	Gasolina	FWD	2967	150	204	09.04-03.07	■
ST220 (MEBA)	Gasolina	FWD	2967	166	226	04.02-03.07	■
ST220 (MEBA)	Gasolina	FWD	2967	166	226	04.02-03.07	■
2.0 16V DI / TDDi / TDCi (D5BA)	Diesel	FWD	1998	66	90	10.00-03.07	■
2.0 16V DI / TDDi / TDCi (D5BA)	Diesel	FWD	1998	66	90	10.00-03.07	■
2.0 16V DI / TDDi / TDCi (SDBA)	Diesel	FWD	1998	66	90	10.00-03.07	■
2.0 16V DI / TDDi / TDCi (SDBA)	Diesel	FWD	1998	66	90	10.00-03.07	■
2.0 16V TDDi / TDCi (D6BA)	Diesel	FWD	1998	85	115	10.00-03.07	■

LISTA DE APLICACIONES - BUYERS GUIDE

2.0 16V TDDi / TDCi (D6BA)	Diesel	FWD	1998	85	115	10.00-03.07	■
2.0 16V TDDi / TDCi (HJBA)	Diesel	FWD	1998	85	115	10.00-03.07	■
2.0 16V TDDi / TDCi (HJBA)	Diesel	FWD	1998	85	115	10.00-03.07	■
2.0 16V TDDi / TDCi (HJBB)	Diesel	FWD	1998	85	115	10.00-03.07	■
2.0 16V TDDi / TDCi (HJBB)	Diesel	FWD	1998	85	115	10.00-03.07	■
2.0 16V TDDi / TDCi (HJBC)	Diesel	FWD	1998	85	115	10.00-03.07	■
2.0 16V TDDi / TDCi (HJBC)	Diesel	FWD	1998	85	115	10.00-03.07	■
2.0 DI	Diesel	FWD	1998	92	125	10.00-03.07	■
2.0 DI	Diesel	FWD	1998	92	125	10.00-03.07	■
2.0 TDCi (FMBA)	Diesel	FWD	1998	96	130	10.01-03.07	■
2.0 TDCi (FMBA)	Diesel	FWD	1998	96	130	10.01-03.07	■
2.0 TDCi (N7BA)	Diesel	FWD	1998	96	130	10.01-03.07	■
2.0 TDCi (N7BA)	Diesel	FWD	1998	96	130	10.01-03.07	■
2.0 TDCi (N7BB)	Diesel	FWD	1998	96	130	10.01-03.07	■
2.0 TDCi (N7BB)	Diesel	FWD	1998	96	130	10.01-03.07	■
2.2 TDCi (QJBC)	Diesel	FWD	2198	110	150	09.04-03.07	■
2.2 TDCi (QJBC)	Diesel	FWD	2198	110	150	09.04-03.07	■
2.2 TDCi (QJBD)	Diesel	FWD	2198	110	150	09.04-03.07	■
2.2 TDCi (QJBD)	Diesel	FWD	2198	110	150	09.04-03.07	■
2.2 TDCi (QJBA)	Diesel	FWD	2198	114	155	09.04-03.07	■
2.2 TDCi (QJBA)	Diesel	FWD	2198	114	155	09.04-03.07	■
2.2 TDCi (QJBB)	Diesel	FWD	2198	114	155	09.04-03.07	■
2.2 TDCi (QJBB)	Diesel	FWD	2198	114	155	09.04-03.07	■
MONDEO III Turnier (BWY) 10.00-03.07					Estate (Large family car-D Segment)		
1.8 16V (CGBA)	Gasolina	FWD	1798	81	110	10.00-03.07	■
1.8 16V (CGBA)	Gasolina	FWD	1798	81	110	10.00-03.07	■
1.8 16V (CGBB)	Gasolina	FWD	1798	81	110	10.00-03.07	■
1.8 16V (CGBB)	Gasolina	FWD	1798	81	110	10.00-03.07	■
1.8 16V (CHBA)	Gasolina	FWD	1798	92	125	10.00-03.07	■
1.8 16V (CHBA)	Gasolina	FWD	1798	92	125	10.00-03.07	■
1.8 16V (CHBB)	Gasolina	FWD	1798	92	125	10.00-03.07	■
1.8 16V (CHBB)	Gasolina	FWD	1798	92	125	10.00-03.07	■
1.8 SCi (CFBA)	Gasolina	FWD	1798	96	130	06.03-03.07	■
1.8 SCi (CFBA)	Gasolina	FWD	1798	96	130	06.03-03.07	■
2.0 16V (CJBA)	Gasolina	FWD	1999	107	146	10.00-03.07	■
2.0 16V (CJBA)	Gasolina	FWD	1999	107	146	10.00-03.07	■
2.0 16V (CJBB)	Gasolina	FWD	1999	107	146	10.00-03.07	■
2.0 16V (CJBB)	Gasolina	FWD	1999	107	146	10.00-03.07	■
2.5 V6 24V (LCBD)	Gasolina	FWD	2495	125	170	10.00-03.07	■
2.5 V6 24V (LCBD)	Gasolina	FWD	2495	125	170	10.00-03.07	■
3.0 V6 24V (REBA)	Gasolina	FWD	2967	150	204	09.04-03.07	■
3.0 V6 24V (REBA)	Gasolina	FWD	2967	150	204	09.04-03.07	■
ST220 (MEBA)	Gasolina	FWD	2967	166	226	04.02-03.07	■
ST220 (MEBA)	Gasolina	FWD	2967	166	226	04.02-03.07	■
2.0 16V DI / TDDi / TDCi (D5BA)	Diesel	FWD	1998	66	90	10.00-03.07	■
2.0 16V DI / TDDi / TDCi (D5BA)	Diesel	FWD	1998	66	90	10.00-03.07	■
2.0 16V DI / TDDi / TDCi (SDBA)	Diesel	FWD	1998	66	90	10.00-03.07	■
2.0 16V DI / TDDi / TDCi (SDBA)	Diesel	FWD	1998	66	90	10.00-03.07	■
2.0 16V TDDi / TDCi (D6BA)	Diesel	FWD	1998	85	115	10.00-03.07	■
2.0 16V TDDi / TDCi (D6BA)	Diesel	FWD	1998	85	115	10.00-03.07	■
2.0 16V TDDi / TDCi (HJBA)	Diesel	FWD	1998	85	115	10.00-03.07	■

LISTA DE APLICACIONES - BUYERS GUIDE

2.0 16V TDDi / TDCi (HJBA)		Diesel	FWD	1998	85	115	10.00-03.07	■
2.0 16V TDDi / TDCi (HJBB)		Diesel	FWD	1998	85	115	10.00-03.07	■
2.0 16V TDDi / TDCi (HJBB)		Diesel	FWD	1998	85	115	10.00-03.07	■
2.0 16V TDDi / TDCi (HJBC)		Diesel	FWD	1998	85	115	10.00-03.07	■
2.0 16V TDDi / TDCi (HJBC)		Diesel	FWD	1998	85	115	10.00-03.07	■
2.0 TDCi (FMBA)		Diesel	FWD	1998	96	130	10.01-03.07	■
2.0 TDCi (FMBA)		Diesel	FWD	1998	96	130	10.01-03.07	■
2.0 TDCi (N7BA)		Diesel	FWD	1998	96	130	10.01-03.07	■
2.0 TDCi (N7BA)		Diesel	FWD	1998	96	130	10.01-03.07	■
2.0 TDCi (N7BB)		Diesel	FWD	1998	96	130	10.01-03.07	■
2.0 TDCi (N7BB)		Diesel	FWD	1998	96	130	10.01-03.07	■
2.2 TDCi (QJBA)		Diesel	FWD	2198	114	155	09.04-03.07	■
2.2 TDCi (QJBA)		Diesel	FWD	2198	114	155	09.04-03.07	■
2.2 TDCi (QJBB)		Diesel	FWD	2198	114	155	09.04-03.07	■
2.2 TDCi (QJBB)		Diesel	FWD	2198	114	155	09.04-03.07	■
JAGUAR								
X-TYPE (X400) 09.03-12.09					Estate (Compact executive car-D Segment)			
2.1 V6 (YB (AJ-V6))		Gasolina	FWD	2099	115	156	11.03-03.09	■
2.1 V6 (YB (AJ-V6))		Gasolina	FWD	2099	115	156	11.03-03.09	■
2.5 (XB (AJ-V6))		Gasolina	4WD	2495	144	196	02.04-12.09	■
2.5 (XB (AJ-V6))		Gasolina	4WD	2495	144	196	02.04-12.09	■
3.0 (AJ-V6)		Gasolina	4WD	2967	169	230	02.04-12.09	■
3.0 (AJ-V6)		Gasolina	4WD	2967	169	230	02.04-12.09	■
2.0 D (FMBA)	-12/05	Diesel	FWD	1998	96	130	02.04-12.09	■
2.0 D (FMBA)	-12/05	Diesel	FWD	1998	96	130	02.04-12.09	■
2.0 D (FMBB)	-12/05	Diesel	FWD	1998	96	130	02.04-12.09	■
2.0 D (FMBB)	-12/05	Diesel	FWD	1998	96	130	02.04-12.09	■
2.2 D (QJBA)		Diesel	FWD	2198	114	155	10.05-12.09	■
2.2 D (QJBA)		Diesel	FWD	2198	114	155	10.05-12.09	■
X-TYPE (X400) 03.01-11.09					Saloon (Compact executive car-D Segment)			
2.1 V6 (YB (AJ-V6))		Gasolina	FWD	2099	115	156	03.02-11.09	■
2.1 V6 (YB (AJ-V6))		Gasolina	FWD	2099	115	156	03.02-11.09	■
2.5 V6 A las 4 ruedas (XB (AJ-V6))	-12/05	Gasolina	4WD	2495	144	196	06.01-11.09	■
2.5 V6 A las 4 ruedas (XB (AJ-V6))	-12/05	Gasolina	4WD	2495	144	196	06.01-11.09	■
3.0 V6 A las 4 ruedas (AJ-V6)	-12/05	Gasolina	4WD	2967	169	230	06.01-12.08	■
3.0 V6 A las 4 ruedas (AJ-V6)	-12/05	Gasolina	4WD	2967	169	230	06.01-12.08	■
2.0 D (FMBA)		Diesel	FWD	1998	96	130	07.03-11.09	■
2.0 D (FMBA)		Diesel	FWD	1998	96	130	07.03-11.09	■
2.0 D (FMBB)		Diesel	FWD	1998	96	130	07.03-11.09	■
2.0 D (FMBB)		Diesel	FWD	1998	96	130	07.03-11.09	■
2.2 D (QJBA)		Diesel	FWD	2198	114	155	10.05-11.09	■
2.2 D (QJBA)		Diesel	FWD	2198	114	155	10.05-11.09	■