

LISTA DE APLICACIONES - BUYERS GUIDE

31406-4753

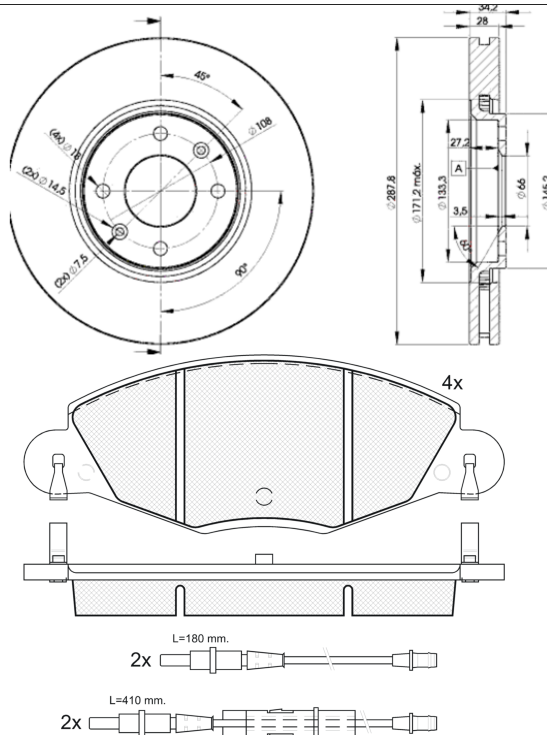

Weight: 18.562



181406-701



31406-4753



Bosch

168.8x63.3x18

Ø289x28x34

WVA

23272

23273

MAKE

CITROËN



Trac.	CC	Kw	CV
-------	----	----	----



Front / Rear

CITROËN

C5 (DE_) 06.01-09.04

Estate (Large family car-D Segment)

3.0 V6 (DEXFXC, DEXFXF) (XFX (ES9J4S))	Gasolina	FWD	2946	152	207	06.01-08.04	■
3.0 V6 (DEXFXC, DEXFXF) (XFX (ES9J4S))	Gasolina	FWD	2946	152	207	06.01-08.04	■
3.0 V6 (REXFUF) (XFU (ES9A))	Gasolina	FWD	2946	152	207	09.04-01.08	■
3.0 V6 (REXFUF) (XFU (ES9A))	Gasolina	FWD	2946	152	207	09.04-01.08	■
3.0 Carlsson (XFX (ES9J4S))	Gasolina	FWD	2946	173	235	09.03-08.04	■
3.0 Carlsson (XFX (ES9J4S))	Gasolina	FWD	2946	173	235	09.03-08.04	■
2.2 HDi (DE4HXB, DE4HXE) (4HX (DW12TED4))	Diesel	FWD	2179	98	133	06.01-08.04	■
2.2 HDi (DE4HXB, DE4HXE) (4HX (DW12TED4))	Diesel	FWD	2179	98	133	06.01-08.04	■
2.2 HDi (RE4HXE) (4HX (DW12TED4))	Diesel	FWD	2179	98	133	09.04-09.06	■
2.2 HDi (RE4HXE) (4HX (DW12TED4))	Diesel	FWD	2179	98	133	09.04-09.06	■

C5 (DC_) 03.01-03.05

Hatchback (Large family car-D Segment)

3.0 V6 (DCXFXC, DCXFXF) (XFX (ES9J4S))	Gasolina	FWD	2946	152	207	03.01-08.04	■
3.0 V6 (DCXFXC, DCXFXF) (XFX (ES9J4S))	Gasolina	FWD	2946	152	207	03.01-08.04	■
3.0 V6 (RCXFUF) (XFU (ES9A))	Gasolina	FWD	2946	152	207	09.04-09.08	■
3.0 V6 (RCXFUF) (XFU (ES9A))	Gasolina	FWD	2946	152	207	09.04-09.08	■
3.0 V6 (RCXFUF) (XFX (ES9J4S))	Gasolina	FWD	2946	152	207	09.04-09.08	■
3.0 V6 (RCXFUF) (XFX (ES9J4S))	Gasolina	FWD	2946	152	207	09.04-09.08	■
2.2 HDi (DC4HXB, DC4HXE) (4HX (DW12TED4))	Diesel	FWD	2179	98	133	03.01-08.04	■
2.2 HDi (DC4HXB, DC4HXE) (4HX (DW12TED4))	Diesel	FWD	2179	98	133	03.01-08.04	■
2.2 HDi (RC4HXE) (4HX (DW12TED4))	Diesel	FWD	2179	98	133	09.04-08.08	■
2.2 HDi (RC4HXE) (4HX (DW12TED4))	Diesel	FWD	2179	98	133	09.04-08.08	■

