

LISTA DE APLICACIONES - BUYERS GUIDE

31434-2891



8 424073 162656

Weight: 12.698

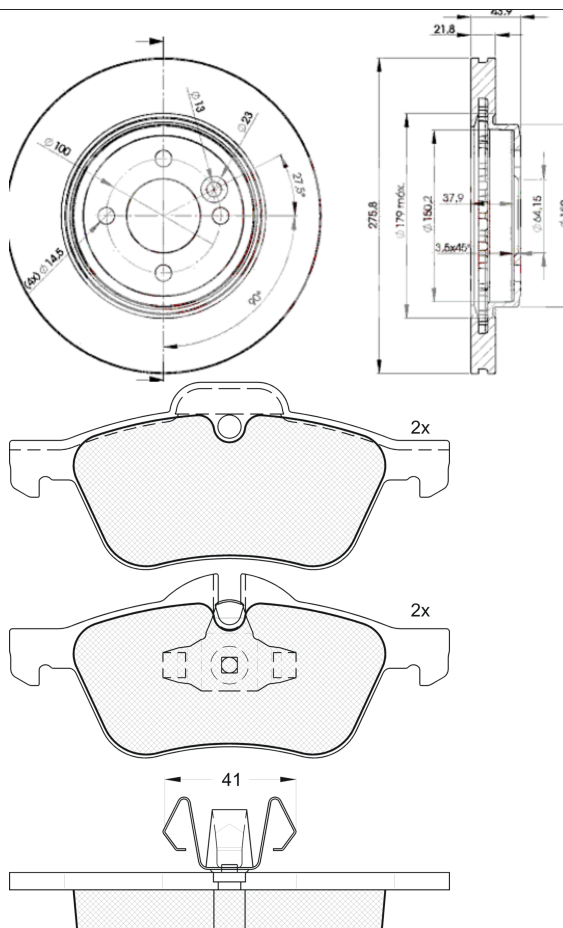

31434-2891



Ate - Teves

140.2x58.7x18.3

Ø276x22x44.2

WVA

23281

23282

MAKE

MINI



Trac.

CC

Kw

CV



Front / Rear

MINI

MINI (R52) 04.04-07.08

					Convertible (Supermini car-B Segment)				
One (W10 B16 A)		Gasolina	FWD	1598	66	90	07.04-11.07	■	
One (W10 B16 A)		Gasolina	FWD	1598	66	90	07.04-11.07	■	
Cooper (W10 B16 A)		Gasolina	FWD	1598	85	116	04.04-07.08	■	
Cooper (W10 B16 A)		Gasolina	FWD	1598	85	116	04.04-07.08	■	
Cooper S (W11 B16 A)		Gasolina	FWD	1598	125	170	07.04-07.08	■	
Cooper S (W11 B16 A)		Gasolina	FWD	1598	125	170	07.04-07.08	■	
John Cooper Works (W11 B16 A)		Gasolina	FWD	1598	155	210	07.04-11.07	■	
John Cooper Works (W11 B16 A)		Gasolina	FWD	1598	155	210	07.04-11.07	■	

MINI (R50, R53) 06.01-09.06

					Hatchback (Supermini car-B Segment)				
One (W10 B14 A)		Gasolina	FWD	1398	55	75	04.03-09.06	■	
One (W10 B14 A)		Gasolina	FWD	1398	55	75	04.03-09.06	■	
One (W10 B16 A)		Gasolina	FWD	1598	66	90	06.01-09.06	■	
One (W10 B16 A)		Gasolina	FWD	1598	66	90	06.01-09.06	■	
Cooper (W10 B16 A)		Gasolina	FWD	1598	85	116	06.01-09.06	■	
Cooper (W10 B16 A)		Gasolina	FWD	1598	85	116	06.01-09.06	■	
Cooper S (W11 B16 A)		Gasolina	FWD	1598	120	163	03.02-09.06	■	
Cooper S (W11 B16 A)		Gasolina	FWD	1598	120	163	03.02-09.06	■	
Cooper S (W11 B16 A)		Gasolina	FWD	1598	125	170	07.04-09.06	■	
Cooper S (W11 B16 A)		Gasolina	FWD	1598	125	170	07.04-09.06	■	
Works (W11 B16 A)		Gasolina	FWD	1598	155	210	11.03-09.06	■	
Works (W11 B16 A)		Gasolina	FWD	1598	155	210	11.03-09.06	■	
One D (1ND)		Diesel	FWD	1364	55	75	06.03-09.06	■	

LISTA DE APLICACIONES - BUYERS GUIDE

One D (1ND)	Diesel	FWD	1364	55	75	06.03-09.06	■
One D (W17 D14 (1ND))	Diesel	FWD	1364	65	88	06.03-09.06	■
One D (W17 D14 (1ND))	Diesel	FWD	1364	65	88	06.03-09.06	■