

LISTA DE APLICACIONES - BUYERS GUIDE

31439-4694

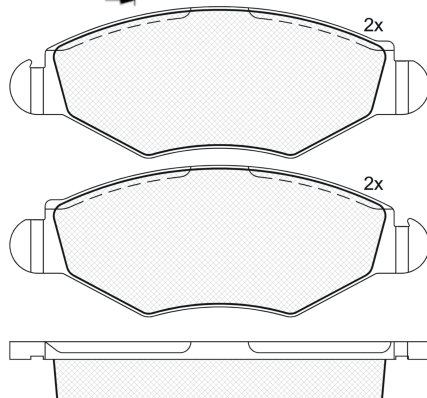

Weight: 10.505

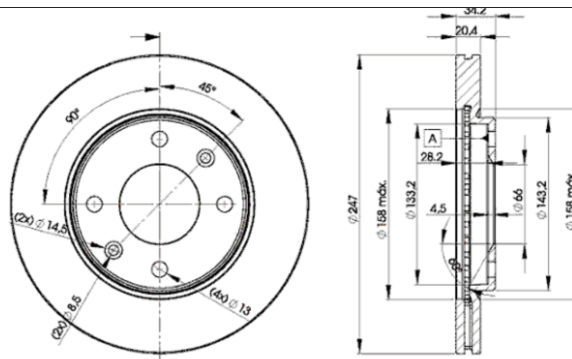

181439-702

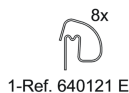
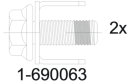

1-Ref. 640121 E

31439-4694



Bosch

131x47.3x18

Ø247x20.4x34.2

WVA

23597

MAKE

PEUGEOT



Trac.	CC	Kw	CV
-------	----	----	----



Front / Rear

PEUGEOT

206 (2A/C) 08.98-

Hatchback (Supermini car-B Segment)

Model	Year	Engine	Drive	CC	Kw	CV	Period	Front	Rear
1.4 i (KFW (TU3A))	01/00-	Gasolina	FWD	1360	55	75	09.98-12.12	■	■
1.4 i (KFW (TU3A))	01/00-	Gasolina	FWD	1360	55	75	09.98-12.12	■	■
1.4 i (KFW (TU3JP))	01/00-	Gasolina	FWD	1360	55	75	09.98-12.12	■	■
1.4 i (KFW (TU3JP))	01/00-	Gasolina	FWD	1360	55	75	09.98-12.12	■	■
1.4 i (KFX (TU3JP))	01/00-	Gasolina	FWD	1360	55	75	09.98-12.12	■	■
1.4 i (KFX (TU3JP))	01/00-	Gasolina	FWD	1360	55	75	09.98-12.12	■	■
1.4 16V (KFU (ET3J4))	-12/06	Gasolina	FWD	1360	65	88	10.03-02.08	■	■
1.4 16V (KFU (ET3J4))	-12/06	Gasolina	FWD	1360	65	88	10.03-02.08	■	■
1.6 i (NFZ (TU5JP))	01/00-	Gasolina	FWD	1587	65	89	09.98-12.00	■	■
1.6 i (NFZ (TU5JP))	01/00-	Gasolina	FWD	1587	65	89	09.98-12.00	■	■
1.4 HDi eco 70 (8HX (DV4TD))	-12/06	Diesel	FWD	1398	50	68	09.01-04.09	■	■
1.4 HDi eco 70 (8HX (DV4TD))	-12/06	Diesel	FWD	1398	50	68	09.01-04.09	■	■
1.4 HDi eco 70 (8HZ (DV4TD))	-12/06	Diesel	FWD	1398	50	68	09.01-04.09	■	■
1.4 HDi eco 70 (8HZ (DV4TD))	-12/06	Diesel	FWD	1398	50	68	09.01-04.09	■	■
1.9 D (WJY (DW8B))	01/00-	Diesel	FWD	1868	51	69	09.98-11.01	■	■
1.9 D (WJY (DW8B))	01/00-	Diesel	FWD	1868	51	69	09.98-11.01	■	■
1.9 D (WJZ (DW8))	01/00-	Diesel	FWD	1868	51	69	09.98-11.01	■	■
1.9 D (WJZ (DW8))	01/00-	Diesel	FWD	1868	51	69	09.98-11.01	■	■

206 03.07-

Saloon (Supermini car-B Segment)

Model	Year	Engine	Drive	CC	Kw	CV	Period	Front	Rear
1.4 (KFV (TU3A))		Gasolina	FWD	1360	55	75	03.07-	■	■
1.4 (KFV (TU3A))		Gasolina	FWD	1360	55	75	03.07-	■	■
1.4 (KFW (TU3JP))		Gasolina	FWD	1360	55	75	03.07-	■	■

LISTA DE APLICACIONES - BUYERS GUIDE

1.4 (KFW (TU3JP))	Gasolina	FWD	1360	55	75	03.07-
-------------------	----------	-----	------	----	----	--------

