

LISTA DE APLICACIONES - BUYERS GUIDE

31678-0111

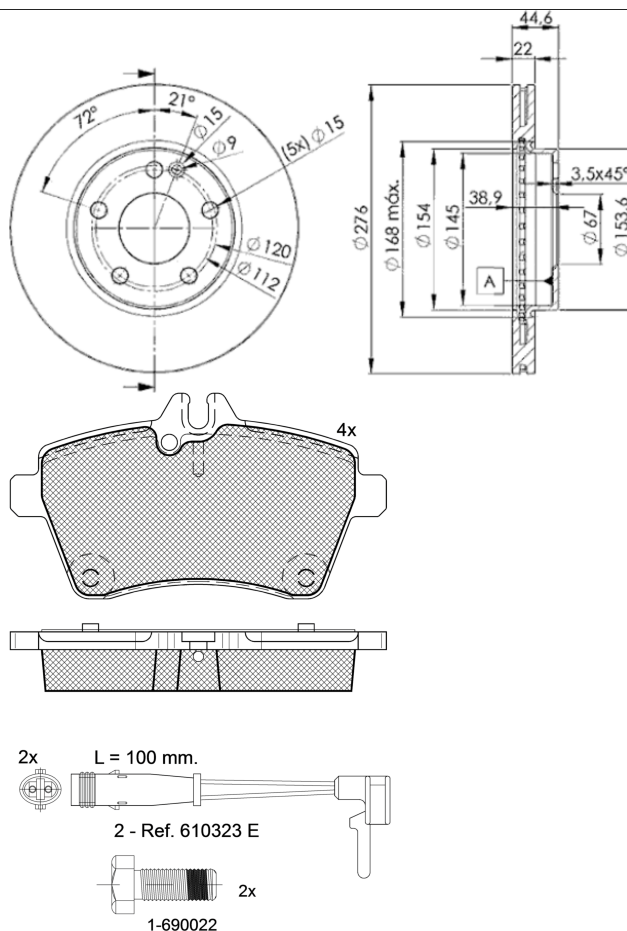

Weight: 14.095



31678-0111



Trw

116.5x63.8x19

Ø276x22x44.6

WVA

24077

MAKE

MERCEDES-BENZ



| Trac. | CC | Kw | CV |
|-------|----|----|----|
|-------|----|----|----|



Front / Rear

MERCEDES-BENZ

A-Class II (W169) 04.04-06.12

Hatchback (Compact car-C Segment)

| | | | | | | | |
|---|----------|-----|------|-----|-----|-------------|---|
| A 170 (169.032, 169.332) (M 266.940) | Gasolina | FWD | 1699 | 85 | 116 | 09.04-06.12 | ■ |
| A 170 (169.032, 169.332) (M 266.940) | Gasolina | FWD | 1699 | 85 | 116 | 09.04-06.12 | ■ |
| A 200 (169.033, 169.333) (M 266.960) | Gasolina | FWD | 2034 | 100 | 136 | 09.04-06.12 | ■ |
| A 200 (169.033, 169.333) (M 266.960) | Gasolina | FWD | 2034 | 100 | 136 | 09.04-06.12 | ■ |
| A 180 CDI (169.007, 169.307) (OM 640.940) | Diesel | FWD | 1991 | 80 | 109 | 09.04-06.12 | ■ |
| A 180 CDI (169.007, 169.307) (OM 640.940) | Diesel | FWD | 1991 | 80 | 109 | 09.04-06.12 | ■ |

B-Class Sports Tourer (W245) 03.05-11.11

Hatchback (Compact MPV-M1 Segment)

| | | | | | | | |
|-----------------------------|----------|-----|------|----|-----|-------------|---|
| B 150 (245.231) (M 266.920) | Gasolina | FWD | 1498 | 70 | 95 | 03.05-11.11 | ■ |
| B 150 (245.231) (M 266.920) | Gasolina | FWD | 1498 | 70 | 95 | 03.05-11.11 | ■ |
| B 170 (245.232) (M 266.940) | Gasolina | FWD | 1699 | 85 | 116 | 03.05-11.11 | ■ |
| B 170 (245.232) (M 266.940) | Gasolina | FWD | 1699 | 85 | 116 | 03.05-11.11 | ■ |