

LISTA DE APLICACIONES - BUYERS GUIDE

78BD0031-2



Weight: 11.032

| O.E.M. | MAKE |
|-------------|--------|
| 26300-AE040 | SUBARU |
| 26300-AE090 | SUBARU |
| 26310-AA021 | SUBARU |
| 26310-AA031 | SUBARU |
| 26310-AA032 | SUBARU |
| 26310-AC060 | SUBARU |

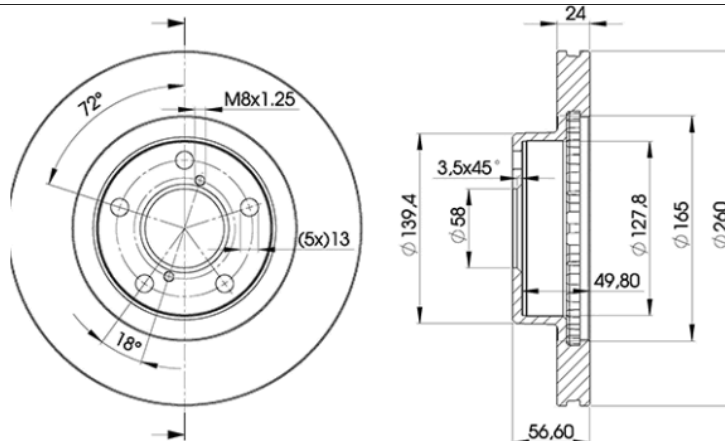

78BD0031-2

E1 90R-02C0452/0077



Ø260x24x56.6

MAKE
SUBARU



| Trac. | CC | Kw | CV | |
|-------|----|----|----|--------------|
| | | | | Front / Rear |

SUBARU

IMPREZA (GFC) 01.93-12.00

| | | | | | | Coupe (Compact car-C Segment) | | | |
|-----------------------------|-----------------------------------|----------|-----|------|-----|-------------------------------|-------------|---|--|
| 1.6 (GC4) (EJ161) | -12/98, vehicles with ABS, Rim 14 | Gasolina | FWD | 1597 | 66 | 90 | 12.96-12.00 | ■ | |
| 1.6 (GC4) (EJ16E) | -12/98, vehicles with ABS, Rim 14 | Gasolina | FWD | 1597 | 66 | 90 | 12.96-12.00 | ■ | |
| 1.6 AWD (GC4) (EJ161) | -12/98, Rim 14 | Gasolina | 4WD | 1597 | 66 | 90 | 12.96-12.00 | ■ | |
| 1.8 (EJ18) | | Gasolina | FWD | 1820 | 76 | 103 | 01.93-10.95 | ■ | |
| 2.0 | -12/98 | Gasolina | FWD | 1994 | 85 | 116 | 11.95-09.00 | ■ | |
| 2.0 AWD (GC8) (EJ201) | -12/98 | Gasolina | 4WD | 1994 | 85 | 115 | 12.95-12.00 | ■ | |
| 2.0 AWD (GC8) (EJ20E) | -12/98 | Gasolina | 4WD | 1994 | 85 | 115 | 12.95-12.00 | ■ | |
| 2.0 (GC8) | -12/98 | Gasolina | FWD | 1994 | 92 | 125 | 09.98-09.00 | ■ | |
| 2.0 Turbo AWD (GC8) (EJ20G) | -12/98 | Gasolina | 4WD | 1994 | 155 | 211 | 12.96-12.00 | ■ | |

IMPREZA (GF) 08.92-12.00

| | | | | | | Estate (Compact car-C Segment) | | | |
|-------------------------|------------------------|----------|-----|------|----|--------------------------------|-------------|---|--|
| 1.5 L (GF1) (EJ151) | | Gasolina | FWD | 1493 | 66 | 90 | 09.98-09.00 | ■ | |
| 1.5 L (GF1) | | Gasolina | FWD | 1493 | 70 | 95 | 11.95-08.98 | ■ | |
| 1.6 (GF3) (EJ161) | | Gasolina | FWD | 1597 | 66 | 90 | 01.93-08.98 | ■ | |
| 1.6 (GF3) (EJ16E) | | Gasolina | FWD | 1597 | 66 | 90 | 01.93-08.98 | ■ | |
| 1.6 i AWD (GF4) (EJ16) | 01/93-, -10/95, Rim 14 | Gasolina | 4WD | 1597 | 66 | 90 | 08.92-12.00 | ■ | |
| 1.6 i (GF3) (EJ161) | Rim 14 | Gasolina | FWD | 1597 | 70 | 95 | 06.98-12.00 | ■ | |
| 1.6 i AWD (GF4) (EJ161) | Rim 14 | Gasolina | 4WD | 1597 | 70 | 95 | 06.98-12.00 | ■ | |
| 1.8 i (GF5) (EJ18E) | vehicles with ABS | Gasolina | FWD | 1820 | 76 | 103 | 11.95-06.96 | ■ | |
| 1.8 i AWD (GF6) (EJ18) | Rim 14 | Gasolina | 4WD | 1820 | 76 | 103 | 08.92-12.00 | ■ | |
| 2.0 (GF8) (EJ20E) | | Gasolina | FWD | 1994 | 85 | 116 | 09.96-08.98 | ■ | |
| 2.0 i AWD (GF8) (EJ201) | Rim 14 | Gasolina | 4WD | 1994 | 85 | 116 | 12.95-12.00 | ■ | |
| 2.0 i AWD (GF8) (EJ20E) | Rim 14 | Gasolina | 4WD | 1994 | 85 | 116 | 12.95-12.00 | ■ | |

LISTA DE APLICACIONES - BUYERS GUIDE

| | | | | | | | | |
|---|-----------------------------------|----------|-----|------|--|-----|-------------|---|
| 2.0 i (GF8) (EJ201) | | Gasolina | FWD | 1994 | 92 | 125 | 09.98-09.00 | ■ |
| 2.0 i 16V AWD (GF8) (EJ201) | Rim 14 | Gasolina | 4WD | 1994 | 92 | 125 | 06.98-12.00 | ■ |
| 2.0 i 16V AWD (GF8) (EJ20E) | Rim 14 | Gasolina | 4WD | 1994 | 92 | 125 | 06.98-12.00 | ■ |
| 2.2 GX AWD (EJ22) | | Gasolina | 4WD | 2212 | 97 | 132 | 11.95-08.98 | ■ |
| IMPREZA (GC) 08.92-09.01 | | | | | Saloon (Compact car-C Segment) | | | |
| 1.5 (GC1) | | Gasolina | FWD | 1493 | 70 | 95 | 11.94-08.98 | ■ |
| 1.6 i (GC3) (EJ16) | -12/98, vehicles with ABS, Rim 14 | Gasolina | FWD | 1597 | 66 | 90 | 08.92-12.00 | ■ |
| 1.6 i AWD (GC4) (EJ16) | -12/98, Rim 14 | Gasolina | 4WD | 1597 | 66 | 90 | 08.92-12.00 | ■ |
| 1.6 i (GC3) (EJ161) | Rim 14 | Gasolina | FWD | 1597 | 70 | 95 | 06.98-12.00 | ■ |
| 1.6 i AWD (GC4) (EJ161) | Rim 14 | Gasolina | 4WD | 1597 | 70 | 95 | 06.98-12.00 | ■ |
| 1.8 i (GC5) (EJ18E) | | Gasolina | FWD | 1820 | 76 | 103 | 11.95-06.96 | ■ |
| 1.8 i AWD (GC6) (EJ18) | Rim 14 | Gasolina | 4WD | 1820 | 76 | 103 | 08.92-12.00 | ■ |
| 1.8 i AWD (GC6) (EJ18E) | Rim 14 | Gasolina | 4WD | 1820 | 76 | 103 | 08.92-12.00 | ■ |
| 2.0 i (GC7) (EJ20E) | | Gasolina | FWD | 1994 | 85 | 116 | 07.96-08.98 | ■ |
| 2.0 i AWD (GC8) (EJ201) | | Gasolina | 4WD | 1994 | 85 | 115 | 10.95-12.00 | ■ |
| 2.0 i AWD (GC8) (EJ20E) | | Gasolina | 4WD | 1994 | 85 | 115 | 10.95-12.00 | ■ |
| 2.0 i (GC7) (EJ201) | | Gasolina | FWD | 1994 | 92 | 125 | 09.98-09.00 | ■ |
| 2.0 i AWD (GC8) (EJ201) | | Gasolina | 4WD | 1994 | 92 | 125 | 06.98-12.00 | ■ |
| IMPREZA II (GG) 10.00- | | | | | Estate (Compact car-C Segment) | | | |
| 1.5 AWD (GG3) (EL15) | | Gasolina | 4WD | 1498 | 77 | 105 | 05.06-03.07 | ■ |
| 1.6 (EJ161) | | Gasolina | FWD | 1597 | 70 | 95 | 10.00-09.06 | ■ |
| 1.6 AWD (EJ161) | | Gasolina | 4WD | 1597 | 70 | 95 | 12.00-09.06 | ■ |
| IMPREZA II (GD) 09.99- | | | | | Saloon (Compact car-C Segment) | | | |
| 1.5 (GD2) (EL15) | | Gasolina | FWD | 1498 | 74 | 101 | 06.01-09.05 | ■ |
| 1.5 (GD2) (EL154) | | Gasolina | FWD | 1498 | 74 | 101 | 06.01-09.05 | ■ |
| 1.5 AWD (GD3) (EL15) | Rim 14 | Gasolina | 4WD | 1498 | 77 | 105 | 05.06-03.07 | ■ |
| 1.5 (GDC) (EL15) | | Gasolina | FWD | 1498 | 81 | 110 | 10.05-03.07 | ■ |
| 1.5 AWD (GDD) (EL15) | | Gasolina | 4WD | 1498 | 81 | 110 | 10.05-03.07 | ■ |
| 1.6 (EJ16) | | Gasolina | FWD | 1597 | 70 | 95 | 06.01-09.06 | ■ |
| 1.6 (EJ161) | | Gasolina | FWD | 1597 | 70 | 95 | 06.01-09.06 | ■ |
| 1.6 AWD (GD5) (EJ161) | | Gasolina | 4WD | 1597 | 70 | 95 | 12.00-06.09 | ■ |
| 2.5 i WRX AWD (GDG) (EJ255) | | Gasolina | 4WD | 2457 | 169 | 230 | 09.05-12.08 | ■ |
| IMPREZA III (GR, GH, G3) 03.07- | | | | | Hatchback (Compact car-C Segment) | | | |
| 1.5 AWD (GH3) (EL15) | | Gasolina | 4WD | 1498 | 79 | 107 | 02.08-03.12 | ■ |
| 1.5 F (GH2) (EL15) | | Gasolina | FWD | 1498 | 79 | 107 | 09.07-03.12 | ■ |
| IMPREZA III (GE, GV) 01.07- | | | | | Saloon (Compact car-C Segment) | | | |
| 1.5 (GE2) (EL15) | | Gasolina | FWD | 1498 | 79 | 107 | 02.08- | ■ |
| IMPREZA IV / WRX (GP_) 10.11- | | | | | Hatchback (Compact car-C Segment) | | | |
| 1.6 i AWD (GP3) (FB16) | | Gasolina | 4WD | 1599 | 85 | 115 | 12.11-10.16 | ■ |
| LEGACY II / LIBERTY (BG) 02.94-12.99 | | | | | Estate (Executive car-E Segment) | | | |
| 2.0 i (BG4) (EJ20 EMPI) | | Gasolina | FWD | 1994 | 85 | 116 | 09.94-11.98 | ■ |
| 2.0 i 4WD (BG5) (EJ201) | | Gasolina | 4WD | 1994 | 85 | 116 | 09.94-11.98 | ■ |
| 2.0 i 4WD (BG5) (EJ20E) | | Gasolina | 4WD | 1994 | 85 | 116 | 09.94-11.98 | ■ |
| 2.2 i 4WD (BG7) (EJ22 EMPI) | | Gasolina | 4WD | 2212 | 94 | 128 | 02.94-12.98 | ■ |
| 2.2 i 4WD (BG7) (EJ22 EMPI) | | Gasolina | 4WD | 2212 | 96 | 131 | 06.96-11.98 | ■ |
| LEGACY II / LIBERTY (BD) 01.94-10.99 | | | | | Saloon (Executive car-E Segment) | | | |
| 2.0 i (BD4) (EJ20E) | | Gasolina | FWD | 1994 | 85 | 116 | 09.94-03.99 | ■ |
| 2.0 i 4WD (BD5) (EJ201) | | Gasolina | 4WD | 1994 | 85 | 116 | 09.94-03.99 | ■ |

LISTA DE APLICACIONES - BUYERS GUIDE

| | | | | | | | | |
|--|----------------|----------|-----|------|---|-----|-------------|---|
| 2.0 i 4WD (BD5) (EJ20E) | | Gasolina | 4WD | 1994 | 85 | 116 | 09.94-03.99 | ■ |
| 2.2 (BD6) (EJ22) | | Gasolina | FWD | 2212 | 94 | 128 | 07.94-11.98 | ■ |
| 2.2 i 4WD (BD7) (EJ22 EMPI) | | Gasolina | 4WD | 2212 | 94 | 128 | 09.94-03.99 | ■ |
| 2.2 i 4WD (BD7) (EJ22 EMPI) | | Gasolina | 4WD | 2212 | 96 | 131 | 06.96-03.99 | ■ |
| LEGACY III / LIBERTY (BH) 10.98-08.03 | | | | | Estate (Executive car-E Segment) | | | |
| 2.0 AWD (BH5) (EJ201) | | Gasolina | 4WD | 1994 | 92 | 125 | 12.98-08.03 | ■ |
| 2.0 RSK | | Gasolina | FWD | 1994 | 191 | 260 | 08.00-08.03 | ■ |
| 2.0 AWD (EJ208) | | Gasolina | 4WD | 1994 | 206 | 280 | 06.02-08.03 | ■ |
| LEGACY III / LIBERTY (BE) 10.98-08.03 | | | | | Saloon (Executive car-E Segment) | | | |
| 2.0 AWD (BE5) (EJ201) | | Gasolina | 4WD | 1994 | 92 | 125 | 04.99-08.03 | ■ |
| 2.0 RSK | | Gasolina | FWD | 1994 | 191 | 260 | 08.00-08.03 | ■ |
| LEGACY / LIBERTY (BC, BF, BJ) 01.89-08.94 | | | | | Estate (Executive car-E Segment) | | | |
| 1.6 GL (EJ16) | | Gasolina | FWD | 1597 | 70 | 95 | 05.89-12.93 | ■ |
| 1800 (BF2) (EJ18 SPI) | Rim 14 | Gasolina | FWD | 1820 | 76 | 103 | 01.89-07.94 | ■ |
| 1800 4WD (BF3) (EJ18 SPI) | | Gasolina | 4WD | 1820 | 76 | 103 | 01.89-07.94 | ■ |
| 2000 (BF5) (EJ20 EMPI) | | Gasolina | FWD | 1994 | 85 | 116 | 09.91-12.93 | ■ |
| 2000 4WD (BF5) (EJ20 EMPI) | | Gasolina | 4WD | 1994 | 85 | 116 | 09.91-07.94 | ■ |
| 2.2 (BF7) (EJ22) | | Gasolina | FWD | 2212 | 100 | 136 | 05.89-10.91 | ■ |
| 2200 Super 4WD (BF7) (EJ22 EMPI) | 05/89-, Rim 14 | Gasolina | 4WD | 2212 | 100 | 136 | 01.89-07.94 | ■ |
| LEGACY / LIBERTY (BC) 01.89-12.95 | | | | | Saloon (Executive car-E Segment) | | | |
| 1.6 (EJ16) | | Gasolina | FWD | 1597 | 70 | 95 | 05.89-12.93 | ■ |
| 1800 (BC2) (EJ18 SPI) | | Gasolina | FWD | 1820 | 76 | 103 | 01.89-12.93 | ■ |
| 1800 4WD (BC3) (EJ18 SPI) | | Gasolina | 4WD | 1820 | 76 | 103 | 01.89-09.91 | ■ |
| 2.0 (BC4) (EJ20E) | | Gasolina | FWD | 1994 | 85 | 116 | 08.91-12.93 | ■ |
| 2000 4WD (BC5) (EJ20 EMPI) | | Gasolina | 4WD | 1994 | 85 | 116 | 08.91-07.94 | ■ |
| 2.0 GL (EJ20E) | | Gasolina | FWD | 1994 | 103 | 140 | 08.91-12.93 | ■ |
| 2200 4WD (BC7) (EJ22 EMPI) | Rim 14 | Gasolina | 4WD | 2212 | 100 | 136 | 01.89-07.94 | ■ |