

LISTA DE APLICACIONES - BUYERS GUIDE

78BD0034-2



Weight: 9.116

| O.E.M. | MAKE |
|-------------|--------|
| 26310-AA040 | SUBARU |
| 26310-AA050 | SUBARU |
| 26310-AA051 | SUBARU |
| 26700-FE010 | SUBARU |
| 26700-FE030 | SUBARU |
| 26700-FE080 | SUBARU |

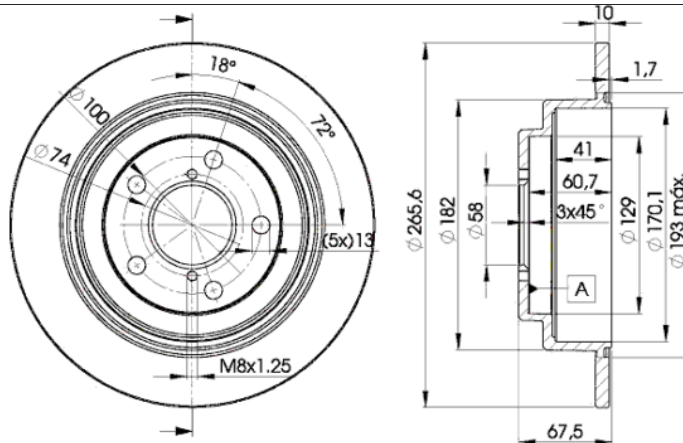

78BD0034-2



Ø265.6x10x67.5

| MAKE |
|--------|
| SUBARU |



| Trac. | CC | Kw | CV | |
|-------|----|----|----|--------------|
| | | | | Front / Rear |

SUBARU

FORESTER (SF_) 03.97-09.02

SUV (Compact SUV-J Segment)

| | | | | | | | |
|-------------------------------|----------|-----|------|-----|-----|-------------|---|
| 2.0 S Turbo AWD (SF5) (EJ205) | Gasolina | 4WD | 1994 | 125 | 170 | 06.98-04.01 | ■ |
| 2.0 S Turbo AWD (SF5) (EJ205) | Gasolina | 4WD | 1994 | 130 | 177 | 04.01-09.02 | ■ |
| 2.0 16V AWD | Gasolina | 4WD | 1994 | 184 | 250 | 03.97-02.02 | ■ |
| 2.5 AWD (SF9) (EJ25D) | Gasolina | 4WD | 2457 | 123 | 167 | 07.97-05.02 | ■ |
| 2.5 Turbo AWD (EJ250) | Gasolina | 4WD | 2457 | 160 | 218 | 09.98-05.02 | ■ |

FORESTER II (SG_) 02.02-12.12

SUV (Compact SUV-J Segment)

| | | | | | | | |
|---|----------|-----|------|-----|-----|-------------|---|
| 2.0 S Turbo AWD (SG5) (EJ205) | Gasolina | 4WD | 1994 | 130 | 177 | 02.02-05.05 | ■ |
| 2.5 AWD (SG9) | Gasolina | 4WD | 2457 | 112 | 152 | 06.02-05.05 | ■ |
| 2.5 RX Nato AWD (SG9) (EJ25) | Gasolina | 4WD | 2457 | 115 | 156 | 11.02-12.08 | ■ |
| 2.5 AWD (SG9) (EJ25D) | Gasolina | 4WD | 2457 | 121 | 165 | 06.05-05.08 | ■ |
| 2.5 AWD (EJ253) | Gasolina | 4WD | 2457 | 129 | 175 | 01.05-10.12 | ■ |
| 2.5 AWD (SG9) (EJ25) | Gasolina | 4WD | 2457 | 155 | 211 | 12.03-05.05 | ■ |
| 2.5 AWD (SG9, S11SG, S12SH) (EJ255) | Gasolina | 4WD | 2457 | 169 | 230 | 06.05-05.08 | ■ |
| 2.5 AWD (EJ255) | Gasolina | 4WD | 2457 | 171 | 232 | 01.04-12.09 | ■ |
| 2.5 Prodrive Performance Pack AWD (EJ255) | Gasolina | 4WD | 2457 | 188 | 256 | 05.05-09.05 | ■ |

IMPREZA (GFC) 01.93-12.00

Coupe (Compact car-C Segment)

| | | | | | | | | |
|-----------------------------|---------------------------|----------|-----|------|-----|-----|-------------|---|
| 1.6 (GC4) (EJ161) | -12/98, vehicles with ABS | Gasolina | FWD | 1597 | 66 | 90 | 12.96-12.00 | ■ |
| 1.6 (GC4) (EJ16E) | -12/98, vehicles with ABS | Gasolina | FWD | 1597 | 66 | 90 | 12.96-12.00 | ■ |
| 1.6 AWD (GC4) (EJ161) | -12/98, vehicles with ABS | Gasolina | 4WD | 1597 | 66 | 90 | 12.96-12.00 | ■ |
| 1.8 (EJ18) | | Gasolina | FWD | 1820 | 76 | 103 | 01.93-10.95 | ■ |
| 2.0 (GC8) | | Gasolina | FWD | 1994 | 92 | 125 | 09.98-09.00 | ■ |
| 2.0 Turbo AWD (GC8) (EJ20G) | | Gasolina | 4WD | 1994 | 155 | 211 | 12.96-12.00 | ■ |

LISTA DE APLICACIONES - BUYERS GUIDE

| IMPREZA (GF) 08.92-12.00 | | | | | Estate (Compact car-C Segment) | | | |
|---------------------------------------|---------------------------|----------|-----|------|----------------------------------|-----|-------------|---|
| 1.5 L (GF1) (EJ151) | | Gasolina | FWD | 1493 | 66 | 90 | 09.98-09.00 | ■ |
| 1.5 L (GF1) | | Gasolina | FWD | 1493 | 70 | 95 | 11.95-08.98 | ■ |
| 1.6 i AWD (GF4) (EJ16) | vehicles with ABS | Gasolina | 4WD | 1597 | 66 | 90 | 08.92-12.00 | ■ |
| 1.8 i (GF5) (EJ18E) | vehicles with ABS | Gasolina | FWD | 1820 | 76 | 103 | 11.95-06.96 | ■ |
| 1.8 i AWD (GF6) (EJ18) | vehicles with ABS | Gasolina | 4WD | 1820 | 76 | 103 | 08.92-12.00 | ■ |
| 2.0 (GF8) (EJ20E) | vehicles with ABS | Gasolina | FWD | 1994 | 85 | 116 | 09.96-08.98 | ■ |
| 2.0 i AWD (GF8) (EJ201) | vehicles with ABS | Gasolina | 4WD | 1994 | 85 | 116 | 12.95-12.00 | ■ |
| 2.0 i AWD (GF8) (EJ20E) | vehicles with ABS | Gasolina | 4WD | 1994 | 85 | 116 | 12.95-12.00 | ■ |
| 2.0 i (GF8) (EJ201) | vehicles with ABS | Gasolina | FWD | 1994 | 92 | 125 | 09.98-09.00 | ■ |
| 2.0 i Turbo AWD (GF8) (EJ20 (TURBO)) | -12/98 | Gasolina | 4WD | 1994 | 155 | 211 | 03.94-12.00 | ■ |
| 2.0 Turbo GT AWD (GF8) (EJ205) | -12/98 | Gasolina | 4WD | 1994 | 160 | 218 | 06.98-12.00 | ■ |
| IMPREZA (GC) 08.92-09.01 | | | | | Saloon (Compact car-C Segment) | | | |
| 1.5 (GC1) | | Gasolina | FWD | 1493 | 70 | 95 | 11.94-08.98 | ■ |
| 1.6 i (GC3) (EJ16) | -12/98, vehicles with ABS | Gasolina | FWD | 1597 | 66 | 90 | 08.92-12.00 | ■ |
| 1.6 i AWD (GC4) (EJ16) | -12/98, vehicles with ABS | Gasolina | 4WD | 1597 | 66 | 90 | 08.92-12.00 | ■ |
| 1.8 i (GC5) (EJ18E) | | Gasolina | FWD | 1820 | 76 | 103 | 11.95-06.96 | ■ |
| 1.8 i AWD (GC6) (EJ18) | vehicles with ABS | Gasolina | 4WD | 1820 | 76 | 103 | 08.92-12.00 | ■ |
| 1.8 i AWD (GC6) (EJ18E) | vehicles with ABS | Gasolina | 4WD | 1820 | 76 | 103 | 08.92-12.00 | ■ |
| 2.0 i (GC7) (EJ20E) | vehicles with ABS | Gasolina | FWD | 1994 | 85 | 116 | 07.96-08.98 | ■ |
| 2.0 i AWD (GC8) (EJ201) | vehicles with ABS | Gasolina | 4WD | 1994 | 85 | 115 | 10.95-12.00 | ■ |
| 2.0 i AWD (GC8) (EJ20E) | vehicles with ABS | Gasolina | 4WD | 1994 | 85 | 115 | 10.95-12.00 | ■ |
| 2.0 i (GC7) (EJ201) | vehicles with ABS | Gasolina | FWD | 1994 | 92 | 125 | 09.98-09.00 | ■ |
| 2.0 i AWD (GC8) (EJ201) | vehicles with ABS | Gasolina | 4WD | 1994 | 92 | 125 | 06.98-12.00 | ■ |
| 2.0 Turbo GT AWD (GC8) (EJ20 (TURBO)) | | Gasolina | 4WD | 1994 | 155 | 211 | 03.94-12.00 | ■ |
| 2.0 Turbo GT AWD (GC8) (EJ205) | | Gasolina | 4WD | 1994 | 160 | 218 | 06.98-12.00 | ■ |
| IMPREZA II (GG) 10.00- | | | | | Estate (Compact car-C Segment) | | | |
| 2.0 AWD (GG9) (EJ201) | -09/05 | Gasolina | 4WD | 1994 | 92 | 125 | 12.00-12.07 | ■ |
| 2.0 i R AWD (GG9) (EJ20) | | Gasolina | 4WD | 1994 | 118 | 160 | 12.00-06.07 | ■ |
| 2.0 i R AWD (GG9) (EJ204) | | Gasolina | 4WD | 1994 | 118 | 160 | 12.00-06.07 | ■ |
| IMPREZA II (GD) 09.99- | | | | | Saloon (Compact car-C Segment) | | | |
| 1.5 (GD2) (EL15) | | Gasolina | FWD | 1498 | 74 | 101 | 06.01-09.05 | ■ |
| 1.5 (GD2) (EL154) | | Gasolina | FWD | 1498 | 74 | 101 | 06.01-09.05 | ■ |
| 1.5 (GDC) (EL15) | | Gasolina | FWD | 1498 | 81 | 110 | 10.05-03.07 | ■ |
| 1.5 AWD (GDD) (EL15) | | Gasolina | 4WD | 1498 | 81 | 110 | 10.05-03.07 | ■ |
| 2.0 i AWD (GD9) (EJ201) | -09/05 | Gasolina | 4WD | 1994 | 92 | 125 | 12.00-06.09 | ■ |
| 2.0 i R AWD (GD9) (EJ204) | | Gasolina | 4WD | 1994 | 118 | 160 | 09.05-03.07 | ■ |
| 2.5 i AWD (GDE) (EJ251) | | Gasolina | 4WD | 2457 | 112 | 152 | 12.02-09.05 | ■ |
| 2.5 AWD (GDE) (EJ251) | | Gasolina | 4WD | 2457 | 130 | 177 | 03.01-09.05 | ■ |
| LEGACY II / LIBERTY (BG) 02.94-12.99 | | | | | Estate (Executive car-E Segment) | | | |
| 2.0 i (BG4) (EJ20 EMPI) | vehicles with ABS | Gasolina | FWD | 1994 | 85 | 116 | 09.94-11.98 | ■ |
| 2.0 i 4WD (BG5) (EJ201) | vehicles with ABS | Gasolina | 4WD | 1994 | 85 | 116 | 09.94-11.98 | ■ |
| 2.0 i 4WD (BG5) (EJ20E) | vehicles with ABS | Gasolina | 4WD | 1994 | 85 | 116 | 09.94-11.98 | ■ |
| 2.2 i 4WD (BG7) (EJ22 EMPI) | | Gasolina | 4WD | 2212 | 94 | 128 | 02.94-12.98 | ■ |
| 2.2 i 4WD (BG7) (EJ22 EMPI) | | Gasolina | 4WD | 2212 | 96 | 131 | 06.96-11.98 | ■ |
| 2.5 i 4WD (BG9) (EJ25D) | | Gasolina | 4WD | 2457 | 110 | 150 | 06.96-11.98 | ■ |
| LEGACY II / LIBERTY (BD) 01.94-10.99 | | | | | Saloon (Executive car-E Segment) | | | |
| 2.0 i (BD4) (EJ20E) | vehicles with ABS | Gasolina | FWD | 1994 | 85 | 116 | 09.94-03.99 | ■ |
| 2.0 i 4WD (BD5) (EJ201) | vehicles with ABS | Gasolina | 4WD | 1994 | 85 | 116 | 09.94-03.99 | ■ |

LISTA DE APLICACIONES - BUYERS GUIDE

| | | | | | | | | |
|---|-------------------|----------|-----|------|---|-----|-------------|---|
| 2.0 i 4WD (BD5) (EJ20E) | vehicles with ABS | Gasolina | 4WD | 1994 | 85 | 116 | 09.94-03.99 | ■ |
| 2.2 (BD6) (EJ22) | | Gasolina | FWD | 2212 | 94 | 128 | 07.94-11.98 | ■ |
| 2.2 i 4WD (BD7) (EJ22 EMPI) | | Gasolina | 4WD | 2212 | 94 | 128 | 09.94-03.99 | ■ |
| 2.2 i 4WD (BD7) (EJ22 EMPI) | | Gasolina | 4WD | 2212 | 96 | 131 | 06.96-03.99 | ■ |
| 2.5 i 4WD (BD9) (EJ25D) | | Gasolina | 4WD | 2457 | 110 | 150 | 06.96-03.99 | ■ |
| LEGACY II OUTBACK / LIBERTY OUTBACK (BG) 01.96-12.99 | | | | | Estate (Executive car-E Segment) | | | |
| 2.5 (BG9) (EJ25D) | | Gasolina | 4WD | 2457 | 110 | 150 | 01.96-12.99 | ■ |
| LEGACY III / LIBERTY (BE) 10.98-08.03 | | | | | Saloon (Executive car-E Segment) | | | |
| 3.0 H6 AWD (BEE) | | Gasolina | 4WD | 3000 | 154 | 209 | 08.00-08.03 | ■ |
| LEGACY / LIBERTY (BC, BF, BJ) 01.89-08.94 | | | | | Estate (Executive car-E Segment) | | | |
| 1.6 GL (EJ16) | | Gasolina | FWD | 1597 | 70 | 95 | 05.89-12.93 | ■ |
| 2.2 (BF7) (EJ22) | | Gasolina | FWD | 2212 | 100 | 136 | 05.89-10.91 | ■ |
| 2200 Super 4WD (BF7) (EJ22 EMPI) | 05/89- | Gasolina | 4WD | 2212 | 100 | 136 | 01.89-07.94 | ■ |
| LEGACY / LIBERTY (BC) 01.89-12.95 | | | | | Saloon (Executive car-E Segment) | | | |
| 1.6 (EJ16) | | Gasolina | FWD | 1597 | 70 | 95 | 05.89-12.93 | ■ |
| 2200 4WD (BC7) (EJ22 EMPI) | | Gasolina | 4WD | 2212 | 100 | 136 | 01.89-07.94 | ■ |