

LISTA DE APLICACIONES - BUYERS GUIDE

78BD0050-2



Weight: 11.840

O.E.M.	MAKE
HQ232405	mitsubishi

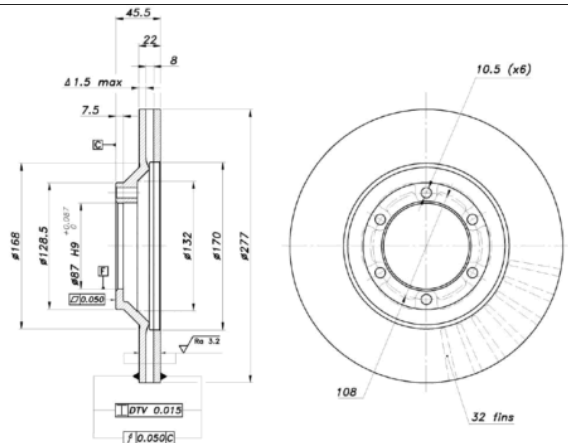

78BD0050-2



Ø277x22x45.5

MAKE
GALLOPER
HYUNDAI
mitsubishi



Trac.	CC	Kw	CV
-------	----	----	----



Front / Rear

GALLOPER

02.97-12.03

Closed Off-Road Vehicle ()

2.5 TD (KNE1CP)	vehicles with ABS	Diesel	4WD	2476	65	88	11.97-08.02	■
2.5 TD intercooler (KNE1CP, KPE1CP)	vehicles with ABS	Diesel	4WD	2476	73	99	11.97-08.02	■

HYUNDAI

GALLOPER II (JK-01) 02.97-12.03

Closed Off-Road Vehicle (Compact SUV-J Segment)

LPI A las 4 ruedas (L6AT)		LPG	4WD	2972	99	135	01.98-12.03	■
3.0 V6 (G6AT)		Gasolina	4WD	2972	104	141	08.98-12.03	■
3.0 AWD	vehicles with ABS	Gasolina	4WD	2972	118	160	05.99-09.01	■
LPI A las 4 ruedas (D4BF)		Diesel/a utogas (LPG)	4WD	2476	61	83	02.97-12.03	■
LPI A las 4 ruedas (D4BH)		Diesel/a utogas (LPG)	4WD	2476	76	103	02.97-12.03	■
2.5 TD (D4BA)		Diesel	4WD	2476	65	88	08.98-12.03	■
2.5 TD (D4BF)		Diesel	4WD	2476	65	88	08.98-12.03	■
2.5 TD intercooler (D4BH)		Diesel	4WD	2476	73	99	08.98-12.03	■
2.5 TCi D (D4BH)		Diesel	4WD	2476	77	105	08.98-12.03	■
2.6 TD A las 4 ruedas (D4BB)		Diesel	4WD	2607	63	86	08.98-06.03	■

mitsubishi

GALLOPER (JK-01) 09.98-12.03

Closed Off-Road Vehicle (Compact SUV-J Segment)

3.0 V6 (G6AT)		Gasolina	4WD	2972	104	141	09.98-12.03	■
2.5 TD (D4BF)		Diesel	4WD	2476	65	88	09.98-12.03	■
2.5 TD intercooler (D4BH)		Diesel	4WD	2476	73	99	09.98-12.03	■