

# LISTA DE APLICACIONES - BUYERS GUIDE

## 78BD0105-2



8 424073 291783

Weight: 6.840

O.E.M.	MAKE
51808471	FIAT
51885409	FIAT
52048984	FIAT
52048985	FIAT
52067389	FIAT
52067390	FIAT

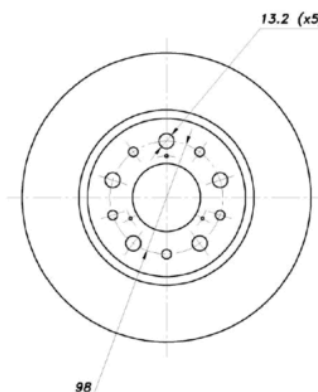
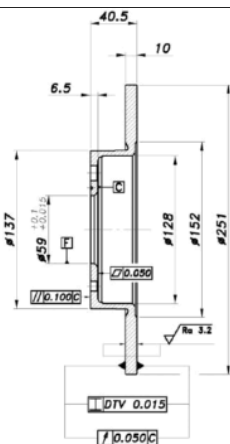

## 78BD0105-2



Ø251x10x40.5

MAKE

FIAT



Trac.	CC	Kw	CV
-------	----	----	----



Front / Rear

FIAT

### 500 L (351\_, 352\_) 09.12-

### Hatchback (Mini MPV-M1 Segment)

0.9 (199LYC1B) (199 B6.000)	Gasolina	FWD	875	77	105	09.12-	■
1.4 (199LYB1B) (843 A1.000)	Gasolina	FWD	1368	70	95	09.12-	■
0.9 Natural Power (199LYC1B) (312 A2.000)	Gasol./Gas (CNG)	FWD	875	59	80	04.17-	■
0.9 Natural Power (199LYC1B) (312 A2.000)	Gasol./Gas (CNG)	FWD	875	63	86	03.13-	■
1.3 D Multijet (199LXY1A, 199LXY11) (199 B4.000)	Diesel	FWD	1248	62	84	09.12-	■
1.3 D Multijet (199.LYM11, 199.LYM1A) (330 A1.000)	Diesel	FWD	1248	70	95	06.14-	■
1.6 D Multijet (199LYD1B) (199 B5.000)	Diesel	FWD	1598	77	105	09.12-05.18	■

### TIPO / EGEA (356\_, 357\_) 03.16-

### Estate (Compact car-C Segment)

1.0 (357WXN1A)	Gasolina	FWD	999	74	101	11.20-	■
1.4 (356WXA1B) (843 A1.000)	Gasolina	FWD	1368	70	95	03.16-10.20	■
1.4 (356WXF1B) (940 B7.000)	Gasolina	FWD	1368	88	120	03.16-10.20	■
1.6 (356WXE11) (552 68 036)	Gasolina	FWD	1598	81	110	07.16-10.20	■
1.4 LPG (356WXF1B) (940 B7.000)	Gasol./Gas (LPG)	FWD	1368	88	120	05.16-10.20	■
1.5 T4 Hybrid	Gasol./el éc.	FWD	1469	96	131	03.22-	■
1.3 D (356WXH1A) (552 66 963)	Diesel	FWD	1248	70	95	03.16-	■
1.3 D (356WXH1A) (552 83 775)	Diesel	FWD	1248	70	95	03.16-	■
1.6 D (356WYG11) (552 60 384)	Diesel	FWD	1598	84	114	09.16-10.20	■
1.6 D (356WYG11) (552 80 444)	Diesel	FWD	1598	84	114	09.16-10.20	■
1.6 D (356WYG1B) (552 60 384)	Diesel	FWD	1598	88	120	03.16-10.20	■

# LISTA DE APLICACIONES - BUYERS GUIDE

1.6 D (356WXG1B) (552 80 444)	Diesel	FWD	1598	88	120	03.16-10.20	■
1.6 Multijet (357WXG1)	Diesel	FWD	1598	96	131	11.20-	■
<b>TIPO / EGEA (356_, 357_) 03.16-</b>				<b>Hatchback (Compact car-C Segment)</b>			
1.0 (357HXN1A)	Gasolina	FWD	999	74	101	11.20-	■
1.4 (356HXA1B, 357) (843 A1.000)	Gasolina	FWD	1368	70	95	03.16-	■
1.4 (356HXF1B) (940 B7.000)	Gasolina	FWD	1368	88	120	03.16-10.20	■
1.6 (356HXE11) (552 68 036)	Gasolina	FWD	1598	81	110	07.16-10.20	■
1.4 LPG (356HXF1B) (940 B7.000)	Gasol./G as (LPG)	FWD	1368	88	120	05.16-10.20	■
1.5 T4 Hybrid	Gasol./el éc.	FWD	1469	96	131	03.22-	■
1.3 D (356HXH1A) (552 66 963)	Diesel	FWD	1248	70	95	03.16-	■
1.3 D (356HXH1A) (552 83 775)	Diesel	FWD	1248	70	95	03.16-	■
1.6 D (356HXG11) (552 60 384)	Diesel	FWD	1598	84	114	09.16-10.20	■
1.6 D (356HXG11) (552 80 444)	Diesel	FWD	1598	84	114	09.16-10.20	■
1.6 D (356HXG1B, 356HXG11) (552 60 384)	Diesel	FWD	1598	88	120	03.16-10.20	■
1.6 D (356HXG1B, 356HXG11) (552 80 444)	Diesel	FWD	1598	88	120	03.16-10.20	■
1.6 Multijet (357HXG1)	Diesel	FWD	1598	96	131	11.20-	■
<b>TIPO / EGEA (356_, 357_) 10.15-</b>				<b>Saloon (Compact car-C Segment)</b>			
1.0 (357SXN1A)	Gasolina	FWD	999	74	101	11.20-	■
1.4 (356SXA1B) (843 A1.000)	Gasolina	FWD	1368	70	95	10.15-	■
1.6 (356SXE11) (552 68 036)	Gasolina	FWD	1598	81	110	10.15-10.20	■
1.4 LPG (356SXF1B) (940 B7.000)	Gasol./G as (LPG)	FWD	1368	88	120	05.16-10.20	■
1.5 T4 Hybrid	Gasol./el éc.	FWD	1469	96	131	03.22-	■
1.3 D (356SXB1A, 356SXH1A, 356SXD1A) (199 B1.000)	Diesel	FWD	1248	70	95	10.15-10.20	■
1.3 D (356SXB1A, 356SXH1A, 356SXD1A) (552 66 963)	Diesel	FWD	1248	70	95	10.15-10.20	■
1.3 D (356SXB1A, 356SXH1A, 356SXD1A) (552 83 775)	Diesel	FWD	1248	70	95	10.15-10.20	■
1.6 D (356SXG1B) (552 60 384)	Diesel	FWD	1598	84	114	09.16-10.20	■
1.6 D (356SXG1B) (552 60 384)	Diesel	FWD	1598	88	120	10.15-10.20	■
1.6 D (356SXG1B) (940 C1.000)	Diesel	FWD	1598	88	120	10.15-10.20	■
1.6 Multijet (357SXG1)	Diesel	FWD	1598	96	131	11.20-	■