

LISTA DE APLICACIONES - BUYERS GUIDE

78BD0184-1



Weight: 6.454

O.E.M.	MAKE
2D0 615 601	VW
2D0 615 601 C	VW
901 423 04 12	MERCEDES-BENZ
901 423 06 12	MERCEDES-BENZ
901 423 08 12	MERCEDES-BENZ
901 423 10 12	MERCEDES-BENZ

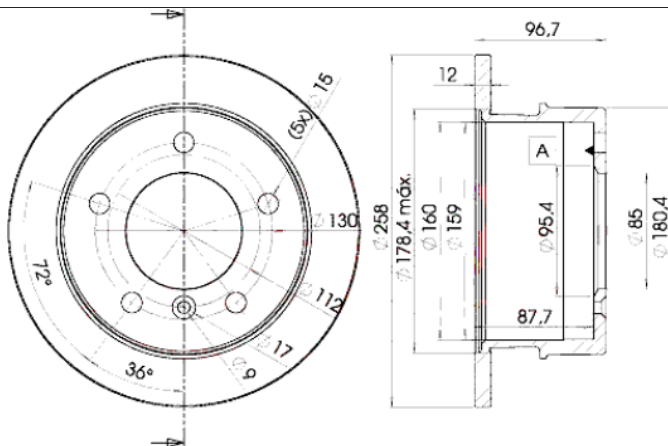

78BD0184-1



90R-02C0453/0107



Ø258x12x96.7

MAKE
DODGE
MERCEDES-BENZ
PUCH
VW



Trac.	CC	Kw	CV
-------	----	----	----



Front / Rear

DODGE

SPRINTER 2500 (VA) 09.92-12.06

Van (LCVs-N1 Segment)

2.7 D	Diesel	RWD	2685	115	156	09.03-12.06	■
-------	--------	-----	------	-----	-----	-------------	---

MERCEDES-BENZ

G-Class (W463) 09.89-

Closed Off-Road Vehicle (Luxury Crossover SUV-J Segment)

G 500 (463.249) (M 113.962)	Gasolina	4WD	4966	215	292	09.04-12.05	■
350 Turbo GD (463.320, 463.321) (OM 603.972)	Diesel	4WD	3449	100	136	09.91-08.96	■
G 320 CDI (463.321) (OM 603.972)	Diesel	4WD	3449	100	136	09.96-08.99	■

G-Class (W463) 09.89-

Open Off-Road Vehicle (Luxury Crossover SUV-J Segment)

350 G Turbo-D (463.300) (OM 603.972)	Diesel	4WD	3449	100	136	09.91-09.97	■
G 320 CDI (463.320) (OM 603.972)	Diesel	4WD	3449	100	136	09.96-08.99	■

SPRINTER 2-Ton. (B901, B902) 01.95-05.06

Bus (Minibus-M2-Segment)

214 (902.071, 902.072, 902.671, 902.672) (M 111.979)	Gasolina	RWD	2295	105	143	02.95-05.06	■
214 (902.071, 902.072, 902.671, 902.672) (M 111.984)	Gasolina	RWD	2295	105	143	02.95-05.06	■
214 NGT (902.072, 902.671, 902.672) (M 111.979)	Gasol./Gas (CNG)	RWD	2295	95	129	02.95-05.06	■
214 NGT (902.072, 902.671, 902.672) (M 111.984)	Gasol./Gas (CNG)	RWD	2295	95	129	02.95-05.06	■
208 CDI (901.671, 902.671, 902.672) (OM 611.987)	Diesel	RWD	2148	60	82	04.00-05.06	■
211 CDI (902.671, 902.672) (OM 611.981)	Diesel	RWD	2148	80	109	04.00-05.06	■
213 CDI (902.671, 902.672) (OM 611.981)	Diesel	RWD	2148	95	129	04.00-05.06	■

LISTA DE APLICACIONES - BUYERS GUIDE

208 D (901.371, 902.371, 902.372) (OM 601.943)	Diesel	RWD	2299	58	79	02.95-04.00	■
216 CDI (902.671, 902.672) (OM 612.981)	Diesel	RWD	2685	115	156	04.00-05.06	■
210 D (902.471, 902.472) (OM 602.980)	Diesel	RWD	2874	75	102	03.97-04.00	■
212 D (902.471, 902.472) (OM 602.980)	Diesel	RWD	2874	90	122	02.95-04.00	■
SPRINTER 2-Ton. (B901, B902) 01.95-05.06				Platform/Chassis (LCVs-N1 Segment)			
214 (902.011, 902.012, 902.611, 902.612) (M 111.979)	Gasolina	RWD	2295	105	143	02.95-05.06	■
214 (902.011, 902.012, 902.611, 902.612) (M 111.984)	Gasolina	RWD	2295	105	143	02.95-05.06	■
214 NGT (902.012, 902.611, 902.612) (M 111.979)	Gasol./Gas (CNG)	RWD	2295	95	129	02.95-05.06	■
214 NGT (902.012, 902.611, 902.612) (M 111.984)	Gasol./Gas (CNG)	RWD	2295	95	129	02.95-05.06	■
208 CDI (901.611, 901.612, 901.621, 902.611, 902.612,... (OM 611.987)	Diesel	RWD	2148	60	82	04.00-05.06	■
211 CDI (901.621, 902.611, 902.612, 902.621, 902.622) (OM 611.981)	Diesel	RWD	2148	80	109	04.00-05.06	■
213 CDI (901.621, 902.611, 902.612, 902.621, 902.622) (OM 611.981)	Diesel	RWD	2148	95	129	04.00-05.06	■
208 D (901.311, 901.312, 901.321, 902.311, 902.312,... (OM 601.943)	Diesel	RWD	2299	58	79	01.95-04.00	■
208 D (901.311, 901.312, 901.321, 902.311, 902.312,... (OM 601.943)	Diesel	RWD	2299	60	82	09.96-04.00	■
216 CDI (902.611, 902.612, 902.621, 902.622) (OM 612.981)	Diesel	RWD	2685	115	156	04.00-05.06	■
210 D (901.421, 902.412) (OM 602.980)	Diesel	RWD	2874	75	102	01.97-04.00	■
212 D (901.421, 902.412) (OM 602.980)	Diesel	RWD	2874	90	122	02.95-04.00	■
SPRINTER 2-Ton. (B901, B902) 01.95-05.06				Van (LCVs-N1 Segment)			
214 (901.061, 901.062, 901.661, 901.662, 902.061,... (M 111.979)	Gasolina	RWD	2295	105	143	02.95-05.06	■
214 (901.061, 901.062, 901.661, 901.662, 902.061,... (M 111.984)	Gasolina	RWD	2295	105	143	02.95-05.06	■
214 NGT (901.661, 902.061, 902.062, 902.661, 902.662) (M 111.979)	Gasol./Gas (CNG)	RWD	2295	95	129	02.95-05.06	■
214 NGT (901.661, 902.061, 902.062, 902.661, 902.662) (M 111.984)	Gasol./Gas (CNG)	RWD	2295	95	129	02.95-05.06	■
208 CDI (901.661, 901.662, 902.661, 902.662) (OM 611.987)	Diesel	RWD	2148	60	82	04.00-05.06	■
211 CDI (901.661, 901.662, 902.661, 902.662) (OM 611.981)	Diesel	RWD	2148	80	109	04.00-05.06	■
213 CDI (901.661, 901.662, 902.661, 902.662) (OM 611.981)	Diesel	RWD	2148	95	129	04.00-05.06	■
208 D (901.361, 901.362, 902.361, 902.362) (OM 601.943)	Diesel	RWD	2299	58	79	02.95-04.00	■
208 D (901.361, 901.362, 902.361, 902.362) (OM 601.943)	Diesel	RWD	2299	60	82	10.96-04.00	■
216 CDI (902.661, 902.662) (OM 612.981)	Diesel	RWD	2685	115	156	04.00-05.06	■
210 D (901.461, 901.462, 902.461, 902.462) (OM 602.980)	Diesel	RWD	2874	75	102	01.97-04.00	■
212 D (901.461, 901.462, 902.461, 902.462) (OM 602.980)	Diesel	RWD	2874	90	122	02.95-04.00	■
PUCH							
G-MODELL (W460) 03.79-12.91				Closed Off-Road Vehicle (Off-Road SUV-J Segment)			
230 G (460.230, 460.231) (M 102.944)	Gasolina	4WD	2299	80	109	01.86-06.89	■
230 GE (460.238, 460.239) (M 102.987)	Gasolina	4WD	2299	90	122	01.86-12.91	■
230 GE (461.239, 461.238) (M 102.979)	Gasolina	4WD	2299	90	122	11.91-08.96	■
230 GE (461.239, 461.238) (M 102.996)	Gasolina	4WD	2299	90	122	11.91-08.96	■
230 GE (460.238, 460.239) (M 102.981)	Gasolina	4WD	2299	92	125	03.79-12.91	■

LISTA DE APLICACIONES - BUYERS GUIDE

230 GE (460.238, 460.239) (M 102.987)	Gasolina	4WD	2299	92	125	03.79-12.91	■
230 G (460.230, 460.231) (M 115.973)	Gasolina	4WD	2307	66	90	03.79-08.85	■
230 G (460.230, 460.231) (M 115.973)	Gasolina	4WD	2307	75	102	03.79-08.85	■
280 GE (460.232, 460.233) (M 110.994)	Gasolina	4WD	2746	110	150	01.86-12.91	■
280 GE (460.232, 460.233) (M 110.994)	Gasolina	4WD	2746	115	156	03.79-12.91	■
300 GE (463.227, 463.228) (M 103.987)	Gasolina	4WD	2960	125	170	06.89-08.93	■
G 320 (463.230, 463.231) (M 104.996)	Gasolina	4WD	3199	155	211	02.94-12.97	■
G 36 AMG (463.231, 463.230) (M 104.952 (AMG 3,6))	Gasolina	4WD	3606	190	258	01.95-04.98	■
G 36 AMG (463.230, 463.231) (M 104.952 (AMG 3,6))	Gasolina	4WD	3606	200	272	01.95-04.98	■
G 55 AMG (463.240, 463.241) (M 113.982)	Gasolina	4WD	5439	260	354	04.99-03.01	■
240 GD (460.330, 460.331) (OM 616.936)	Diesel	4WD	2399	53	72	03.79-09.87	■
240 GD (460.330, 460.331) (OM 616.938)	Diesel	4WD	2399	53	72	03.79-09.87	■
250 GD (460.337, 460.338) (OM 602.930)	Diesel	4WD	2497	62	84	10.87-12.91	■
290 GD (461.338, 461.337) (OM 602.942)	Diesel	4WD	2874	70	95	10.91-12.97	■
290 GD (461.338, 461.337) (OM 602.947)	Diesel	4WD	2874	70	95	10.91-12.97	■
290 GD Turbodiesel (461.335, 461.336) (OM 602.983)	Diesel	4WD	2874	88	120	04.97-12.01	■
300 GD (460.332, 460.333) (OM 617.931)	Diesel	4WD	2998	59	80	03.79-08.79	■
300 GD (460.332, 460.333) (OM 617.932)	Diesel	4WD	2998	59	80	03.79-08.79	■
300 GD (460.332, 460.333) (OM 617.931)	Diesel	4WD	2998	65	88	09.79-12.91	■
300 GD (460.332, 460.333) (OM 617.932)	Diesel	4WD	2998	65	88	09.79-12.91	■
350 GD Turbo (463.320, 463.321) (OM 603.972)	Diesel	4WD	3449	100	136	08.91-08.93	■
G 350 Turbo (463.320, 463.321) (OM 603.972)	Diesel	4WD	3449	100	136	09.93-07.96	■
G-MODELL (W463) 06.89-11.00				Open Off-Road Vehicle (Off-Road SUV-J Segment)			
G 320 (V6) (463.209) (M 112.945)	Gasolina	4WD	3199	158	215	05.97-11.00	■
300 GD (463.307) (OM 603.931)	Diesel	4WD	2996	83	113	07.89-08.93	■
G 300 Diesel (463.307) (OM 603.931)	Diesel	4WD	2996	83	113	09.93-07.94	■
G 300 Turbodiesel (463.330, 463.331) (OM 606.964)	Diesel	4WD	2996	130	177	01.96-11.00	■
350 GD Turbo (463.300) (OM 603.972)	Diesel	4WD	3449	100	136	09.91-08.93	■
G 350 Turbo (463.300) (OM 603.972)	Diesel	4WD	3449	100	136	09.93-08.96	■
G-MODELL (W460) 03.79-12.91				Van (Off-Road SUV-J Segment)			
230 G (460.220, 460.221) (M 102.944)	Gasolina	4WD	2299	80	109	01.86-06.89	■
230 GE (460.228, 460.229) (M 102.987)	Gasolina	4WD	2299	90	122	01.86-12.91	■
230 GE (461.229) (M 102.979)	Gasolina	4WD	2299	90	122	11.91-08.96	■
230 GE (461.229) (M 102.996)	Gasolina	4WD	2299	90	122	11.91-08.96	■
230 GE (460.228, 460.229) (M 102.981)	Gasolina	4WD	2299	92	125	03.79-12.91	■
230 GE (460.228, 460.229) (M 102.987)	Gasolina	4WD	2299	92	125	03.79-12.91	■
230 G (460.220, 460.221) (M 115.973)	Gasolina	4WD	2307	66	90	03.79-08.85	■
230 G (460.220, 460.221) (M 115.973)	Gasolina	4WD	2307	75	102	03.79-08.85	■
280 GE (460.222, 460.223) (M 110.994)	Gasolina	4WD	2746	110	150	01.86-12.91	■
280 GE (460.222, 460.223) (M 110.994)	Gasolina	4WD	2746	115	156	03.79-12.91	■
240 GD (460.320, 460.321) (OM 616.936)	Diesel	4WD	2399	53	72	03.79-09.87	■
240 GD (460.320, 460.321) (OM 616.938)	Diesel	4WD	2399	53	72	03.79-09.87	■
250 GD (460.328) (OM 602.930)	Diesel	4WD	2497	62	84	10.87-12.91	■
290 GD (461.328) (OM 602.942)	Diesel	4WD	2874	70	95	10.91-12.97	■
290 GD (461.328) (OM 602.947)	Diesel	4WD	2874	70	95	10.91-12.97	■
290 GD Turbodiesel (461.335, 461.336) (OM 602.983)	Diesel	4WD	2874	88	120	04.97-12.01	■
300 GD (460.322, 460.323) (OM 617.931)	Diesel	4WD	2998	59	80	03.79-08.79	■
300 GD (460.322, 460.323) (OM 617.932)	Diesel	4WD	2998	59	80	03.79-08.79	■

LISTA DE APLICACIONES - BUYERS GUIDE

300 GD (460.322, 460.323) (OM 617.931)		Diesel	4WD	2998	65	88	09.79-12.91	■
300 GD (460.322, 460.323) (OM 617.932)		Diesel	4WD	2998	65	88	09.79-12.91	■
VW								
LT 28-35 (2DB, 2DE, 2DK) 04.96-07.06					Bus (Minibus-M2-Segment)			
2.3 (AGL)	-06/01, Type LT28	Gasolina	RWD	2295	105	143	05.96-07.06	■
2.5 SDI (AGX)	-06/01, Type LT28	Diesel	RWD	2461	55	75	07.96-07.06	■
2.5 TDI (BBE)	-06/06, Type LT28	Diesel	RWD	2461	61	83	05.01-07.06	■
2.5 TDI (APA)	Type LT28	Diesel	RWD	2461	66	90	05.99-07.06	■
2.5 TDI (BBF)	Type LT28	Diesel	RWD	2461	70	95	05.01-07.06	■
2.5 TDI (AHD)	Type LT28	Diesel	RWD	2461	75	102	05.96-08.99	■
2.5 TDI (ANJ)	-01/01, Type LT28	Diesel	RWD	2461	80	109	05.99-07.06	■
2.5 TDI (AVR)	-01/01, Type LT28	Diesel	RWD	2461	80	109	05.99-07.06	■
2.8 TDI (AGK)	Type LT28	Diesel	RWD	2798	92	125	07.97-05.03	■
LT 28-46 (2DC, 2DF, 2DG, 2DL, 2DM) 04.96-07.06					Platform/Chassis (LCVs-N1 Segment)			
2.3 (AGL)	-06/01, Type LT28	Gasolina	RWD	2295	105	143	06.96-07.06	■
2.5 SDI (AGX)	-06/01, Type LT28	Diesel	RWD	2461	55	75	09.96-07.06	■
2.5 TDI (BBE)	-06/01, Type LT28	Diesel	RWD	2461	61	83	05.01-07.06	■
2.5 TDI (APA)	-06/01, Type LT28	Diesel	RWD	2461	66	90	05.99-07.06	■
2.5 TDI (BBF)	Type LT28	Diesel	RWD	2461	70	95	05.01-07.06	■
2.5 TDI (AHD)	Type LT28	Diesel	RWD	2461	75	102	06.96-08.99	■
2.5 TDI (ANJ)	-06/01, Type LT28	Diesel	RWD	2461	80	109	05.99-07.06	■
2.5 TDI (AVR)	-06/01, Type LT28	Diesel	RWD	2461	80	109	05.99-07.06	■
2.8 TDI (AGK)	Type LT28	Diesel	RWD	2799	92	125	07.97-01.02	■
2.8 TDI (ATA)	-07/01, Type LT28	Diesel	RWD	2799	96	130	01.99-07.06	■
LT 28-46 (2DA, 2DD, 2DH) 04.96-07.06					Van (LCVs-N1 Segment)			
2.3 (AGL)	-06/01, Type LT28	Gasolina	RWD	2295	105	143	05.96-07.06	■
2.5 SDI (AGX)	-04/01	Diesel	RWD	2461	55	75	09.96-07.06	■
2.5 TDI (APA)	-06/06, Type LT28	Diesel	RWD	2461	66	90	05.99-07.06	■
2.5 TDI (BBF)	-06/01, Type LT28	Diesel	RWD	2461	70	95	05.01-07.06	■
2.5 TDI (AHD)	Type LT28	Diesel	RWD	2461	75	102	05.96-08.99	■
2.5 TDI (ANJ)	-06/01, Type LT28	Diesel	RWD	2461	80	109	05.99-07.06	■
2.5 TDI (AVR)	-06/01, Type LT28	Diesel	RWD	2461	80	109	05.99-07.06	■
2.8 TDI (AGK)	Type LT28	Diesel	RWD	2799	92	125	07.97-01.02	■
2.8 TDI (ATA)	-07/01, Type LT28	Diesel	RWD	2799	96	130	01.99-07.06	■