

# LISTA DE APLICACIONES - BUYERS GUIDE

## 78BD0187-1



Weight: 7.190

| O.E.M.        | MAKE          |
|---------------|---------------|
| 903 421 00 12 | MERCEDES-BENZ |
| 903 421 01 12 | MERCEDES-BENZ |

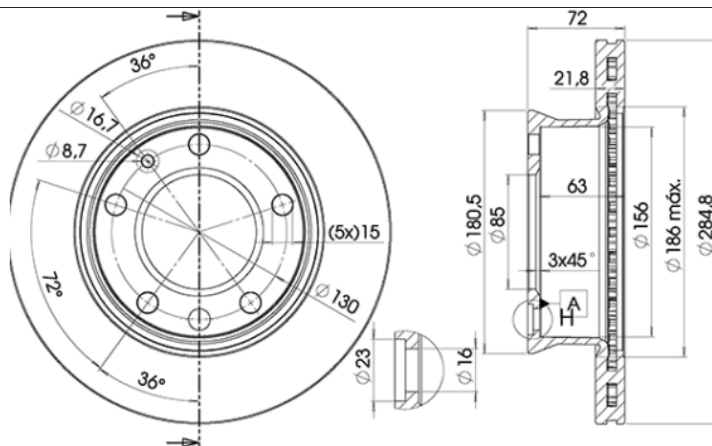

## 78BD0187-1



90R-02C0339/0048



Ø284.8x21.8x72

| MAKE          |
|---------------|
| MERCEDES-BENZ |



| Trac. | CC | Kw | CV |
|-------|----|----|----|
|-------|----|----|----|



Front / Rear

### MERCEDES-BENZ

#### SPRINTER 3-Ton. (B903) 01.95-05.12

#### Bus (Minibus-M2-Segment)

|  |              |                  |     |      |     |     |             |   |
|--|--------------|------------------|-----|------|-----|-----|-------------|---|
| 314 (903.071, 903.072, 903.073, 903.671, 903.672,... (M 111.979) | Axle 730.415 | Gasolina         | RWD | 2295 | 105 | 143 | 02.95-05.06 | ■ |
| 314 (903.071, 903.072, 903.073, 903.671, 903.672,... (M 111.984) | Axle 730.415 | Gasolina         | RWD | 2295 | 105 | 143 | 02.95-05.06 | ■ |
| 314 4x4 (903.672, 903.673) (M 111.984)                           | Axle 730.415 | Gasolina         | 4WD | 2295 | 105 | 143 | 02.95-05.06 | ■ |
| 314 NGT (903.072, 903.671, 903.672) (M 111.979)                  | Axle 730.415 | Gasol./Gas (CNG) | RWD | 2295 | 95  | 129 | 02.95-05.06 | ■ |
| 314 NGT (903.072, 903.671, 903.672) (M 111.984)                  | Axle 730.415 | Gasol./Gas (CNG) | RWD | 2295 | 95  | 129 | 02.95-05.06 | ■ |
| 308 E (903.372)  | Axle 730.415 | Eléctrico        | RWD |      | 40  | 54  | 01.96-05.06 | ■ |
| 308 CDI (903.671, 903.672, 903.673) (OM 611.987)                 | Axle 730.415 | Diesel           | RWD | 2148 | 60  | 82  | 04.00-05.06 | ■ |
| 311 CDI (903.671, 903.672) (OM 611.981)                          | Axle 730.415 | Diesel           | RWD | 2148 | 80  | 109 | 04.00-05.06 | ■ |
| 311 CDI 4x4 (903.672, 903.673) (OM 611.981)                      | Axle 730.415 | Diesel           | 4WD | 2148 | 80  | 109 | 08.02-05.06 | ■ |
| 313 CDI (903.671, 903.672, 903.673) (OM 611.981)                 | Axle 730.415 | Diesel           | RWD | 2148 | 95  | 129 | 04.00-05.06 | ■ |
| 313 CDI 4x4 (903.672, 903.673) (OM 611.981)                      | Axle 730.415 | Diesel           | 4WD | 2148 | 95  | 129 | 08.02-05.06 | ■ |
| 2.3 D  |              | Diesel           | RWD | 2299 | 58  | 79  | 06.97-12.99 | ■ |
| 308 D (903.372, 903.373) (OM 601.943)                            | Axle 730.415 | Diesel           | RWD | 2299 | 58  | 79  | 02.95-04.00 | ■ |
| 308 D (903.371, 903.372, 903.373) (OM 601.943)                   | Axle 730.415 | Diesel           | RWD | 2299 | 60  | 82  | 03.97-04.00 | ■ |
| 316 CDI (903.671, 903.672, 903.673) (OM 612.981)                 | Axle 730.415 | Diesel           | RWD | 2685 | 115 | 156 | 04.00-05.06 | ■ |
| 316 CDI (903.671, 903.672, 903.673) (OM 647.981)                 | Axle 730.415 | Diesel           | RWD | 2685 | 115 | 156 | 04.00-05.06 | ■ |
| 316 CDI 4x4 (903.672, 903.673) (OM 612.981)                      | Axle 730.415 | Diesel           | 4WD | 2685 | 115 | 156 | 08.02-05.06 | ■ |
| 316 CDI 4x4 (903.672, 903.673) (OM 647.981)                      | Axle 730.415 | Diesel           | 4WD | 2685 | 115 | 156 | 08.02-05.06 | ■ |

# LISTA DE APLICACIONES - BUYERS GUIDE

|   |              |                  |     |      |   |     |             |   |
|---|--------------|------------------|-----|------|---|-----|-------------|---|
| 310 D (903.471, 903.472, 903.473) (OM 602.980)                          |              | Diesel           | RWD | 2874 | 75  | 102 | 01.97-12.99 | ■ |
| 310 D 4x4 (903.472, 903.473) (OM 602.980)                               | Axle 730.415 | Diesel           | 4WD | 2874 | 75  | 102 | 05.97-08.02 | ■ |
| 312 D 2.9 (903.471, 903.472, 903.473) (OM 602.980)                      | Axle 730.415 | Diesel           | RWD | 2874 | 90  | 122 | 02.95-04.00 | ■ |
| 312 D 2.9 4x4 (903.473) (OM 602.980)                                    | Axle 730.415 | Diesel           | 4WD | 2874 | 90  | 122 | 05.97-08.02 | ■ |
| <b>SPRINTER 3-Ton. (B903) 01.95-05.12</b>                               |              |                  |     |      | <b>Platform/Chassis (LCVs-N1 Segment)</b> |     |             |   |
| 314 (903.011, 903.012, 903.013, 903.022, 903.612,... (M 111.979)        | Axle 730.415 | Gasolina         | RWD | 2295 | 105                                       | 143 | 02.95-05.06 | ■ |
| 314 (903.011, 903.012, 903.013, 903.022, 903.612,... (M 111.984)        | Axle 730.415 | Gasolina         | RWD | 2295 | 105                                       | 143 | 02.95-05.06 | ■ |
| 314 4x4 (903.612, 903.613, 903.622) (M 111.984)                         | Axle 730.415 | Gasolina         | 4WD | 2295 | 105                                       | 143 | 02.95-05.06 | ■ |
| 314 NGT (903.611, 903.612, 903.613, 903.622, 903.012,... (M 111.979)    | Axle 730.415 | Gasol./Gas (CNG) | RWD | 2295 | 95  | 129 | 02.95-05.06 | ■ |
| 314 NGT (903.611, 903.612, 903.613, 903.622, 903.012,... (M 111.984)    | Axle 730.415 | Gasol./Gas (CNG) | RWD | 2295 | 95  | 129 | 02.95-05.06 | ■ |
| 308 E (903.312, 903.322)  |              | Eléctrico        | RWD |      | 40  | 54  | 01.96-05.06 | ■ |
| 308 CDI (903.611, 903.612, 903.613, 903.621, 903.622,... (OM 611.987)   | Axle 730.415 | Diesel           | RWD | 2148 | 60  | 82  | 04.00-05.06 | ■ |
| 311 CDI (903.611, 903.612, 903.613, 903.621, 903.622,... (OM 611.981)   | Axle 730.415 | Diesel           | RWD | 2148 | 80  | 109 | 04.00-05.06 | ■ |
| 311 CDI 4x4 (903.612, 903.613, 903.622, 903.623) (OM 611.981)           | Axle 730.415 | Diesel           | 4WD | 2148 | 80  | 109 | 04.00-05.06 | ■ |
| 313 CDI (903.611, 903.612, 903.621, 903.622) (OM 611.981)               | Axle 730.415 | Diesel           | RWD | 2148 | 95  | 129 | 04.00-05.06 | ■ |
| 313 CDI 4x4 (903.612, 903.613, 903.622, 903.623) (OM 611.981)           | Axle 730.415 | Diesel           | 4WD | 2148 | 95  | 129 | 04.00-05.06 | ■ |
| 308 D 2.3 (903.311, 903.322) (OM 601.943)                               | Axle 730.415 | Diesel           | RWD | 2299 | 58  | 79  | 02.95-04.00 | ■ |
| 308 D 2.3 (903.311, 903.322) (OM 601.943)                               | Axle 730.415 | Diesel           | RWD | 2299 | 60  | 82  | 11.96-04.00 | ■ |
| 316 CDI (903.611, 903.612, 903.613, 903.621, 903.622,... (OM 612.981)   | Axle 730.415 | Diesel           | RWD | 2685 | 115                                       | 156 | 04.00-05.06 | ■ |
| 316 CDI (903.611, 903.612, 903.613, 903.621, 903.622,... (OM 647.981)   | Axle 730.415 | Diesel           | RWD | 2685 | 115                                       | 156 | 04.00-05.06 | ■ |
| 316 CDI 4x4 (903.612, 903.613, 903.622, 903.623) (OM 612.981)           | Axle 730.415 | Diesel           | 4WD | 2685 | 115                                       | 156 | 08.02-05.06 | ■ |
| 316 CDI 4x4 (903.612, 903.613, 903.622, 903.623) (OM 647.981)           | Axle 730.415 | Diesel           | 4WD | 2685 | 115                                       | 156 | 08.02-05.06 | ■ |
| 310 D 2.9 (903.411, 903.412, 903.413, 903.421, 903.422,... (OM 602.980) | Axle 730.415 | Diesel           | RWD | 2874 | 75  | 102 | 01.97-04.00 | ■ |
| 310 D 2.9 4x4 (903.421, 903.422, 903.423) (OM 602.980)                  |              | Diesel           | 4WD | 2874 | 75  | 102 | 01.97-04.00 | ■ |
| 312 D 2.9 (903.411, 903.412, 903.421, 903.422, 903.423) (OM 602.980)    | Axle 730.415 | Diesel           | RWD | 2874 | 85  | 116 | 12.98-09.01 | ■ |
| 312 D 2.9 (903.411, 903.412, 903.421, 903.422, 903.423) (OM 602.980)    | Axle 730.415 | Diesel           | RWD | 2874 | 90  | 122 | 02.95-04.00 | ■ |
| 312 D 2.9 4x4 (903.411)   |              | Diesel           | 4WD | 2874 | 90  | 122 | 02.95-04.00 | ■ |
| <b>SPRINTER 3-Ton. (B903) 01.95-05.12</b>                               |              |                  |     |      | <b>Van (LCVs-N1 Segment)</b>              |     |             |   |
| 314 (903.061, 903.062, 903.063, 903.661, 903.662) (M 111.979)           | Axle 730.415 | Gasolina         | RWD | 2295 | 105                                       | 143 | 02.95-05.06 | ■ |
| 314 (903.061, 903.062, 903.063, 903.661, 903.662) (M 111.984)           | Axle 730.415 | Gasolina         | RWD | 2295 | 105                                       | 143 | 02.95-05.06 | ■ |
| 314 4x4 (903.661, 903.662, 903.663) (M 111.984)                         | Axle 730.415 | Gasolina         | 4WD | 2295 | 105                                       | 143 | 02.95-05.06 | ■ |
| 314 NGT (903.661, 903.061, 903.062, 903.063, 903.662) (M 111.979)       | Axle 730.415 | Gasol./Gas (CNG) | RWD | 2295 | 95  | 129 | 02.95-05.06 | ■ |
| 314 NGT (903.661, 903.061, 903.062, 903.063, 903.662) (M 111.984)       | Axle 730.415 | Gasol./Gas (CNG) | RWD | 2295 | 95  | 129 | 02.95-05.06 | ■ |
| 308 E (903.362)   |              | Eléctrico        | RWD |      | 40  | 54  | 01.96-05.06 | ■ |
| 308 CDI (903.661, 903.662, 903.663) (OM 611.987)                        | Axle 730.415 | Diesel           | RWD | 2148 | 60  | 82  | 04.00-05.06 | ■ |
| 311 CDI (903.661, 903.662, 903.663) (OM 611.981)                        | Axle 730.415 | Diesel           | RWD | 2148 | 80  | 109 | 04.00-05.06 | ■ |

# LISTA DE APLICACIONES - BUYERS GUIDE

|  |              |          |     |      |   |     |             |   |
|--|--------------|----------|-----|------|---|-----|-------------|---|
| 311 CDI 4x4 (903.662, 903.663) (OM 611.981)              | Axle 730.415 | Diesel   | 4WD | 2148 | 80  | 109 | 08.02-05.06 | ■ |
| 313 CDI (903.663, 903.662, 903.661) (OM 611.981)         | Axle 730.415 | Diesel   | RWD | 2148 | 95  | 129 | 04.00-05.06 | ■ |
| 313 CDI 4x4 (903.662, 903.663) (OM 611.981)              | Axle 730.415 | Diesel   | 4WD | 2148 | 95  | 129 | 08.02-05.06 | ■ |
| 2.3 D  |              | Diesel   | RWD | 2299 | 58  | 79  | 06.97-12.99 | ■ |
| 308 D 2.3 (903.361, 903.362, 903.363) (OM 601.943)       | Axle 730.415 | Diesel   | RWD | 2299 | 58  | 79  | 02.95-04.00 | ■ |
| 308 D 2.3 (903.361) (OM 601.943)                         | Axle 730.415 | Diesel   | RWD | 2299 | 60  | 82  | 02.95-04.00 | ■ |
| 316 CDI (903.661, 903.662, 903.663) (OM 612.981)         | Axle 730.415 | Diesel   | RWD | 2685 | 115                                       | 156 | 04.00-05.06 | ■ |
| 316 CDI (903.661, 903.662, 903.663) (OM 647.981)         | Axle 730.415 | Diesel   | RWD | 2685 | 115                                       | 156 | 04.00-05.06 | ■ |
| 316 CDI 4x4 (903.662, 903.663) (OM 612.981)              | Axle 730.415 | Diesel   | 4WD | 2685 | 115                                       | 156 | 02.01-05.06 | ■ |
| 316 CDI 4x4 (903.662, 903.663) (OM 647.981)              | Axle 730.415 | Diesel   | 4WD | 2685 | 115                                       | 156 | 02.01-05.06 | ■ |
| 310 D 2.9 (903.461, 903.462, 903.463) (OM 602.980)       | Axle 730.415 | Diesel   | RWD | 2874 | 75  | 102 | 02.95-04.00 | ■ |
| 310 D 2.9 4x4 (903.461, 903.462) (OM 602.980)            |              | Diesel   | 4WD | 2874 | 75  | 102 | 06.97-04.00 | ■ |
| 312 D 2.9 (903.461, 903.462, 903.463) (OM 602.980)       | Axle 730.415 | Diesel   | RWD | 2874 | 90  | 122 | 02.95-04.00 | ■ |
| 312 D 2.9 4x4 (903.461, 903.462) (OM 602.980)            | Axle 730.415 | Diesel   | 4WD | 2874 | 90  | 122 | 05.97-08.02 | ■ |
| <b>SPRINTER 4-Ton. (B904) 02.96-05.06</b>                |              |          |     |      | <b>Bus (Minibus-M2-Segment)</b>           |     |             |   |
| 414 (904.662, 904.663) (M 111.979)                       |              | Gasolina | RWD | 2295 | 105                                       | 143 | 02.96-05.06 | ■ |
| 414 (904.662, 904.663) (M 111.984)                       |              | Gasolina | RWD | 2295 | 105                                       | 143 | 02.96-05.06 | ■ |
| 408 CDI (904.662, 904.663) (OM 611.987)                  |              | Diesel   | RWD | 2148 | 60  | 82  | 04.00-05.06 | ■ |
| 411 CDI (904.662, 904.663) (OM 611.981)                  |              | Diesel   | RWD | 2148 | 80  | 109 | 04.00-05.06 | ■ |
| 413 CDI (904.663, 904.662) (OM 611.981)                  |              | Diesel   | RWD | 2148 | 95  | 129 | 04.00-05.06 | ■ |
| 416 CDI (904.662, 904.663) (OM 612.981)                  |              | Diesel   | RWD | 2685 | 115                                       | 156 | 04.00-05.06 | ■ |
| <b>SPRINTER 4-Ton. (B904) 02.95-05.12</b>                |              |          |     |      | <b>Platform/Chassis (LCVs-N1 Segment)</b> |     |             |   |
| 414 (904.012, 904.013, 904.612, 904.613) (M 111.979)     |              | Gasolina | RWD | 2295 | 105                                       | 143 | 02.95-05.06 | ■ |
| 414 (904.012, 904.013, 904.612, 904.613) (M 111.984)     |              | Gasolina | RWD | 2295 | 105                                       | 143 | 02.95-05.06 | ■ |
| 414 4x4 (904.012, 904.013, 904.612, 904.613) (M 111.979) |              | Gasolina | 4WD | 2295 | 105                                       | 143 | 05.97-05.06 | ■ |
| 414 4x4 (904.012, 904.013, 904.612, 904.613) (M 111.984) |              | Gasolina | 4WD | 2295 | 105                                       | 143 | 05.97-05.06 | ■ |
| 408 CDI (OM 611.987)                                     |              | Diesel   | RWD | 2148 | 60  | 82  | 04.00-05.06 | ■ |
| 411 CDI (OM 611.981)                                     |              | Diesel   | RWD | 2148 | 80  | 109 | 04.00-05.06 | ■ |
| 411 CDI 4x4 (OM 611.981)                                 |              | Diesel   | 4WD | 2148 | 80  | 109 | 04.00-05.06 | ■ |
| 413 CDI (OM 611.981)                                     |              | Diesel   | RWD | 2148 | 95  | 129 | 04.00-05.06 | ■ |
| 413 CDI 4x4 (OM 611.981)                                 |              | Diesel   | 4WD | 2148 | 95  | 129 | 04.00-05.06 | ■ |
| 2.3 D  |              | Diesel   | RWD | 2299 | 58  | 79  | 06.97-12.99 | ■ |
| 408 D (OM 601.943)                                       |              | Diesel   | RWD | 2299 | 58  | 79  | 02.96-05.06 | ■ |
| 416 CDI (OM 612.981)                                     |              | Diesel   | RWD | 2685 | 115                                       | 156 | 04.00-05.06 | ■ |
| 416 CDI (OM 647.981)                                     |              | Diesel   | RWD | 2685 | 115                                       | 156 | 04.00-05.06 | ■ |
| 416 CDI 4x4 (OM 612.981)                                 |              | Diesel   | 4WD | 2685 | 115                                       | 156 | 04.00-05.06 | ■ |
| 416 CDI 4x4 (OM 647.981)                                 |              | Diesel   | 4WD | 2685 | 115                                       | 156 | 04.00-05.06 | ■ |
| 410 D (OM 602.980)                                       |              | Diesel   | RWD | 2874 | 75  | 102 | 02.96-05.06 | ■ |
| 410 D 4x4 (OM 602.980)                                   |              | Diesel   | 4WD | 2874 | 75  | 102 | 05.97-05.06 | ■ |
| 412 D (OM 602.980)                                       |              | Diesel   | RWD | 2874 | 85  | 115 | 02.96-05.06 | ■ |
| 412 D 4x4 (OM 602.980)                                   |              | Diesel   | 4WD | 2874 | 85  | 115 | 05.97-05.06 | ■ |
| 412 D (OM 602.980)                                       |              | Diesel   | RWD | 2874 | 90  | 122 | 02.96-05.06 | ■ |
| 412 D 4x4 (OM 602.980)                                   |              | Diesel   | 4WD | 2874 | 90  | 122 | 05.97-05.06 | ■ |

# LISTA DE APLICACIONES - BUYERS GUIDE

| SPRINTER 4-Ton. (B904) 02.95-05.12                       |          |     |      |     | Van (LCVs-N1 Segment) |             |   |  |
|--|----------|-----|------|-----|-----------------------|-------------|---|--|
| 414 (904.062, 904.063, 904.662, 904.663) (M 111.979)     | Gasolina | RWD | 2295 | 105 | 143                   | 02.96-05.06 | ■ |  |
| 414 (904.062, 904.063, 904.662, 904.663) (M 111.984)     | Gasolina | RWD | 2295 | 105 | 143                   | 02.96-05.06 | ■ |  |
| 414 4x4 (904.062, 904.063, 904.662, 904.663) (M 111.979) | Gasolina | 4WD | 2295 | 105 | 143                   | 05.97-05.06 | ■ |  |
| 414 4x4 (904.062, 904.063, 904.662, 904.663) (M 111.984) | Gasolina | 4WD | 2295 | 105 | 143                   | 05.97-05.06 | ■ |  |
| 408 CDI (OM 611.987)                                     | Diesel   | RWD | 2148 | 60  | 82                    | 04.00-05.06 | ■ |  |
| 411 CDI (OM 611.981)                                     | Diesel   | RWD | 2148 | 80  | 109                   | 04.00-05.06 | ■ |  |
| 411 CDI 4x4 (OM 611.981)                                 | Diesel   | 4WD | 2148 | 80  | 109                   | 04.00-05.06 | ■ |  |
| 413 CDI (OM 611.981)                                     | Diesel   | RWD | 2148 | 95  | 129                   | 04.00-05.06 | ■ |  |
| 413 CDI 4x4 (OM 611.981)                                 | Diesel   | 4WD | 2148 | 95  | 129                   | 04.00-05.06 | ■ |  |
| 2.3 D  | Diesel   | RWD | 2299 | 58  | 79                    | 06.97-12.99 | ■ |  |
| 408 D (OM 601.943)                                       | Diesel   | RWD | 2299 | 58  | 79                    | 02.96-05.06 | ■ |  |
| 416 CDI (OM 612.981)                                     | Diesel   | RWD | 2685 | 115 | 156                   | 04.00-05.06 | ■ |  |
| 416 CDI (OM 647.981)                                     | Diesel   | RWD | 2685 | 115 | 156                   | 04.00-05.06 | ■ |  |
| 416 CDI 4x4 (OM 612.981)                                 | Diesel   | 4WD | 2685 | 115 | 156                   | 04.00-05.06 | ■ |  |
| 416 CDI 4x4 (OM 647.981)                                 | Diesel   | 4WD | 2685 | 115 | 156                   | 04.00-05.06 | ■ |  |
| 410 D (OM 602.980)                                       | Diesel   | RWD | 2874 | 75  | 102                   | 02.96-05.06 | ■ |  |
| 410 D 4x4 (OM 602.980)                                   | Diesel   | 4WD | 2874 | 75  | 102                   | 05.97-05.06 | ■ |  |
| 412 D (OM 602.980)                                       | Diesel   | RWD | 2874 | 85  | 115                   | 02.96-05.06 | ■ |  |
| 412 D 4x4 (OM 602.980)                                   | Diesel   | 4WD | 2874 | 85  | 115                   | 05.97-05.06 | ■ |  |
| 412 D (OM 602.980)                                       | Diesel   | RWD | 2874 | 90  | 122                   | 02.96-05.06 | ■ |  |
| 412 D 4x4 (OM 602.980)                                   | Diesel   | 4WD | 2874 | 90  | 122                   | 05.97-05.06 | ■ |  |