

LISTA DE APLICACIONES - BUYERS GUIDE

78BD0198-1



8 424073 290823

Weight: 9.460

O.E.M.	MAKE
2N0615301A	VW
65508030000	MAN
65508030006	MAN

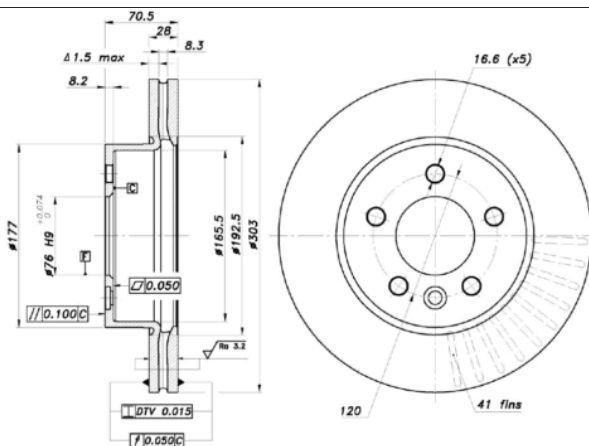

78BD0198-1



Ø303x28x70.5

MAKE
MAN
VW



Trac.	CC	Kw	CV
-------	----	----	----



Front / Rear

MAN

TGE 02.17-

						Bus (Minibus-M2-Segment)			
2.0 TDI (DAUB)	PR 1LA, PR 1LB	Diesel	FWD	1968	75	102	02.17-06.24	■	
2.0 TDI RWD	PR 1LA, PR 1LB	Diesel	RWD	1968	90	122	01.19-	■	
2.0 TDI (DAUA)	PR 1LA, PR 1LB	Diesel	FWD	1968	103	140	02.17-	■	
2.0 TDI AWD (DAUA)	PR 1LA, PR 1LB	Diesel	4WD	1968	103	140	02.17-	■	
2.0 TDI (DAVA)	PR 1LA, PR 1LB	Diesel	FWD	1968	130	177	02.17-	■	
2.0 TDI AWD (DAVA)	PR 1LA, PR 1LB	Diesel	4WD	1968	130	177	02.17-	■	
2.0 TDI RWD (DAVA)	PR 1LA, PR 1LB	Diesel	RWD	1968	130	177	02.17-06.24	■	

TGE (UZ_) 11.16-

						Platform/Chassis (LCVs-N1 Segment)			
2.0 TDI (DAUB)	PR 1LA, PR 1LB	Diesel	FWD	1968	75	102	11.16-06.24	■	
2.0 TDI RWD (DASA)	PR 1LA, PR 1LB	Diesel	RWD	1968	90	122	08.17-	■	
2.0 TDI (UZB, UZC, 08V, UZH, UZI, 10V, UZO, UZP, 21V,... (DAUA)	PR 1LA, PR 1LB	Diesel	FWD	1968	103	140	11.16-	■	
2.0 TDI AWD (UZB, UZC, 15V, UZH, UZI, 19V, UZO, UZP,... (DAUA)	PR 1LA, PR 1LB	Diesel	4WD	1968	103	140	11.17-	■	
2.0 TDI RWD (UZB, UZC, UZH, UZI, UZO, UZP, 14V, 18V, 22V... (DASB)	PR 1LA, PR 1LB	Diesel	RWD	1968	103	140	11.17-	■	
2.0 TDI (UZB, UZC, UZH, UZI, UZO, UZP, UZJ, UZK, 14V,...	PR 1LA, PR 1LB	Diesel	FWD	1968	120	163	11.22-	■	
2.0 TDI AWD (UZB, UZC, UZH, UZI, UZO, UZP, 15V, 19V)	PR 1LA, PR 1LB	Diesel	4WD	1968	120	163	11.22-	■	
2.0 TDI RWD (UZB, UZC, UZH, UZI, UZO, UZP, 14V, 18V, 22V...)	PR 1LA, PR 1LB	Diesel	RWD	1968	120	163	03.23-	■	
2.0 TDI (DAVA)	PR 1LA, PR 1LB	Diesel	FWD	1968	130	177	11.16-	■	
2.0 TDI AWD (DAVA)	PR 1LA, PR 1LB	Diesel	4WD	1968	130	177	11.17-	■	
2.0 TDI RWD (DAVA)	PR 1LA, PR 1LB	Diesel	RWD	1968	130	177	07.17-06.24	■	

LISTA DE APLICACIONES - BUYERS GUIDE

TGE 02.17-					Van (LCVs-N1 Segment)			
eTGE (35V, UXB) (EBHA)	PR 1LA, PR 1LB	Eléctrico	FWD		100	136	07.18-	■
2.0 TDI (01V, 03V, 36V, UYB, UYC, UYD) (DAUB)	PR 1LA, PR 1LB	Diesel	FWD	1968	75	102	02.17-06.24	■
2.0 TDI RWD (11V, 12V, 33V, 34V, UYB, UYC, UYD) (DASA)	PR 1LA, PR 1LB	Diesel	RWD	1968	90	122	08.17-	■
2.0 TDI (01V, 03V, 36V, UYB, UYC, UYD) (DAUA)	PR 1LA, PR 1LB	Diesel	FWD	1968	103	140	02.17-	■
2.0 TDI AWD (02V, 04V, 37V, UYB, UYC, UYD) (DAUA)	PR 1LA, PR 1LB	Diesel	4WD	1968	103	140	04.17-	■
2.0 TDI RWD (11V, 12V, UYB, UYC, UYD) (DASB)	PR 1LA, PR 1LB	Diesel	RWD	1968	103	140	10.17-	■
2.0 TDI (UYB, UYC, UYD, 01V, 09V, 03V, 10V)	PR 1LA, PR 1LB	Diesel	FWD	1968	120	163	11.22-	■
2.0 TDI AWD (UYB, UYC, UYD, 02V, 04V)	PR 1LA, PR 1LB	Diesel	4WD	1968	120	163	11.22-	■
2.0 TDI RWD (UYB, UYC, UYD, 11V, 12V, 33V)	PR 1LA, PR 1LB	Diesel	RWD	1968	120	163	03.23-	■
2.0 TDI (01V, 03V, 36V, UYB, UYC, UYD) (DAVA)	PR 1LA, PR 1LB	Diesel	FWD	1968	130	177	02.17-	■
2.0 TDI AWD (02V, 04V, 37V, UYB, UYC, UYD) (DAVA)	PR 1LA, PR 1LB	Diesel	4WD	1968	130	177	03.17-	■
2.0 TDI RWD (11V, 12V, 33V, 34V, UYB, UYC, UYD) (DAWA)	PR 1LA, PR 1LB	Diesel	RWD	1968	130	177	05.17-06.24	■
VW								
CRAFTER II (SYI, SYJ) 09.16-					Bus (Minibus-M2-Segment)			
2.0 TDI (DAUB)	PR 1LA, PR 1LB	Diesel	FWD	1968	75	102	10.16-06.24	■
2.0 TDI (DAUA)	PR 1LA, PR 1LB	Diesel	FWD	1968	103	140	09.16-	■
2.0 TDI 4motion (DAUA)	PR 1LA, PR 1LB	Diesel	4WD	1968	103	140	04.17-	■
2.0 TDI (DAVA)	PR 1LA, PR 1LB	Diesel	FWD	1968	130	177	09.16-	■
2.0 TDI 4motion (DAVA)	PR 1LA, PR 1LB	Diesel	4WD	1968	130	177	03.17-	■
CRAFTER II (SZ_) 11.16-					Platform/Chassis (LCVs-N1 Segment)			
2.0 TDI (DAUB)	PR 1LA, PR 1LB	Diesel	FWD	1968	75	102	11.16-06.24	■
2.0 TDI RWD (DASC)	PR 1LA, PR 1LB	Diesel	RWD	1968	80	109	11.16-06.24	■
2.0 TDI RWD (DASA)	PR 1LA, PR 1LB	Diesel	RWD	1968	90	122	08.17-	■
2.0 TDI (DAUA)	PR 1LA, PR 1LB	Diesel	FWD	1968	103	140	11.16-	■
2.0 TDI 4motion (DAUA)	PR 1LA, PR 1LB	Diesel	4WD	1968	103	140	11.17-	■
2.0 TDI RWD (SZB, SZC, SZD, SZH, SZI) (DASB)	PR 1LA, PR 1LB	Diesel	RWD	1968	103	140	11.17-	■
2.0 TDI	PR 1LA, PR 1LB	Diesel	FWD	1968	120	163	11.22-	■
2.0 TDI 4motion	PR 1LA, PR 1LB	Diesel	4WD	1968	120	163	11.22-	■
2.0 TDI RWD	PR 1LA, PR 1LB	Diesel	RWD	1968	120	163	03.23-	■
2.0 TDI (DAVA)	PR 1LA, PR 1LB	Diesel	FWD	1968	130	177	11.16-	■
2.0 TDI 4motion (DAVA)	PR 1LA, PR 1LB	Diesel	4WD	1968	130	177	11.17-	■
2.0 TDI RWD (DAWA)	PR 1LA, PR 1LB	Diesel	RWD	1968	130	177	07.17-06.24	■
CRAFTER II (SY_, SX_) 09.16-					Van (LCVs-N1 Segment)			
e-Crafter (EBHA)	PR 1LA, PR 1LB	Eléctrico	FWD		100	136	07.18-	■
2.0 TDI (DAUB)	PR 1LA, PR 1LB	Diesel	FWD	1968	75	102	10.16-06.24	■
2.0 TDI RWD (DASC)	PR 1LA, PR 1LB	Diesel	RWD	1968	80	109	05.17-06.24	■
2.0 TDI RWD (DASA)	PR 1LA, PR 1LB	Diesel	RWD	1968	90	122	08.17-	■
2.0 TDI (DAUA)	PR 1LA, PR 1LB	Diesel	FWD	1968	103	140	09.16-	■
2.0 TDI 4motion (DAUA)	PR 1LA, PR 1LB	Diesel	4WD	1968	103	140	04.17-	■
2.0 TDI RWD (DASB)	PR 1LA, PR 1LB	Diesel	RWD	1968	103	140	10.17-	■
2.0 TDI	PR 1LA, PR 1LB	Diesel	FWD	1968	120	163	11.22-	■
2.0 TDI 4motion	PR 1LA, PR 1LB	Diesel	4WD	1968	120	163	11.22-	■
2.0 TDI RWD	PR 1LA, PR 1LB	Diesel	RWD	1968	120	163	03.23-	■
2.0 TDI (DAVA)	PR 1LA, PR 1LB	Diesel	FWD	1968	130	177	09.16-	■
2.0 TDI 4motion (DAVA)	PR 1LA, PR 1LB	Diesel	4WD	1968	130	177	03.17-	■

LISTA DE APLICACIONES - BUYERS GUIDE

2.0 TDI RWD (DAWA)	PR 1LA, PR 1LB	Diesel	RWD	1968	130	177	05.17-06.24	■
GRAND CALIFORNIA Camper (SCB, SCC) 04.19-					Bus (Minibus-M2-Segment)			
2.0 TDI	PR 1LA, PR 1LB	Diesel	FWD	1968	103	140	04.19-	■
2.0 TDI 4motion	PR 1LA, PR 1LB	Diesel	4WD	1968	103	140	04.19-	■
2.0 TDI (DAVA)	PR 1LA, PR 1LB	Diesel	FWD	1968	130	177	04.19-	■
2.0 TDI 4motion (DAVA)	PR 1LA, PR 1LB	Diesel	4WD	1968	130	177	04.19-	■
MULTIVAN VII (STM, STN) 08.21-					Bus (Minibus-M2-Segment)			
1.5 TSI	PR 1LA	Gasolina	FWD	1498	100	136	09.21-05.24	■
2.0 TSI	PR 1LA	Gasolina	FWD	1984	150	204	10.21-	■
1.4 eHybrid	PR 1LA	Gasol./el éc.	FWD	1395	160	218	08.21-05.24	■
2.0 TDI	PR 1LA	Diesel	FWD	1968	110	150	03.22-	■