

LISTA DE APLICACIONES - BUYERS GUIDE

78BD0217-2



8 424073 291899

Weight: 8.860

O.E.M.	MAKE
2474210712	MERCEDES-BENZ
A2474210712	MERCEDES-BENZ

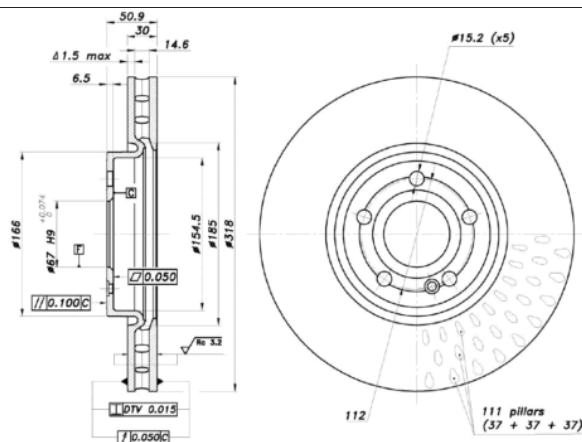

78BD0217-2



Ø318x30x50.9

MAKE
MERCEDES-BENZ
MERCEDES-BENZ (BBDC)



Trac.	CC	Kw	CV
-------	----	----	----



Front / Rear

MERCEDES-BENZ

A-Class IV (W177) 03.18-						Hatchback (Compact car-C Segment)			
A 220 (177.044) (M 260.920)	not AMG sports pack., not sports package	Gasolina	FWD	1991	140	190	07.18-	■	
A 220 4-matic (177.045) (M 260.920)	not AMG sports pack., not sports package	Gasolina	4WD	1991	140	190	07.18-10.19	■	
A 220 Mild-Hybrid 4-matic (177.145)	AMG Sports Package	Gasol./el éc.	4WD	1991	140	190	10.22-	■	
A 200 d 4-matic (177.013) (OM 654.920)	not AMG sports pack., not sports package	Diesel	4WD	1950	110	150	10.19-	■	
A 220 d (177.014) (OM 654.920)	not AMG sports pack., not sports package	Diesel	FWD	1950	140	190	11.18-	■	
A 220 d 4-matic (177.015) (OM 654.920)	not AMG sports pack., not sports package	Diesel	4WD	1950	140	190	10.19-	■	
A-Class IV (V177) 09.18-						Saloon (Compact car-C Segment)			
A 220 (177.144) (M 260.920)	not AMG sports pack., not sports package	Gasolina	FWD	1991	140	190	01.19-	■	
A 220 4-matic (177.145) (M 260.920)	not AMG sports pack., not sports package	Gasolina	4WD	1991	140	190	09.18-	■	
A 220 Mild-Hybrid 4-matic (177.145)	not AMG sports pack., not sports package	Gasol./el éc.	4WD	1991	140	190	10.22-	■	
A 220 d (177.114) (OM 654.920)	not AMG sports pack., not sports package	Diesel	FWD	1950	140	190	08.19-	■	
A 220 d 4-matic (177.115) (OM 654.920)	not AMG sports pack., not sports package	Diesel	4WD	1950	140	190	10.19-	■	
B-Class III Sports Tourer (W247) 12.18-						Hatchback (Compact MPV-M1 Segment)			
B 220 (247.044) (M 260.920)	not AMG sports pack., not sports package	Gasolina	FWD	1991	140	190	04.19-	■	
B 220 4-matic (247.045) (M 260.920)	not AMG sports pack., not sports package	Gasolina	4WD	1991	140	190	01.19-	■	
B 220 Mild-Hybrid 4-matic (247.045)	not AMG sports pack., not sports package	Gasol./el éc.	4WD	1991	140	190	10.22-	■	

LISTA DE APLICACIONES - BUYERS GUIDE

B 220 d (247.014) (OM 654.920)	not AMG sports pack., not sports package	Diesel	FWD	1950	140	190	12.18-	■
B 220 d 4-matic (247.015) (OM 654.920)	not AMG sports pack., not sports package	Diesel	4WD	1950	140	190	10.19-	■
CLA-Class II (C118) 03.19-					Coupe (Compact executive car-D Segment)			
CLA 220 4-matic (118.345) (M 260.920)	not AMG sports pack., not sports package	Gasolina	4WD	1991	140	190	03.19-	■
CLA 220 Mild-Hybrid 4-matic (118.345)	not AMG sports pack., not sports package	Gasol./el éc.	4WD	1991	140	190	03.23-	■
CLA 220 d (118.314) (OM 654.920)	not AMG sports pack., not sports package	Diesel	FWD	1950	140	190	04.19-	■
CLA 220 d 4-matic (118.315) (OM 654.920)	not AMG sports pack., not sports package	Diesel	4WD	1950	140	190	07.20-	■
CLA-Class II Shooting Brake (X118) 06.19-					Estate (Compact executive car-D Segment)			
CLA 220 d (118.614) (OM 654.920)	not AMG sports pack., not sports package	Diesel	FWD	1950	140	190	06.19-	■
CLA 220 d 4-matic (118.615) (OM 654.920)	not AMG sports pack., not sports package	Diesel	4WD	1950	140	190	10.19-	■
GLA-Class II (H247) 02.20-					SUV (Compact SUV-J Segment)			
GLA 180 (247.784) (M 282.914)	not AMG sports pack., not sports package	Gasolina	FWD	1332	100	136	07.20-	■
GLA 200 4-matic (247.788)	not AMG sports pack., not sports package	Gasolina	4WD	1332	110	150	01.22-	■
GLA 200 (247.787) (M 282.914)	AMG Sports Package, sports package	Gasolina	FWD	1332	120	163	02.20-	■
GLA 200 4-matic (247.788) (M 282.914)	not AMG sports pack., not sports package	Gasolina	4WD	1332	120	163	10.20-	■
GLA 200 Mild-Hybrid (247.787)	AMG Sports Package, sports package	Gasol./el éc.	FWD	1332	120	163	03.23-	■
GLA 180 d (247.710) (OM 654.920)	not AMG sports pack., not sports package	Diesel	FWD	1950	85	116	03.20-	■
GLA 200 d (247.712) (OM 654.920)	not AMG sports pack., not sports package	Diesel	FWD	1950	110	150	02.20-	■
GLA 200 d 4-matic (247.713) (OM 654.920)	not AMG sports pack., not sports package	Diesel	4WD	1950	110	150	02.20-	■
GLB-CLASS (X247) 07.19-					SUV (Compact SUV-J Segment)			
GLB 200 (247.687) (M 282.914)	not AMG sports pack., not sports package	Gasolina	FWD	1332	120	163	08.19-	■
GLB 200 4-matic (247.688) (M 282.914)	not AMG sports pack., not sports package	Gasolina	4WD	1332	120	163	12.19-03.23	■
GLB 200 Mild-Hybrid (247.687)	not AMG sports pack., not sports package	Gasol./el éc.	FWD	1332	120	163	03.23-	■
GLB 180 d (247.610) (OM 654.920)	not AMG sports pack., not sports package	Diesel	FWD	1950	85	116	08.19-	■
MERCEDES-BENZ (BBDC)								
A-Class (W177) 11.18-					Saloon (Compact car-C Segment)			
A 220 L 4-matic (177.045)	not AMG sports pack., not sports package	Gasolina	4WD	1991	140	190	07.19-	■
GLA-Class II (H247) 07.20-					SUV (Compact SUV-J Segment)			
GLA 180 (247.784) (M 282.914)	not AMG sports pack., not sports package	Gasolina	FWD	1332	100	136	09.20-	■
GLA 200 (247.787) (M 282.914)	AMG Sports Package, sports package	Gasolina	FWD	1332	120	163	07.20-	■
GLB (X247) 11.19-					Closed Off-Road Vehicle (Compact SUV-J Segment)			
180 (247.684)	not AMG sports pack., not sports package	Gasolina	FWD	1332	100	136	04.20-	■
200 (247.687)		Gasolina	FWD	1332	120	163	11.19-	■
GLB (X247) 11.19-					SUV (Compact SUV-J Segment)			
200 4-matic (247.688) (M 282.914)		Gasolina	4WD	1332	120	163	09.20-	■