

# LISTA DE APLICACIONES - BUYERS GUIDE

## 78BD0219-2



8 424073 291462

Weight: 10.100

O.E.M.	MAKE
2474230212	MERCEDES-BENZ
A2474230212	MERCEDES-BENZ

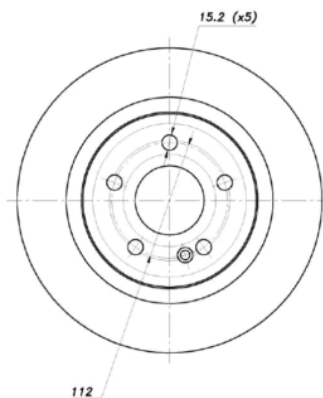
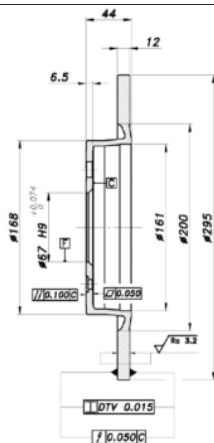

## 78BD0219-2



Ø295x12x44

MAKE
MERCEDES-BENZ
MERCEDES-BENZ (BBDC)



Trac.	CC	Kw	CV
-------	----	----	----



Front / Rear

### MERCEDES-BENZ

A-Class IV (W177) 03.18-						Hatchback (Compact car-C Segment)			
A 200 (177.087) (M 282.914)	sports package, AMG Sports Package	Gasolina	FWD	1332	110	150	06.18-		■
A 200 (177.087) (M 282.914)	sports package, AMG Sports Package	Gasolina	FWD	1332	120	163	03.18-		■
A 200 4-matic (177.088) (M 282.914)	sports package, AMG Sports Package	Gasolina	4WD	1332	120	163	10.20-		■
A 220 (177.044) (M 260.920)	not sports package	Gasolina	FWD	1991	140	190	07.18-		■
A 220 4-matic (177.045) (M 260.920)	not sports package	Gasolina	4WD	1991	140	190	07.18-10.19		■
A 250 (177.046) (M 260.920)	not sports package	Gasolina	FWD	1991	165	224	03.18-		■
A 250 4-matic (177.047) (M 260.920)	not sports package	Gasolina	4WD	1991	165	224	07.18-		■
A 200 Mild-Hybrid (177.187)	sports package, AMG Sports Package	Gasol./el éc.	FWD	1332	120	163	10.22-		■
A 220 Mild-Hybrid 4-matic (177.145)		Gasol./el éc.	4WD	1991	140	190	10.22-		■
A 200 d 4-matic (177.013) (OM 654.920)		Diesel	4WD	1950	110	150	10.19-		■
A 220 d (177.014) (OM 654.920)	sports package, AMG Sports Package	Diesel	FWD	1950	140	190	11.18-		■
A 220 d 4-matic (177.015) (OM 654.920)		Diesel	4WD	1950	140	190	10.19-		■
A-Class IV (V177) 09.18-						Saloon (Compact car-C Segment)			
A 200 (177.187) (M 282.914)		Gasolina	FWD	1332	110	150	09.18-		■
A 200 (177.187) (M 282.914)	not sports package, not AMG sports pack.	Gasolina	FWD	1332	120	163	09.18-		■
A 200 4-matic (177.188) (M 282.914)	sports package, AMG Sports Package	Gasolina	4WD	1332	120	163	10.20-		■
A 220 (177.144) (M 260.920)		Gasolina	FWD	1991	140	190	01.19-		■
A 220 4-matic (177.145) (M 260.920)		Gasolina	4WD	1991	140	190	09.18-		■

# LISTA DE APLICACIONES - BUYERS GUIDE

A 250 (177.146) (M 260.920)	not sports package, not AMG sports pack.	Gasolina	FWD	1991	165	224	09.18-	■
A 250 4-matic (177.147) (M 260.920)	not sports package, not AMG sports pack.	Gasolina	4WD	1991	165	224	09.18-	■
A 200 Mild-Hybrid (177.187)	not sports package, not AMG sports pack.	Gasol./el éc.	FWD	1332	120	163	10.22-	■
A 220 Mild-Hybrid 4-matic (177.145)		Gasol./el éc.	4WD	1991	140	190	10.22-	■
A 250 Mild-Hybrid 4-matic (177.147)	not sports package, not AMG sports pack.	Gasol./el éc.	4WD	1991	165	224	10.22-	■
A 200 d 4-matic (177.113) (OM 654.920)	sports package, AMG Sports Package	Diesel	4WD	1950	110	150	10.19-	■
A 220 d (177.114) (OM 654.920)		Diesel	FWD	1950	140	190	08.19-	■
A 220 d 4-matic (177.115) (OM 654.920)		Diesel	4WD	1950	140	190	10.19-	■
<b>B-Class III Sports Tourer (W247) 12.18-</b>					<b>Hatchback (Compact MPV-M1 Segment)</b>			
B 200 4-matic (247.088) (M 282.914)		Gasolina	4WD	1332	120	163	10.20-	■
B 220 (247.044) (M 260.920)		Gasolina	FWD	1991	140	190	04.19-	■
B 220 4-matic (247.045) (M 260.920)	sports package, AMG Sports Package	Gasolina	4WD	1991	140	190	01.19-	■
B 200 Mild Hybrid (247.087)		Gasol./el éc.	FWD	1332	120	163	11.22-	■
B 220 Mild-Hybrid 4-matic (247.045)	sports package, AMG Sports Package	Gasol./el éc.	4WD	1991	140	190	10.22-	■
B 200 d 4-matic (247.013) (OM 654.920)	sports package, AMG Sports Package	Diesel	4WD	1950	110	150	10.19-09.21	■
B 220 d (247.014) (OM 654.920)		Diesel	FWD	1950	140	190	12.18-	■
B 220 d 4-matic (247.015) (OM 654.920)		Diesel	4WD	1950	140	190	10.19-	■
<b>CLA-Class II (C118) 03.19-</b>					<b>Coupe (Compact executive car-D Segment)</b>			
CLA 200 4-matic (118.388) (M 282.914)		Gasolina	4WD	1332	120	163	10.20-	■
CLA 220 4-matic (118.345) (M 260.920)		Gasolina	4WD	1991	140	190	03.19-	■
CLA 220 Mild-Hybrid 4-matic (118.345)		Gasol./el éc.	4WD	1991	140	190	03.23-	■
CLA 180 d (118.310) (OM 654.820)	not sports package, not AMG sports pack.	Diesel	FWD	1950	85	116	10.20-	■
CLA 180 d (118.310) (OM 654.920)	not sports package, not AMG sports pack.	Diesel	FWD	1950	85	116	10.20-	■
CLA 200 d (118.312) (OM 654.920)		Diesel	FWD	1950	110	150	04.19-	■
CLA 200 d 4-matic (118.313) (OM 654.920)		Diesel	4WD	1950	110	150	04.19-	■
CLA 220 d (118.314) (OM 654.920)		Diesel	FWD	1950	140	190	04.19-	■
CLA 220 d 4-matic (118.315) (OM 654.920)		Diesel	4WD	1950	140	190	07.20-	■
<b>CLA-Class II Shooting Brake (X118) 06.19-</b>					<b>Estate (Compact executive car-D Segment)</b>			
CLA 180 (118.684) (M 282.914)		Gasolina	FWD	1332	100	136	06.19-	■
CLA 200 (118.687) (M 282.914)		Gasolina	FWD	1332	110	150	06.19-	■
CLA 200 (118.687) (M 282.914)		Gasolina	FWD	1332	120	163	06.19-	■
CLA 180 Mild-Hybrid (118.684)		Gasol./el éc.	FWD	1332	100	136	03.23-	■
CLA 200 Mild-Hybrid (118.687)		Gasol./el éc.	FWD	1332	120	163	03.23-	■
CLA 180 d (118.603) (OM 608.915)		Diesel	FWD	1461	85	116	06.19-	■
CLA 180 d (118.610) (OM 654.820)	not sports package, not AMG sports pack.	Diesel	FWD	1950	85	116	10.20-	■
CLA 180 d (118.610) (OM 654.920)	not sports package, not AMG sports pack.	Diesel	FWD	1950	85	116	10.20-	■
CLA 200 d (118.612) (OM 654.920)		Diesel	FWD	1950	110	150	06.19-	■
CLA 200 d 4-matic (118.613) (OM 654.920)		Diesel	4WD	1950	110	150	10.19-	■
CLA 220 d (118.614) (OM 654.920)		Diesel	FWD	1950	140	190	06.19-	■
CLA 220 d 4-matic (118.615) (OM 654.920)		Diesel	4WD	1950	140	190	10.19-	■
<b>GLA-Class II (H247) 02.20-</b>					<b>SUV (Compact SUV-J Segment)</b>			
GLA 180 (247.784) (M 282.914)		Gasolina	FWD	1332	100	136	07.20-	■

# LISTA DE APLICACIONES - BUYERS GUIDE

GLA 200 4-matic (247.788)		Gasolina	4WD	1332	110	150	01.22-	■
GLA 200 (247.787) (M 282.914)		Gasolina	FWD	1332	120	163	02.20-	■
GLA 200 4-matic (247.788) (M 282.914)		Gasolina	4WD	1332	120	163	10.20-	■
GLA 200 Mild-Hybrid (247.787)		Gasol./el éc.	FWD	1332	120	163	03.23-	■
GLA 180 d (247.710) (OM 654.920)		Diesel	FWD	1950	85	116	03.20-	■
GLA 200 d (247.712) (OM 654.920)		Diesel	FWD	1950	110	150	02.20-	■
GLA 200 d 4-matic (247.713) (OM 654.920)		Diesel	4WD	1950	110	150	02.20-	■
<b>GLB-CLASS (X247) 07.19-</b>					<b>SUV (Compact SUV-J Segment)</b>			
GLB 200 (247.687) (M 282.914)	not sports package, not AMG sports pack.	Gasolina	FWD	1332	120	163	08.19-	■
GLB 200 4-matic (247.688) (M 282.914)		Gasolina	4WD	1332	120	163	10.20-	■
GLB 220	not sports package, not AMG sports pack.	Gasolina	FWD	1991	140	190	07.19-	■
GLB 200 Mild-Hybrid (247.687)	not sports package, not AMG sports pack.	Gasol./el éc.	FWD	1332	120	163	03.23-	■
GLB 180 d (247.610) (OM 654.920)	not sports package, not AMG sports pack.	Diesel	FWD	1950	85	116	08.19-	■
GLB 200 d (247.612) (OM 654.920)	not sports package, not AMG sports pack.	Diesel	FWD	1950	110	150	08.19-	■
GLB 200 d 4-matic (247.613) (OM 654.920)	not sports package, not AMG sports pack.	Diesel	4WD	1950	110	150	08.19-	■
GLB 220 d 4-matic (247.615) (OM 654.920)	not sports package, not AMG sports pack.	Diesel	4WD	1950	140	190	08.19-	■
<b>MERCEDES-BENZ (BBDC)</b>								
<b>A-Class (W177) 11.18-</b>					<b>Saloon (Compact car-C Segment)</b>			
1.3 A200 L (177.987)		Gasolina	4WD	1332	120	163	11.18-	■
A 220 L 4-matic (177.045)		Gasolina	4WD	1991	140	190	07.19-	■
AMG A35 EQ Boost 4-matic (177.951) (M 260.920)		Gasol./el éc.	4WD	1991	225	306	10.23-	■
<b>GLA-Class II (H247) 07.20-</b>					<b>SUV (Compact SUV-J Segment)</b>			
GLA 180 (247.784) (M 282.914)		Gasolina	FWD	1332	100	136	09.20-	■
GLA 200 (247.787) (M 282.914)		Gasolina	FWD	1332	120	163	07.20-	■
GLA 200 4-matic (247.788) (M 282.914)		Gasolina	4WD	1332	120	163	09.20-	■
<b>GLB (X247) 11.19-</b>					<b>Closed Off-Road Vehicle (Compact SUV-J Segment)</b>			
180 (247.684)		Gasolina	FWD	1332	100	136	04.20-	■
200 (247.687)		Gasolina	FWD	1332	120	163	11.19-	■
<b>GLB (X247) 11.19-</b>					<b>SUV (Compact SUV-J Segment)</b>			
200 4-matic (247.688) (M 282.914)		Gasolina	4WD	1332	120	163	09.20-	■
220 (247.644) (M 260.920)		Gasolina	FWD	1991	140	190	03.22-	■