

# LISTA DE APLICACIONES - BUYERS GUIDE

## 78BD0265-2



Weight: 22.120

O.E.M.	MAKE
34 11 6 750 265	BMW

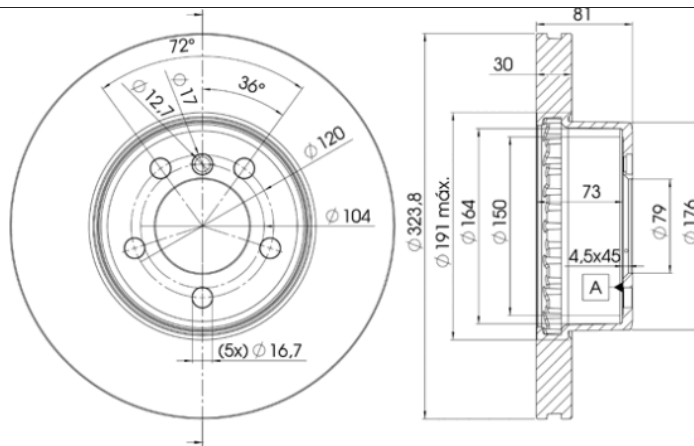

## 78BD0265-2

E1 90R-02C0074/1462



Ø323.8x30x81

MAKE
BMW



Trac.	CC	Kw	CV	
				Front / Rear

### BMW

#### 7 Serie IV (E65, E66, E67) 07.01-12.09

#### Saloon (Luxury car-F Segment)

730 i, Li (M54 B30 (306S3))		Gasolina	RWD	2979	170	231	03.03-07.08	■
730 i, Li		Gasolina	RWD	2996	184	250	03.05-07.08	■
730 i, Li (N52 B30 A)	Long Wheelbase	Gasolina	RWD	2996	190	258	03.05-08.08	■
730 i, Li (N52 B30 BF)	Long Wheelbase	Gasolina	RWD	2996	190	258	03.05-08.08	■
735 i		Gasolina	RWD	3999	225	306	03.05-12.09	■
730 d (M57 D30 (306D2))		Diesel	RWD	2993	150	204	09.02-08.03	■
730 d (M57 D30 (306D2))		Diesel	RWD	2993	155	211	09.03-08.08	■
730 d (M57 D30 (306D3))		Diesel	RWD	2993	155	211	09.03-08.08	■
730 d (M57 D30 (306D2))		Diesel	RWD	2993	160	218	06.02-02.05	■