

LISTA DE APLICACIONES - BUYERS GUIDE

78BD0372-1



Weight: 6.550

O.E.M.	MAKE
6314200372	MERCEDES-BENZ
6314200772	MERCEDES-BENZ

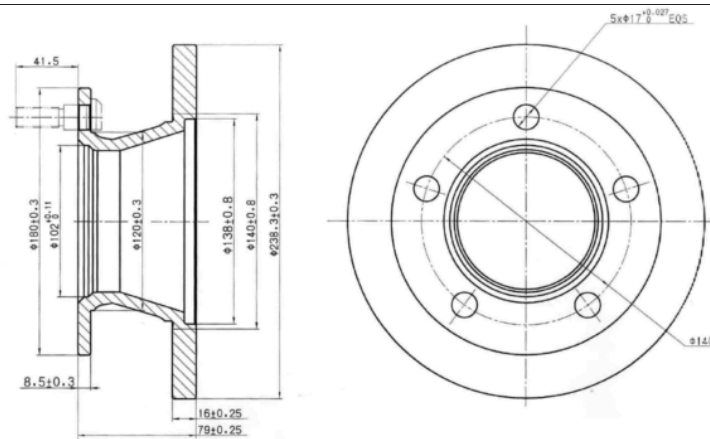

78BD0372-1



Ø238.3x16x120.5

MAKE
MERCEDES-BENZ
SSANGYONG



Trac.	CC	Kw	CV
-------	----	----	----



Front / Rear

MERCEDES-BENZ

MB (W631) 02.88-04.96

2.0 D (OM 615.963)	Diesel	FWD	1988	44	60	04.88-08.93	■
2.0 D (OM 615.970)	Diesel	FWD	1988	44	60	04.88-08.93	■
2.0 D (OM 615.970)	Diesel	FWD	1988	45	61	09.93-04.96	■
D (OM 616)	Diesel	FWD	2399	41	56	12.90-12.94	■
D (631.333, 631.343, 631.334, 631.344) (OM 616.963)	Diesel	FWD	2399	53	72	02.88-05.92	■
D (631.333, 631.343, 631.334, 631.344) (OM 616)	Diesel	FWD	2399	55	75	12.90-02.96	■
D (631.333, 631.343, 631.334, 631.344) (OM 616.963)	Diesel	FWD	2399	55	75	12.90-02.96	■

MB (W631) 02.88-02.96

D (631.340) (OM 616.963)	Diesel	FWD	2399	53	72	02.88-05.92	■
D (631.340) (OM 616.963)	Diesel	FWD	2399	55	75	12.90-02.96	■

MB (W631) 02.88-09.96

2.0 D (OM 615.970)		Diesel	FWD	1988	44	60	04.88-08.93	■
2.0 D (OM 615.970)		Diesel	FWD	1988	45	61	09.93-04.96	■
D (631.332, 631.342) (OM 616.963)		Diesel	FWD	2399	53	72	02.88-05.92	■
D (631.332, 631.342) (OM 616.963)		Diesel	FWD	2399	55	75	12.90-02.96	■
2.4 D		Diesel	FWD	2399	56	76	01.93-01.96	■

MB II (KPA) 11.99-05.05

2.3 i	Gasolina	FWD	2295	90	122	11.99-05.05	■
2.3 i	Gasolina	FWD	2295	90	122	11.99-05.05	■
2.3 D	Diesel	RWD	2299	58	79	11.99-01.03	■

LISTA DE APLICACIONES - BUYERS GUIDE

100 2.4 D	Diesel	FWD	2399	53	72	11.99-12.02	■
2.9 D	Diesel	RWD	2874	70	95	10.01-05.05	■
2.9 D	Diesel	RWD	2874	70	95	10.01-05.05	■

SSANGYONG

ISTANA 10.92-05.95				Bus (Minibus-M2-Segment)			
2.3	Gasolina	FWD	2295	110	150	06.95-11.03	■
2.9 TD (OM 602.940)	Diesel	RWD	2874	70	95	10.92-05.95	■
2.9 D (OM 602.980)	Diesel	RWD	2874	90	122	06.95-11.03	■
ISTANA 10.92-05.95				Van (LCVs-N1 Segment)			
2.9 D (OM 602.940)	Diesel	RWD	2874	70	95	10.92-05.95	■
2.9 D (OM 602.980)	Diesel	RWD	2874	90	122	06.95-11.03	■