

# LISTA DE APLICACIONES - BUYERS GUIDE

## 78BD0504-2



Weight: 14.044

O.E.M.	MAKE
43512-05040	TOYOTA

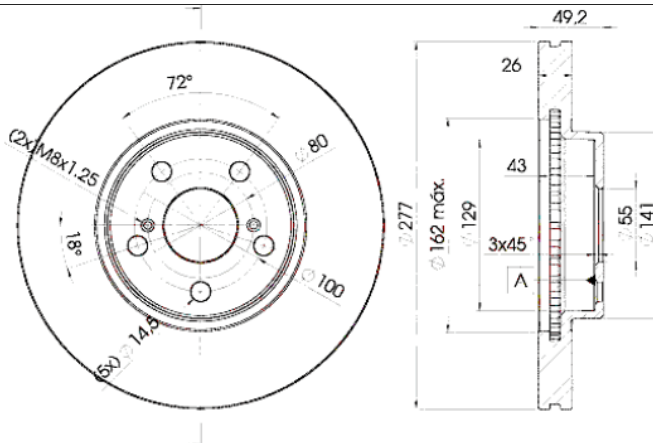

## 78BD0504-2



90R-02C0452/0078



Ø277x26x49.2

MAKE
TOYOTA



Trac.	CC	Kw	CV
-------	----	----	----



Front / Rear

### TOYOTA

#### AVENSIS II (\_T25\_) 04.03-11.08

#### Estate (Large family car-D Segment)

1.6 VVT-i (ZZT250_, ZZT250R) (3ZZ-FE)	Gasolina	FWD	1598	81	110	04.03-11.08	■
1.8 VVT-i (ZZT251_, ZZT251R) (1ZZ-FE)	Gasolina	FWD	1794	95	129	04.03-11.08	■
2.0 VVT-i (AZT250_, AZT250R) (1AZ-FSE)	Gasolina	FWD	1998	108	147	04.03-11.08	■

#### AVENSIS II (\_T25\_) 03.03-11.08

#### Hatchback (Large family car-D Segment)

1.6 VVT-i (ZZT250_, ZZT250R) (3ZZ-FE)	Gasolina	FWD	1598	81	110	04.03-11.08	■
1.8 VVT-i (ZZT251_, ZZT251R) (1ZZ-FE)	Gasolina	FWD	1794	95	129	03.03-10.08	■
2.0 VVT-i (AZT250_, AZT250R) (1AZ-FSE)	Gasolina	FWD	1998	108	147	03.03-11.08	■
2.0 VVTi (AZT250_)	Gasolina	FWD	1998	114	155	03.03-10.08	■

#### AVENSIS II (\_T25\_) 01.03-04.09

#### Saloon (Large family car-D Segment)

1.6 VVT-i (ZZT250_, ZZT250R) (3ZZ-FE)	Gasolina	FWD	1598	81	110	04.03-11.08	■
1.8 VVT-i (ZZT251_, ZZT251R) (1ZZ-FE)	Gasolina	FWD	1794	95	129	04.03-11.08	■
2.0 VVT-i (AZT250_, AZT250R) (1AZ-FSE)	Gasolina	FWD	1998	108	147	04.03-11.08	■