

LISTA DE APLICACIONES - BUYERS GUIDE

78BD0580-2



Weight: 16.400

| O.E.M. | MAKE |
|-------------|---------|
| 51712-2L500 | HYUNDAI |

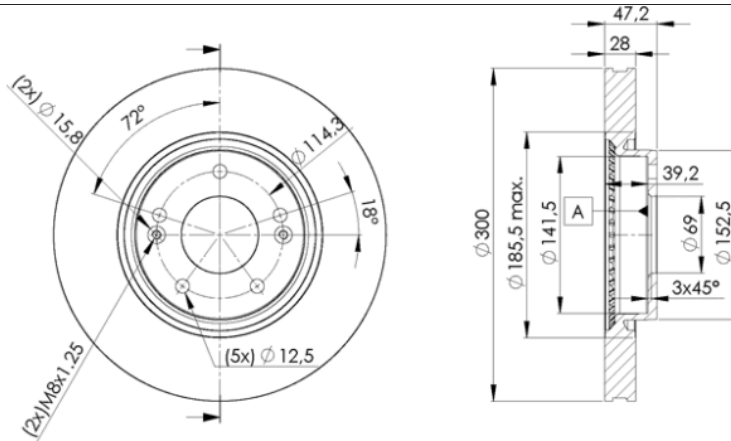

78BD0580-2

E1 90R-02C0452/0127



Ø300x28x47.2

| MAKE |
|---------|
| HYUNDAI |
| KIA |



| Trac. | CC | Kw | CV | |
|-------|----|----|----|--------------|
| | | | | Front / Rear |

HYUNDAI

| GRANDEUR V / AZERA V (HG) 01.11- | | | | | Saloon (Executive car-E Segment) | | | |
|---------------------------------------|--|---------------|-----|------|-----------------------------------|-----|-------------|---|
| 2.4 GDI | | Gasolina | FWD | 2359 | 140 | 190 | 02.11-04.16 | ■ |
| 3.0 GDi (G6DG) | | Gasolina | FWD | 2999 | 195 | 265 | 12.11- | |
| i30 (FD) 10.07-06.12 | | | | | Estate (Compact car-C Segment) | | | |
| 2.0 (G4GC) | | Gasolina | FWD | 1975 | 105 | 143 | 02.08-06.12 | ■ |
| 2.0 CRDi (D4EA) | | Diesel | FWD | 1991 | 103 | 140 | 02.08-06.12 | |
| i30 (FD) 10.07-07.12 | | | | | Hatchback (Compact car-C Segment) | | | |
| 2.0 (G4GC) | | Gasolina | FWD | 1975 | 105 | 143 | 10.07-11.11 | ■ |
| 2.0 CRDi (D4EA) | | Diesel | FWD | 1991 | 103 | 140 | 10.07-11.11 | |
| i30 II (GD) 06.11- | | | | | Hatchback (Compact car-C Segment) | | | |
| 1.8 (G4NB) | | Gasolina | FWD | 1797 | 110 | 150 | 01.12- | ■ |
| ix35 / TUCSON II (LM, EL, ELH) 08.09- | | | | | SUV (Compact SUV-J Segment) | | | |
| 2.4 4WD (G4KE) | | Gasolina | 4WD | 2359 | 130 | 177 | 01.10-12.15 | ■ |
| 2.0 Flex | | Gasol./Etanol | FWD | 1999 | 131 | 178 | 05.12-08.15 | |
| SONATA VI / i45 VI (YF) 06.09-12.15 | | | | | Saloon (Executive car-E Segment) | | | |
| 2.0 (G4KD) | | Gasolina | FWD | 1998 | 110 | 150 | 06.09-06.14 | ■ |
| 2.0 i (G4KD) | | Gasolina | FWD | 1998 | 120 | 163 | 09.12-06.14 | |
| 2.0 i (G4KD) | | Gasolina | FWD | 1998 | 121 | 165 | 01.11-06.14 | ■ |
| 2.0 (G4NA) | | Gasolina | FWD | 1999 | 126 | 172 | 10.12-06.14 | |
| 2.4 (G4KC) | | Gasolina | FWD | 2359 | 128 | 174 | 06.09-11.10 | ■ |
| 2.4 (G4KJ) | | Gasolina | FWD | 2359 | 142 | 193 | 09.11-12.14 | |

LISTA DE APLICACIONES - BUYERS GUIDE

| | | | | | | | | |
|---|--|-------------------|-----|------|--|-----|-------------|---|
| 2.0 Hybrid (G4NA) | | Gasol./el éc. | FWD | 1999 | 110 | 150 | 01.11-06.14 | ■ |
| SONATA VII (LF) 03.14-06.23 | | | | | Saloon (Executive car-E Segment) | | | |
| 2.0 Hybrid | | Gasol./el éc. | FWD | 1999 | 110 | 150 | 09.14-12.19 | ■ |
| VELOSTER (FS) 03.11- | | | | | Coupe (Supermini car-B Segment) | | | |
| 1.6 T-GDI | | Gasolina | FWD | 1591 | 150 | 204 | 08.12-12.17 | ■ |
| KIA | | | | | | | | |
| CARENS III / RONDO III (RP) 01.13- | | | | | MPV (Compact MPV-M1 Segment) | | | |
| 2.0 MPi | | Gasolina | FWD | 1999 | 110 | 150 | 03.13-08.16 | ■ |
| 2.0 GDI | | Gasolina | FWD | 1999 | 121 | 165 | 06.16-08.16 | ■ |
| CERATO III / FORTE III / K3 (YD) 09.12- | | | | | Saloon (Compact car-C Segment) | | | |
| 2.0 MPi (G4NA) | | Gasolina | FWD | 1999 | 112 | 152 | 03.16-06.18 | ■ |
| CERATO III / FORTE III / K3 EURO (YD) 09.12- | | | | | Hatchback (Compact car-C Segment) | | | |
| 1.6 CVVT (G4FC) | | Gasolina | FWD | 1591 | 95 | 129 | 11.14- | ■ |
| CERATO III KOUP / K3 KOUP (YD) 12.13- | | | | | Coupe (Compact car-C Segment) | | | |
| 1.6 T-GDI (G4FJ) | | Gasolina | FWD | 1591 | 150 | 204 | 12.13- | ■ |
| PRO CEE'D II (JD) 03.12- | | | | | Hatchback Van (Compact car-C Segment) | | | |
| 1.0 T-GDI | | Gasolina | FWD | 998 | 88 | 120 | 05.15-07.18 | ■ |
| 1.4 MPI | | Gasolina | FWD | 1368 | 74 | 101 | 05.15-07.18 | ■ |
| 1.6 CRDI | | Diesel | FWD | 1582 | 100 | 136 | 05.15-07.18 | ■ |
| SOUL II (PS) 02.14- | | | | | Hatchback (Mini MPV-M1 Segment) | | | |
| 1.6 CVVT | | Gasolina | FWD | 1591 | 95 | 129 | 07.16-12.18 | ■ |
| 1.6 CVVT Flex | | Gasol./Et anol | FWD | 1591 | 94 | 128 | 09.14-12.18 | ■ |
| SPORTAGE III (SL) 09.09- | | | | | SUV (Compact SUV-J Segment) | | | |
| 2.4 i AWD (G4KE) | | Gasolina | 4WD | 2359 | 130 | 177 | 08.10-12.15 | ■ |
| 2.4 GDI AWD | | Gasolina | 4WD | 2359 | 136 | 185 | 09.13-05.16 | ■ |
| 2.0 CVVT Flex | | Gasol./Et anol | FWD | 1998 | 131 | 178 | 02.12-12.16 | ■ |
| 2.0 CVVT Flex AWD | | Gasol./Et anol | 4WD | 1998 | 131 | 178 | 01.12-12.16 | ■ |
| 2.0 CRDi (D4HA) | | Diesel | FWD | 1995 | 130 | 177 | 08.12-12.16 | ■ |
| 2.0 CRDi AWD (D4HA) | | Diesel | 4WD | 1995 | 130 | 177 | 08.12-12.16 | ■ |