

LISTA DE APLICACIONES - BUYERS GUIDE

78BD0602-2



Weight: 8.120

O.E.M.	MAKE
40206-0M801	NISSAN
40206-0M802	NISSAN

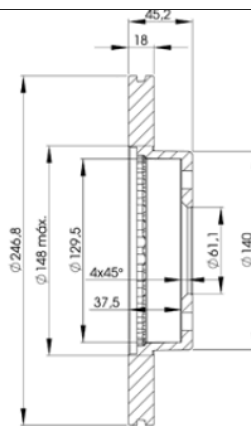

78BD0602-2

E1 90R-02C0452/0117



Ø247x18x45.2

MAKE
NISSAN



Trac.	CC	Kw	CV
-------	----	----	----



Front / Rear

NISSAN

ALMERA / PULSAR (N15) 07.95-01.01

Hatchback (Compact car-C Segment)

1.4 S, GX, LX (GA14DE)	Gasolina	FWD	1392	55	75	09.95-03.00	■
1.4 (GA14DE)	Gasolina	FWD	1392	64	87	09.95-03.00	■
1.5 (GA15DE)	Gasolina	FWD	1497	77	105	07.95-03.00	■
1.6 SR, SLX (GA16DE)	Gasolina	FWD	1597	66	90	09.95-03.00	■
1.6 (GA16DE)	Gasolina	FWD	1597	73	99	09.95-03.00	■
1.6	Gasolina	FWD	1597	75	102	07.95-03.00	■
2.0 D (CD20)	Diesel	FWD	1974	55	75	11.95-03.00	■

ALMERA / PULSAR / SENTRA (N15) 07.95-09.00

Saloon (Compact car-C Segment)

1.4 GX,LX (GA14DE)	Gasolina	FWD	1392	55	75	09.95-07.00	■
1.4 (GA14DE)	Gasolina	FWD	1392	64	87	09.95-07.00	■
1.5 (GA15DE)	Gasolina	FWD	1497	77	105	07.95-05.00	■
1.6 SLX (GA16DE)	Gasolina	FWD	1597	66	90	09.95-07.00	■
1.6 (GA16DE)	Gasolina	FWD	1597	73	99	09.95-07.00	■
1.6 (GA16DE)	Gasolina	FWD	1597	75	102	07.95-03.00	■
2.0 D (CD20)	Diesel	FWD	1974	55	75	11.95-07.00	■

PRESEA (R11) 03.90-12.00

Saloon (Compact car-C Segment)

1.8	Gasolina	FWD	1838	81	110	03.90-08.95	■
2.0	Gasolina	FWD	1998	103	140	03.90-08.95	■
2.0	Gasolina	FWD	1998	107	145	08.97-08.00	■

PULSAR / SABRE (N15) 07.95-07.00

Saloon (Supermini car-B Segment)

1.6	-04/98, vehicles without ABS	Gasolina	FWD	1597	73	99	07.95-05.00	■
-----	------------------------------	----------	-----	------	----	----	-------------	---