

LISTA DE APLICACIONES - BUYERS GUIDE

78BD0751-2



Weight: 9.340

O.E.M.	MAKE
5 69 015	OPEL
5 69 026	OPEL
90 008 001	VAUXHALL
92 807 51	VAUXHALL

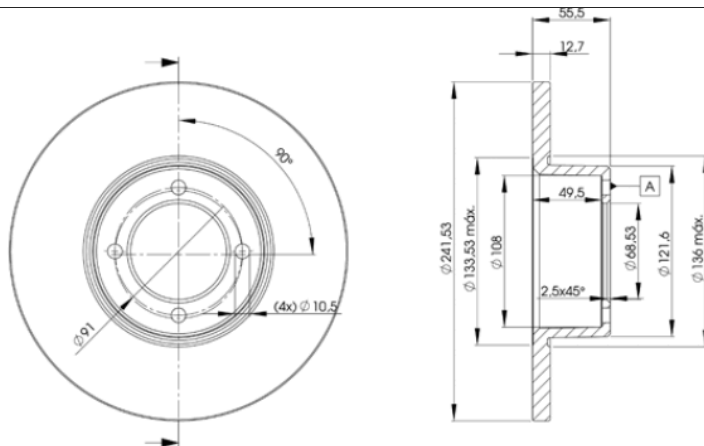

78BD0751-2



Ø246x12.5x55.5

MAKE
BEDFORD
CHEVROLET
DAEWOO
OPEL
VAUXHALL



Trac.	CC	Kw	CV
-------	----	----	----



Front / Rear

BEDFORD

ASTRAMAX 09.85-06.90						Box Body/MPV (Compact car-C Segment)		
1.6 D (16 D)	Diesel	FWD	1598	40	54	09.85-08.88	■	
1.6 D (16 DA)	Diesel	FWD	1598	42	57	09.85-08.88	■	
1.7 D (17 D)	Diesel	FWD	1699	42	57	09.88-06.90	■	

CHEVROLET

CORSA 03.94-12.10						Hatchback (Supermini car-B Segment)		
1.4 GLS (08, 68, 73, 78) (2H6(85CUL4))	not sport chassis	Gasolina	FWD	1389	44	60	08.94-07.97	■
1.4 GLS (08, 68, 73, 78) (LQ5(85CUL4))	not sport chassis	Gasolina	FWD	1389	44	60	08.94-07.97	■
CORSA 08.94-12.10						Pickup (Supermini car-B Segment)		
1.4 GLS (2H6)	sports chassis	Gasolina	FWD	1389	44	60	08.94-07.97	■
CORSA 03.94-12.10						Saloon (Supermini car-B Segment)		
1.4 GLS (2H6)	sports chassis	Gasolina	FWD	1389	44	60	08.94-07.97	■

DAEWOO

NEXIA / CIELO 02.95-08.97						Hatchback (Supermini car-B Segment)		
1.5 (08, 68) (G15MF)	Rim 14	Gasolina	FWD	1498	55	75	02.95-08.97	■

OPEL

ASCONA B (81_, 86_, 87_, 88_) 09.75-08.81						Saloon (Executive car-E Segment)		
1.2 (12 N)	Gasolina	RWD	1196	40	55	08.76-02.79	■	
1.2 S (12 S)	Gasolina	RWD	1196	44	60	09.75-02.79	■	
1.3 N (13 N)	Gasolina	RWD	1297	44	60	03.79-08.81	■	
1.3 S (13 S)	Gasolina	RWD	1297	55	75	08.79-08.81	■	

LISTA DE APLICACIONES - BUYERS GUIDE

1.6 N (16 N)		Gasolina	RWD	1584	44	60	09.75-08.81	■
1.6 S (16 S)		Gasolina	RWD	1584	55	75	09.75-08.81	■
1.9 N (19 N)		Gasolina	RWD	1897	55	75	08.76-08.81	■
1.9 S (19 S)		Gasolina	RWD	1897	66	90	09.75-08.81	■
2.0 N (20 N)		Gasolina	RWD	1979	66	90	08.77-08.81	■
2.0 S (20 S)		Gasolina	RWD	1979	74	100	08.77-08.81	■
2.0 E (20 E)		Gasolina	RWD	1979	81	110	08.79-08.81	■
2.4 400 (24 E)		Gasolina	RWD	2410	106	144	07.80-08.81	■
2.0 D (20 D)		Diesel	RWD	1998	43	58	08.78-08.81	■
ASCONA C (J82) 09.81-10.88					Saloon (Executive car-E Segment)			
1.8 (F11, M11, F68, M68) (E 18 NV)		Gasolina	FWD	1796	62	84	09.87-08.88	■
1.8 E (F11, M11, F68, M68) (C 18 NE)		Gasolina	FWD	1796	74	100	01.85-08.86	■
1.8 E (F11, M11, F68, M68) (S 18 NV)		Gasolina	FWD	1796	74	100	01.85-08.86	■
1.8 i (F11, M11, F68, M68) (18 E)		Gasolina	FWD	1796	85	115	09.82-08.86	■
2.0		Gasolina	FWD	1979	81	110	09.81-08.83	■
2.0 i (F11, M11, F68, M68) (20 NE)		Gasolina	FWD	1998	85	115	09.86-08.88	■
2.0 i Cat (F11, M11, F68, M68) (C 20 NE)		Gasolina	FWD	1998	85	116	09.86-08.88	■
ASTRA F (T92) 10.91-01.99					Estate Van (Compact car-C Segment)			
1.6 i (F70) (C 16 SE)		Gasolina	FWD	1598	74	101	03.92-12.94	■
COMBO B (71_) 07.94-10.01					Box Body/MPV (LCVs-N1 Segment)			
1.4 (C 14 NZ)		Gasolina	FWD	1389	44	60	07.94-10.01	■
1.4 (X 14 SZ)		Gasolina	FWD	1389	44	60	07.94-10.01	■
1.4 (C 14 SE)		Gasolina	FWD	1389	60	82	07.94-10.01	■
1.4 16V (X 14 XE)		Gasolina	FWD	1389	66	90	08.99-10.01	■
CORSA B (S93) 04.98-12.02					Estate (Supermini car-B Segment)			
1.4 i 16V (F35) (X 14 XE)		Gasolina	FWD	1389	66	90	01.99-12.02	■
KADETT C 08.73-07.79					Coupe (Compact car-C Segment)			
1.6 S (16 S)		Gasolina	RWD	1584	55	75	05.77-07.79	■
1.9 GT/E (19 E)		Gasolina	RWD	1897	77	105	09.75-07.77	■
2.0 E Rallye (20 E)		Gasolina	RWD	1979	81	110	08.77-07.79	■
2.0 GT/E (20 EH)		Gasolina	RWD	1979	85	115	08.77-07.79	■
KADETT C 08.73-07.79					Estate (Compact car-C Segment)			
1.6 S (16 S)		Gasolina	RWD	1584	55	75	05.77-07.79	■
KADETT C 08.73-07.79					Hatchback (Compact car-C Segment)			
1.6 S (16 S)		Gasolina	RWD	1584	55	75	05.77-07.79	■
KADETT C 08.73-07.79					Saloon (Compact car-C Segment)			
1.6 S (16 S)		Gasolina	RWD	1584	55	75	09.76-07.79	■
KADETT E (T85) 09.84-12.93					Hatchback (Compact car-C Segment)			
1.8 (43, 34, 44)		Gasolina	FWD	1796	82	111	08.85-08.88	■
MANTA A (58_, 59_) 09.70-08.75					Coupe (Sports car-S Segment)			
1.2 (12 S)		Gasolina	RWD	1196	44	60	04.72-08.75	■
1.6 (16 N)		Gasolina	RWD	1584	44	60	02.75-08.75	■
1.6 (16 N)		Gasolina	RWD	1584	50	68	09.70-08.75	■
1.6 (16 S)		Gasolina	RWD	1584	55	75	02.75-08.75	■
1.6 S (16 S)		Gasolina	RWD	1584	59	80	09.70-08.75	■
1.9 S (19 S)		Gasolina	RWD	1897	65	88	09.70-08.75	■
1.9 S (19 S)		Gasolina	RWD	1897	66	90	09.70-08.75	■

LISTA DE APLICACIONES - BUYERS GUIDE

1.9 GT/E (19 E)		Gasolina	RWD	1897	77	105	02.74-08.75	■
MANTA B (53_, 55_) 09.75-08.88					Coupe (Sports car-S Segment)			
1.2 N (12 N)		Gasolina	RWD	1196	40	55	08.76-07.83	■
1.2 S (12 S)		Gasolina	RWD	1196	44	60	09.75-02.79	■
1.3 N (13 N)		Gasolina	RWD	1297	44	60	03.79-12.80	■
1.3 S (13 S)		Gasolina	RWD	1297	55	75	08.79-08.86	■
1.6 N (16 N)		Gasolina	RWD	1584	44	60	09.75-12.80	■
1.6 (16 S)		Gasolina	RWD	1584	51	69	09.75-08.81	■
1.6 (16 S)		Gasolina	RWD	1584	55	75	08.77-07.81	■
1.8 S (18 S)		Gasolina	RWD	1796	66	90	07.82-08.87	■
1.9 N (19 N)		Gasolina	RWD	1897	55	75	08.76-12.81	■
1.9 S (19 S)		Gasolina	RWD	1897	66	90	09.75-12.80	■
2.0 (20 N)		Gasolina	RWD	1979	66	90	08.77-12.80	■
2.0 S (20 S)		Gasolina	RWD	1979	74	100	08.77-08.84	■
2.0 E (20 E)		Gasolina	RWD	1979	81	110	08.77-08.88	■
2.0 (20 ER)		Gasolina	RWD	1979	92	125	08.81-07.88	■
2.4 400 (24 E)		Gasolina	RWD	2410	106	144	07.80-08.84	■
MANTA B (58_, 59_) 09.75-08.88					Saloon (Sports car-S Segment)			
1.3 N (13 N)		Gasolina	RWD	1297	44	60	03.79-12.80	■
1.3 S (13 S)		Gasolina	RWD	1297	55	75	08.81-08.86	■
1.6 N (16 N)		Gasolina	RWD	1584	44	60	09.75-12.80	■
1.6 (16 S)		Gasolina	RWD	1584	51	69	09.75-08.81	■
1.6 S (16 S)		Gasolina	RWD	1584	55	75	09.75-12.81	■
1.8 S (18 S)		Gasolina	RWD	1796	66	90	07.82-08.87	■
1.9 N (19 N)		Gasolina	RWD	1897	55	75	08.76-12.81	■
1.9 E (19 E)		Gasolina	RWD	1897	77	105	09.75-08.77	■
2.0 (20 N)		Gasolina	RWD	1979	66	90	08.77-12.80	■
2.0 S (20 S)		Gasolina	RWD	1979	74	100	08.77-08.84	■
2.0 E (20 E)		Gasolina	RWD	1979	81	110	08.77-08.88	■
REKORD D 01.72-08.77					Coupe (Large family car-D Segment)			
1.7 S (17 S)		Gasolina	RWD	1698	61	83	01.72-02.75	■
1.9 (19 N)	09/75-	Gasolina	RWD	1897	55	75	03.75-08.77	■
1.9 (19 SH)	09/75-	Gasolina	RWD	1897	66	90	03.75-08.77	■
1.9 S (19 SH)		Gasolina	RWD	1897	71	97	01.72-02.75	■
2.0 (20 S)		Gasolina	RWD	1979	74	100	09.75-08.77	■
REKORD D 01.72-08.77					Estate (Large family car-D Segment)			
1.7 (17 N)	09/75-	Gasolina	RWD	1698	44	60	03.75-08.77	■
1.7 (17 N)		Gasolina	RWD	1698	49	67	01.72-02.75	■
1.7 S (17 S)		Gasolina	RWD	1698	61	83	01.72-02.75	■
1.9 (19 N)	09/75-	Gasolina	RWD	1897	55	75	03.75-08.77	■
1.9 (19 SH)	09/75-	Gasolina	RWD	1897	66	90	03.75-08.77	■
1.9 S (19 SH)		Gasolina	RWD	1897	71	97	01.72-02.75	■
2.0 S (20 S)		Gasolina	RWD	1979	74	100	09.75-08.77	■
2.0 D (20 D)		Diesel	RWD	1998	40	54	08.74-08.77	■
2.1 D (21 D)		Diesel	RWD	2068	44	60	09.72-08.77	■
REKORD D 01.72-08.77					Saloon (Large family car-D Segment)			
1.7 (17 N)	09/75-	Gasolina	RWD	1698	44	60	03.75-08.77	■
1.7 (17 N)		Gasolina	RWD	1698	49	66	01.72-02.75	■
1.7 S (17 S)		Gasolina	RWD	1698	61	83	01.72-02.75	■

LISTA DE APLICACIONES - BUYERS GUIDE

1.9 (19 N)	09/75-	Gasolina	RWD	1897	55	75	03.75-08.77	■
1.9 (19 SH)	09/75-	Gasolina	RWD	1897	66	90	03.75-08.77	■
1.9 S (19 SH)		Gasolina	RWD	1897	71	97	01.72-02.75	■
2.0 (20 S)		Gasolina	RWD	1979	74	100	09.75-08.77	■
2.0 D (20 D)		Diesel	RWD	1998	40	54	08.74-08.77	■
2.1 D (21 D)		Diesel	RWD	2068	44	60	09.72-08.77	■
REKORD E (61_, 66_, 67_) 08.77-08.86					Estate (Large family car-D Segment)			
1.7 (17 N)		Gasolina	RWD	1698	44	60	09.77-10.82	■
1.8 (18 N)		Gasolina	RWD	1796	55	75	11.82-08.86	■
1.8 S (18 S)		Gasolina	RWD	1796	66	90	11.82-08.86	■
1.8 E (C 18 NV)		Gasolina	RWD	1796	74	100	05.85-08.86	■
1.9 (19 N)		Gasolina	RWD	1897	55	75	09.77-10.82	■
2.0 (20 N)		Gasolina	RWD	1979	66	90	09.77-10.82	■
2.0 S (20 S)		Gasolina	RWD	1979	74	100	08.77-08.86	■
2.0 E (20 E)		Gasolina	RWD	1979	81	110	09.77-10.84	■
2.2 E (22 E)		Gasolina	RWD	2197	85	115	11.84-08.86	■
2.0 D (20 D)		Diesel	RWD	1998	43	58	09.77-10.82	■
2.1 D (21 D)		Diesel	RWD	2068	44	60	09.77-07.78	■
2.2 D (23 D)		Diesel	RWD	2260	48	65	08.78-08.83	■
2.3 D (23 D)		Diesel	RWD	2260	52	71	11.82-08.86	■
2.2 TD (23 TD)		Diesel	RWD	2260	63	86	06.84-08.86	■
REKORD E (17_, 11_, 14_, 16_, 18_, 19_) 08.77-08.86					Saloon (Large family car-D Segment)			
1.7 (17 N)		Gasolina	RWD	1698	44	60	09.77-10.82	■
1.8 (18 N)		Gasolina	RWD	1796	55	75	11.82-08.86	■
1.8 S (18 S)		Gasolina	RWD	1796	66	90	11.82-08.86	■
1.8 E (C 18 NV)		Gasolina	RWD	1796	74	100	05.85-08.86	■
1.9 (19 N)		Gasolina	RWD	1897	55	75	09.77-10.82	■
2.0 (20 N)		Gasolina	RWD	1979	66	90	09.77-10.82	■
2.0 S (20 S)		Gasolina	RWD	1979	74	100	08.77-08.86	■
2.0 E (20 E)		Gasolina	RWD	1979	81	110	09.77-10.84	■
2.2 E (22 E)		Gasolina	RWD	2197	85	115	11.84-08.86	■
2.0 D (20 D)		Diesel	RWD	1998	43	58	09.77-10.82	■
2.1 D (21 D)		Diesel	RWD	2068	44	60	09.77-07.78	■
2.2 D (23 D)		Diesel	RWD	2260	48	65	08.78-08.83	■
2.2 D (23 D)		Diesel	RWD	2260	52	71	11.82-08.86	■
2.2 TD (23 TD)		Diesel	RWD	2260	63	86	06.84-08.86	■
VECTRA A (J89) 08.88-12.95					Saloon (Large family car-D Segment)			
1.6 (F19, M19) (C 16 LZ2)		Gasolina	FWD	1598	51	69	08.92-07.93	■
1.6		Gasolina	FWD	1598	65	88	08.92-06.94	■
VAUXHALL								
ASTRA Mk II BELMONT (T85) 09.85-12.91					Saloon (Compact car-C Segment)			
1.8 i (C 18 NE)		Gasolina	FWD	1796	74	100	10.85-08.86	■
ASTRAMAX (T85) 08.85-10.94					Box Body/MPV (LCVs-N1 Segment)			
1.3 N (13 NB)		Gasolina	FWD	1297	44	60	08.85-12.89	■
1.4 S (14 NV)		Gasolina	FWD	1389	55	75	07.89-08.91	■
1.6 D (16 DA)		Diesel	FWD	1598	40	54	05.86-06.90	■
1.7 D (17 D)		Diesel	FWD	1699	42	57	01.89-07.94	■
CARLTON Mk II 09.77-08.86					Estate (Executive car-E Segment)			
1.8 S (18 S)		Gasolina	RWD	1796	66	90	11.82-08.86	■

LISTA DE APLICACIONES - BUYERS GUIDE

2.0 S (20 S)		Gasolina	RWD	1979	74	100	09.77-08.86	■
2.0 (20 E)		Gasolina	RWD	1979	81	110	09.77-08.86	■
2.0 (20 S)		Gasolina	RWD	1979	81	110	09.77-08.86	■
2.0 S		Gasolina	RWD	1998	74	100	01.82-08.86	■
2.2 i (22 E)		Gasolina	RWD	2197	85	115	11.84-08.86	■
2.3 D (23 D)		Diesel	RWD	2260	48	65	09.80-08.86	■
2.3 D (23 D)	09/83-	Diesel	RWD	2260	52	71	05.83-08.86	■
CARLTON Mk II 10.78-08.86					Saloon (Executive car-E Segment)			
1.8 (18 N)		Gasolina	RWD	1796	55	75	09.81-08.86	■
1.8 S (18 S)		Gasolina	RWD	1796	65	88	12.82-08.86	■
2.0 i (20 E)		Gasolina	RWD	1979	81	110	01.83-12.84	■
2.0 i (20 S)		Gasolina	RWD	1979	81	110	01.83-12.84	■
2.0 S (C 20 NEJ)		Gasolina	RWD	1998	74	100	10.78-08.86	■
2.2 i (22 E)		Gasolina	RWD	2197	85	115	11.84-08.86	■
2.3 D		Diesel	RWD	2260	48	65	09.80-08.86	■
2.3 D (23 D)	09/83-	Diesel	RWD	2260	52	71	05.83-08.86	■
CARLTON Mk III (V87) 09.86-03.94					Estate (Executive car-E Segment)			
1.8		Gasolina	FWD	1796	74	100	09.86-08.88	■
CAVALIER Mk I 08.75-08.81					Coupe (Large family car-D Segment)			
1.3		Gasolina	FWD	1256	42	57	08.75-08.81	■
1.9 S		Gasolina	RWD	1897	66	90	10.75-03.78	■
2.0 S (20 S)		Gasolina	RWD	1979	74	100	03.78-08.81	■
CAVALIER Mk I 08.75-08.81					Saloon (Large family car-D Segment)			
1.3 (LW4)		Gasolina	RWD	1256	43	58	08.77-01.81	■
1.6 (16 S CIH)		Gasolina	RWD	1584	55	74	08.75-08.81	■
2.0 (20 S)		Gasolina	RWD	1979	74	100	01.79-01.81	■
CAVALIER Mk I 03.75-08.81					Targa (Large family car-D Segment)			
1300 (13 N)		Gasolina	RWD	1297	44	60	08.77-08.81	■
1.6 N (16 N (CIH))		Gasolina	RWD	1584	44	60	08.75-08.81	■
1.6 N		Gasolina	RWD	1584	44	60	03.75-08.75	■
1.6 S (16 S CIH)		Gasolina	RWD	1584	55	75	08.75-08.81	■
1900 (19 S)		Gasolina	RWD	1897	66	90	10.75-03.78	■
2.0 S (20 S)		Gasolina	RWD	1979	74	100	01.78-08.81	■
CAVALIER Mk I CC 03.75-08.81					Hatchback (Large family car-D Segment)			
1.3 (LW4)		Gasolina	RWD	1256	42	57	08.75-08.81	■
1600 (16 S CIH)		Gasolina	RWD	1584	55	75	09.75-08.81	■
2000 (20 S)		Gasolina	RWD	1979	74	100	08.77-08.81	■
VICEROY 01.80-10.82					Saloon (Executive car-E Segment)			
2500 (25 S)		Gasolina	RWD	2490	85	115	01.80-10.82	■