

LISTA DE APLICACIONES - BUYERS GUIDE

78BD0817-2



Weight: 6.784

O.E.M.	MAKE
42510-SD2-A00	ACURA
42510-SE0-000	HONDA
42510-SE0-010	HONDA
42510-SH3-000	HONDA
42510-SH3-G00	ACURA
42510-SK3-305	HONDA
42510-SK3-E00	HONDA
42510-SK7-A00	HONDA
42511 SE0 000	MG
42511-SE0-000	ROVER
EGP1254	ROVER
GBD90817	LOTUS

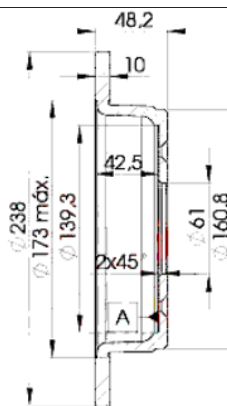
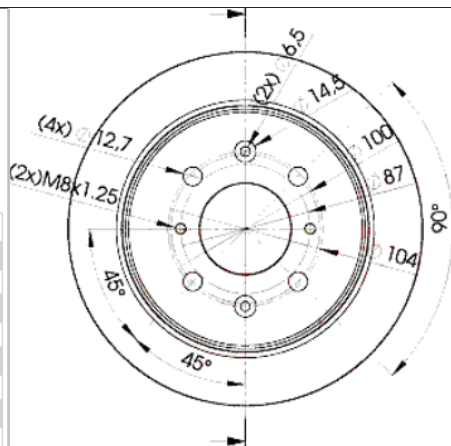

78BD0817-2



Ø239x10x48.1

MAKE
ACURA
HONDA
LOTUS
MG
ROVER



Trac.	CC	Kw	CV		
					Front / Rear

ACURA

INTEGRA 01.85-12.90

						Coupe (Sport compact car-C Segment)		
1.5 (D15A1)	Gasolina	FWD	1488	63	85	01.85-12.90		■
1.6 (D16A3)	Gasolina	FWD	1590	74	100	01.85-12.90		■
1.6 i (D16A8)	Gasolina	FWD	1590	88	120	01.85-12.90		■

INTEGRA 01.85-12.90

						Hatchback (Sport compact car-C Segment)		
1.5 (D15A1)	Gasolina	FWD	1488	63	85	01.85-12.90		■
1.6 (D16A1)	Gasolina	FWD	1590	74	100	01.85-12.90		■
1.6 i (D16A8)	Gasolina	FWD	1590	88	120	01.85-12.90		■

INTEGRA 01.85-12.90

						Saloon (Sport compact car-C Segment)		
1.5 (D15A1)	Gasolina	FWD	1488	63	85	01.85-12.90		■
1.6 (D16A3)	Gasolina	FWD	1590	74	100	01.85-12.90		■
1.6 i (D16A8)	Gasolina	FWD	1590	88	120	01.85-12.90		■

HONDA

ACCORD III 03.85-12.89

						Coupe (Executive car-E Segment)		
2.0 EXi (A20A3)	Gasolina	FWD	1955	90	122	01.88-12.89		■

ACCORD III (CA) 11.85-12.89

						Saloon (Executive car-E Segment)		
1.6 L (CA4) (A16A1)	Gasolina	FWD	1598	65	88	11.85-12.89		■
2.0 12V (CA5) (A20A1)	Gasolina	FWD	1955	75	102	01.86-03.88		■
2.0 EX (CA5) (A20A1)	Gasolina	FWD	1955	75	102	11.85-12.89		■
2.0 EX (CA5) (A20A1)	Gasolina	FWD	1955	76	103	11.85-12.89		■
2.0 EX (CA5) (A20A2)	Gasolina	FWD	1955	78	106	11.85-05.89		■
2.0 12V (CA5)	Gasolina	FWD	1955	85	116	01.87-12.89		■

LISTA DE APLICACIONES - BUYERS GUIDE

2.0 EXi (CA5) (A20A3)		Gasolina	FWD	1955	85	116	01.86-12.89	■
2.0 EXi (CA5) (A20A4)		Gasolina	FWD	1955	90	122	11.85-12.87	■
2.0 i 16V (CA5) (B20A8)		Gasolina	FWD	1958	98	133	10.87-12.89	■
2.0 i 16V (CA5) (B20A2)		Gasolina	FWD	1958	101	137	01.87-12.87	■
ACCORD III Aerodeck (CA) 11.85-12.89					Estate (Executive car-E Segment)			
2.0 EX (CA5) (A20A1)		Gasolina	FWD	1955	75	102	10.87-12.89	■
2.0 EX (CA5) (A20A1)		Gasolina	FWD	1955	76	103	10.87-12.89	■
2.0 EX (CA5) (A20A2)		Gasolina	FWD	1955	78	106	11.85-05.89	■
2.0 EXi (CA5) (A20A3)		Gasolina	FWD	1955	85	116	10.87-12.89	■
2.0 EXi (CA5) (A20A4)		Gasolina	FWD	1955	90	122	11.85-12.87	■
2.0 (A20A2)		Gasolina	FWD	1955	101	137	01.86-12.86	■
CIVIC IV / BALLADE (EC, ED, EE) 09.87-10.93					Hatchback (Supermini car-B Segment)			
1.6 i 16V (ED7) (D16A6)		Gasolina	FWD	1590	80	109	10.87-09.91	■
1.6 i 16V (ED7) (D16Z2)		Gasolina	FWD	1590	81	110	10.87-09.91	■
1.6 i 16V (D16A7)		Gasolina	FWD	1590	91	124	01.88-12.91	■
1.6 i 16V (ED7) (D16A7)		Gasolina	FWD	1590	96	130	09.87-09.91	■
1.6 i 16V (ED7) (D16A9)		Gasolina	FWD	1590	96	130	09.87-09.91	■
1.6 i 16V Vtec (EE9) (B16A1)		Gasolina	FWD	1595	110	150	10.89-09.91	■
CIVIC IV / BALLADE (ED) 09.87-10.93					Saloon (Supermini car-B Segment)			
1.5 (EW3)		Gasolina	FWD	1488	74	101	01.88-08.88	■
1.6 16V 4x4 (D16A6)		Gasolina	4WD	1590	79	107	11.87-09.91	■
1.6 i 16V (ED4) (D16A6)		Gasolina	FWD	1590	80	109	11.87-09.91	■
1.6 i 16V 4x4 (EE5) (D16A6)		Gasolina	4WD	1590	80	109	10.89-09.91	■
1.6 i 16V (ED4) (D16Z2)		Gasolina	FWD	1590	81	110	10.87-09.91	■
1.6 i 16V 4x4 (D16Z2)		Gasolina	4WD	1590	81	110	01.89-12.91	■
1.6 (D16Z5)		Gasolina	FWD	1590	91	124	01.88-12.89	■
1.6 4x4 (D16Z5)		Gasolina	4WD	1590	91	124	01.89-12.89	■
1.6 i 16V (ED4) (D16A7)		Gasolina	FWD	1590	96	130	09.87-09.91	■
1.6 4x4		Gasolina	4WD	1595	110	150	01.88-12.91	■
CIVIC VI (MA, MB) 09.94-02.01					Hatchback (Supermini car-B Segment)			
1.6 (D16Y7)		Gasolina	FWD	1590	79	107	10.95-12.00	■
1.6 i (MB1) (D16Y3)		Gasolina	FWD	1590	83	113	09.94-01.97	■
1.6 16V (MB4) (D16B2)		Gasolina	FWD	1590	85	116	01.97-02.01	■
1.6 (MB1) (D16Y2)	vehicles with ABS	Gasolina	FWD	1590	93	126	10.95-03.01	■
1.6 i Vtec (MB1) (D16Y2)		Gasolina	FWD	1590	93	126	09.94-01.97	■
1.6 VTi (MB4) (B16A2)		Gasolina	FWD	1595	118	160	01.97-02.01	■
2.0 i TD (MB7) (20T2R)		Diesel	FWD	1994	63	86	01.97-02.01	■
2.0 TDiC (MB7) (20T2N)		Diesel	FWD	1994	74	101	11.98-10.00	■
2.0 TDiC (20T2N)		Diesel	FWD	1994	77	105	11.98-10.00	■
2.0 TDiC (MB7) (20T2N)		Diesel	FWD	1994	77	105	11.98-10.00	■
CIVIC VI Aerodeck (MB, MC) 04.98-02.01					Estate (Supermini car-B Segment)			
2.0 i D (MC3)		Diesel	FWD	1994	74	101	04.98-02.01	■
2.0 i D (MC3) (20T2N)		Diesel	FWD	1994	77	105	04.98-02.01	■
CIVIC VII (EU, EP, EV) 01.00-02.06					Hatchback (Compact car-C Segment)			
1.4 i (EP1, EU7) (D14Z6)		Gasolina	FWD	1396	55	75	02.01-09.05	■
1.4 iS (EP1, EU5, EU7) (D14Z5)		Gasolina	FWD	1396	66	90	11.00-09.05	■
1.4 iS (EP1, EU5, EU7) (D14Z6)		Gasolina	FWD	1396	66	90	11.00-09.05	■

LISTA DE APLICACIONES - BUYERS GUIDE

CONCERTO (HW, MA) 08.89-10.96					Hatchback (Compact car-C Segment)			
1.5 i 16V (D15B2)		Gasolina	FWD	1493	66	90	08.89-03.95	■
1.6 16V (D16Z2)		Gasolina	FWD	1590	78	106	08.89-03.95	■
1.6 i 16V (D16Z2)		Gasolina	FWD	1590	82	112	08.89-03.95	■
1.6 i 16V (HW) (D16A8)		Gasolina	FWD	1590	90	122	08.89-03.95	■
1.6 i 16V (HW) (D16Z4)		Gasolina	FWD	1590	90	122	08.89-03.95	■
1.6 (D16A9)		Gasolina	FWD	1590	96	131	10.89-10.92	■
1.8 TD		Diesel	RWD	1769	58	79	08.94-10.96	■
1.8 TD		Diesel	RWD	1769	65	88	08.94-10.96	■
CONCERTO (HWW) 08.89-05.95					Saloon (Compact car-C Segment)			
1.5 i 16V (D15B2)		Gasolina	FWD	1493	66	90	08.89-05.95	■
1.6 16V (D16Z2)		Gasolina	FWD	1590	78	106	08.89-03.95	■
1.6 i 16V (D16Z2)		Gasolina	FWD	1590	82	112	08.89-03.95	■
1.6 i 16V (D16A8)		Gasolina	FWD	1590	90	122	08.89-03.95	■
1.6 i 16V (D16Z4)		Gasolina	FWD	1590	90	122	08.89-03.95	■
1.6 (D16A9)		Gasolina	FWD	1590	96	131	10.89-10.92	■
CRX II (ED, EE) 10.87-02.92					Coupe (Sports car-S Segment)			
1.6 i 16V (D16A)		Gasolina	FWD	1590	79	107	10.87-12.91	■
1.6 i 16V (D16A6)		Gasolina	FWD	1590	79	107	10.87-12.91	■
1.6 i 16V (ED9) (D16Z5)		Gasolina	FWD	1590	91	124	10.87-02.92	■
1.6 i 16V (ED9) (D16A8)		Gasolina	FWD	1590	96	131	10.87-12.89	■
1.6 i 16V (ED9) (D16A9)		Gasolina	FWD	1590	96	131	10.87-12.89	■
1.6 i 16V Vtec (EE8) (B16A1)		Gasolina	FWD	1595	110	150	10.89-02.92	■
INTEGRA I-II (DA) 10.85-08.93					Hatchback (Sport compact car-C Segment)			
1.5 (DA4) (D15A1)		Gasolina	FWD	1488	63	86	10.85-08.89	■
1.6 (DA1, DA3) (D16A3)		Gasolina	FWD	1590	88	120	03.86-08.89	■
INTEGRA II (DA5, DA6, DA7, DA8, DA9, DB1, DB2) 06.89-08.93					Saloon (Sport compact car-C Segment)			
1.6 Vtec (DA6)		Gasolina	FWD	1595	125	170	09.89-08.93	■
PRELUDE III (BA) 04.86-11.96					Coupe (Sport compact car-C Segment)			
2.0 EX (BA4) (B20A3)		Gasolina	FWD	1958	80	109	04.87-01.92	■
2.0 (BA4) (B20A4)		Gasolina	FWD	1958	84	114	08.87-01.92	■
2.0 i EX 16V		Gasolina	FWD	1958	101	137	04.86-12.87	■
2.0 i EX 16V (BA2) (B20A1)		Gasolina	FWD	1958	101	137	04.86-12.87	■
2.0 i EX 16V Cat (BA4) (B20A5)		Gasolina	FWD	1958	101	137	04.87-01.92	■
2.0 i EX 16V (BA4) (B20A9)		Gasolina	FWD	1958	103	140	10.87-01.92	■
2.0 i EX 16V (BA5) (B20A7)		Gasolina	FWD	1958	110	150	10.87-12.90	■
LOTUS								
ELISE 08.95-01.01					Convertible (Sports car-S Segment)			
1.8 (18 K4F)		Gasolina	RWD	1796	88	120	08.95-11.00	■
111 S (18 K4K)		Gasolina	RWD	1796	107	146	03.99-11.00	■
MG								
MG ZR 06.01-04.05					Hatchback (Supermini car-B Segment)			
105 (14 K4F)		Gasolina	FWD	1396	76	103	06.01-04.05	■
120 (18 K4F)		Gasolina	FWD	1796	86	117	06.01-04.05	■
2.0 TD (20 T2N)		Diesel	FWD	1994	74	100	06.01-04.05	■
2.0 TD (20 T2N)		Diesel	FWD	1994	83	113	12.02-04.05	■
ROVER								

LISTA DE APLICACIONES - BUYERS GUIDE

200 II (XW) 04.90-11.99					Convertible (Compact car-C Segment)			
214 1.4 (14 K4C)	-09/97	Gasolina	FWD	1396	66	90	01.92-11.99	■
214 1.4 (14 K4D)	-09/97	Gasolina	FWD	1396	66	90	01.92-11.99	■
214 1.4 (14 K4C)		Gasolina	FWD	1396	70	95	04.90-09.92	■
214 1.4i 16V (14 K4F)	-09/97	Gasolina	FWD	1396	76	103	01.93-11.99	■
216 1.6i 16V (16 K4F)	-06/99	Gasolina	FWD	1588	82	111	01.96-11.99	■
216 1.6 (D 16 Z2)		Gasolina	FWD	1590	82	111	04.90-02.96	■
216 1.6i (D 16 A8)	-02/96	Gasolina	FWD	1590	90	122	01.92-11.99	■
200 II (XW) 10.92-06.99					Coupe (Compact car-C Segment)			
216 (16 K4F)		Gasolina	FWD	1588	82	112	01.96-12.97	■
216 (D 16 A8)		Gasolina	FWD	1590	90	122	10.92-06.99	■
220 GSi (20 T4H)		Gasolina	FWD	1994	100	136	05.94-06.99	■
220TURBO (20 T4G)		Gasolina	FWD	1994	147	200	10.92-06.99	■
200 II (XW) 10.89-12.95					Hatchback (Compact car-C Segment)			
214 (14 K2A)		Gasolina	FWD	1396	55	75	09.93-12.95	■
214 (14 K2D)		Gasolina	FWD	1396	55	75	09.93-12.95	■
214 Si/GSi (14 K4C)		Gasolina	FWD	1396	66	90	10.89-10.95	■
214 Si/GSi (14 K4D)		Gasolina	FWD	1396	66	90	10.89-10.95	■
214 GSi/Si (14 K4C)		Gasolina	FWD	1396	70	95	01.90-10.95	■
214 GSi/Si (14 K4F)		Gasolina	FWD	1396	76	103	12.92-10.95	■
216 GSi (D 16 Z2)		Gasolina	FWD	1590	82	112	01.90-12.95	■
216 GSi (D 16 A7)		Gasolina	FWD	1590	85	116	10.89-10.95	■
216 GTi (D 16 A8)		Gasolina	FWD	1590	90	122	01.90-10.95	■
216 GTi (D 16 A9)		Gasolina	FWD	1590	96	130	09.90-10.95	■
220 GTi (20 T4H)		Gasolina	FWD	1994	100	136	01.93-10.95	■
220 GTi (20 M4F)		Gasolina	FWD	1994	103	140	09.91-10.95	■
220TURBO (20 T4G)		Gasolina	FWD	1994	147	200	01.93-12.95	■
2.0		Gasolina	FWD	1994	152	207	10.92-12.95	■
218 TD (XUD 7TE)		Diesel	FWD	1769	65	88	09.91-10.95	■
218d (XUD9)		Diesel	FWD	1905	47	64	09.91-09.92	■
218d (XUD9)		Diesel	FWD	1905	52	71	09.91-10.95	■
200 III (RF) 11.95-11.00					Hatchback (Compact car-C Segment)			
211 (11 K2D)		Gasolina	FWD	1120	44	60	01.98-03.00	■
214 i (14 K2F)		Gasolina	FWD	1396	55	75	11.95-03.00	■
1.4 (14 K4D)		Gasolina	FWD	1396	66	90	01.96-12.97	■
214 Si (14 K4F)		Gasolina	FWD	1396	76	103	11.95-03.00	■
216 Si (16 K4F)		Gasolina	FWD	1588	82	112	11.95-06.99	■
218 Si (18 K4F)		Gasolina	FWD	1796	88	120	08.99-03.00	■
218 K Vi (18 K4K)		Gasolina	FWD	1796	107	146	11.95-03.00	■
220 D/SD (20 T2R)		Diesel	FWD	1994	63	86	11.95-03.00	■
220 SDi (20 T2N)		Diesel	FWD	1994	77	105	11.95-03.00	■
25 (RF) 09.99-06.06					Hatchback (Compact car-C Segment)			
1.1		Gasolina	FWD	1120	44	60	11.99-05.05	■
1.1 (11 K4F)		Gasolina	FWD	1120	55	75	09.99-06.01	■
1.1 16V (11 K4F)		Gasolina	FWD	1120	55	75	01.04-05.05	■
1.4 16V (14 K4M)		Gasolina	FWD	1396	62	84	10.99-05.05	■
1.4 16V (14 K4F)		Gasolina	FWD	1396	76	103	10.99-05.05	■
1.6 16V (16 K4F)		Gasolina	FWD	1588	80	109	10.99-05.05	■
1.8 16V (18 K4F)		Gasolina	FWD	1796	85	116	10.99-05.05	■

LISTA DE APLICACIONES - BUYERS GUIDE

1.8 16V (18 K4K)		Gasolina	FWD	1796	107	146	02.00-05.05	■
2.0 iDT (20 T2N)		Diesel	FWD	1994	74	101	10.99-05.05	■
2.0 iDT (20 T2N)		Diesel	FWD	1994	83	113	01.02-12.04	■
25 COMMERCE (RF) 01.03-12.05					Hatchback Van (Compact car-C Segment)			
1.4 (14 K4M)		Gasolina	FWD	1396	62	84	01.03-12.05	■
2.0 iDT (20 T2N)		Diesel	FWD	1994	74	101	01.03-12.05	■
400 III (RT) 05.95-03.00					Hatchback (Compact car-C Segment)			
414 (14 K2F)		Gasolina	FWD	1396	55	75	03.96-12.97	■
414 Si (14 K4F)		Gasolina	FWD	1396	76	103	05.95-03.00	■
416 Si (16 K4F)	03/96-, -06/99	Gasolina	FWD	1588	82	112	05.95-03.00	■
416 Si (D 16 Y3)		Gasolina	FWD	1590	83	113	06.95-03.00	■
416 Si (D16B2)		Gasolina	FWD	1590	85	116	06.95-03.00	■
420 Si Lux (20 T4H)		Gasolina	FWD	1994	100	136	12.95-03.00	■
420 D (20 T2R)		Diesel	FWD	1994	63	86	11.95-03.00	■
420 Di (20 T2N)		Diesel	FWD	1994	77	105	05.95-03.00	■
400 III (RT) 03.95-03.00					Saloon (Compact car-C Segment)			
414 (14 K2F)	vehicles with ABS	Gasolina	FWD	1396	55	75	03.96-12.99	■
414 Si (14 K4F)		Gasolina	FWD	1396	76	103	05.95-03.00	■
416 Si (16 K4F)		Gasolina	FWD	1588	82	112	05.95-03.00	■
416 Si (D 16 Y3)		Gasolina	FWD	1590	83	113	03.95-06.99	■
416 Si (D16B2)		Gasolina	FWD	1590	85	116	05.95-03.00	■
420 Si Lux (20 T4H)		Gasolina	FWD	1994	100	136	12.95-03.00	■
420 D (20 T2R)		Diesel	FWD	1994	63	86	11.95-03.00	■
420 Di (20 T2N)		Diesel	FWD	1994	77	105	05.95-03.00	■
400 I-II (XW) 04.90-04.95					Saloon (Compact car-C Segment)			
414 GSI/SI (14 K4C)	vehicles with ABS	Gasolina	FWD	1396	66	90	04.90-04.95	■
414 GSI/SI (14 K4D)	vehicles with ABS	Gasolina	FWD	1396	66	90	04.90-04.95	■
414 (14 K4C)	vehicles with ABS	Gasolina	FWD	1396	70	95	01.93-04.95	■
414 GSI/SI Cat (14 K4F)	vehicles with ABS	Gasolina	FWD	1396	76	103	10.92-04.95	■
416 GSI (D 16 Z2)		Gasolina	FWD	1590	82	112	04.90-04.95	■
416 GSI/GSE (D 16 A7)		Gasolina	FWD	1590	85	116	04.90-04.95	■
416 GTI (D 16 A8)		Gasolina	FWD	1590	90	122	04.90-04.95	■
416 GTI/GTE (D 16 A9)		Gasolina	FWD	1590	96	131	04.90-04.95	■
420 GSI/SLI/GTI/Vite (20 T4H)		Gasolina	FWD	1994	100	136	01.93-04.95	■
420 GTI/GSI/Vitesse (20 M4F)		Gasolina	FWD	1994	103	140	02.92-04.95	■
420 Turbo (20 T4G)		Gasolina	FWD	1994	147	200	01.93-04.95	■
2.0 Turbo GSi Sport		Gasolina	FWD	1994	152	207	10.92-04.95	■
418 TD (XUD 7TE)		Diesel	FWD	1769	65	88	09.91-04.95	■
418 D (XUD9)		Diesel	FWD	1905	49	67	09.91-04.95	■
400 I-II Tourer (XW) 09.93-11.98					Estate (Compact car-C Segment)			
1.8 i (18 K4K)		Gasolina	FWD	1796	107	146	06.96-11.98	■
2.0 i (20 T4H)		Gasolina	FWD	1994	100	136	05.94-11.98	■
1.8 TD (XUD 7TE)		Diesel	FWD	1769	65	88	09.93-11.98	■
45 (RT) 02.00-05.05					Hatchback (Compact car-C Segment)			
1.4 (14 K4F)		Gasolina	FWD	1396	76	103	02.00-05.05	■
1.6 (16 K4F)		Gasolina	FWD	1588	80	109	02.00-05.05	■
1.8 (18 K4F)		Gasolina	FWD	1796	86	117	02.00-05.05	■
2.0 V6 (20 K4F)		Gasolina	FWD	1997	110	150	02.00-05.05	■
2.0 iDT (20 T2N)		Diesel	FWD	1994	74	101	02.00-05.05	■

LISTA DE APLICACIONES - BUYERS GUIDE

2.0 iDT (20 T2N)		Diesel	FWD	1994	83	113	01.04-05.05	■
45 (RT) 02.00-05.05					Saloon (Compact car-C Segment)			
1.4 (14 K4F)		Gasolina	FWD	1396	76	103	02.00-05.05	■
1.6 (16 K4F)		Gasolina	FWD	1588	80	109	02.00-05.05	■
1.8 (18 K4F)		Gasolina	FWD	1796	86	117	02.00-05.05	■
2.0 V6 (20 K4F)		Gasolina	FWD	1997	110	150	02.00-05.05	■
2.0 iDT (20 T2N)		Diesel	FWD	1994	74	101	02.00-05.05	■
2.0 iDT (20 T2N)		Diesel	FWD	1994	83	113	01.04-05.05	■
CDV (RF) 03.03-04.05					Hatchback Van (Compact car-C Segment)			
2.0 iDT (20 T2N)		Diesel	FWD	1994	74	101	03.03-04.05	■
COUPE 03.96-11.99					Coupe (Compact car-C Segment)			
1.6 16V (16 K4F)	-06/99	Gasolina	FWD	1588	82	111	03.96-11.99	■
1.8 16V (18 K4K)	-06/99	Gasolina	FWD	1795	107	145	03.96-11.99	■
STREETWISE 08.03-05.05					Hatchback (Supermini car-B Segment)			
1.6 (16 K4F)		Gasolina	FWD	1588	80	109	01.04-05.05	■
1.8 (18 K4F)		Gasolina	FWD	1796	86	117	08.03-05.05	■