

LISTA DE APLICACIONES - BUYERS GUIDE

78BD0837-2



Weight: 11.870

O.E.M.	MAKE
45251-SM4-G01	HONDA
45251-SM4-G02	HONDA
45251-SN7-E50	HONDA
GBD 90837	ROVER

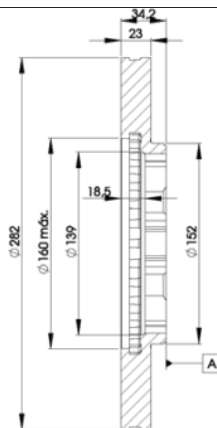
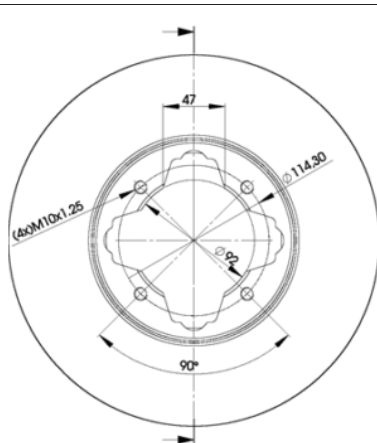

78BD0837-2

E1 90R-02C0074/0858



Ø282x23x34

MAKE
ACURA
HONDA
ROVER



Trac.	CC	Kw	CV
-------	----	----	----



Front / Rear

ACURA

VIGOR III 09.91-09.94

Saloon (Executive car-E Segment)

2.5 (G25A)	Gasolina	FWD	2451	140	190	09.91-09.94	■
------------	----------	-----	------	-----	-----	-------------	---

HONDA

ACCORD IV (CB) 11.89-12.93

Saloon (Executive car-E Segment)

2.2 (CB3, CB7) (F22A6)	Gasolina	FWD	2156	103	140	10.91-10.93	■
2.2 (CB3, CB7) (F22A9)	Gasolina	FWD	2156	103	140	10.91-10.93	■
2.2 i 16V Automatik (CB7) (F22A3)	Gasolina	FWD	2156	108	147	01.90-03.93	■
2.2 i 16V (CB7) (F22A3)	Gasolina	FWD	2156	110	150	01.90-03.93	■

ACCORD V (CC, CD) 06.92-12.97

Saloon (Executive car-E Segment)

1.8 i (CE7) (F18A3)	Gasolina	FWD	1850	85	116	02.96-10.98	■
1.8 i (CE7) (F18A3)	Gasolina	FWD	1850	85	116	02.96-10.98	■
2.0 i (CD4) (F20Z2)	Gasolina	FWD	1997	85	116	03.93-01.96	■
2.0 i LS (CE8) (F20Z1)	Gasolina	FWD	1997	96	131	02.96-10.98	■
2.0 i S (CD4) (F20Z1)	Gasolina	FWD	1997	96	131	03.93-01.96	■
2.2 i (CD5)	Gasolina	FWD	2156	110	150	04.93-06.97	■
2.2 i VTEC (CE9) (F22Z2)	Gasolina	FWD	2156	110	150	02.96-10.98	■
2.3 i SR (CD6) (H23A3)	Gasolina	FWD	2259	116	158	03.93-01.96	■
2.0 TDi (CF1) (20T2N)	Diesel	FWD	1994	77	105	04.96-10.98	■

INSPIRE II / SABER (UA1, UA3) 06.95-08.98

Saloon (Executive car-E Segment)

2.5 (G25A)	Gasolina	FWD	2451	132	179	06.95-08.98	■
------------	----------	-----	------	-----	-----	-------------	---

ROVER

LISTA DE APLICACIONES - BUYERS GUIDE

600 (RH) 08.93-10.00					Saloon (Compact executive car-D Segment)			
618 i/Si (F 18 A3)	Rim 15	Gasolina	FWD	1850	85	115	03.96-02.99	■
620 Ti Vitesse (20 T4G)	Rim 15	Gasolina	FWD	1994	147	200	05.94-08.98	■
620 i (F 20 Z2)	Rim 15	Gasolina	FWD	1997	85	115	08.93-06.96	■
620 Si (F 20 Z1)	Rim 15	Gasolina	FWD	1997	96	131	08.93-02.99	■
623 Si (H 23 A3)		Gasolina	FWD	2259	116	158	08.93-06.99	■