

LISTA DE APLICACIONES - BUYERS GUIDE

78BD1057-2



8 424073 142887

Weight: 13.504

| O.E.M. | MAKE |
|-------------|--------|
| 40206-2F500 | NISSAN |
| 40206-2F501 | NISSAN |
| 40206-55F01 | NISSAN |
| 40206-55F03 | NISSAN |
| 40206-73L01 | NISSAN |

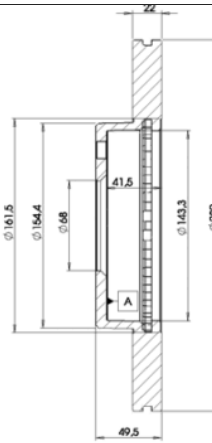
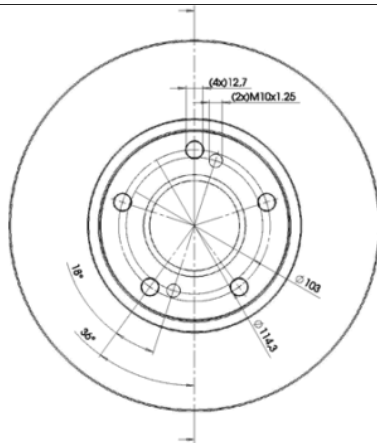

78BD1057-2



90R-02C0452/0118



Ø280x22x49.6

MAKE
NISSAN



| Trac. | CC | Kw | CV |
|-------|----|----|----|
|-------|----|----|----|



Front / Rear

NISSAN

200SX (S13) 07.88-12.95

| | | | | | | Coupe (Sports car-S Segment) | | | |
|---------------------|--------|----------|-----|------|-----|------------------------------|-------------|---|--|
| 1.8 (CA18DE) | 09/93- | Gasolina | RWD | 1809 | 99 | 135 | 09.88-03.94 | ■ | |
| 1.8 Turbo (CA18DT) | | Gasolina | RWD | 1809 | 122 | 166 | 01.92-09.94 | ■ | |
| 1.8 Turbo (CA18DET) | 10/91- | Gasolina | RWD | 1809 | 124 | 169 | 07.88-11.93 | ■ | |
| 1.8 Turbo (CA18DT) | | Gasolina | RWD | 1809 | 126 | 171 | 09.88-03.94 | ■ | |
| 2.0 i 16V | | Gasolina | RWD | 1998 | 103 | 140 | 07.88-11.93 | ■ | |

ALMERA II / PULSAR / SENTRA (N16) 01.00-

| | | | | | | Hatchback (Compact car-C Segment) | | | |
|--------------------|-------------------|----------|-----|------|-----|-----------------------------------|-------------|---|--|
| 1.5 (QG15DE) | vehicles with ABS | Gasolina | FWD | 1497 | 72 | 98 | 10.02-09.06 | ■ | |
| 1.5 (QG15DE) | vehicles with ABS | Gasolina | FWD | 1498 | 66 | 90 | 03.00-11.06 | ■ | |
| 1.5 XL | | Gasolina | FWD | 1498 | 77 | 105 | 03.01- | ■ | |
| 1.6 | vehicles with ABS | Gasolina | FWD | 1597 | 83 | 113 | 07.00-02.03 | ■ | |
| 1.8 (QG18DE) | | Gasolina | FWD | 1769 | 84 | 114 | 01.00-11.02 | ■ | |
| 1.8 (QG18DE) | | Gasolina | FWD | 1769 | 85 | 116 | 10.02-09.06 | ■ | |
| 1.5 dCi (K9K 722) | | Diesel | FWD | 1461 | 60 | 82 | 01.03-09.06 | ■ | |
| 2.2 Di (YD22DDT) | | Diesel | FWD | 2184 | 81 | 110 | 03.00-04.03 | ■ | |
| 2.2 dCi (YD22DDT) | | Diesel | FWD | 2184 | 82 | 112 | 09.03-09.06 | ■ | |
| 2.2 dCi (YD22DDTI) | | Diesel | FWD | 2184 | 100 | 136 | 09.03-09.06 | ■ | |

ALMERA II / PULSAR / SENTRA (N16) 04.00-

| | | | | | | Saloon (Compact car-C Segment) | | | |
|--------------|-------------------|----------|-----|------|----|--------------------------------|-------------|---|--|
| 1.5 (QG15DE) | vehicles with ABS | Gasolina | FWD | 1497 | 72 | 98 | 10.02-09.06 | ■ | |
| 1.5 (QG15DE) | vehicles with ABS | Gasolina | FWD | 1498 | 66 | 90 | 07.00-11.06 | ■ | |
| 1.5 | | Gasolina | FWD | 1498 | 77 | 105 | 03.01- | ■ | |
| 1.6 (N16) | vehicles with ABS | Gasolina | FWD | 1597 | 83 | 113 | 07.00-04.09 | ■ | |
| 1.6 | | Gasolina | FWD | 1597 | 88 | 120 | 06.00-12.09 | ■ | |

LISTA DE APLICACIONES - BUYERS GUIDE

| | | | | | | | | |
|--|-------------------|------------------|-----|------|---|-----|-------------|---|
| 1.8 (QG18DE) | | Gasolina | FWD | 1769 | 84 | 114 | 07.00-11.02 | ■ |
| 1.8 (QG18DE) | | Gasolina | FWD | 1769 | 85 | 116 | 10.02-09.06 | ■ |
| 1.8 | | Gasolina | FWD | 1769 | 88 | 120 | 06.00- | ■ |
| 1.8 | | Gasolina | FWD | 1769 | 94 | 128 | 01.02- | ■ |
| 2.0 | | Gasolina | FWD | 1998 | 107 | 145 | 08.02- | ■ |
| 1.5 dCi (K9K 722) | | Diesel | FWD | 1461 | 60 | 82 | 01.03-09.06 | ■ |
| 2.2 Di (YD22DDT) | | Diesel | FWD | 2184 | 81 | 110 | 07.00-04.03 | ■ |
| 2.2 dCi (YD22DDT) | | Diesel | FWD | 2184 | 82 | 112 | 09.03-09.06 | ■ |
| 2.2 dCi (YD22DDTI) | | Diesel | FWD | 2184 | 100 | 136 | 09.03-09.06 | ■ |
| PRIMERA II (P11) 06.96-07.02 | | | | | Hatchback (Large family car-D Segment) | | | |
| 1.6 16V (GA16DE) | vehicles with ABS | Gasolina | FWD | 1597 | 66 | 90 | 09.96-07.02 | ■ |
| 1.6 16V (GA16DE) | vehicles with ABS | Gasolina | FWD | 1597 | 73 | 99 | 09.96-07.02 | ■ |
| 1.6 16V (QG16DE) | vehicles with ABS | Gasolina | FWD | 1597 | 78 | 106 | 09.00-07.02 | ■ |
| 1.8 16V (QG18DE) | vehicles with ABS | Gasolina | FWD | 1769 | 84 | 114 | 08.99-07.02 | ■ |
| 2.0 16V (SR20DE) | | Gasolina | FWD | 1998 | 103 | 140 | 08.99-07.02 | ■ |
| 2.0 16V (SR20DE) | | Gasolina | FWD | 1998 | 110 | 150 | 09.96-07.02 | ■ |
| 1.6 16V LPG | | Gasol./Gas (LPG) | FWD | 1597 | 78 | 106 | 09.00-07.02 | ■ |
| 1.8 16V LPG | | Gasol./Gas (LPG) | FWD | 1769 | 84 | 114 | 08.99-07.02 | ■ |
| 2.0 16V LPG | | Gasol./Gas (LPG) | FWD | 1998 | 96 | 131 | 09.96-07.02 | ■ |
| 2.0 TD (CD20T) | vehicles with ABS | Diesel | FWD | 1974 | 66 | 90 | 09.96-07.02 | ■ |
| PRIMERA II (P11) 06.96-07.02 | | | | | Saloon (Large family car-D Segment) | | | |
| 1.6 16V (GA16DE) | vehicles with ABS | Gasolina | FWD | 1597 | 66 | 90 | 09.96-12.01 | ■ |
| 1.6 16V (GA16DE) | vehicles with ABS | Gasolina | FWD | 1597 | 73 | 99 | 09.96-10.00 | ■ |
| 1.6 16V (QG16DE) | vehicles with ABS | Gasolina | FWD | 1597 | 78 | 106 | 06.96-12.01 | ■ |
| 1.8 16V (QG18DE) | vehicles with ABS | Gasolina | FWD | 1769 | 84 | 114 | 08.99-12.01 | ■ |
| 1.8 | | Gasolina | FWD | 1769 | 96 | 131 | 06.96-05.99 | ■ |
| 2.0 16V (SR20DE) | | Gasolina | FWD | 1998 | 103 | 140 | 08.99-12.01 | ■ |
| 2.0 16V (SR20DE) | | Gasolina | FWD | 1998 | 105 | 143 | 06.96-12.01 | ■ |
| 2.0 16V (SR20DE) | | Gasolina | FWD | 1998 | 110 | 150 | 09.96-12.01 | ■ |
| 1.8 LPG | | Gasol./Gas (LPG) | FWD | 1769 | 84 | 114 | 08.99-12.01 | ■ |
| 2.0 TD (CD20T) | vehicles with ABS | Diesel | FWD | 1974 | 66 | 90 | 09.96-12.01 | ■ |
| PRIMERA II Traveller (WP11) 06.96-01.02 | | | | | Estate (Large family car-D Segment) | | | |
| 1.6 16V (GA16DE) | | Gasolina | FWD | 1597 | 66 | 90 | 04.98-12.01 | ■ |
| 1.6 16V (GA16DE) | | Gasolina | FWD | 1597 | 73 | 99 | 04.98-12.01 | ■ |
| 1.6 16V | | Gasolina | FWD | 1597 | 80 | 109 | 04.98-12.01 | ■ |
| 1.8 16V (QG18DE) | | Gasolina | FWD | 1769 | 84 | 114 | 08.99-12.01 | ■ |
| 1.8 16V | | Gasolina | FWD | 1769 | 96 | 131 | 06.96-05.99 | ■ |
| 2.0 16V (SR20DE) | | Gasolina | FWD | 1998 | 85 | 115 | 06.96-12.01 | ■ |
| 2.0 16V (SR20DE) | | Gasolina | FWD | 1998 | 96 | 131 | 04.98-12.01 | ■ |
| 2.0 16V (SR20DE) | | Gasolina | FWD | 1998 | 103 | 140 | 08.99-12.01 | ■ |
| 2.0 16V | | Gasolina | FWD | 1998 | 140 | 190 | 06.96-05.99 | ■ |
| 1.8 16V LPG | | Gasol./Gas (LPG) | FWD | 1769 | 84 | 114 | 08.99-12.01 | ■ |
| 2.0 TD (CD20T) | | Diesel | FWD | 1974 | 66 | 90 | 04.98-12.01 | ■ |