

LISTA DE APLICACIONES - BUYERS GUIDE

78BD1564-2



8 424073 291301

Weight: 8.000

O.E.M.	MAKE
13509119	OPEL
13514611	OPEL
13514612	OPEL
13597355	CHEVROLET

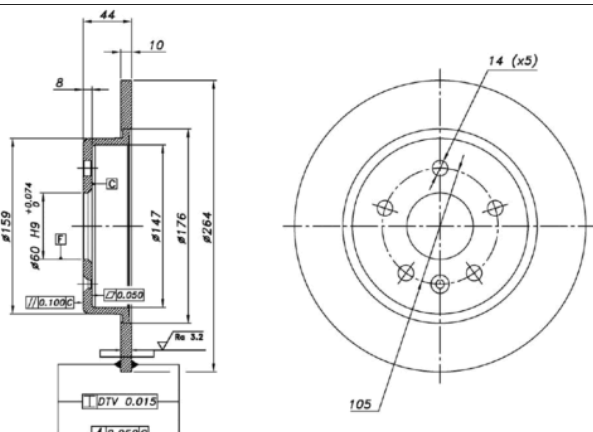

78BD1564-2



Ø264x10x44

MAKE
BUICK (SGM)
CHEVROLET
CHEVROLET (SGM)
HOLDEN
OPEL
VAUXHALL



Trac.	CC	Kw	CV
-------	----	----	----



Front / Rear

BUICK (SGM)

VELITE 5 (SR1) 04.17-						Saloon (Compact car-C Segment)			
1.5 EREV (L3A,TZ264XYMKV)		Gasol./el éc.	FWD	1490		135	184	04.17-12.19	■
VELITE 7 (SF1) 07.20-						SUV (Subcompact CUV-B Segment)			
652E (TZ204XYMMF)		Eléctrico	FWD	0		130	177	07.20-	■
VERANO II (CP6) 11.15-						Hatchback (Compact car-C Segment)			
15S (L3G)		Gasolina	FWD	1490		87	118	11.15-	■
VERANO II (CP5) 06.15-						Saloon (Compact car-C Segment)			
15T (LIV)		Gasolina	FWD	999		92	125	09.19-	■
20t (L3Z)		Gasolina	FWD	1341		121	165	09.19-	■
1.5		Gasolina	FWD	1490		87	118	06.15-	■
1.5 T		Gasolina	FWD	1490		124	169	06.15-	■
VERANO II GS (CP6) 11.15-						Hatchback (Compact car-C Segment)			
1.5 (LFV)		Gasolina	FWD	1490		124	169	11.15-	■
VERANO III GS (CP5) 04.20-						Saloon (Compact car-C Segment)			
20t (L3Z)		Gasolina	FWD	1341		121	165	04.20-	■

CHEVROLET

BOLT 08.16-						Hatchback (Supermini car-B Segment)			
EV		Eléctrico	FWD			150	204	08.16-	■
CRUZE II (J405) 01.17-						Hatchback (Supermini car-B Segment)			
1.4 (LE2(85CUL4))		Gasolina	FWD	1399		114	155	01.17-	■

LISTA DE APLICACIONES - BUYERS GUIDE

1.6 (LH7(98CUL4))	Diesel	FWD	1598	102	139	01.17-	■
CRUZE II (J400) 11.15-				Saloon (Supermini car-B Segment)			
1.4 (LE2(85CUL4))	Gasolina	FWD	1399	114	155	11.15-	■
1.4 Flex (LE2(85VUL4))	Gasol./Etanol	FWD	1399	113	153	01.17-	■
CDTi (B 16 DTH)	Diesel	FWD	1598	99	135	11.15-	■
VOLT II 05.15-				Hatchback (Compact car-C Segment)			
EV 150	Gasolina	FWD		111	151	05.15-	■
1.5 EV100 (L3A)	Gasol./eléc.	FWD	1490	111	151	01.16-	■
CHEVROLET (SGM)							
CRUZE II (CP7) 02.17-				Hatchback (Supermini car-B Segment)			
1.4 (LE2)	Gasolina	FWD	1399	110	150	02.17-	■
1.5 (L3G)	Gasolina	FWD	1490	84	114	02.17-	■
CRUZE II (CP3) 08.14-07.16				Saloon (Supermini car-B Segment)			
1.4 T	Gasolina	FWD	1399	110	150	08.14-	■
330T (LE2)	Gasolina	FWD	1399	110	150	07.16-	■
1.5	Gasolina	FWD	1490	84	114	08.14-	■
320 (L3G)	Gasolina	FWD	1490	84	114	07.16-	■
HOLDEN							
ASTRA (BK) 09.17-				Estate (Compact car-C Segment)			
1.4 (B 14 XFT)	Gasolina	FWD	1399	110	150	09.17-	■
ASTRA (PJ) 12.14-				Hatchback (Compact car-C Segment)			
1.4	Gasolina	FWD	1399	110	150	01.17-	■
1.6 (B 16 SHT)	Gasolina	FWD	1598	147	200	09.16-	■
OPEL							
AMPERA-E II (F17) 05.17-				Hatchback (Compact car-C Segment)			
EV150 (48)	Eléctrico	FWD		150	204	05.17-03.19	■
ASTRA K 11.15-				Estate Van (Compact car-C Segment)			
1.0 (35) (D 10 XFL)	Gasolina	FWD	999	77	105	05.18-	■
1.4 (35) (D 14 XFT)	Gasolina	FWD	1399	110	150	06.18-	■
1.5 CRDI (35) (D 15 DVC)	Diesel	FWD	1496	77	105	08.19-	■
1.5 CRDI (35) (F 15 DVC)	Diesel	FWD	1496	77	105	08.19-	■
ASTRA K 06.15-				Hatchback Van (Compact car-C Segment)			
1.6 CDTi (D 16 DTH)	Diesel	FWD	1598	100	136	04.18-	■
ASTRA K (B16) 06.15-				Hatchback (Compact car-C Segment)			
1.0 Turbo (68) (D 10 XFL)	Gasolina	FWD	999	66	90	06.18-12.22	■
1.0 Turbo (68) (B 10 XFL)	Gasolina	FWD	999	77	105	06.15-12.22	■
1.0 Turbo (68) (D 10 XFL)	Gasolina	FWD	999	77	105	06.15-12.22	■
1.2 Turbo (68) (F 12 SHL)	Gasolina	FWD	1199	81	110	08.19-12.22	■
1.2 Turbo (68) (F 12 SHT)	Gasolina	FWD	1199	96	131	08.19-12.22	■
1.2 Turbo (68) (F 12 SHR)	Gasolina	FWD	1199	107	145	08.19-12.22	■
1.4 Turbo (68) (F 14 SHL)	Gasolina	FWD	1342	107	145	08.19-12.22	■
1.4 Turbo (68) (F 14 SHT)	Gasolina	FWD	1342	107	145	08.19-12.22	■
1.4 (68) (B 14 XE)	Gasolina	FWD	1399	74	100	06.15-12.22	■
1.4 Turbo (68) (B 14 XFL)	Gasolina	FWD	1399	92	125	06.15-12.22	■
1.4 Turbo (68) (B 14 XFT)	Gasolina	FWD	1399	103	140	07.17-	■

LISTA DE APLICACIONES - BUYERS GUIDE

1.4 Turbo (68) (B 14 XFT)		Gasolina	FWD	1399	110	150	06.15-12.22	■
1.6 Turbo (68) (B 16 SHT)		Gasolina	FWD	1598	147	200	11.15-12.22	■
1.4 CNG (68) (B 14 XNT)		Gasol./Gas (CNG)	FWD	1399	81	110	10.17-12.22	■
1.5 CRDI (68) (D 15 DVC)		Diesel	FWD	1496	77	105	08.19-12.22	■
1.5 CRDI (68) (F 15 DVC)		Diesel	FWD	1496	77	105	08.19-12.22	■
1.5 CRDI (68) (D 15 DVH)		Diesel	FWD	1496	90	122	08.19-12.22	■
1.5 CRDI (68) (F 15 DVH)		Diesel	FWD	1496	90	122	08.19-12.22	■
1.6 CDTi (68) (B 16 DTE)		Diesel	FWD	1598	70	95	06.15-12.22	■
1.6 CDTi (68) (B 16 DTE)		Diesel	FWD	1598	81	110	06.15-12.22	■
1.6 CDTi (68) (B 16 DTU)		Diesel	FWD	1598	81	110	06.15-12.22	■
1.6 CDTi (68) (D 16 DTI)		Diesel	FWD	1598	81	110	06.15-12.22	■
1.6 CDTi (68) (B 16 DTH)		Diesel	FWD	1598	100	136	06.15-12.22	■
1.6 CDTi (68) (D 16 DTH)		Diesel	FWD	1598	100	136	06.15-12.22	■
1.6 BiTurbo (D 16 DTR)		Diesel	FWD	1598	110	150	08.18-12.22	■
1.6 CDTi (68) (B 16 DTR)		Diesel	FWD	1598	118	160	11.15-12.22	■
ASTRA K Sports Tourer (B16) 11.15-						Estate (Compact car-C Segment)		
1.0 Turbo (35) (D 10 XFL)		Gasolina	FWD	999	66	90	06.18-12.22	■
1.0 Turbo (35) (B 10 XFL)		Gasolina	FWD	999	77	105	11.15-12.22	■
1.0 Turbo (35) (D 10 XFL)		Gasolina	FWD	999	77	105	11.15-12.22	■
1.2 Turbo (35) (F 12 SHL)		Gasolina	FWD	1199	81	110	08.19-12.22	■
1.2 Turbo (35) (F 12 SHT)		Gasolina	FWD	1199	96	131	08.19-12.22	■
1.2 Turbo (35) (F 12 SHR)		Gasolina	FWD	1199	107	145	08.19-12.22	■
1.4 Turbo (35) (F 14 SHL)		Gasolina	FWD	1342	107	145	08.19-12.22	■
1.4 Turbo (35) (F 14 SHT)		Gasolina	FWD	1342	107	145	08.19-12.22	■
1.4 (35) (B 14 XE)		Gasolina	FWD	1399	74	100	11.15-12.22	■
1.4 Turbo (35) (B 14 XFL)		Gasolina	FWD	1399	92	125	11.15-12.22	■
1.4 Turbo (35) (B 14 XFT)		Gasolina	FWD	1399	110	150	11.15-12.22	■
1.4 Turbo (35) (D 14 XFT)		Gasolina	FWD	1399	110	150	11.15-12.22	■
1.6 Turbo (35) (B 16 SHT)		Gasolina	FWD	1598	147	200	11.15-12.22	■
1.4 CNG (35) (B 14 XNT)		Gasol./Gas (CNG)	FWD	1399	81	110	10.17-12.22	■
1.5 CRDI (35) (D 15 DVC)		Diesel	FWD	1496	77	105	08.19-12.22	■
1.5 CRDI (35) (F 15 DVC)		Diesel	FWD	1496	77	105	08.19-12.22	■
1.5 CRDI (35) (D 15 DVH)		Diesel	FWD	1496	90	122	08.19-12.22	■
1.5 CRDI (35) (F 15 DVH)		Diesel	FWD	1496	90	122	08.19-12.22	■
1.6 CDTi (35) (B 16 DTE)		Diesel	FWD	1598	70	95	11.15-12.22	■
1.6 CDTi (35) (B 16 DTE)		Diesel	FWD	1598	81	110	11.15-12.22	■
1.6 CDTi (35) (B 16 DTU)		Diesel	FWD	1598	81	110	11.15-12.22	■
1.6 CDTi (35) (D 16 DTI)		Diesel	FWD	1598	81	110	11.15-12.22	■
1.6 CDTi (35) (B 16 DTH)		Diesel	FWD	1598	100	136	11.15-12.22	■
1.6 BiTurbo (D 16 DTR)		Diesel	FWD	1598	110	150	08.18-12.22	■
1.6 CDTi (35) (B 16 DTR)		Diesel	FWD	1598	118	160	11.15-12.22	■
VAUXHALL								
ASTRA Mk VII (K) (B16) 07.15-						Estate (Compact car-C Segment)		
1.0 (B 10 XFL)		Gasolina	FWD	999	77	105	11.15-	■
1.0 (D 10 XFL)		Gasolina	FWD	999	77	105	11.15-	■
1.2 Turbo (F 12 SHL)		Gasolina	FWD	1199	81	110	08.19-	■
1.2 Turbo (F 12 SHT)		Gasolina	FWD	1199	96	131	08.19-	■
1.2 Turbo (F 12 SHR)		Gasolina	FWD	1199	107	145	08.19-	■

LISTA DE APLICACIONES - BUYERS GUIDE

1.4 Turbo (F 14 SHL)		Gasolina	FWD	1342	107	145	08.19-	■
1.4 Turbo (F 14 SHT)		Gasolina	FWD	1342	107	145	08.19-	■
1.4 (B 14 XE)		Gasolina	FWD	1399	74	100	11.15-	■
1.4 Turbo (B 14 XFL)		Gasolina	FWD	1399	92	125	11.15-	■
1.4 Turbo (B 14 XFT)		Gasolina	FWD	1399	110	150	11.15-	■
1.6 Turbo (B 16 SHT)		Gasolina	FWD	1598	147	200	11.15-	■
1.5 CRDi (D 15 DVC)		Diesel	FWD	1496	77	105	08.19-	■
1.5 CRDi (F 15 DVC)		Diesel	FWD	1496	77	105	08.19-	■
1.5 CRDi (D 15 DVH)		Diesel	FWD	1496	90	122	08.19-	■
1.5 CRDi (F 15 DVH)		Diesel	FWD	1496	90	122	08.19-	■
1.6 CDTi (B 16 DTE)		Diesel	FWD	1598	70	95	11.15-	■
1.6 CDTi (B 16 DTE)		Diesel	FWD	1598	81	110	07.15-	■
1.6 CDTi (B 16 DTU)		Diesel	FWD	1598	81	110	07.15-	■
1.6 CDTi (D 16 DTI)		Diesel	FWD	1598	81	110	07.15-	■
1.6 CDTi (B 16 DTH)		Diesel	FWD	1598	100	136	11.15-	■
1.6 CDTi (D 16 DTH)		Diesel	FWD	1598	100	136	11.15-	■
1.6 BiTurbo (D 16 DTR)		Diesel	FWD	1598	110	150	08.18-	■
1.6 CDTi (B 16 DTR)		Diesel	FWD	1598	118	160	11.15-	■
ASTRA Mk VII (K) (B16) 07.15-					Hatchback (Compact car-C Segment)			
1.0 (B 10 XFL)		Gasolina	FWD	999	77	105	07.15-	■
1.0 (D 10 XFL)		Gasolina	FWD	999	77	105	07.15-	■
1.2 Turbo (F 12 SHL)		Gasolina	FWD	1199	81	110	08.19-	■
1.2 Turbo (F 12 SHT)		Gasolina	FWD	1199	96	131	08.19-	■
1.2 Turbo (F 12 SHR)		Gasolina	FWD	1199	107	145	08.19-	■
1.4 Turbo (F 14 SHL)		Gasolina	FWD	1342	107	145	08.19-	■
1.4 Turbo (F 14 SHT)		Gasolina	FWD	1342	107	145	08.19-	■
1.4 (B 14 XE)		Gasolina	FWD	1399	74	100	07.15-	■
1.4 Turbo (B 14 XFL)		Gasolina	FWD	1399	92	125	07.15-	■
1.4 Turbo (B 14 XFT)		Gasolina	FWD	1399	110	150	07.15-	■
1.6 Turbo (B 16 SHT)		Gasolina	FWD	1598	147	200	11.15-	■
1.5 CRDi (D 15 DVC)		Diesel	FWD	1496	77	105	08.19-	■
1.5 CRDi (F 15 DVC)		Diesel	FWD	1496	77	105	08.19-	■
1.5 CRDi (D 15 DVH)		Diesel	FWD	1496	90	122	08.19-	■
1.5 CRDi (F 15 DVH)		Diesel	FWD	1496	90	122	08.19-	■
1.6 CDTi (B 16 DTE)		Diesel	FWD	1598	70	95	07.15-	■
1.6 CDTi (B 16 DTE)		Diesel	FWD	1598	81	110	07.15-	■
1.6 CDTi (B 16 DTU)		Diesel	FWD	1598	81	110	07.15-	■
1.6 CDTi (D 16 DTI)		Diesel	FWD	1598	81	110	07.15-	■
1.6 CDTi (B 16 DTH)		Diesel	FWD	1598	100	136	07.15-	■
1.6 CDTi (D 16 DTH)		Diesel	FWD	1598	100	136	07.15-	■
1.6 BiTurbo (D 16 DTR)		Diesel	FWD	1598	110	150	08.18-	■
1.6 CDTi (B 16 DTR)		Diesel	FWD	1598	118	160	11.15-	■