

# LISTA DE APLICACIONES - BUYERS GUIDE

## 78BD1607-2



Weight: 7.720

O.E.M.	MAKE
43512-16070	TOYOTA
43512-16120	TOYOTA

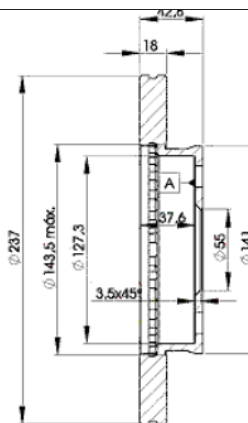
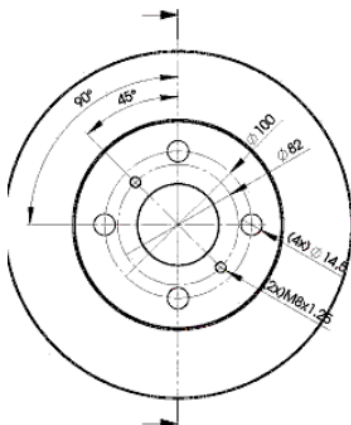

## 78BD1607-2



Ø238x18x43

MAKE
ALFA ROMEO
TOYOTA



Trac.	CC	Kw	CV		
					Front / Rear

### ALFA ROMEO

#### 147 (937\_) 10.00-12.10

#### Hatchback (Compact car-C Segment)

2.0 16V T.SPARK (937.AXA1, 937.AXC1, 937.BXC1) (AR 32310)

Gasolina FWD 1970 110 150 01.01-03.10 ■

### TOYOTA

#### CORSA IV (\_L4\_) 09.90-10.94

#### Saloon (Supermini car-B Segment)

1.3 (EL41\_, EL41) (4E-FE)

Gasolina FWD 1332 65 88 10.90-10.94 ■

#### CORSA V (\_L5\_) 09.94-09.99

#### Hatchback (Supermini car-B Segment)

1.3 (EL51) (4E-FE)

Gasolina FWD 1332 65 88 11.94-09.99 ■

1.5 (EL53, EL55) (5E-FE)

Gasolina FWD 1496 70 95 11.94-09.99 ■

1.5 4WD (EL55) (5E-FE)

Gasolina 4WD 1497 67 91 09.94-12.97 ■

#### CORSA V (\_L5\_) 09.94-09.99

#### Saloon (Supermini car-B Segment)

1.3 (EL51) (4E-FE)

Gasolina FWD 1332 65 88 11.94-09.99 ■

1.5 (EL53, EL55) (5E-FE)

Gasolina FWD 1496 70 95 11.94-09.99 ■

#### STARLET IV (\_P8\_) 12.89-03.96

#### Hatchback (Supermini car-B Segment)

1.0 (EP80\_, EP80R) (1E)

Gasolina FWD 999 40 54 12.89-12.92 ■

1.3 XL (EP81) (2E)

03/90-, vehicles with ABS

Gasolina FWD 1295 52 71 12.89-12.91 ■

1.3 12V (EP81\_, EP81R) (2E)

03/90-, vehicles with ABS

Gasolina FWD 1296 55 75 12.89-12.92 ■

1.3 12V (EP81\_, EP81R) (2E-E)

03/90-, vehicles with ABS

Gasolina FWD 1296 55 75 12.89-12.92 ■

1.3 12V Cat (EP81) (2E-E)

03/90-, vehicles with ABS

Gasolina FWD 1296 55 75 12.89-03.96 ■

1.5 D (NP80\_, NP80) (1N)

Diesel FWD 1453 40 54 12.89-03.96 ■

#### STARLET V (\_P9\_) 01.96-10.99

#### Hatchback (Supermini car-B Segment)

1.3 (EP91\_, EP91R) (4E-FE)

Gasolina FWD 1332 55 75 01.96-07.99 ■

# LISTA DE APLICACIONES - BUYERS GUIDE

TERCEL III-IV ( _L3 _ ) 05.86-10.94					Hatchback (Supermini car-B Segment)			
1.3 (EL41_, EL41) (4E-FE)	Gasolina	FWD	1332	65	88	09.90-10.94	■	
TERCEL V (EL5_) 09.94-09.99					Hatchback (Supermini car-B Segment)			
1.3 (EL51_, EL51) (4E-FE)	Gasolina	FWD	1332	65	88	11.94-09.99	■	
1.5 (EL53_, EL53) (5E-FE)	Gasolina	FWD	1497	70	95	11.94-09.99	■	