

LISTA DE APLICACIONES - BUYERS GUIDE

78BD1704-2



Weight: 10.832

O.E.M.	MAKE
45251-S6F-E10	HONDA

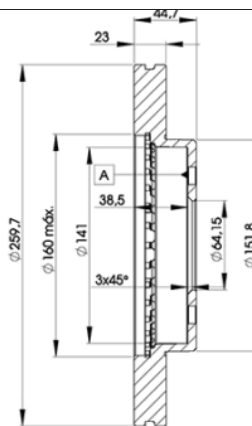
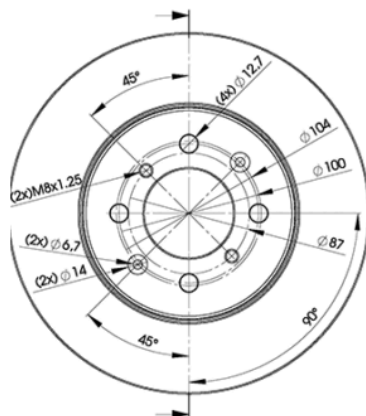

78BD1704-2

E1 90R-02C0452/0077



Ø260x23x44.7

MAKE
HONDA



Trac.	CC	Kw	CV
-------	----	----	----



Front / Rear

HONDA

CIVIC VII (EU, EP, EV) 01.00-02.06

Hatchback (Compact car-C Segment)

2.0 i Sport (EV1) (K20A3)	Gasolina	FWD	1998	118	160	09.01-09.05	■
1.7 CTDi (EP4, EU9) (4EE-2)	Diesel	FWD	1686	74	100	01.02-09.05	■