

LISTA DE APLICACIONES - BUYERS GUIDE

78BD1788-2



Weight: 12.564

O.E.M.	MAKE
2 717 88	VOLVO
2 717 882	VOLVO
9 140 759	VOLVO
9 140 759 3	VOLVO

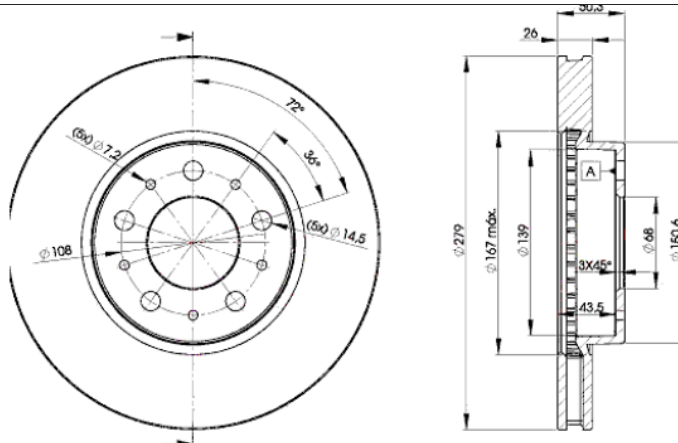

78BD1788-2

E1 90R-02C0452/0078



Ø280x26x50.3

MAKE
VOLVO



Trac.	CC	Kw	CV
-------	----	----	----



Front / Rear

VOLVO

850 (855) 04.92-10.97

					Estate (Compact executive car-D Segment)				
2.0 (B 5202 S)		Gasolina	FWD	1984	93	126	08.94-12.96	■	
2.0 (B 5204 FS)		Gasolina	FWD	1984	105	143	02.93-12.96	■	
2.0 Turbo (B 5204 T2)		Gasolina	FWD	1984	132	180	09.93-10.97	■	
2.0 Turbo (B 5204 FT)		Gasolina	FWD	1984	155	210	02.93-12.96	■	
2.0 Turbo (B 5204 T)		Gasolina	FWD	1984	155	210	02.93-12.96	■	
2.3		Gasolina	FWD	2319	106	144	01.96-10.96	■	
T5 (B 5234 FT)		Gasolina	FWD	2319	166	226	02.93-12.96	■	
T5 R (B 5234 T2)		Gasolina	FWD	2319	176	239	04.96-10.96	■	
2.3 Turbo R (B 5234 T5)		Gasolina	FWD	2319	177	241	06.95-10.97	■	
2.3 Turbo R (B 5234 T5)		Gasolina	FWD	2319	179	243	09.94-10.97	■	
T5-R (B 5234 T4)		Gasolina	FWD	2319	184	250	08.95-12.96	■	
2.4 (B 5252)	09/93-	Gasolina	FWD	2435	103	140	08.92-07.94	■	
2.4 (B 5252 FS)		Gasolina	FWD	2435	106	144	08.94-12.96	■	
2.4 (B 5254 S)	09/93-	Gasolina	FWD	2435	125	170	09.92-12.96	■	
2.4 AWD (B 5254 T)		Gasolina	4WD	2435	142	193	04.96-10.97	■	
2.4 GLE (B 5254 T)		Gasolina	FWD	2435	142	193	09.93-10.97	■	
2.5 TDI (D 5252 T)		Diesel	FWD	2460	103	140	08.95-12.96	■	

850 (854) 06.91-10.97

					Saloon (Compact executive car-D Segment)				
2.0 (B 5202 S)		Gasolina	FWD	1984	93	126	08.94-12.96	■	
2.0 (B 5204 FS)		Gasolina	FWD	1984	105	143	06.91-12.96	■	
2.0 Turbo (B 5204 T2)		Gasolina	FWD	1984	132	179	09.93-10.96	■	
2.0 Turbo (B 5204 FT)		Gasolina	FWD	1984	155	210	08.93-12.96	■	

LISTA DE APLICACIONES - BUYERS GUIDE

2.0 Turbo (B 5204 T)		Gasolina	FWD	1984	155	210	08.93-12.96	■
2.3		Gasolina	FWD	2319	106	144	01.96-10.96	■
T5 (B 5234 FT)		Gasolina	FWD	2319	166	226	08.93-07.96	■
T5 R (B 5234 T2)		Gasolina	FWD	2319	176	239	04.96-10.96	■
2.3 Turbo R (B 5234 T5)		Gasolina	FWD	2319	177	241	06.95-10.96	■
2.3 Turbo R (B 5234 T5)		Gasolina	FWD	2319	179	243	09.94-10.97	■
T5-R (B 5234 T4)		Gasolina	FWD	2319	184	250	08.95-12.96	■
2.4 (B 5252)	09/93-	Gasolina	FWD	2435	103	140	06.91-07.94	■
2.4 (B 5252 FS)		Gasolina	FWD	2435	106	144	08.94-12.96	■
2.4 (B 5254 S)	09/93-	Gasolina	FWD	2435	125	170	08.91-12.96	■
2.4 GLE (B 5254 T)		Gasolina	FWD	2435	142	193	09.93-10.97	■
2.5 TDI (D 5252 T)		Diesel	FWD	2460	103	140	08.95-12.96	■
940 (945) 09.90-10.98					Estate (Executive car-E Segment)			
2.4 TD Interc. (D 24 TIC)		Diesel	RWD	2383	90	122	08.94-10.98	■
940 (944) 08.90-03.95					Saloon (Executive car-E Segment)			
2.0 (B 200 F)	10/93-, vehicles without ABS	Gasolina	RWD	1986	82	112	01.92-07.94	■
2.3 (B 230 FB)	08/93-	Gasolina	RWD	2316	96	131	08.90-12.94	■
2.3 (B 230 G)	08/93-	Gasolina	RWD	2316	96	131	08.90-12.94	■
2.3 (B 230 FK)	08/93-	Gasolina	RWD	2316	99	135	05.91-03.95	■
2.4 Turbo Diesel (D 24 T)	10/93-	Diesel	RWD	2383	80	109	08.90-12.94	■
2.4 TD Interc. (D 24 TIC)		Diesel	RWD	2383	90	122	08.94-10.98	■
940 Kombi (945) 08.90-10.95					Estate (Executive car-E Segment)			
2.0 (B 200 F)	10/93-	Gasolina	RWD	1986	82	112	01.92-07.94	■
2.4 Turbo Diesel (D 24 T)	10/93-	Diesel	RWD	2383	80	109	08.90-07.94	■
2.4 TD Intercooler (D 24 TIC)	10/93-	Diesel	RWD	2383	90	122	08.90-08.94	■
960 (965) 07.94-12.96					Estate (Executive car-E Segment)			
2.5 (B 6254 S)		Gasolina	RWD	2473	125	170	08.94-12.96	■
2.9 (B 6304 S)		Gasolina	RWD	2922	150	204	09.94-12.96	■
960 (964) 08.90-07.94					Saloon (Executive car-E Segment)			
2.5 (B 6254 S)		Gasolina	RWD	2473	125	170	07.94-12.96	■
2.9 (B 6304 F)	09/93-	Gasolina	RWD	2922	150	204	08.90-07.94	■
2.9 (B 6304 FS)	09/93-	Gasolina	RWD	2922	150	204	08.90-07.94	■
2.9 (B 6304 GS)	09/93-	Gasolina	RWD	2922	150	204	08.90-07.94	■
2.9 (B 6304 S)		Gasolina	RWD	2922	150	204	07.94-12.96	■
2.4 TD Interc. (D 24 TIC)	09/93-	Diesel	RWD	2383	85	115	09.91-07.94	■
960 Kombi (965) 08.90-07.94					Estate (Executive car-E Segment)			
2.9 (B 6304 F)	09/93-	Gasolina	RWD	2922	150	204	08.90-07.94	■
2.9 (B 6304 S)	09/93-	Gasolina	RWD	2922	150	204	08.90-07.94	■
C70 (872) 03.97-09.02					Coupe (Pony car-F Segment)			
2.4 (B 5254 S)		Gasolina	FWD	2435	121	165	03.99-09.02	■
2.4 (B 5244 S)		Gasolina	FWD	2435	125	170	05.99-09.02	■
2.4 (B 5254 S)		Gasolina	FWD	2435	125	170	05.99-09.02	■
S70 (874) 11.96-11.00					Saloon (Compact executive car-D Segment)			
2.0 (B 5202 FS)		Gasolina	FWD	1984	93	126	01.97-11.00	■
2.0 (B 5202 S)		Gasolina	FWD	1984	93	126	01.97-11.00	■
2.0 (B 5204 F)		Gasolina	FWD	1984	105	143	01.97-11.00	■
2.0 (B 5204 T4)		Gasolina	FWD	1984	120	163	01.97-11.00	■
2.0 (B 5204 T2)	Rim 15	Gasolina	FWD	1984	132	180	01.97-11.00	■

LISTA DE APLICACIONES - BUYERS GUIDE

2.0 Turbo (B 5204 T)	Rim 15	Gasolina	FWD	1984	155	210	01.97-11.00	■
2.0 Turbo (B 5204 T3)	Rim 15	Gasolina	FWD	1984	166	226	01.97-11.00	■
2.3 T5 R		Gasolina	FWD	2319	176	239	11.96-09.98	■
T5 (B 5234 T3)	Rim 15	Gasolina	FWD	2319	176	239	01.97-11.00	■
2.3 (B 5234 T3)		Gasolina	FWD	2319	177	241	11.96-11.00	■
2.3 T5 AWD (B 5234 T3)	Rim 15	Gasolina	4WD	2319	177	241	11.96-09.98	■
2.3 T5		Gasolina	FWD	2319	184	250	07.97-09.00	■
2.3 Turbo (B 5234 T4)	Rim 15	Gasolina	FWD	2319	184	250	01.97-11.00	■
2.3		Gasolina	FWD	2319	195	265	04.99-09.00	■
2.3 (B 5234 T7)	Rim 15	Gasolina	FWD	2319	195	265	04.99-09.00	■
2.4 (B 5244 S2)	Rim 15	Gasolina	FWD	2435	103	140	08.99-11.00	■
2.4 (B 5244 SG)	Rim 15	Gasolina	FWD	2435	103	140	08.99-11.00	■
2.4 AWD (B 5244 S2)	Rim 15	Gasolina	4WD	2435	103	140	04.99-09.00	■
2.4 (B 5252 FS)	Rim 15	Gasolina	FWD	2435	106	144	01.97-11.00	■
2.4 AWD (B 5252 FS)	Rim 15	Gasolina	4WD	2435	106	144	11.96-05.99	■
2.4 (B 5254 S)	Rim 15	Gasolina	FWD	2435	121	165	06.98-11.00	■
2.4 AWD (B 5254 S)	Rim 15	Gasolina	4WD	2435	121	165	10.98-05.99	■
2.4 (B 5244 S)	Rim 15	Gasolina	FWD	2435	125	170	01.97-11.00	■
2.4 (B 5254 S)	Rim 15	Gasolina	FWD	2435	125	170	01.97-11.00	■
2.4 AWD (B 5244 S)	Rim 15	Gasolina	4WD	2435	125	170	04.99-09.00	■
2.4 T5 AWD (B 5254 T)	Rim 15	Gasolina	4WD	2435	142	193	11.96-04.99	■
2.4 Turbo (B 5244 T)	Rim 15	Gasolina	FWD	2435	142	193	01.97-11.00	■
2.4 Turbo (B 5254 T)	Rim 15	Gasolina	FWD	2435	142	193	01.97-11.00	■
2.4 Bifuel (B 5244 SG)	Rim 15	Gasol./Gas (CNG)	FWD	2435	103	140	07.99-11.00	■
2.4 Blu-Fuel (B 5244 S2)	Rim 15	Gasol./Gas (CNG)	FWD	2435	103	140	07.97-09.00	■
2.4 Blu-Fuel (B 5244 SG)	Rim 15	Gasol./Gas (CNG)	FWD	2435	103	140	07.97-09.00	■
2.4 Bifuel (GB 5252 S)	Rim 15	Gasol./Gas (CNG)	FWD	2435	106	144	10.98-11.00	■
2.5 TDI (D 5252 T)	Rim 15	Diesel	FWD	2460	103	140	01.97-11.00	■
2.5 TDi AWD (D 5252 T)	Rim 15	Diesel	4WD	2460	103	140	10.99-09.00	■
S90 (964) 11.96-12.98					Saloon (Executive car-E Segment)			
2.5 (B 6254 FS)		Gasolina	RWD	2473	125	170	11.96-10.98	■
2.5 (B 6244 FS)		Gasolina	RWD	2473	132	179	11.96-10.97	■
2.9 (B 6304 S2)		Gasolina	RWD	2922	132	180	01.97-05.98	■
2.9 (B 6304 GS)		Gasolina	RWD	2922	150	204	01.97-05.98	■
V70 (875, 876) 12.95-12.00					Estate (Executive car-E Segment)			
2.0 (B 5202 FS)	Rim 15	Gasolina	FWD	1984	93	126	12.95-03.00	■
2.0 (B 5202 S)	Rim 15	Gasolina	FWD	1984	93	126	12.95-03.00	■
2.0 (B 5204 F)	Rim 15	Gasolina	FWD	1984	105	143	12.95-03.00	■
2.0 (B 5204 T4)	Rim 15	Gasolina	FWD	1984	120	163	01.97-12.00	■
2.0 (B 5204 T2)	Rim 15	Gasolina	FWD	1984	132	180	11.96-03.00	■
2.0 Turbo (B 5204 T)	Rim 15	Gasolina	FWD	1984	155	211	12.95-03.00	■
2.0 Turbo (B 5204 T3)	Rim 15	Gasolina	FWD	1984	166	226	11.96-12.00	■
2.0 Turbo AWD (B 5204 T3)	Rim 15	Gasolina	4WD	1984	166	226	11.96-12.00	■
2.3 T-5 (B 5234 T3)	Rim 15	Gasolina	FWD	2319	176	239	11.96-12.00	■
2.3 T-5 AWD (B 5234 T3)	Rim 15	Gasolina	4WD	2319	176	239	01.97-12.00	■
2.3 (B 5234 T3)		Gasolina	FWD	2319	177	241	11.96-11.00	■

LISTA DE APLICACIONES - BUYERS GUIDE

2.3 AWD (B 5234 T3)	Rim 15	Gasolina	4WD	2319	177	241	04.97-09.98	■
2.3 T AWD (B 5234 T4)	Rim 15	Gasolina	4WD	2319	184	250	04.97-03.00	■
2.3 Turbo (B 5234 T4)	Rim 15	Gasolina	FWD	2319	184	250	12.95-03.00	■
2.3 AWD (B 5234 T7)	Rim 15	Gasolina	4WD	2319	195	265	12.98-02.00	■
2.3 AWD (B 5234 T8)	Rim 15	Gasolina	4WD	2319	195	265	12.98-02.00	■
2.4 (B 5244 S2)	Rim 15	Gasolina	FWD	2435	103	140	03.99-12.00	■
2.4 (B 5244 SG2)	Rim 15	Gasolina	FWD	2435	103	140	03.99-12.00	■
2.4 (B 5252 FS)	Rim 15	Gasolina	FWD	2435	106	144	12.95-03.00	■
2.4 (B 5254 S)	Rim 15	Gasolina	FWD	2435	121	165	06.98-12.99	■
2.4 AWD (B 5254 S)	Rim 15	Gasolina	4WD	2435	121	165	06.98-12.99	■
2.4 (B 5244 S)	Rim 15	Gasolina	FWD	2435	125	170	12.95-05.00	■
2.4 (B 5254 FS)	Rim 15	Gasolina	FWD	2435	125	170	12.95-05.00	■
2.4 (B 5254 S)	Rim 15	Gasolina	FWD	2435	125	170	12.95-05.00	■
2.4 Turbo (B 5244 T)	Rim 15	Gasolina	FWD	2435	142	193	04.96-12.00	■
2.4 Turbo (B 5254 T)	Rim 15	Gasolina	FWD	2435	142	193	04.96-12.00	■
2.4 Turbo AWD (B 5244 T)	Rim 15	Gasolina	4WD	2435	142	193	04.96-12.00	■
2.4 Turbo AWD (B 5254 T)	Rim 15	Gasolina	4WD	2435	142	193	04.96-12.00	■
2.4 Turbo	Rim 15	Gasolina	FWD	2435	195	265	05.99-02.00	■
2.4 Turbo AWD (B 5244 T2)	Rim 15	Gasolina	4WD	2435	195	265	03.99-12.00	■
2.4 Bifuel (B 5244 SG)	Rim 15	Gasol./Gas (CNG)	FWD	2435	103	140	08.99-12.00	■
2.4 Bifuel (GB 5252 S)	Rim 15	Gasol./Gas (CNG)	FWD	2435	106	144	05.98-12.99	■
2.5 TDI (D 5252 T)	Rim 15	Diesel	FWD	2460	103	140	12.95-12.00	■
2.5 TDi AWD (D 5252 T)	Rim 15	Diesel	4WD	2460	103	140	11.96-02.00	■
V90 (965) 11.96-12.98					Estate (Executive car-E Segment)			
2.5 (B 6254 FS)		Gasolina	RWD	2473	125	170	11.96-10.98	■
2.5 (B 6244 FS)		Gasolina	RWD	2473	132	179	11.96-10.97	■
2.9 (B 6304 S2)		Gasolina	RWD	2922	132	180	01.97-12.98	■
2.9 (B 6304 FS)		Gasolina	RWD	2922	150	204	01.97-12.98	■
2.9 (B 6304 GS)		Gasolina	RWD	2922	150	204	01.97-12.98	■
XC70 CROSS COUNTRY / V70 XC (295) 10.97-10.07					Estate (Executive car-E Segment)			
T5 AWD (B 5204 T3)		Gasolina	4WD	1984	166	226	10.97-03.99	■