

LISTA DE APLICACIONES - BUYERS GUIDE

78BD1971-2



Weight: 19.270

| O.E.M. | MAKE |
|-----------------|------|
| 34 21 6 771 246 | BMW |
| 34 21 6 771 971 | BMW |
| 34 21 6 886 480 | BMW |

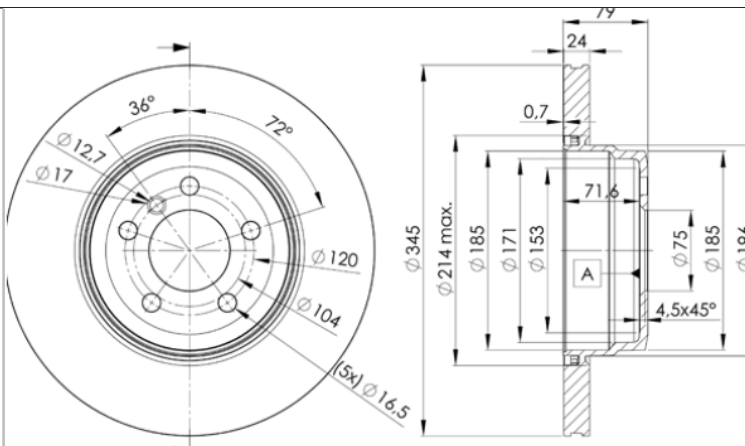

78BD1971-2

E1 90R-02C0438/1463



Ø345x24x79

| MAKE |
|------|
| BMW |



| Trac. | CC | Kw | CV | |
|-------|----|----|----|--------------|
| | | | | Front / Rear |

BMW

X5 II (E70) 02.06-07.13

| | | | | | SUV (Luxury Crossover SUV-J Segment) | | | | |
|-------------------------------|-----------------|----------|-----|------|--------------------------------------|-----|-------------|--|---|
| xDrive 40 i (N55 B30 A) | | Gasolina | 4WD | 2979 | 225 | 306 | 01.12-06.13 | | ■ |
| xDrive 35 i (N55 B30 A) | | Gasolina | 4WD | 2979 | 235 | 320 | 02.12-06.13 | | ■ |
| xDrive 30 i (N52 B30 A) | | Gasolina | 4WD | 2996 | 172 | 234 | 02.07-12.12 | | ■ |
| xDrive 30 i (N52 B30 A) | | Gasolina | 4WD | 2996 | 194 | 264 | 09.08-12.10 | | ■ |
| 4.8 i xDrive (N62 B48 B) | | Gasolina | 4WD | 4799 | 261 | 355 | 10.06-09.08 | | ■ |
| xDrive 48 i (N62 B48 B) | | Gasolina | 4WD | 4799 | 261 | 355 | 10.08-03.10 | | ■ |
| 3.0 3.0d (M57 D30 (306D3)) | Short Wheelbase | Diesel | 4WD | 2993 | 155 | 211 | 02.07-09.08 | | ■ |
| xDrive 30 d (M57 D30 (306D3)) | | Diesel | 4WD | 2993 | 155 | 211 | 10.08-07.13 | | ■ |
| xDrive 30 d (N57 D30 A) | | Diesel | 4WD | 2993 | 155 | 211 | 10.08-07.13 | | ■ |
| M 50 d (N57 D30 C) | | Diesel | 4WD | 2993 | 280 | 381 | 08.11-06.13 | | ■ |

X5 III (F15, F85) 08.13-07.18

| | | | | | SUV (Luxury Crossover SUV-J Segment) | | | | |
|-------------------------|--|---------------|-----|------|--------------------------------------|-----|-------------|--|---|
| xDrive28i (N20 B20 A) | | Gasolina | 4WD | 1997 | 180 | 245 | 06.15-07.18 | | ■ |
| sDrive 35 i (N55 B30 A) | | Gasolina | RWD | 2979 | 225 | 306 | 08.13-07.18 | | ■ |
| xDrive 35 i (N55 B30 A) | | Gasolina | 4WD | 2979 | 225 | 306 | 12.13-07.18 | | ■ |
| xDrive 35 i (N55 B30 A) | | Gasolina | 4WD | 2979 | 240 | 326 | 12.13-07.18 | | ■ |
| xDrive 50 i (N63 B44 B) | | Gasolina | 4WD | 4395 | 330 | 449 | 08.13-07.18 | | ■ |
| xDrive 40e (N20 B20 A) | | Gasol./el éc. | 4WD | 1997 | 205 | 279 | 08.15-07.18 | | ■ |
| xDrive 40e (N20 B20 A) | | Gasol./el éc. | 4WD | 1997 | 230 | 313 | 08.15-07.18 | | ■ |
| sDrive 25 d (N47 D20 D) | | Diesel | RWD | 1995 | 155 | 211 | 12.13-07.18 | | ■ |
| xDrive 25 d (N47 D20 D) | | Diesel | 4WD | 1995 | 155 | 211 | 12.13-07.15 | | ■ |
| sDrive 25 d (N47 D20 D) | | Diesel | RWD | 1995 | 160 | 218 | 12.13-07.15 | | ■ |

LISTA DE APLICACIONES - BUYERS GUIDE

| | | | | | | | |
|----------------------------------|---------------|-----|------|---|-----|-------------|---|
| xDrive 25 d (N47 D20 D) | Diesel | 4WD | 1995 | 160 | 218 | 12.13-07.15 | ■ |
| sDrive 25 d (B47 D20 B) | Diesel | RWD | 1995 | 170 | 231 | 08.15-07.18 | ■ |
| xDrive 25 d (B47 D20 B) | Diesel | 4WD | 1995 | 170 | 231 | 08.15-07.18 | ■ |
| xDrive 25 d (N57 D30 A) | Diesel | 4WD | 2993 | 160 | 218 | 04.14-07.18 | ■ |
| xDrive 30 d (N57 D30 A) | Diesel | 4WD | 2993 | 183 | 249 | 12.13-07.18 | ■ |
| xDrive 30 d (N57 D30 A) | Diesel | 4WD | 2993 | 190 | 258 | 08.13-07.18 | ■ |
| xDrive 30 d (N57 D30 A) | Diesel | 4WD | 2993 | 204 | 277 | 08.13-07.18 | ■ |
| xDrive 30 d (N57 D30 A) | Diesel | 4WD | 2993 | 210 | 286 | 08.13-07.18 | ■ |
| xDrive 40 d (N57 D30 B) | Diesel | 4WD | 2993 | 230 | 313 | 12.13-07.18 | ■ |
| M 50 d (N57 D30 C) | Diesel | 4WD | 2993 | 280 | 381 | 12.13-07.18 | ■ |
| X6 (E71, E72) 06.07-12.15 | | | | SUV (Luxury Crossover SUV-J Segment) | | | |
| xDrive 35 i (N54 B30 A) | Gasolina | 4WD | 2979 | 224 | 305 | 01.08-06.14 | ■ |
| xDrive 35 i (N55 B30 A) | Gasolina | 4WD | 2979 | 224 | 305 | 01.08-06.14 | ■ |
| 35 i | Gasolina | FWD | 2979 | 225 | 306 | 05.08-08.08 | ■ |
| xDrive 35 i (N55 B30 A) | Gasolina | 4WD | 2979 | 235 | 320 | 08.12-06.14 | ■ |
| xDrive 35 i (N54 B30 A) | Gasolina | 4WD | 2979 | 240 | 326 | 06.07-03.10 | ■ |
| xDrive 50 i (N63 B44 A) | Gasolina | 4WD | 4395 | 330 | 449 | 10.07-06.14 | ■ |
| ActiveHybrid (N63 B44 A) | Gasol./el éc. | 4WD | 4395 | 357 | 485 | 01.09-10.11 | ■ |
| 35 d | Diesel | RWD | 2993 | 210 | 286 | 05.08-08.08 | ■ |
| M 50 d (N57 D30 C) | Diesel | 4WD | 2993 | 280 | 381 | 08.11-06.14 | ■ |
| X6 II (F16, F86) 08.14- | | | | SUV (Luxury Crossover SUV-J Segment) | | | |
| xDrive28i (N20 B20 A) | Gasolina | 4WD | 1997 | 180 | 245 | 06.15-07.19 | ■ |
| xDrive 35 i (N55 B30 A) | Gasolina | 4WD | 2979 | 225 | 306 | 08.14-07.19 | ■ |
| xDrive 35 i (N55 B30 A) | Gasolina | 4WD | 2979 | 240 | 326 | 08.14-07.19 | ■ |
| xDrive 30 d (N57 D30 A) | Diesel | 4WD | 2993 | 155 | 211 | 08.14-07.19 | ■ |
| xDrive 30 d (N57 D30 A) | Diesel | 4WD | 2993 | 183 | 249 | 12.14-07.19 | ■ |
| xDrive 30 d (N57 D30 A) | Diesel | 4WD | 2993 | 190 | 258 | 08.14-07.19 | ■ |
| xDrive 30 d (N57 D30 A) | Diesel | 4WD | 2993 | 204 | 277 | 08.14-07.19 | ■ |
| xDrive 40 d (N57 D30 B) | Diesel | 4WD | 2993 | 230 | 313 | 12.14-07.19 | ■ |
| M 50 d (N57 D30 C) | Diesel | 4WD | 2993 | 280 | 381 | 08.14-07.19 | ■ |