

LISTA DE APLICACIONES - BUYERS GUIDE

78BD1972-2



Weight: 18.336

| O.E.M. | MAKE |
|-----------------|------|
| 34 11 6 774 875 | BMW |
| 34 11 6 792 219 | BMW |
| 34 11 6 855 006 | BMW |

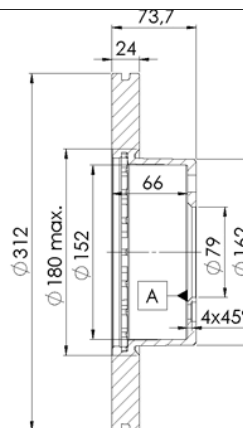
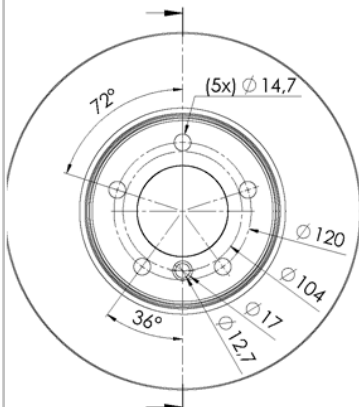

78BD1972-2



Ø312x24x73.5

MAKE

BMW



| Trac. | CC | Kw | CV |
|-------|----|----|----|
|-------|----|----|----|



Front / Rear

BMW

1 Serie II (F20) 07.11-06.19

Hatchback (Compact car-C Segment)

| | | | | | | | | |
|-------------------------------|---------------------------------------|----------------|-----|------|-----|-----|-------------|---|
| 125 i (N20 B20 A) | not M technique, not Performance brak | Gasolina | RWD | 1997 | 160 | 218 | 03.12-11.17 | ■ |
| 125 i (N20 B20 A) | not M technique, not Performance brak | Gasolina | RWD | 1997 | 160 | 218 | 12.11-12.19 | ■ |
| 125 i (N20 B20 A) | | Gasolina | RWD | 1997 | 175 | 238 | 03.12-11.17 | ■ |
| 125 i (B48 B20 B) | not M technique, not Performance brak | Gasolina | RWD | 1998 | 165 | 224 | 07.16-06.19 | ■ |
| 125 i (B48 B20 B) | not M technique, not Performance brak | Gasolina | RWD | 1998 | 165 | 224 | 10.15-06.19 | ■ |
| 125 i Active Flex (N20 B20 A) | not M technique, not Performance brak | Gasol./Et anol | RWD | 1997 | 160 | 218 | 11.14-11.17 | ■ |
| 125 d (B47 D20 B) | not M technique, not Performance brak | Diesel | RWD | 1995 | 155 | 211 | 03.12-06.19 | ■ |
| 125 d (N47 D20 D) | not M technique, not Performance brak | Diesel | RWD | 1995 | 155 | 211 | 03.12-06.19 | ■ |
| 125 d (N47 D20 D) | not M technique, not Performance brak | Diesel | RWD | 1995 | 155 | 211 | 12.11-05.19 | ■ |
| 125 d (N47 D20 D) | not M technique, not Performance brak | Diesel | RWD | 1995 | 160 | 218 | 03.12-02.15 | ■ |
| 125 d (N47 D20 D) | not M technique, not Performance brak | Diesel | RWD | 1995 | 160 | 218 | 12.11-02.15 | ■ |

2 Serie (F23) 03.14-

Convertible (Compact car-C Segment)

| | | | | | | | | |
|-------------------|---------------------------------------|----------|-----|------|-----|-----|-------------|---|
| 220 i (B48 B20 A) | not M technique, not Performance brak | Gasolina | RWD | 1998 | 135 | 184 | 09.15-06.21 | ■ |
| 230 i (B46 B20 B) | not M technique, not Performance brak | Gasolina | RWD | 1998 | 185 | 252 | 07.16-06.21 | ■ |
| 230 i (B48 B20 B) | not M technique, not Performance brak | Gasolina | RWD | 1998 | 185 | 252 | 07.16-06.21 | ■ |
| 230 i | not M technique, not Performance brak | Gasolina | FWD | 1998 | 185 | 252 | 09.16- | ■ |

LISTA DE APLICACIONES - BUYERS GUIDE

| | | | | | | | | |
|------------------------------------|---------------------------------------|----------|-----|------|--|-----|-------------|---|
| 220 D | | Diesel | RWD | 1995 | 151 | 205 | 03.14-09.20 | ■ |
| 2 Serie (F22, F87) 10.12- | | | | | Coupe (Compact car-C Segment) | | | |
| 220 i (B48 B20 A) | not M technique, not Performance brak | Gasolina | RWD | 1998 | 135 | 184 | 09.15-06.21 | ■ |
| 225 i | | Gasolina | RWD | 1998 | 135 | 184 | 10.17-06.21 | ■ |
| 230 i (B46 B20 B) | not M technique, not Performance brak | Gasolina | RWD | 1998 | 185 | 252 | 07.16-06.21 | ■ |
| 230 i (B48 B20 B) | not M technique, not Performance brak | Gasolina | RWD | 1998 | 185 | 252 | 07.16-06.21 | ■ |
| 230 i | not M technique, not Performance brak | Gasolina | FWD | 1998 | 185 | 252 | 09.16- | ■ |
| 220 D | | Diesel | RWD | 1995 | 151 | 205 | 03.14-09.20 | ■ |
| 220 d xDrive | | Diesel | 4WD | 1995 | 151 | 205 | 06.14-09.20 | ■ |
| 3 Serie V (E93) 05.06-12.13 | | | | | Convertible (Compact executive car-D Segment) | | | |
| 320i | not M technique | Gasolina | RWD | 1995 | 110 | 149 | 01.07-08.13 | ■ |
| 320i (N46 B20 B) | not M technique | Gasolina | RWD | 1995 | 115 | 156 | 01.07-08.13 | ■ |
| 320i (N43 B20 A) | not M technique | Gasolina | RWD | 1995 | 125 | 170 | 03.07-10.13 | ■ |
| 323 i (N52 B25 A) | | Gasolina | RWD | 2497 | 140 | 190 | 03.07-09.11 | ■ |
| 320 d (N47 D20 C) | | Diesel | RWD | 1995 | 120 | 163 | 01.08-12.13 | ■ |
| 320 d (N47 D20 A) | not M technique | Diesel | RWD | 1995 | 130 | 177 | 03.08-02.10 | ■ |
| 320 d (N47 D20 C) | not M technique | Diesel | RWD | 1995 | 130 | 177 | 03.08-02.10 | ■ |
| 320 d (N47 D20 C) | not M technique | Diesel | RWD | 1995 | 135 | 184 | 03.10-10.13 | ■ |
| 320 d (N47 D20 A) | | Diesel | RWD | 1995 | 145 | 197 | 09.07-02.10 | ■ |
| 320 d (N47 D20 C) | | Diesel | RWD | 1995 | 145 | 197 | 09.07-02.10 | ■ |
| 320 d (N47 D20 C) | | Diesel | RWD | 1995 | 147 | 200 | 03.10-10.13 | ■ |
| 3 Serie V (E92) 01.05-12.13 | | | | | Coupe (Compact executive car-D Segment) | | | |
| 325i (N52 B25 A) | | Gasolina | RWD | 2497 | 150 | 204 | 03.10-10.13 | ■ |
| 325i (N52 B25 AF) | | Gasolina | RWD | 2497 | 150 | 204 | 03.10-10.13 | ■ |
| 325i (N52 B25 BF) | | Gasolina | RWD | 2497 | 150 | 204 | 03.10-10.13 | ■ |
| 325 i xDrive (N52 B25 A) | | Gasolina | 4WD | 2497 | 150 | 204 | 03.10-04.13 | ■ |
| 325 i xDrive (N52 B25 AF) | | Gasolina | 4WD | 2497 | 155 | 211 | 03.10-04.13 | ■ |
| 325i (N52 B25 A) | not M technique | Gasolina | RWD | 2497 | 160 | 218 | 06.06-02.10 | ■ |
| 325i (N52 B25 AF) | not M technique | Gasolina | RWD | 2497 | 160 | 218 | 06.06-02.10 | ■ |
| 325i (N52 B25 BF) | not M technique | Gasolina | RWD | 2497 | 160 | 218 | 06.06-02.10 | ■ |
| 328 i xDrive (N51 B30 A) | | Gasolina | 4WD | 2996 | 172 | 234 | 09.08-06.13 | ■ |
| 328 i xDrive (N52 B30 A) | | Gasolina | 4WD | 2996 | 172 | 234 | 09.08-06.13 | ■ |
| 320 d xDrive (N47 D20 C) | | Diesel | 4WD | 1995 | 120 | 163 | 09.08-06.13 | ■ |
| 320 d (N47 D20 A) | not M technique | Diesel | RWD | 1995 | 130 | 177 | 09.06-02.10 | ■ |
| 320 d (N47 D20 C) | not M technique | Diesel | RWD | 1995 | 130 | 177 | 09.06-02.10 | ■ |
| 320 d xDrive (N47 D20 C) | | Diesel | 4WD | 1995 | 130 | 177 | 09.08-02.10 | ■ |
| 320 xd | | Diesel | 4WD | 1995 | 130 | 177 | 09.08-02.10 | ■ |
| 320 d (N47 D20 C) | not M technique | Diesel | RWD | 1995 | 135 | 184 | 03.10-06.13 | ■ |
| 320 d xDrive (N47 D20 C) | | Diesel | 4WD | 1995 | 135 | 184 | 03.10-06.13 | ■ |
| 320 d xDrive (N47 D20 C) | | Diesel | 4WD | 1995 | 145 | 197 | 09.08-02.10 | ■ |
| 320 d xDrive (N47 D20 C) | | Diesel | 4WD | 1995 | 147 | 200 | 03.10-06.13 | ■ |
| 3 Serie V (E90) 02.04-02.12 | | | | | Saloon (Compact executive car-D Segment) | | | |
| 320i (N43 B20 A) | not M technique, increased payload | Gasolina | RWD | 1995 | 120 | 163 | 03.07-12.11 | ■ |
| 320i (N43 B20 A) | not M technique, increased payload | Gasolina | RWD | 1995 | 125 | 170 | 09.07-10.11 | ■ |
| 325 xi (N52 B25 A) | not increas.payload | Gasolina | 4WD | 2497 | 160 | 218 | 09.05-08.08 | ■ |
| 325 i xDrive (N53 B30 A) | | Gasolina | 4WD | 2996 | 155 | 211 | 09.08-10.11 | ■ |

LISTA DE APLICACIONES - BUYERS GUIDE

| | | | | | | | | |
|--|--|----------|-----|------|---|-----|-------------|---|
| 325i (N53 B30 A) | not M technique, increased payload | Gasolina | RWD | 2996 | 160 | 218 | 03.07-12.11 | ■ |
| 325 i xDrive (N53 B30 A) | not increas.payload | Gasolina | 4WD | 2996 | 160 | 218 | 09.08-10.11 | ■ |
| 325 xi (N53 B30 A) | not increas.payload | Gasolina | 4WD | 2996 | 160 | 218 | 09.07-08.08 | ■ |
| 320 d xDrive (N47 D20 C) | not government vehic | Diesel | 4WD | 1995 | 120 | 163 | 09.08-10.11 | ■ |
| 320 d (N47 D20 A) | not government vehic, not M technique | Diesel | RWD | 1995 | 130 | 177 | 09.07-02.10 | ■ |
| 320 d (N47 D20 C) | not government vehic, not M technique | Diesel | RWD | 1995 | 130 | 177 | 09.07-02.10 | ■ |
| 320 d xDrive (N47 D20 A) | not government vehic | Diesel | 4WD | 1995 | 130 | 177 | 09.08-02.10 | ■ |
| 320 d xDrive (N47 D20 C) | not government vehic | Diesel | 4WD | 1995 | 130 | 177 | 09.08-02.10 | ■ |
| 320 xd | not government vehic | Diesel | 4WD | 1995 | 130 | 177 | 09.07-12.11 | ■ |
| 320 d (N47 D20 C) | not government vehic, not M technique | Diesel | RWD | 1995 | 135 | 184 | 03.10-10.11 | ■ |
| 320 d xDrive (N47 D20 C) | not government vehic | Diesel | 4WD | 1995 | 135 | 184 | 03.10-10.11 | ■ |
| 3 Serie V Touring (E91) 12.04-12.12 | | | | | Estate (Compact executive car-D Segment) | | | |
| 318i (N43 B20 A) | 02/08-, not M technique, not increas.payload | Gasolina | RWD | 1995 | 105 | 143 | 05.07-05.12 | ■ |
| 320i (N46 B20 B) | | Gasolina | RWD | 1995 | 115 | 156 | 09.05-06.12 | ■ |
| 320i (N46 B20 BD) | | Gasolina | RWD | 1995 | 115 | 156 | 09.05-06.12 | ■ |
| 320i (N46 B20 C) | | Gasolina | RWD | 1995 | 115 | 156 | 09.05-06.12 | ■ |
| 320i (N43 B20 A) | | Gasolina | RWD | 1995 | 120 | 163 | 02.07-05.12 | ■ |
| 320i (N43 B20 A) | not M technique | Gasolina | RWD | 1995 | 125 | 170 | 02.07-12.12 | ■ |
| 325 xi (N52 B25 A) | not increas.payload | Gasolina | 4WD | 2497 | 160 | 218 | 08.05-08.08 | ■ |
| 325i (N53 B30 A) | not M technique, not increas.payload | Gasolina | RWD | 2996 | 155 | 211 | 09.07-06.12 | ■ |
| 325i (N53 B30 A) | not M technique, not increas.payload | Gasolina | RWD | 2996 | 160 | 218 | 09.07-06.12 | ■ |
| 318 d (N47 D20 A) | not M technique | Diesel | RWD | 1995 | 100 | 136 | 07.07-06.12 | ■ |
| 318 d (N47 D20 C) | not M technique | Diesel | RWD | 1995 | 100 | 136 | 07.07-06.12 | ■ |
| 318 d (N47 D20 A) | not M technique | Diesel | RWD | 1995 | 105 | 143 | 09.07-06.12 | ■ |
| 318 d (N47 D20 C) | not M technique | Diesel | RWD | 1995 | 105 | 143 | 09.07-06.12 | ■ |
| 320 d xDrive (N47 D20 C) | not government vehic | Diesel | 4WD | 1995 | 120 | 163 | 07.09-06.12 | ■ |
| 320 d (N47 D20 A) | not government vehic, not M technique | Diesel | RWD | 1995 | 130 | 177 | 02.07-12.10 | ■ |
| 320 d (N47 D20 C) | not government vehic, not M technique | Diesel | RWD | 1995 | 130 | 177 | 02.07-12.10 | ■ |
| 320 d xDrive (N47 D20 C) | not government vehic | Diesel | 4WD | 1995 | 130 | 177 | 09.08-02.10 | ■ |
| 320 xd | not government vehic | Diesel | RWD | 1995 | 130 | 177 | 02.08-02.10 | ■ |
| 320 d (N47 D20 C) | not government vehic, not M technique | Diesel | RWD | 1995 | 135 | 184 | 03.10-05.12 | ■ |
| 320 d xDrive (N47 D20 C) | not government vehic | Diesel | 4WD | 1995 | 135 | 184 | 03.10-06.12 | ■ |
| 320 d (N47 D20 A) | | Diesel | RWD | 1995 | 145 | 197 | 02.07-02.10 | ■ |
| 320 d (N47 D20 C) | | Diesel | RWD | 1995 | 145 | 197 | 02.07-02.10 | ■ |
| 320 d xDrive (N47 D20 C) | | Diesel | 4WD | 1995 | 145 | 197 | 02.08-02.10 | ■ |
| 320 d xDrive (N47 D20 C) | | Diesel | 4WD | 1995 | 147 | 200 | 03.10-05.12 | ■ |
| 3 Serie VI (U.S.A.) 09.11- | | | | | Saloon (Compact executive car-D Segment) | | | |
| 320i (N13 B16 A) | with cruise control, not Performance brak | Gasolina | RWD | 1598 | 125 | 170 | 11.12-06.16 | ■ |
| 320i | with cruise control, not M technique, not Performance brak | Gasolina | FWD | 1997 | 134 | 182 | 09.12- | ■ |
| 320i | with cruise control, not M technique, not Performance brak | Gasolina | RWD | 1997 | 134 | 182 | 03.12-10.18 | ■ |
| 320 i xDrive (N20 B20 A) | not M technique, Japan | Gasolina | 4WD | 1997 | 135 | 184 | 07.12-10.18 | ■ |
| 320 i xDrive (N20 B20 B) | not M technique, Japan | Gasolina | 4WD | 1997 | 135 | 184 | 07.12-10.18 | ■ |
| 320 d (N47 D20 C) | not M technique, not Performance brak | Diesel | RWD | 1995 | 135 | 184 | 11.11-03.16 | ■ |

LISTA DE APLICACIONES - BUYERS GUIDE

| | | | | | | | | |
|---|--|---------------|-----|------|--|-----|-------------|---|
| 320 d xDrive (N47 D20 C) | not M technique, not Performance brak | Diesel | 4WD | 1995 | 135 | 184 | 08.12-06.15 | ■ |
| 3 Serie VI GRAN TURISMO (F34) 07.12- | | | | | Hatchback (Compact executive car-D Segment) | | | |
| 320 d (N47 D20 C) | not M technique, not Performance brak | Diesel | RWD | 1995 | 135 | 184 | 03.13-06.15 | ■ |
| 3 Serie VI Touring (F31) 07.12-06.19 | | | | | Estate (Compact executive car-D Segment) | | | |
| 320i (N20 B20 B) | with cruise control, not M technique, not Performance brak | Gasolina | RWD | 1997 | 135 | 184 | 11.12-06.15 | ■ |
| 320 i xDrive (N20 B20 B) | with cruise control, not M technique, not Performance brak | Gasolina | 4WD | 1997 | 135 | 184 | 03.13-06.15 | ■ |
| 320 d (N47 D20 C) | not M technique | Diesel | RWD | 1995 | 135 | 184 | 07.12-02.16 | ■ |
| 320 d xDrive (N47 D20 C) | not M technique, not Performance brak | Diesel | 4WD | 1995 | 135 | 184 | 03.13-06.15 | ■ |
| 3 Serie VI Touring Van (F31) 07.12-06.19 | | | | | Estate Van (Compact executive car-D Segment) | | | |
| 340 i (B58 B30 A) | | Gasolina | RWD | 2998 | 240 | 326 | 07.15-06.19 | ■ |
| 4 Serie (F33, F83) 10.13- | | | | | Convertible (Compact executive car-D Segment) | | | |
| 420 D | | Diesel | RWD | 1995 | 151 | 205 | 07.15-07.20 | ■ |
| 4 Serie (F32, F82) 07.13- | | | | | Coupe (Compact executive car-D Segment) | | | |
| 420 D (N47 D20 C) | not M technique | Diesel | RWD | 1995 | 135 | 184 | 07.13-02.15 | ■ |
| 420 D (B47 D20 A) | not M technique | Diesel | RWD | 1995 | 140 | 190 | 03.15-06.20 | ■ |
| 420 d xDrive (B47 D20 A) | not M technique | Diesel | 4WD | 1995 | 140 | 190 | 03.15-06.20 | ■ |
| 420 D (N47 D20 C) | not M technique | Diesel | RWD | 1995 | 147 | 200 | 07.13-03.15 | ■ |
| 420 d xDrive (N47 D20 C) | not M technique | Diesel | 4WD | 1995 | 147 | 200 | 11.13-03.15 | ■ |
| X1 (E84) 03.09-06.15 | | | | | SUV (Compact SUV-J Segment) | | | |
| sDrive 16i (N20 B16 A) | | Gasolina | RWD | 1592 | 105 | 143 | 03.13-06.15 | ■ |
| sDrive18i (N46 B20 B) | | Gasolina | RWD | 1995 | 100 | 136 | 03.10-06.15 | ■ |
| sDrive18i (N46 B20 BD) | | Gasolina | RWD | 1995 | 100 | 136 | 03.10-06.15 | ■ |
| sDrive18i (N46 B20 B) | | Gasolina | RWD | 1995 | 110 | 150 | 03.10-06.15 | ■ |
| sDrive18i (N46 B20 BD) | | Gasolina | RWD | 1995 | 110 | 150 | 03.10-06.15 | ■ |
| sDrive18i (N46 B20 C) | | Gasolina | RWD | 1995 | 110 | 150 | 03.10-06.15 | ■ |
| sDrive18i (N46 B20 CC) | | Gasolina | RWD | 1995 | 110 | 150 | 03.10-06.15 | ■ |
| sDrive18i (N46 B20 CD) | | Gasolina | RWD | 1995 | 110 | 150 | 03.10-06.15 | ■ |
| sDrive18i (N46 B20 E) | | Gasolina | RWD | 1995 | 110 | 150 | 03.10-06.15 | ■ |
| sDrive20i (N20 B20 A) | | Gasolina | RWD | 1997 | 135 | 184 | 09.11-06.15 | ■ |
| xDrive20i (N20 B20 A) | | Gasolina | 4WD | 1997 | 135 | 184 | 09.11-06.15 | ■ |
| sDrive28i (N20 B20 A) | | Gasolina | RWD | 1997 | 180 | 245 | 09.12-06.15 | ■ |
| xDrive 28 i Flex (N20 B20 A) | | Gasol./Etanol | 4WD | 1997 | 180 | 245 | 04.11-06.15 | ■ |
| sDrive 16 d (N47 D20 C) | | Diesel | RWD | 1995 | 85 | 116 | 04.12-06.15 | ■ |
| sDrive 18 d (N47 D20 C) | | Diesel | RWD | 1995 | 105 | 143 | 12.09-06.15 | ■ |
| xDrive 18 d (N47 D20 C) | | Diesel | 4WD | 1995 | 105 | 143 | 10.09-06.15 | ■ |
| sDrive 20 d (N47 D20 C) | | Diesel | RWD | 1995 | 130 | 177 | 10.09-06.15 | ■ |
| xDrive 20 d (N47 D20 C) | | Diesel | 4WD | 1995 | 130 | 177 | 09.09-06.12 | ■ |
| sDrive 20 d (N47 D20 C) | | Diesel | RWD | 1995 | 135 | 184 | 07.12-06.15 | ■ |
| xDrive 20 d (N47 D20 C) | | Diesel | 4WD | 1995 | 135 | 184 | 07.12-06.15 | ■ |
| xDrive 25 d (N47 D20 D) | 03/12- | Diesel | 4WD | 1995 | 160 | 218 | 10.09-06.15 | ■ |