

LISTA DE APLICACIONES - BUYERS GUIDE

78BD2020-2



Weight: 7.580

O.E.M.	MAKE
43512-52020	TOYOTA
43512-52050	TOYOTA

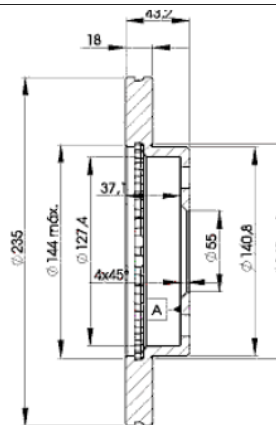

78BD2020-2



Ø234.5x18x43

MAKE
TOYOTA



Trac.	CC	Kw	CV
-------	----	----	----



Front / Rear

TOYOTA

ECHO (_P1_) 08.99-01.06

Saloon (Supermini car-B Segment)

1.3 (NCP11) (2NZ-FE)	Gasolina	FWD	1299	60	82	04.03-08.05	■
1.3 (NCP11) (2NZ-FE)	Gasolina	FWD	1299	64	87	04.03-08.05	■
1.5 (NCP12_, NCP12R) (1NZ-FE)	Gasolina	FWD	1497	78	106	08.99-08.05	■

PLATZ (NCP1_, SCP1_) 04.99-10.05

Saloon (Supermini car-B Segment)

1.0 (SCP11_, SCP11) (1SZ-FE)	Gasolina	FWD	998	50	68	04.99-08.05	■
1.3 (NCP10_, NCP10) (2NZ-FE)	Gasolina	FWD	1299	63	86	08.99-08.05	■
1.5 (NCP12_, NCP12) (1NZ-FE)	Gasolina	FWD	1497	78	106	04.99-08.05	■

YARIS II / VITZ (_P9_) 01.05-

Hatchback (Supermini car-B Segment)

1.3 VVT-i (SCP90_, SCP90R) (2SZ-FE)	Gasolina	FWD	1298	64	87	08.05-11.10	■
-------------------------------------	----------	-----	------	----	----	-------------	---

YARIS / ECHO / VITZ (_P1_) 01.99-12.05

Hatchback (Supermini car-B Segment)

1.0 (SCP10_, SCP10R) (1SZ-FE)	vehicles with ABS	Gasolina	FWD	998	48	65	03.03-09.05	■
1.0 (SCP10_, SCP10R) (1SZ-FE)	vehicles with ABS	Gasolina	FWD	998	50	68	04.99-09.05	■
1.3 (NCP10, SCP12_) (2NZ-FE)	vehicles with ABS	Gasolina	FWD	1299	63	86	08.99-11.05	■