

LISTA DE APLICACIONES - BUYERS GUIDE

78BD2040-2



Weight: 9.256

O.E.M.	MAKE
43512-0D050	TOYOTA
43512-17130	TOYOTA
43512-52040	TOYOTA
43512-52090	TOYOTA

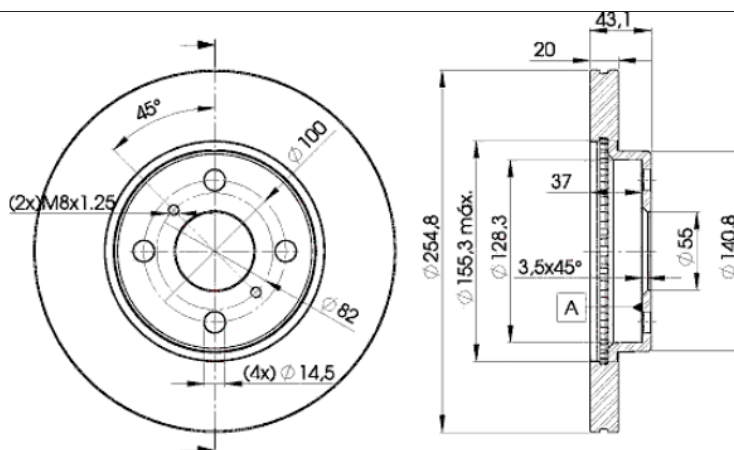

78BD2040-2

E1 90R-02C0452/0026



Ø255x20x43.4

MAKE
FAW (TIANJIN)
GEELY
GREAT WALL
TOYOTA



Trac.	CC	Kw	CV		
					Front / Rear

FAW (TIANJIN)

WEIZHI 01.06-						Hatchback ()		
1.3	Gasolina	FWD	1342	64	87	10.06-12.09	■	
1.3	Gasolina	FWD	1342	68	92	01.07-12.10	■	
WEIZHI V5 04.12-						Saloon ()		
1.5 (CA4GA5)	Gasolina	FWD	1497	75	102	04.12-04.18	■	

GEELY

KINGKONG 06.05-						Saloon ()		
1.5 (5A-FE)	Gasolina	FWD	1498	69	93	05.06-12.10	■	
1.5 (MR479QA)	Gasolina	FWD	1498	69	93	05.06-12.10	■	
MK II 01.12-						Saloon (Compact car-C Segment)		
1.5 (MR479QA)	Gasolina	FWD	1498	69	94	01.12-	■	

GREAT WALL

COOLBEAR / CB150 01.08-12.13						MPV (Large MPV-M1 Segment)		
1.5 (GW4G15)	Gasolina	FWD	1497	77	105	03.09-12.13	■	
FLORID 09.08-						Hatchback ()		
1.3 (GW413EF)	Gasolina	FWD	1342	65	88	09.08-12.10	■	
1.3	Gasolina	FWD	1342	68	92	05.09-12.12	■	
1.5 (GW4G15)	Gasolina	FWD	1497	77	105	02.09-12.12	■	
FLORID CROSS 08.09-12.14						Hatchback ()		
1.5	Gasolina	FWD	1497	77	105	08.09-12.14	■	

LISTA DE APLICACIONES - BUYERS GUIDE

HOVER M2 / HAVAL M2 03.10-					SUV (Compact SUV-J Segment)			
1.5 (GW4G15)		Gasolina	FWD	1497	73	99	01.13-	■
1.5 (GW4G15)		Gasolina	FWD	1497	77	105	03.10-12.14	■
1.5 A las 4 ruedas (GW4G15)		Gasolina	4WD	1497	77	105	03.10-12.12	■
HOVER M4 05.12-					SUV (Compact SUV-J Segment)			
1.5 (GW4G15)		Gasolina	FWD	1497	78	106	05.12-	■
PERI CROSS 03.08-01.10					Hatchback ()			
1.3 (GW413EF)		Gasolina	FWD	1342	65	88	03.08-01.10	■
TOYOTA								
bB (NCP3_) 01.00-12.05					MPV (Compact MPV-M1 Segment)			
1.5 4WD (NCP35) (1NZ-FE)		Gasolina	4WD	1497	77	105	03.00-12.05	■
ECHO (_P1_) 08.99-01.06					Saloon (Supermini car-B Segment)			
1.5 (NCP12_) (1NZ-FE)		Gasolina	FWD	1497	81	110	08.99-12.05	■
IST / XA (NCP6_) 04.02-07.07					Hatchback (Supermini car-B Segment)			
1.3 VVTi (NCP60) (2NZ-FE)		Gasolina	FWD	1299	63	86	05.04-07.07	■
1.5 VVTi (NCP61_, NCP61) (1NZ-FE)		Gasolina	FWD	1497	80	109	05.04-07.07	■
MR 2 III / MR (ZZW3_) 10.99-06.07					Convertible (Sports car-S Segment)			
1.8 16V VT-i (ZZW30) (1ZZ-FE)	vehicles with ABS	Gasolina	RWD	1794	103	140	10.99-06.07	■
VIOS / SOLUNA VIOS / YARIS / BELTA (_P4_) 07.02-08.13					Saloon (Supermini car-B Segment)			
1.3 VVTi (AXP41_) (8A-FE)		Gasolina	FWD	1342	64	87	07.02-01.08	■
1.5 VVTi (NCP42_) (1NZ-FE)		Gasolina	FWD	1497	68	92	10.02-10.06	■
1.5 VVTi (NCP42_, NCP42R) (1NZ-FE)		Gasolina	FWD	1497	80	109	10.02-10.06	■
1.5 (AXP42_, NCP42_) (5A-FE)		Gasolina	FWD	1498	68	92	07.02-01.08	■
Will CYPHA (NCP7_) 05.01-07.05					Hatchback (Compact car-C Segment)			
1.3 VVTi (NCP70) (2NZ-FE)		Gasolina	FWD	1299	62	84	05.01-07.05	■
1.5 VVTi 4WD (NCP75) (1NZ-FE)		Gasolina	4WD	1497	78	106	05.01-07.05	■
Will Vi (NCP19_) 01.00-12.01					Saloon (Compact car-C Segment)			
1.3 (NCP19) (2NZ-FE)		Gasolina	FWD	1298	64	87	01.00-12.01	■
YARIS II / VITZ (_P9_) 01.05-					Hatchback (Supermini car-B Segment)			
1.3 VVT-i (SCP90_, SCP90R) (2SZ-FE)		Gasolina	FWD	1298	64	87	08.05-11.10	■
YARIS VERSO / ECHO VERSO / FUN CARGO (_P2_) 03.00-09.05					Hatchback Van (Mini MPV-M1 Segment)			
1.3 VVTi (NCP22_) (2NZ-FE)		Gasolina	FWD	1299	62	84	04.03-09.05	■
1.3 VVTi (NCP22_) (2NZ-FE)		Gasolina	FWD	1299	63	86	03.00-09.05	■
1.5 VVTi (NCP21_) (1NZ-FE)		Gasolina	FWD	1497	78	106	03.00-03.03	■
1.4 D4d (NLP22_) (1ND-TV)		Diesel	FWD	1364	55	75	10.01-09.05	■
YARIS VERSO / ECHO VERSO / FUN CARGO (_P2_) 08.99-09.05					MPV (Mini MPV-M1 Segment)			
1.3 (NCP20_, NCP22_, NCP20R, NCP22R) (2NZ-FE)		Gasolina	FWD	1299	62	84	11.02-09.05	■
1.3 (NCP20_, NCP22_, NCP20R, NCP22R) (2NZ-FE)		Gasolina	FWD	1299	63	86	08.99-10.02	■
1.5 (NCP21_) (1NZ-FE)		Gasolina	FWD	1497	77	105	03.00-09.05	■
1.5 (NCP21_) (1NZ-FE)		Gasolina	FWD	1497	78	106	03.00-09.05	■
1.5 4WD (NCP25) (1NZ-FE)		Gasolina	4WD	1497	78	106	03.00-09.05	■
1.5 (NCP21)		Gasolina	FWD	1497	80	109	08.02-09.05	■
1.5 (NCP21)		Gasolina	FWD	1497	81	110	01.00-07.02	■
1.4 D-4D (NLP20_, NLP22_) (1ND-TV)		Diesel	FWD	1364	55	75	09.00-09.05	■

LISTA DE APLICACIONES - BUYERS GUIDE

YARIS / ECHO / VITZ (_P1_) 01.99-12.05					Hatchback (Supermini car-B Segment)				
1.0 (SCP10_, SCP10R) (1SZ-FE)	vehicles with ABS	Gasolina	FWD	998	48	65	03.03-09.05	■	
1.0 (SCP10_, SCP10R) (1SZ-FE)	vehicles with ABS	Gasolina	FWD	998	50	68	04.99-09.05	■	
1.3 (SCP12_, SCP13_, SCP12R, SCP13R) (2SZ-FE)	vehicles with ABS	Gasolina	FWD	1298	64	87	04.02-09.05	■	
1.3		Gasolina	FWD	1299	57	76	09.03-12.04	■	
1.3 (NCP10, SCP12_) (2NZ-FE)	vehicles with ABS	Gasolina	FWD	1299	63	86	08.99-11.05	■	
1.5 (NCP13_, NCP13R) (1NZ-FE)		Gasolina	FWD	1497	77	105	01.03-11.05	■	
1.5 (NCP13_, NCP13R) (1NZ-FE)		Gasolina	FWD	1497	78	106	04.01-09.05	■	
1.5 (NCP13_, NCP13R) (1NZ-FE)		Gasolina	FWD	1497	110	150	03.00-07.05	■	
1.4 D-4D (NLP10_, NLP10R) (1ND-TV)	vehicles with ABS	Diesel	FWD	1364	55	75	10.01-09.05	■	