

LISTA DE APLICACIONES - BUYERS GUIDE

78BD2058-2



Weight: 10.440

O.E.M.	MAKE
18 021 354	OPEL
1802 1354	PONTIAC
5 691 07	OPEL
5 691 10	OPEL
9 195 254	OPEL
9 195 294	OPEL
90 542 180	OPEL

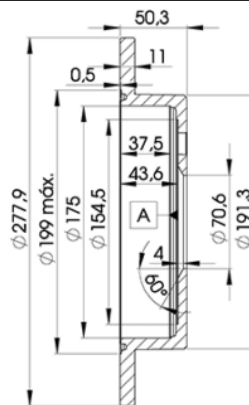
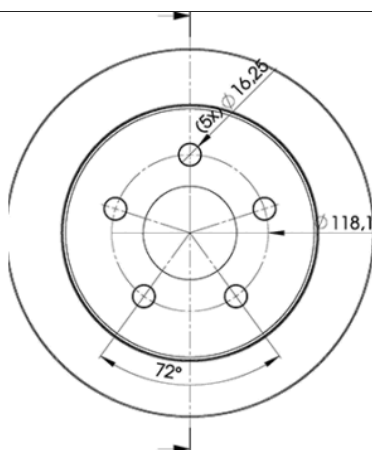

78BD2058-2

E1 90R-02C0241/1351



Ø278x11x50.3

MAKE
BUICK
CHEVROLET
OLDSMOBILE
OPEL
PONTIAC
VAUXHALL



Trac.	CC	Kw	CV		
					Front / Rear

BUICK

REGAL IV (4WF_) 10.97-12.08

Saloon (Large family car-D Segment)

3.8 (L36(231CUV6))	Gasolina	FWD	3791	149	203	10.02-09.04	■
--------------------	----------	-----	------	-----	-----	-------------	---

CHEVROLET

ALERO 03.99-09.04

Saloon (Compact car-C Segment)

2.2 (L61)	Gasolina	FWD	2198	104	141	12.01-09.04	■
2.4 16V (LD9(146CUL4))	Gasolina	FWD	2392	104	141	03.99-09.04	■
3.4 V6 (LA1)	Gasolina	FWD	3350	130	177	03.99-09.04	■

CAPRICE V 10.96-09.03

Saloon (Luxury car-F Segment)

3.8 (LN3)	Gasolina	RWD	3791	94	128	03.99-09.03	■
3.8 (L67)	Gasolina	RWD	3791	179	243	03.99-09.03	■

IMPALA VIII 01.99-12.05

Saloon (Executive car-E Segment)

3.4 V6 (LA1)	Gasolina	FWD	3350	134	182	01.99-12.05	■
3.8 V6 (L36(231CUV6))	Gasolina	FWD	3791	149	203	01.99-12.05	■
3.8 (L67)	Gasolina	FWD	3791	179	243	06.03-05.05	■
5.7 (LS1)	Gasolina	FWD	5665	212	288	10.99-05.05	■

MONTE CARLO VI-VII 09.99-12.07

Coupe (Luxury car-F Segment)

3.4 (LA1)	Gasolina	FWD	3350	134	182	09.99-12.05	■
3.8 (L36(231CUV6))	Gasolina	FWD	3791	149	203	09.99-12.05	■

TRANS SPORT (2U_) 11.96-09.03

Box Body/MPV (Large MPV-M1 Segment)

3.4	Gasolina	FWD	3350	137	186	11.96-08.01	■
3.4	Gasolina	FWD	3350	138	188	09.01-09.03	■

LISTA DE APLICACIONES - BUYERS GUIDE

TRANS SPORT 08.96-09.05					MPV (Large MPV-M1 Segment)			
3.4 (LA1)		Gasolina	FWD	3350	137	186	08.96-09.05	■
3.4 V6 (LA1)		Gasolina	FWD	3350	138	188	10.00-09.05	■
VENTURE 09.96-12.05					MPV (Large MPV-M1 Segment)			
3.4 (LA1)		Gasolina	FWD	3350	130	177	04.98-09.04	■
3.4		Gasolina	FWD	3350	134	182	09.96-12.99	■
3.4 AWD		Gasolina	4WD	3350	134	182	01.02-12.04	■
3.4 (LA1)		Gasolina	FWD	3350	138	188	09.01-12.05	■
OLDSMOBILE								
ALERO (U.S.A.) 09.98-12.04					Saloon (Compact car-C Segment)			
3.4 (LA1)		Gasolina	FWD	3350	126	173	09.98-12.04	■
INTRIGUE (U.S.A.) 09.97-12.02					Saloon ()			
3.5 (LX5(212CUV6))		Gasolina	FWD	3473	160	218	09.98-12.02	■
3.8 (L36(231CUV6))		Gasolina	FWD	3791	145	197	09.97-12.99	■
OPEL								
SINTRA (APV) 11.96-04.99					MPV (Large MPV-M1 Segment)			
2.2 i 16V (OUN16, Y94) (X 22 XE)		Gasolina	FWD	2198	104	141	11.96-04.99	■
3.0 i 24V (OUN16, Y94) (X 30 XE)		Gasolina	FWD	2962	148	201	11.96-04.99	■
2.2 DTI (X 22 DTH)		Diesel	FWD	2171	85	116	07.97-04.99	■
PONTIAC								
GRAND PRIX VI 07.96-12.03					Coupe (Executive car-E Segment)			
3.1 (L82(191CUV6))		Gasolina	FWD	3135	119	162	09.96-12.97	■
3.8 GT (L36(231CUV6))		Gasolina	FWD	3791	145	197	07.96-07.99	■
3.8 GT (L36(231CUV6))		Gasolina	FWD	3791	149	203	08.99-12.03	■
3.8 GT Power (L67)		Gasolina	FWD	3791	179	243	07.96-12.03	■
GRAND PRIX VI 07.96-12.03					Saloon (Executive car-E Segment)			
3.1 (L82(191CUV6))		Gasolina	FWD	3135	119	162	07.96-07.99	■
3.1 (L82(191CUV6))		Gasolina	FWD	3135	131	178	08.99-12.03	■
3.8 (L36(231CUV6))		Gasolina	FWD	3791	145	197	07.96-07.99	■
3.8 (L36(231CUV6))		Gasolina	FWD	3791	149	203	08.99-12.03	■
3.8 GT Power (L67)		Gasolina	FWD	3791	179	243	07.96-12.03	■
MONTANA 04.98-12.05					MPV (Large MPV-M1 Segment)			
3.4 (LA1)		Gasolina	FWD	3350	138	188	04.98-08.05	■
3.4 AWD (LA1)		Gasolina	4WD	3350	138	188	04.98-08.05	■
TRANS SPORT II 11.96-08.98					Box Body/MPV (Large MPV-M1 Segment)			
3.4		Gasolina	FWD	3350	134	182	11.96-08.98	■
TRANS SPORT II 03.97-12.99					MPV (Large MPV-M1 Segment)			
3.4 (LA1)		Gasolina	FWD	3350	134	182	03.97-09.98	■
3.4 (LA1)		Gasolina	FWD	3350	137	186	09.98-12.99	■
VAUXHALL								
SINTRA (APV) 09.96-04.99					MPV (Large MPV-M1 Segment)			
2.2 i 16V (X 22 XE)		Gasolina	FWD	2198	104	141	11.96-04.99	■
3.0 i 24V (X 30 XE)		Gasolina	FWD	2962	148	201	11.96-04.99	■
2.2 DTI (X 22 DTH)		Diesel	FWD	2171	85	116	07.97-04.99	■