

# LISTA DE APLICACIONES - BUYERS GUIDE

## 78BD2215-1



Weight: 8.840

O.E.M.	MAKE
34 11 1 157 391	BMW
34 11 1 158 038	BMW
34 11 1 159 896	BMW
34 11 6 756 090	BMW

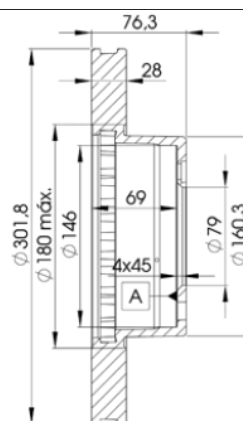

## 78BD2215-1

E1 90R-02C0074/1558



Ø302x28x76.1

MAKE

BMW



Trac.	CC	Kw	CV		
					Front / Rear

### BMW

#### 5 Serie III (E34) 02.87-12.95

#### Saloon (Executive car-E Segment)

540 i V8 (M60 B40 (408S1))	Gasolina	RWD	3982	210	286	09.92-12.95	■
----------------------------	----------	-----	------	-----	-----	-------------	---

#### 5 Serie III Touring (E34) 07.91-07.96

#### Estate (Executive car-E Segment)

540 i (M60 B40 (408S1))	Gasolina	RWD	3982	210	286	09.93-07.96	■
-------------------------	----------	-----	------	-----	-----	-------------	---

#### 7 Serie II (E32) 03.85-10.94

#### Saloon (Luxury car-F Segment)

730 i, iL (M30 B30 (306KA))	Gasolina	RWD	2986	138	188	03.87-03.94	■
730 i, iL (M30 B30 (306EA))	Gasolina	RWD	2986	145	197	03.85-01.89	■
730 i, iL V8 (M60 B30 (308S1))	Gasolina	RWD	2997	160	218	04.92-09.94	■
735 i, iL (M30 B34 (346KB))	Gasolina	RWD	3430	155	211	06.86-07.92	■
735 i, iL (M30 B35 (MOTRONIC,9.2:1))	Gasolina	RWD	3430	162	220	07.86-01.89	■
740 i, iL V8 (M60 B40 (408S1))	Gasolina	RWD	3982	210	286	05.92-03.94	■
750 i, iL V12 (M70 B50 (5012A))	Gasolina	RWD	4988	220	300	09.87-09.94	■