

# LISTA DE APLICACIONES - BUYERS GUIDE

## 78BD2443-2



8 424073 143853

Weight: 9.220

O.E.M.	MAKE
42431-33010	TOYOTA
42431-33040	TOYOTA

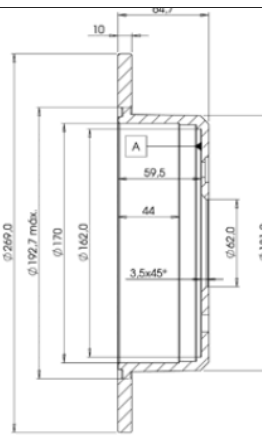
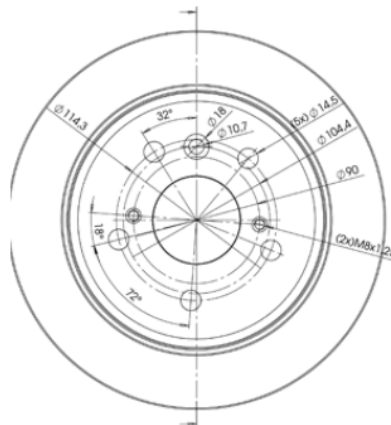

## 78BD2443-2



Ø269x10x64.7

MAKE
LEXUS
TOYOTA



Trac.	CC	Kw	CV		
					Front / Rear

### LEXUS

ES I-II (VCV10_, VZV21_) 09.89-12.97						Saloon (Executive car-E Segment)			
300 (VCV10_, VCV10R) (3VZ-FE)		Gasolina	FWD	2959		138	188	09.91-12.97	■

ES III-IV (MCV_, VZV_) 08.96-06.08						Saloon (Executive car-E Segment)			
3.0 (MCV30_, MCV20_, MCV20R) (1MZ-FE)		Gasolina	FWD	2995		140	190	10.96-07.01	■

### TOYOTA

CAMRY (_V1_) 09.91-07.96						Coupe (Executive car-E Segment)			
3.0 (MCV10_)		Gasolina	FWD	2995		140	190	09.91-07.96	■

CAMRY (_V2_) 08.96-09.02						Estate (Executive car-E Segment)			
2.2 (SXV20_, SXV20W, SXV20R)		Gasolina	FWD	2164		93	126	08.97-09.02	■

CAMRY (_V2_) 08.96-02.04						Saloon (Executive car-E Segment)			
2.2 (SXV20) (5S-FE)		Gasolina	FWD	2164		93	126	08.97-09.02	■
2.2 (SXV20_, SXV20) (5S-FE)		Gasolina	FWD	2164		96	131	08.96-11.01	■
3.0 (VDV10)		Gasolina	FWD	2959		140	190	08.96-07.01	■
3.0 V6 (MCV20_, MCV20R) (1MZ-FE)		Gasolina	FWD	2995		135	184	08.96-11.01	■
3.0 24V (MCV20_, MCV20, MCV10) (1MZ-FE)		Gasolina	FWD	2995		140	190	08.96-11.01	■

CAMRY / SCEPTER (_V1_) 06.91-08.97						Estate (Executive car-E Segment)			
2.2 (SDV10, SXV10)		Gasolina	FWD	2164		93	126	09.91-07.96	■
2.2 (SXV10_) (5S-FE)		Gasolina	FWD	2164		97	132	06.91-12.96	■

CAMRY / SCEPTER (_V1_) 07.90-10.01						Saloon (Executive car-E Segment)			
2.0 (SV32, SV33)		Gasolina	FWD	1998		121	165	07.90-06.94	■
2.2 (SDV10, SXV10)		Gasolina	FWD	2164		93	126	02.93-08.97	■
2.2 (SXV10_, SXV10R) (5S-FE)		Gasolina	FWD	2164		100	136	06.91-07.96	■

# LISTA DE APLICACIONES - BUYERS GUIDE

2.2 (SXV10_) (5S-FE)		Gasolina	FWD	2164	101	137	06.91-09.97	■
2.5 (VZV32_, VZV32R)		Gasolina	FWD	2497	129	175	06.91-07.94	■
3.0 (VCV10_, VCV10R) (3VZ-FE)		Gasolina	FWD	2959	138	188	06.91-08.96	■
3.0 (MCV10_, MCV10R) (1MZ-FE)		Gasolina	FWD	2995	135	183	09.93-07.96	■
3.0 (MCV10_)		Gasolina	FWD	2995	140	190	09.93-12.96	■
<b>MARK II (_X1_, _V2_) 11.83-07.01</b>					<b>Estate (Executive car-E Segment)</b>			
2.5 (MCV21) (2MZ-FE)		Gasolina	FWD	2497	147	200	08.96-07.01	■
<b>SCEPTER 11.92-09.96</b>					<b>Saloon (Executive car-E Segment)</b>			
2.2 (SXV10) (5S-FE)		Gasolina	FWD	2164	100	136	11.92-09.96	■
<b>SOLARA (_V2_) 03.98-12.03</b>					<b>Convertible (Executive car-E Segment)</b>			
3.0 (MCV20_, MCV20R) (1MZ-FE)		Gasolina	FWD	2995	140	190	02.00-11.02	■
3.3 (MCV31_, MCV31) (3MZ-FE)		Gasolina	FWD	3311	165	224	01.04-11.08	■
<b>SOLARA (_V2_) 06.98-12.03</b>					<b>Coupe (Executive car-E Segment)</b>			
2.4 (ACV30_, ACV30R) (2AZ-FE)		Gasolina	FWD	2362	117	159	07.03-11.08	■
3.0 (MCV20) (1MZ-FE)		Gasolina	FWD	2995	140	190	06.98-06.01	■
3.3 (MCV31_, MCV31) (3MZ-FE)		Gasolina	FWD	3311	165	224	07.03-07.08	■
<b>VISTA III-IV (_V3_, _V4_) 07.90-06.98</b>					<b>Saloon (Executive car-E Segment)</b>			
2.0 TD (CV30_, CV30) (2C-T)		Diesel	FWD	1974	67	91	07.90-12.94	■
<b>WINDOM II (_V1_) 07.91-09.96</b>					<b>Saloon (Executive car-E Segment)</b>			
2.5 (VCV11) (4VZ-FE)		Gasolina	FWD	2497	129	175	08.93-08.96	■
<b>WINDOM III (_V2_) 10.96-07.01</b>					<b>Saloon (Executive car-E Segment)</b>			
2.5 (MCV21) (2MZ-FE)		Gasolina	FWD	2496	147	200	10.96-07.01	■
3.0 (MCV20) (1MZ-FE)		Gasolina	FWD	2995	155	211	10.96-07.01	■