

# LISTA DE APLICACIONES - BUYERS GUIDE

## 78BD2500-2



Weight: 5.940

O.E.M.	MAKE
26 77 502 515	DACIA
26 77 509 150	DACIA
77 00 502 515	ARO
77 01 466 540	RENAULT

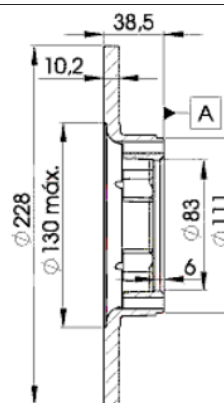
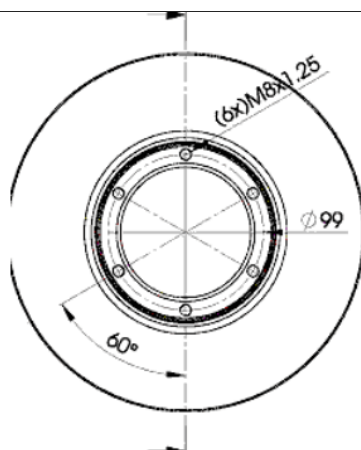

## 78BD2500-2

E1 90R-02C0415/0015



Ø228x10x38.5

MAKE
ARO
DACIA
RENAULT



Trac.	CC	Kw	CV
-------	----	----	----



Front / Rear

### ARO

#### 10-11 / Enduro 06.80-10.06

#### Closed Off-Road Vehicle (Off-Road SUV-J Segment)

1,3 (810-02)		Gasolina	4WD	1289	40	54	06.80-11.86	■
1,4 (IAP 810-R-99)		Gasolina	4WD	1397	46	63	06.84-10.99	■
1.6		Gasolina	4WD	1557	67	91	06.98-10.99	■
1.6 (HN)		Gasolina	4WD	1595	55	75	06.88-10.99	■
1.6 16V		Gasolina	4WD	1598	78	106	06.98-10.99	■
1.6 TD		Diesel	4WD	1588	51	70	08.88-10.99	■
1.6 TD		Diesel	4WD	1588	59	80	01.89-12.92	■
1.6 D (F8M 700)		Diesel	4WD	1596	40	54	09.86-10.99	■
1.9 D (F8QA6)		Diesel	4WD	1870	48	65	09.92-10.06	■
1.9 TD (F8QT)		Diesel	4WD	1870	69	94	06.97-10.06	■

#### 240-244 (24-32 Series) 04.78-12.06

#### Closed Off-Road Vehicle (Off-Road SUV-J Segment)

2.4 (2RZ-FE)		Gasolina	4WD	2438	103	140	01.99-12.06	■
2.5 (ARO L25)		Gasolina	4WD	2495	59	80	04.78-12.98	■
2.5 (ARO L25)		Gasolina	4WD	2495	60	82	01.80-12.98	■
2.5 (ARO L25)		Gasolina	4WD	2495	63	86	01.89-12.06	■
2.9 V6		Gasolina	4WD	2935	108	147	01.98-12.06	■
3.0 (ARO L30)		Gasolina	4WD	3007	70	95	01.92-12.06	■
3.0 (ARO L30)		Gasolina	4WD	3007	74	101	01.96-12.02	■
2.4 D (2L-T)		Diesel	4WD	2446	66	90	01.00-12.06	■
2.5 D (XD3P)		Diesel	4WD	2498	52	71	01.83-12.98	■
2.5 TD (XD3TP)		Diesel	4WD	2498	67	91	01.95-12.98	■
2.5 TD (XD3TP)		Diesel	4WD	2498	70	95	01.92-12.06	■

# LISTA DE APLICACIONES - BUYERS GUIDE

2.5 TD (VM-425HLT)		Diesel	4WD	2499	74	101	01.92-12.06	■
2.7 D		Diesel	4WD	2660	50	68	09.89-12.98	■
2.7 D (ARO L-27D)		Diesel	4WD	2660	52	71	04.85-12.98	■
2.7 D (ARO L-27D)		Diesel	4WD	2660	60	82	01.83-12.98	■
2.7 TD		Diesel	4WD	2660	64	87	04.85-12.06	■
3.1 D (ARO D-127)		Diesel	4WD	3119	47	64	01.80-12.83	■
<b>SPARTANA 01.97-10.06</b>					<b>Open Off-Road Vehicle (Off-Road SUV-J Segment)</b>			
1,2 AWD (C3G 702)		Gasolina	4WD	1239	40	54	01.97-12.03	■
1.2 (C3G 702)		Gasolina	RWD	1239	40	54	01.99-10.06	■
<b>DACIA</b>								
<b>1210 06.83-12.94</b>					<b>Saloon (Compact car-C Segment)</b>			
1.2 (103-00)		Gasolina	FWD	1185	36	49	06.83-12.94	■
<b>1300 12.72-05.83</b>					<b>Estate (Compact car-C Segment)</b>			
1.3 (810-02/-99)		Gasolina	FWD	1289	40	54	12.72-05.83	■
<b>1300 12.72-05.83</b>					<b>Saloon (Compact car-C Segment)</b>			
1.3 (810-02/-99)		Gasolina	FWD	1289	40	54	12.72-05.83	■
<b>1304 06.83-04.04</b>					<b>Pickup (LCVs-N1 Segment)</b>			
1.3 (810-02/-99)		Gasolina	FWD	1289	40	54	06.83-08.90	■
1.3	-01/93	Gasolina	FWD	1289	41	56	09.90-04.04	■
<b>1307 06.84-11.94</b>					<b>Platform/Chassis (LCVs-N1 Segment)</b>			
1.4	-01/93	Gasolina	FWD	1397	48	65	06.84-11.94	■
<b>1309 12.94-08.01</b>					<b>Pickup (LCVs-N1 Segment)</b>			
1.6		Gasolina	FWD	1557	53	72	12.94-08.01	■
<b>1309 09.90-11.94</b>					<b>Platform/Chassis (LCVs-N1 Segment)</b>			
1.4	-01/93	Gasolina	FWD	1397	48	65	09.90-11.94	■
<b>1310 05.83-07.04</b>					<b>Estate (Compact car-C Segment)</b>			
1.3 (810-02/-99)	-01/93	Gasolina	FWD	1289	40	54	05.83-07.04	■
1.4		Gasolina	FWD	1397	46	63	01.95-07.04	■
1.5		Gasolina	FWD	1557	46	63	01.95-07.04	■
<b>1310 (U, X) 05.83-07.04</b>					<b>Saloon (Compact car-C Segment)</b>			
1.3 (810-02/-99)	-01/93	Gasolina	FWD	1289	40	54	05.83-07.04	■
1.4 Classic		Gasolina	FWD	1397	46	63	01.95-07.04	■
1.4		Gasolina	FWD	1397	48	65	09.85-12.94	■
1.4		Gasolina	FWD	1397	50	68	06.00-07.04	■
1.5		Gasolina	FWD	1557	46	63	01.95-07.04	■
<b>1325 / LIBERTA 05.89-05.96</b>					<b>Hatchback (Compact car-C Segment)</b>			
1.3		Gasolina	FWD	1289	40	54	06.89-05.92	■
1.4		Gasolina	FWD	1397	48	65	05.89-05.96	■
1.6 D		Diesel	FWD	1588	51	69	07.94-05.96	■
<b>1410 09.85-12.98</b>					<b>Estate (Compact car-C Segment)</b>			
1.4 (102-00)	-01/93	Gasolina	FWD	1397	48	65	09.85-12.98	■
<b>1410 09.85-12.98</b>					<b>Saloon (Compact car-C Segment)</b>			
1.4 (102-00)	-01/93	Gasolina	FWD	1397	48	65	09.85-12.98	■
<b>DUSTER 03.84-12.93</b>					<b>Closed Off-Road Vehicle (Compact SUV-J Segment)</b>			
1.4 4WD		Gasolina	4WD	1397	48	65	03.84-12.93	■

# LISTA DE APLICACIONES - BUYERS GUIDE

1.6 D 4WD (F8M 700)		Diesel	4WD	1596	41	56	03.88-12.93	■
<b>RENAULT</b>								
<b>R 12 07.75-02.83</b>					<b>Estate Van (Compact car-C Segment)</b>			
1.3 (810.02)		Gasolina	FWD	1289	37	50	07.75-04.80	■
<b>R 12 (117_, 133_) 08.70-12.83</b>					<b>Estate (Compact car-C Segment)</b>			
1.3 (1170) (810.02)		Gasolina	FWD	1289	37	50	07.75-04.80	■
1.3 (1170) (810-02/97)		Gasolina	FWD	1289	40	54	10.70-08.80	■
1.3 (1337) (810.05)		Gasolina	FWD	1289	44	60	08.73-08.80	■
1.3 (1337) (810.06)		Gasolina	FWD	1289	44	60	08.73-08.80	■
1.6 (821.10)		Gasolina	FWD	1565	50	68	08.70-08.76	■
1.6 (821.11)		Gasolina	FWD	1565	50	68	08.70-08.76	■
1.6		Gasolina	FWD	1565	75	102	08.70-08.76	■
1.6		Gasolina	FWD	1565	83	113	08.70-07.75	■
<b>R 12 (117_) 10.69-12.84</b>					<b>Saloon (Compact car-C Segment)</b>			
1.3 (1170) (810.02)		Gasolina	FWD	1289	37	50	07.75-04.80	■
1.3 (1170) (810-02/97)		Gasolina	FWD	1289	40	54	10.69-08.80	■
1.3 TS (1177) (810.05)		Gasolina	FWD	1289	44	60	08.72-08.80	■
1.3 TS (1177) (810.06)		Gasolina	FWD	1289	44	60	08.72-08.80	■
1.4 (1179) (C1J 791)		Gasolina	FWD	1397	49	67	08.76-05.79	■
1.6 (821.10)		Gasolina	FWD	1565	50	68	08.70-08.76	■
1.6 (821.11)		Gasolina	FWD	1565	50	68	08.70-08.76	■
1.6 Gordini (1173) (807.20)		Gasolina	FWD	1565	83	113	08.70-12.74	■
1.6 Gordini (1173) (821.20)		Gasolina	FWD	1565	83	113	08.70-12.74	■
<b>R 15 (130_) 09.71-10.80</b>					<b>Coupe (Compact car-C Segment)</b>			
1.3 (1300) (810.05)	-09/77	Gasolina	FWD	1289	44	60	03.72-10.80	■
<b>R 17 03.72-10.80</b>					<b>Coupe (Compact car-C Segment)</b>			
1.6 (807.10)	-09/79	Gasolina	FWD	1565	66	90	03.72-10.80	■
1.6 Gordini (844.12)		Gasolina	FWD	1605	79	108	03.74-10.80	■
1.6 (843.05)		Gasolina	FWD	1647	68	92	06.74-08.79	■
<b>R 18 05.79-07.86</b>					<b>Estate Van (Large family car-D Segment)</b>			
1.4 (847 720)	-08/82	Gasolina	FWD	1397	47	64	05.79-07.86	■
1.4 (847 722)	-08/82	Gasolina	FWD	1397	47	64	05.79-07.86	■
<b>R 18 (134_) 04.78-11.94</b>					<b>Saloon (Large family car-D Segment)</b>			
1.4 (1340) (847 720)	-08/82	Gasolina	FWD	1397	47	64	04.78-07.86	■
1.4 (1340) (847 722)	-08/82	Gasolina	FWD	1397	47	64	04.78-07.86	■
1.6 (1341) (841 717)	-08/82	Gasolina	FWD	1647	54	73	04.82-07.86	■
1.6 (1341) (A2M 723)	-08/82	Gasolina	FWD	1647	54	73	04.82-07.86	■
1.6 (1341) (841 725)		Gasolina	FWD	1647	58	79	04.78-09.82	■
1.6 (1341) (841 726)		Gasolina	FWD	1647	58	79	04.78-09.82	■
1.6 TS (1342) (A6M 725)	-08/82	Gasolina	FWD	1647	71	97	05.82-07.86	■
1.6 TS (1342) (A6M 726)	-08/82	Gasolina	FWD	1647	71	97	05.82-07.86	■
<b>R 18 Variable (135_) 02.79-11.94</b>					<b>Estate (Large family car-D Segment)</b>			
1.4 (1350) (847 720)	-08/82	Gasolina	FWD	1397	47	64	05.79-07.86	■
1.4 (1350) (847 722)	-08/82	Gasolina	FWD	1397	47	64	05.79-07.86	■
1.6 (1351) (841 717)	-08/82	Gasolina	FWD	1647	54	73	01.82-07.86	■
1.6 (1351) (A2M 723)	-08/82	Gasolina	FWD	1647	54	73	01.82-07.86	■
1.6 (1351) (841 725)		Gasolina	FWD	1647	58	79	05.79-09.82	■
1.6 (1351) (841 726)		Gasolina	FWD	1647	58	79	05.79-09.82	■

# LISTA DE APLICACIONES - BUYERS GUIDE

1.6 4x4 (841 725)		Gasolina	4WD	1647	58	79	02.79-06.81	■
1.6 TS (A6M 725)	-08/82	Gasolina	FWD	1647	71	97	05.82-07.86	■
1.6 TS (A6M 726)	-08/82	Gasolina	FWD	1647	71	97	05.82-07.86	■
<b>R 4 (R21_, R23_) 09.66-12.93</b>					<b>Box Body/MPV (LCVs-N1 Segment)</b>			
0.8 (839 706)		Gasolina	FWD	782	19	26	09.71-08.82	■
0.8 (2391) (800 705)		Gasolina	FWD	845	21	29	04.83-07.89	■
0.8 (2391) (B1B 707)		Gasolina	FWD	845	21	29	04.83-07.89	■
0.8 (2106) (800 01)		Gasolina	FWD	845	25	34	09.66-12.88	■
1.0 (C1C 708)		Gasolina	FWD	956	25	34	06.87-12.93	■
1.1 (2370, 210B) (688 711)		Gasolina	FWD	1108	25	34	10.76-07.89	■
1.1 (2370, 210B) (688 712)		Gasolina	FWD	1108	25	34	10.76-07.89	■
1.1 (2370, 210B) (C1E 714)		Gasolina	FWD	1108	25	34	10.76-07.89	■
1.1 (2370, 210B) (C1E 718)		Gasolina	FWD	1108	25	34	10.76-07.89	■
1.1 (2370, 210B) (C1E 719)		Gasolina	FWD	1108	25	34	10.76-07.89	■
1.1 (239B) (C1E 718)		Gasolina	FWD	1108	26	35	07.82-05.89	■
1.1 (239B) (C1E 719)		Gasolina	FWD	1108	26	35	07.82-05.89	■
<b>R 4 (112_) 04.62-12.93</b>					<b>Hatchback (Supermini car-B Segment)</b>			
0.7 (680.702)		Gasolina	FWD	746	15	20	04.62-04.71	■
0.8 (1123) (800)		Gasolina	FWD	845	19	26	10.62-09.83	■
0.8 (1123) (800 705)		Gasolina	FWD	845	19	26	10.62-09.83	■
0.8 (1123) (800 705)		Gasolina	FWD	845	21	29	10.83-10.88	■
0.8 (1123) (B1B 707)		Gasolina	FWD	845	21	29	10.83-10.88	■
0.8 (1123) (800 01)		Gasolina	FWD	845	25	34	09.71-12.88	■
1.0 (112C) (C1C 708)		Gasolina	FWD	956	25	34	06.87-06.93	■
1.0 (689 710)		Gasolina	FWD	956	31	42	12.85-06.93	■
1.1 (1128, S128) (688 712)		Gasolina	FWD	1108	25	34	06.78-06.90	■
1.1 (1128, S128) (C1E 714)		Gasolina	FWD	1108	25	34	06.78-06.90	■
1.1 (1128, S128) (C1E 719)		Gasolina	FWD	1108	25	34	06.78-06.90	■
1.1 (C1E 714)		Gasolina	FWD	1108	32	44	06.86-06.90	■
1.1 (688 712)		Gasolina	FWD	1108	33	45	02.78-03.84	■
<b>R 5 (238_) 01.72-12.85</b>					<b>Hatchback Van (LCVs-N1 Segment)</b>			
0.8 (2381) (800 710)		Gasolina	FWD	845	26	35	10.72-08.84	■
1.0 (2382) (689 710)		Gasolina	FWD	956	32	44	01.72-12.85	■
1.1 (688 713)		Gasolina	FWD	1108	33	45	09.80-12.85	■
1.1 (C1E 726)		Gasolina	FWD	1108	33	45	09.80-12.85	■
1.1 (C1E 750)		Gasolina	FWD	1108	33	45	09.80-12.85	■
1.1 (C1E 752)		Gasolina	FWD	1108	33	45	09.80-12.85	■
1.1 (C1E 754)		Gasolina	FWD	1108	33	45	09.80-12.85	■
1.3 (2387) (810 726)		Gasolina	FWD	1289	32	44	03.76-08.82	■
<b>R 5 / LE CAR (122_) 01.72-12.85</b>					<b>Hatchback (Supermini car-B Segment)</b>			
0.8 (1221, 1391, 1220) (800 710)		Gasolina	FWD	845	26	35	10.72-08.84	■
0.8 (1221, 1391) (800 710)		Gasolina	FWD	845	27	37	01.82-12.84	■
1.0 (1222, 1392) (689 710)		Gasolina	FWD	956	32	44	01.72-12.85	■
1.1 (1227, 1397) (688 713)		Gasolina	FWD	1108	33	45	09.80-12.85	■
1.1 (1227, 1397) (C1E 726)		Gasolina	FWD	1108	33	45	09.80-12.85	■
1.3 (1225) (810 726)		Gasolina	FWD	1289	31	42	09.76-09.79	■
1.3 (1225, 1395) (810 719)		Gasolina	FWD	1289	33	45	06.79-09.84	■
1.3 Automatik (1225, 1395) (810 729)		Gasolina	FWD	1289	40	54	06.79-09.84	■
1.3 (1224, 1394) (810 725)		Gasolina	FWD	1289	47	64	09.75-09.84	■

# LISTA DE APLICACIONES - BUYERS GUIDE

1.4 Automatik (1229, 1399) (847 712)	Gasolina	FWD	1397	43	59	06.82-09.84	■
1.4 (1229, 1399) (847 725)	Gasolina	FWD	1397	46	63	01.82-12.85	■
1.4 (1229, 1399) (C2J 713)	Gasolina	FWD	1397	46	63	01.82-12.85	■
1.4 Alpine A5 (1223) (840 725)	Gasolina	FWD	1397	68	93	09.77-09.81	■
1.4 Alpine Turbo (122B) (840 726)	Gasolina	FWD	1397	79	108	10.81-01.85	■
1.4 Alpine Turbo (122B) (C6J 750)	Gasolina	FWD	1397	79	108	10.81-01.85	■
1.4 (C6J 750)	Gasolina	FWD	1397	81	110	06.84-01.85	■
1.4 (840 730)	Gasolina	RWD	1397	118	160	09.80-03.85	■
1.4 Turbo (8220) (840 730)	Gasolina	RWD	1397	118	160	06.80-01.85	■
<b>R 6 (118_) 10.69-04.87</b>				<b>Hatchback (Compact car-C Segment)</b>			
0.8 (800.02)	Gasolina	FWD	845	25	34	10.69-04.80	■
1.1 (688.10)	Gasolina	FWD	1108	33	45	08.70-04.87	■
1.1 (688.10)	Gasolina	FWD	1108	35	48	07.71-04.80	■
<b>RODEO 6 (ACL_) 05.70-11.81</b>				<b>Convertible (Off-Road SUV-J Segment)</b>			
1.1 (688.10)	Gasolina	FWD	1108	35	48	08.73-11.81	■