

# LISTA DE APLICACIONES - BUYERS GUIDE

## 78BD2510-2



8 424073 143891

Weight: 6.876

O.E.M.	MAKE
42510-SMG-E20	HONDA
42510-SNA-A00	HONDA
42510-SNA-A01	HONDA
42510-SNE-A00	HONDA

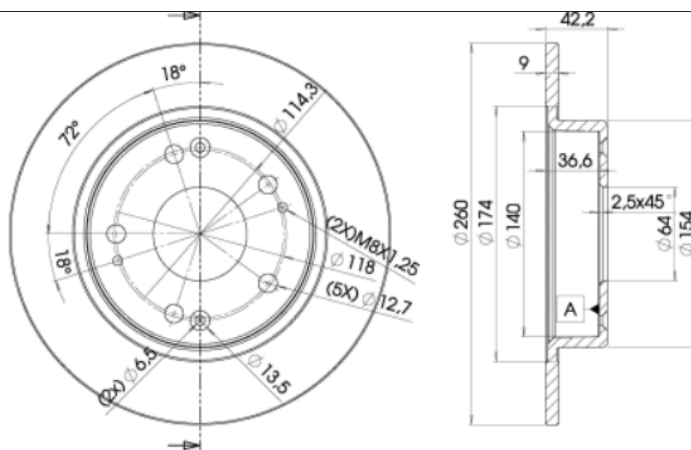

## 78BD2510-2

E1 90R-02C0415/0020



Ø260x9x42.2

MAKE
ACURA
GREAT WALL
HONDA



Trac.	CC	Kw	CV
-------	----	----	----



Front / Rear

### ACURA

ILX 09.12-					Saloon (Compact car-C Segment)			
2.0	Gasolina	FWD	1997	112	152	09.12-	■	
2.4 (K24Z7)	Gasolina	FWD	2354	150	204	09.12-12.15		
1.5 Hybrid	Gasol./el éc.	FWD	1497	68	92	11.12-		

### GREAT WALL

C50 11.11-				Saloon ()			
1.5 Turbo (GW4G15T)	Gasolina	FWD	1497	98	133	11.11-	■

### HONDA

CIVIC IX 01.12-					Coupe (Compact car-C Segment)			
1.8		Gasolina	FWD	1798	104	141	01.12-	■
2.4		Gasolina	FWD	2354	138	188	09.14-	
2.4		Gasolina	FWD	2354	150	204	01.12-	
2.4		Gasolina	FWD	2354	152	206	11.14-12.15	
CIVIC IX (FB) 09.11-					Saloon (Compact car-C Segment)			
1.6 (FB7, FB1) (R16B1)		Gasolina	FWD	1597	92	125	09.11-12.16	■
1.6 (FB7, FB1) (R16B2)		Gasolina	FWD	1597	92	125	09.11-12.16	
1.8 (FB2) (R18Z1)		Gasolina	FWD	1798	104	141	02.12-12.16	
1.8 (FB2) (R18Z4)		Gasolina	FWD	1798	104	141	02.12-12.16	
1.8 (FB2) (R18A1)		Gasolina	FWD	1799	104	141	09.11-12.16	
1.5 IMA (FB4)		Gasol./el éc.	FWD	1497	67	91	02.14-12.16	

# LISTA DE APLICACIONES - BUYERS GUIDE

CIVIC VII (ES, ET) 10.00-04.06					Saloon (Compact car-C Segment)			
1.8		Gasolina	FWD	1799	103	140	02.01-09.05	■
CIVIC VIII (FN, FK) 09.05-					Hatchback (Compact car-C Segment)			
1.4 (FK1) (L13A7)		Gasolina	FWD	1339	61	83	09.05-09.08	■
1.4 (FK1, FN4) (L13Z1)		Gasolina	FWD	1339	73	100	10.08-12.11	■
1.8 (FN1, FK2) (R18A2)		Gasolina	FWD	1799	103	140	09.05-12.11	■
Type R (FN2) (K20Z4)		Gasolina	FWD	1998	148	201	09.06-01.12	■
2.0 i-VTEC Type R (FN2)		Gasolina	FWD	1998	177	241	03.10-12.10	■
2.2 CTDi (FK3) (N22A2)		Diesel	FWD	2204	103	140	09.05-12.11	■
CIVIC VIII / BALLADE (FD, FA) 09.05-					Saloon (Compact car-C Segment)			
1.3 (FD3) (L13A6)		Gasolina	FWD	1339	85	116	02.06-12.12	■
1.6 (FD6) (R16A1)		Gasolina	FWD	1595	84	114	09.05-12.12	■
1.6 (R16A1)		Gasolina	FWD	1595	92	125	09.05-12.12	■
1.6 (R16B1)		Gasolina	FWD	1597	92	125	01.12-12.12	■
1.8		Gasolina	FWD	1799	97	132	01.06-12.13	■
1.8 (FD1, FD7, FA1) (R18A1)		Gasolina	FWD	1799	103	140	09.05-02.12	■
1.8 (FD1, FD7, FA1) (R18A2)		Gasolina	FWD	1799	103	140	09.05-02.12	■
2.0 i-VTEC Type R (FD2) (K20A5)		Gasolina	FWD	1998	165	224	08.07-09.10	■
1.8 EXS Flex (R18A1)		Gasol./Etanol	FWD	1799	103	140	11.06-05.13	■
1.3 IMA (FA3, FD3) (LDA2)		Gasol./eléc.	FWD	1339	70	95	01.06-12.12	■
1.3 IMA (FD3) (LDA2)		Gasol./eléc.	FWD	1339	85	116	01.10-02.12	■