

LISTA DE APLICACIONES - BUYERS GUIDE

78BD2550-2



Weight: 10.064

O.E.M.	MAKE
43512-02040	TOYOTA
43512-12550	TOYOTA
9485 3004	CHEVROLET
9485 4148	CHEVROLET

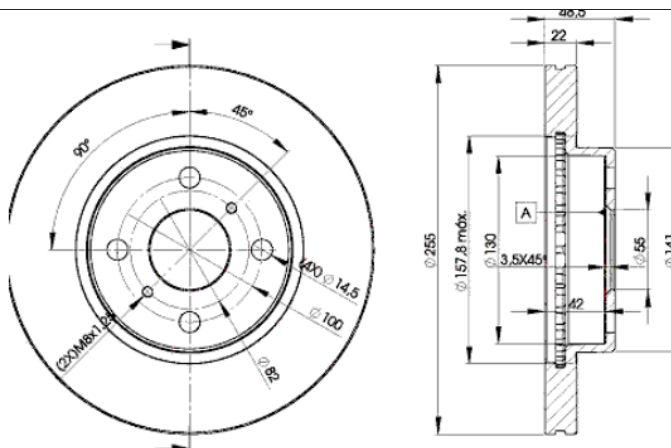

78BD2550-2

E1 90R-02C0452/0077



Ø255x22x48.2

MAKE
GREAT WALL
TOYOTA



Trac.	CC	Kw	CV		
					Front / Rear

GREAT WALL

TENGYI C20R / VOLEEX C20R 09.11-

Hatchback ()

1.5 (GW4G15)	Gasolina	FWD	1497	78	106	09.11-	■
--------------	----------	-----	------	----	-----	--------	---

TENGYI C30 / VOLEEX C30 05.10-

Saloon ()

1.5 (GW4G15)	Gasolina	FWD	1497	77	105	05.10-12.11	■
--------------	----------	-----	------	----	-----	-------------	---

TOYOTA

COROLLA IX (_E12_) 03.01-12.08

Estate (Compact executive car-D Segment)

2.0 D-4D (CDE120_, CDE120R) (1CD-FTV)	Diesel	FWD	1995	66	90	01.02-02.07	■
---------------------------------------	--------	-----	------	----	----	-------------	---

COROLLA VI (_E9_) 05.87-04.97

Hatchback (Compact executive car-D Segment)

1.6 EFi (AE92, AE93) (4A-GE)	Gasolina	FWD	1587	85	116	05.92-04.97	■
------------------------------	----------	-----	------	----	-----	-------------	---

COROLLA VII (_E10_) 09.91-04.98

Estate (Compact executive car-D Segment)

1.3 12V (EE100_, EE100R) (2E)	Gasolina	FWD	1296	53	72	07.92-05.95	■
1.3 XLI (EE101_, EE101R) (4E-FE)	Gasolina	FWD	1332	55	75	09.95-04.97	■
1.3 XLI 16V (EE101_, EE101R) (4E-FE)	Gasolina	FWD	1332	65	88	07.92-09.95	■
1.6	Gasolina	FWD	1587	76	103	07.92-07.95	■
1.6 Si (AE101_, AE101R) (4A-FE)	Gasolina	FWD	1587	84	114	07.92-04.97	■
1.8 (AE103) (7A-FE)	Gasolina	FWD	1762	81	110	09.92-04.97	■
1.8 16V 4WD (AE103_, AE103) (7A-FE)	Gasolina	4WD	1762	81	110	09.95-04.97	■
1.8 XL	Gasolina	FWD	1762	88	120	09.92-11.93	■
1.8 XL 4WD	Gasolina	4WD	1762	88	120	09.92-11.93	■
1.8	Gasolina	FWD	1838	92	125	08.95-04.97	■
2.0 D (CE100_, CE100R) (2C)	Diesel	FWD	1974	53	72	07.92-04.97	■

LISTA DE APLICACIONES - BUYERS GUIDE

COROLLA VII (_E10_) 05.92-12.99					Hatchback (Compact executive car-D Segment)			
1.3 12V (EE100_, EE100R) (2E)		Gasolina	FWD	1296	53	72	07.92-05.95	■
1.3 XLI (EE101_, EE101R) (4E-FE)		Gasolina	FWD	1332	65	88	07.92-04.97	■
1.6 GLI (AE101_, AE101R) (4A-FE)		Gasolina	FWD	1587	84	114	07.92-04.97	■
1.8 GT (AE102_, AE102R) (7A-FE)		Gasolina	FWD	1762	86	117	11.92-05.95	■
1.8 GTI		Gasolina	FWD	1762	92	125	05.92-07.95	■
2.0 D (CE100_, CE100R) (2C)		Diesel	FWD	1974	53	72	07.92-04.97	■
COROLLA VII (_E10_) 06.91-11.99					Saloon (Compact executive car-D Segment)			
1.3 12V (EE100_, EE100R) (2E)		Gasolina	FWD	1296	53	72	07.92-04.97	■
1.3 XLI (EE101_, EE101R) (4E-FE)		Gasolina	FWD	1332	55	75	09.95-04.97	■
1.3 XLI 16V (EE101) (4E-FE)		Gasolina	FWD	1332	65	88	07.92-09.95	■
1.6 (AE101)		Gasolina	FWD	1587	70	95	06.92-02.98	■
1.6 (AE101) (4A-FE)		Gasolina	FWD	1587	76	103	09.91-07.95	■
1.6 Si (AE101_, AE101R) (4A-FE)		Gasolina	FWD	1587	84	114	09.95-04.97	■
1.6 (AE101_, AE101R) (4A-FE)		Gasolina	FWD	1587	85	115	05.92-04.97	■
1.8 i (AE102) (7A-FE)		Gasolina	FWD	1762	85	116	11.92-04.97	■
1.8 4WD		Gasolina	4WD	1762	88	120	05.92-07.95	■
2.0 D (CE100_, CE100R) (2C)		Diesel	FWD	1974	53	72	07.92-04.97	■
COROLLA VII Compact / COROLLA SECCA (_E10_) 05.92-12.99					Hatchback (Compact executive car-D Segment)			
1.3 XLI (EE101_, EE101R) (4E-FE)		Gasolina	FWD	1332	55	75	08.95-04.97	■
1.3 XLI 16V (EE101) (4E-FE)		Gasolina	FWD	1332	65	88	07.92-09.95	■
1.6 i (AE101) (4A-FE)		Gasolina	FWD	1587	78	106	09.94-11.99	■
1.6 Si (AE101_, AE101R) (4A-FE)		Gasolina	FWD	1587	84	114	07.92-04.97	■
1.8 GT (AE102_, AE102R) (7A-FE)		Gasolina	FWD	1762	86	117	11.92-05.95	■
1.8 GTi 4WD (AE103) (7A-FE)		Gasolina	4WD	1762	92	125	05.92-07.95	■
2.0 D (CE100_, CE100R) (2C)		Diesel	FWD	1974	53	72	07.92-04.97	■
COROLLA VIII (_E11_) 09.00-10.01					Estate Van (LCVs-N1 Segment)			
2.0 D4d (CDE110) (1CD-FTV)	vehicles without ABS	Diesel	FWD	1995	66	90	09.00-10.01	■
COROLLA VIII (_E11_) 04.97-10.01					Estate (Compact executive car-D Segment)			
1.4 (EE111_, EE111R) (4E-FE)	09/99-, -09/99, vehicles without ABS	Gasolina	FWD	1332	63	86	04.97-02.00	■
1.4 16V (ZZE111_, ZZE111R) (4ZZ-FE)	vehicles without ABS	Gasolina	FWD	1398	71	97	02.00-10.01	■
1.6 Aut. (AE111_, AE111R) (4A-FE)	09/99-, -09/99, vehicles without ABS	Gasolina	FWD	1587	79	107	04.97-02.00	■
1.6 (AE111_, AE111R) (4A-FE)	09/99-, -09/99, vehicles without ABS	Gasolina	FWD	1587	81	110	04.97-02.00	■
1.6 16V (ZZE112_, ZZE112R) (3ZZ-FE)	vehicles without ABS	Gasolina	FWD	1598	81	110	02.00-10.01	■
1.8 (7A-FE)	09/99-, -09/99, vehicles without ABS	Gasolina	FWD	1762	81	110	10.97-10.01	■
1.8 4WD (AE115_, AE115R) (7A-FE)	09/99-, -09/99, vehicles without ABS	Gasolina	4WD	1762	81	110	04.97-10.01	■
1.8		Gasolina	FWD	1838	92	125	05.97-08.01	■
1.9 D (WZE110_, WZE110R) (1WZ)	vehicles without ABS	Diesel	FWD	1867	51	69	02.00-10.01	■
2.0 D (CE110_, CE110R) (2C-E)	09/99-, -09/99, vehicles without ABS	Diesel	FWD	1975	53	72	04.97-02.00	■
2.0 D-4D (CDE110_, CDE110R) (1CD-FTV)	vehicles without ABS	Diesel	FWD	1995	66	90	09.00-10.01	■
2.0 D4d GS		Diesel	RWD	1995	81	110	08.00-10.01	■
COROLLA VIII (_E11_) 04.97-01.02					Hatchback (Compact executive car-D Segment)			
1.4 (EE111_, EE111R) (4E-FE)	vehicles without ABS	Gasolina	FWD	1332	63	86	05.97-09.99	■
1.4 (ZZE111_, ZZE111R) (4ZZ-FE)	vehicles without ABS	Gasolina	FWD	1398	71	97	10.99-01.02	■
1.6 Aut. (AE111_) (4A-FE)	09/99-, -09/99, vehicles without ABS	Gasolina	FWD	1587	79	107	05.97-02.00	■

LISTA DE APLICACIONES - BUYERS GUIDE

1.6 (AE111_, AE111R) (4A-FE)	09/99-, -09/99, vehicles without ABS	Gasolina	FWD	1587	81	110	05.97-08.01	■
1.6 (ZZE112_, ZZE112R) (3ZZ-FE)	vehicles without ABS	Gasolina	FWD	1598	81	110	02.00-01.02	■
1.8 (AE112)	09/99-, -09/99, vehicles without ABS	Gasolina	FWD	1762	85	116	09.98-11.01	■
1.9 D (WZE110_, WZE110R) (1WZ)		Diesel	FWD	1867	51	69	02.00-01.02	■
2.0 D (CE110) (2C-E)	05/99-, -05/99, vehicles without ABS	Diesel	FWD	1975	53	72	04.97-02.00	■
2.0 D-4D (CDE110_, CDE110R) (1CD-FTV)	vehicles without ABS	Diesel	FWD	1995	66	90	09.00-01.02	■
COROLLA VIII (_E11_) 05.95-02.03					Saloon (Compact executive car-D Segment)			
1.3 (EE111_) (4E-FE)		Gasolina	FWD	1332	63	86	05.97-09.99	■
1.4 (EE111_, EE111R) (4E-FE)	vehicles without ABS	Gasolina	FWD	1332	63	86	05.97-09.99	■
1.4 16V (ZZE111_, ZZE111R) (4ZZ-FE)	vehicles without ABS	Gasolina	FWD	1398	71	97	02.00-11.01	■
1.5		Gasolina	FWD	1497	78	106	09.99-10.01	■
1.6 Aut. (AE111_, AE111R) (4A-FE)	05/99-, -09/99, vehicles without ABS	Gasolina	FWD	1587	79	107	04.97-02.00	■
1.6	05/99-, -09/99, vehicles without ABS	Gasolina	FWD	1587	81	110	04.97-02.00	■
1.6 (AE111) (4A-FE)		Gasolina	FWD	1587	81	110	05.95-02.00	■
1.6 i 20V (AE111)		Gasolina	FWD	1587	115	156	08.98-08.00	■
1.6 16V (ZZE112_, ZZE112R)	vehicles without ABS	Gasolina	FWD	1598	81	110	08.99-12.01	■
1.6 16V (ZZE112_, ZZE112R) (3ZZ-FE)	vehicles without ABS	Gasolina	FWD	1598	81	110	08.99-12.01	■
1.8 (AE112_) (7A-FE)	09/99-, -09/99, vehicles without ABS	Gasolina	FWD	1762	81	110	10.97-10.01	■
1.8 (AE112) (7A-FE)	09/99-, -09/99, vehicles without ABS	Gasolina	FWD	1762	85	116	04.97-06.02	■
1.8 (ZZE110) (1ZZ-FE)		Gasolina	FWD	1794	93	126	09.99-06.02	■
1.9 D (WZE110_, WZE110R) (1WZ)	vehicles without ABS	Diesel	FWD	1867	51	69	02.00-11.01	■
2.0 D (CE110_, CE110R) (2C-E)	09/99-, -09/99, vehicles without ABS	Diesel	FWD	1975	53	72	04.97-02.00	■
2.0 D-4D (CDE110_, CDE110R) (1CD-FTV)	vehicles without ABS	Diesel	FWD	1995	66	90	09.00-11.01	■
2.0 D-4D		Diesel	RWD	1995	81	110	08.00-10.01	■
2.2 TD	09/99-, -09/99, vehicles without ABS	Diesel	RWD	2184	66	90	04.98-10.01	■
COROLLA VIII Compact (_E11_) 04.97-01.02					Hatchback (Compact executive car-D Segment)			
1.4 (EE111_, EE111R) (4E-FE)	vehicles without ABS	Gasolina	FWD	1332	63	86	05.97-09.99	■
1.4 (ZZE111_, ZZE111R) (4ZZ-FE)	vehicles without ABS	Gasolina	FWD	1398	71	97	10.99-01.02	■
1.5		Gasolina	FWD	1497	78	106	09.99-10.01	■
1.6 Aut. (AE111_, AE111R) (4A-FE)	09/99-, -09/99, vehicles without ABS	Gasolina	FWD	1587	79	107	05.97-02.00	■
1.6 (AE111_) (4A-FE)	09/99-, -09/99, vehicles without ABS	Gasolina	FWD	1587	81	110	05.97-02.00	■
1.6 (ZZE112_, ZZE112R) (3ZZ-FE)	vehicles without ABS	Gasolina	FWD	1598	81	110	10.99-10.01	■
1.9 D (WZE110_, WZE110R) (1WZ)		Diesel	FWD	1867	51	69	02.00-01.02	■
2.0 D (CE110_, CE110R) (2C-E)		Diesel	FWD	1975	53	72	04.97-02.00	■
2.0 D-4D (CDE110_, CDE110R) (1CD-FTV)	vehicles without ABS	Diesel	FWD	1995	66	90	09.00-01.02	■
2.0 D-4D		Diesel	RWD	1995	81	110	08.00-10.01	■
2.2 TD	vehicles without ABS	Diesel	RWD	2184	66	90	04.98-10.01	■