

# LISTA DE APLICACIONES - BUYERS GUIDE

## 78BD2890-2



Weight: 12.004

O.E.M.	MAKE
43512-12670	TOYOTA

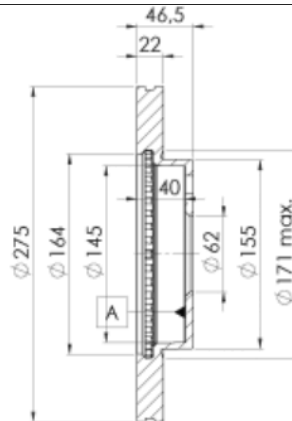
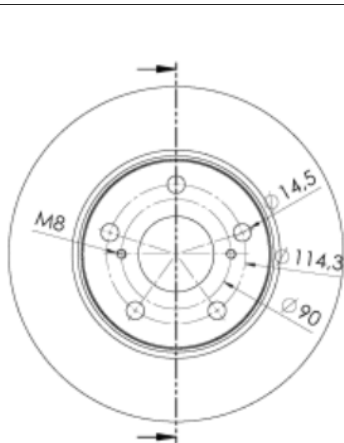

## 78BD2890-2

E1 90R-02C0452/0086



Ø275x22x46.5

MAKE
TOYOTA
TOYOTA (FAW)
TOYOTA (GAC)



Trac.	CC	Kw	CV	
				Front / Rear

### TOYOTA

#### AURIS ( \_E15\_ ) 03.07-09.12

#### Hatchback Van (LCVs-N1 Segment)

1.4 D-4D (NDE150_ (1ND-TV)	Japan	Diesel	FWD	1364	66	90	03.07-09.12	■
----------------------------	-------	--------	-----	------	----	----	-------------	---

#### AURIS / BLADE ( \_E15\_ ) 10.06-09.12

#### Hatchback (Compact car-C Segment)

1.33 Dual-VVTi (NRE150_, NRE150R) (1NR-FE)	Japan	Gasolina	FWD	1329	73	99	01.10-09.12	■
1.33 Dual-VVTi (NRE150_, NRE150R) (1NR-FE)	Japan	Gasolina	FWD	1329	74	101	05.09-09.12	■
1.4 (ZZE150_, ZZE150R) (4ZZ-FE)	Japan	Gasolina	FWD	1398	71	97	03.07-09.12	■
1.6 (ZRE151_, ZRE151R) (1ZR-FE)	Japan	Gasolina	FWD	1598	91	124	03.07-09.12	■
1.6 (ZRE151_, ZRE151R) (1ZR-FAE)	Japan	Gasolina	FWD	1598	97	132	05.09-09.12	■
1.8 (ZRE152_, ZRE152) (2ZR-FAE)	Japan	Gasolina	FWD	1798	108	147	02.09-09.12	■
1.4 D-4D (NDE150_, NDE150R) (1ND-TV)	Japan	Diesel	FWD	1364	66	90	03.07-09.12	■

#### COROLLA IX / ALTIS / AXIO-ALTIS ( \_E12\_ ) 08.00-12.08

#### Saloon (Compact executive car-D Segment)

1.6		Gasolina	FWD	1598	91	124	11.06-07.07	■
-----	--	----------	-----	------	----	-----	-------------	---

#### COROLLA X / ALTIS ( \_E15\_, \_E14\_ ) 10.06-

#### Saloon (Compact executive car-D Segment)

1.3 (NRE150) (1NR-FE)		Gasolina	FWD	1329	74	101	12.08-07.14	■
1.6 Dual VVTi (ZRE141, ZRE151) (1ZR-FE)		Gasolina	FWD	1598	91	124	01.07-07.14	■
1.6 (ZRE151) (1ZR-FAE)		Gasolina	FWD	1598	97	132	11.06-11.13	■
1.6 (ZRE151) (1ZR-FE)		Gasolina	FWD	1598	97	132	11.06-11.13	■
1.6 VVTi (ZRE151) (1ZR-FE)		Gasolina	FWD	1598	100	136	03.07-12.10	■
1.8 (ZRE142, ZRE152) (2ZR-FE)		Gasolina	FWD	1798	100	136	10.06-07.14	■

#### COROLLA XI / COROLLA ALTIS ( \_E18\_, ZRE1\_ ) 06.13-

#### Saloon (Compact executive car-D Segment)

1.6 (ZRE171) (1ZR-FE)		Gasolina	FWD	1598	89	121	10.13-12.18	■
-----------------------	--	----------	-----	------	----	-----	-------------	---

# LISTA DE APLICACIONES - BUYERS GUIDE

1.6 (ZRE171, ZRE181) (1ZR-FE)	Gasolina	FWD	1598	90	122	06.13-12.18	■
1.6 (ZRE181_) (1ZR-FAE)	Gasolina	FWD	1598	97	132	06.13-12.18	■
1.8 VVTi (ZRE172_)	Gasolina	FWD	1798	98	133	06.13-05.19	■
1.8 VVTi (ZRE172, ZRE182) (2ZR-FBE)	Gasolina	FWD	1798	103	140	06.13-08.19	■
1.8 VVTi (ZRE172, ZRE182) (2ZR-FE)	Gasolina	FWD	1798	103	140	06.13-08.19	■
1.8 VVTi	Gasolina	FWD	1798	104	141	09.13-	■
<b>TOYOTA (FAW)</b>							
<b>COROLLA (_E15_) 05.07-12.14</b>					<b>Saloon (Compact executive car-D Segment)</b>		
1.8 (ZRE152)	Gasolina	FWD	1798	103	140	10.10-12.14	■
1.8 (ZRE182)	Gasolina	FWD	1798	103	140	06.14-	■
<b>TOYOTA (GAC)</b>							
<b>LEVIN (ZRE18_, ZWE18_) 10.15-</b>					<b>Saloon (Supermini car-B Segment)</b>		
1.8 (ZRE182)	Gasolina	FWD	1798	103	140	07.14-	■