

LISTA DE APLICACIONES - BUYERS GUIDE

78BD2892-2



8 424073 144201

Weight: 13.000

O.E.M.	MAKE
34 11 6 768 933	MINI

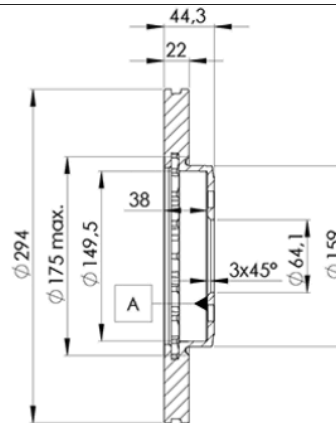
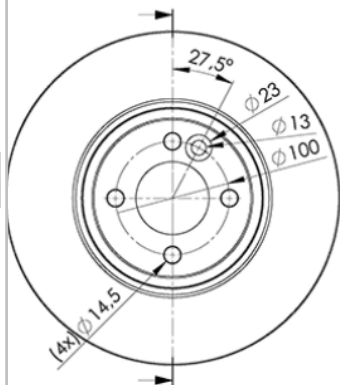

78BD2892-2



Ø294x22x44.3

MAKE

MINI



Trac.	CC	Kw	CV
-------	----	----	----



Front / Rear

MINI

MINI (R52) 04.04-07.08

Convertible (Supermini car-B Segment)

Cooper (N12 B16 A)		Gasolina	FWD	1598	88	120	12.08-07.10	■
Cooper S (W11 B16 A)	11/06-	Gasolina	FWD	1598	125	170	07.04-07.08	■
John Cooper Works (W11 B16 A)	-07/06	Gasolina	FWD	1598	155	210	07.04-11.07	■

MINI (R50, R53) 06.01-09.06

Hatchback (Supermini car-B Segment)

One (N12 B14 A)		Gasolina	FWD	1397	55	75	03.09-03.10	■
One (N12 B14 A)		Gasolina	FWD	1397	70	95	11.06-03.10	■
Cooper (N12 B16 A)		Gasolina	FWD	1598	88	120	10.06-02.12	■
Cooper (N16 B16 A)		Gasolina	FWD	1598	88	120	10.06-02.12	■
Cooper S (W11 B16 A)	Eq.V_ JCW Kit	Gasolina	FWD	1598	125	170	07.04-09.06	■
Cooper S (N14 B16 A)		Gasolina	FWD	1598	128	174	10.06-02.10	■
Cooper S (N14 B16 AB)		Gasolina	FWD	1598	128	174	10.06-02.10	■
Works (W11 B16 A)	-07/06	Gasolina	FWD	1598	155	210	11.03-09.06	■
John Cooper Works (W11 B16 A)	-07/06	Gasolina	FWD	1598	160	218	03.06-09.06	■
Cooper D (9HZ (DV6TED4))		Diesel	FWD	1560	80	109	11.06-09.10	■
Cooper D (W16 D16 (9HZ))		Diesel	FWD	1560	80	109	11.06-09.10	■

MINI CLUBMAN (R55) 10.06-12.15

Estate (Supermini car-B Segment)

Cooper (N12 B16 A)		Gasolina	FWD	1598	88	120	10.07-12.13	■
Cooper (N16 B16 A)		Gasolina	FWD	1598	88	120	10.07-12.13	■
Cooper S (N14 B16 A)		Gasolina	FWD	1598	120	163	10.07-06.14	■
Cooper S (N14 B16 AB)		Gasolina	FWD	1598	120	163	10.07-06.14	■
Cooper S (N18 B16 A)		Gasolina	FWD	1598	120	163	10.07-06.14	■
Cooper S (N14 B16 A)		Gasolina	FWD	1598	128	174	08.07-07.10	■

LISTA DE APLICACIONES - BUYERS GUIDE

Cooper S (N14 B16 AB)	Gasolina	FWD	1598	128	174	08.07-07.10	■
John Cooper Works (N14 B16 C)	Gasolina	FWD	1598	155	211	11.07-06.14	■
John Cooper Works (N18 B16 C)	Gasolina	FWD	1598	155	211	11.07-06.14	■
Cooper D (9HZ (DV6TED4))	Diesel	FWD	1560	80	109	10.07-02.10	■