

LISTA DE APLICACIONES - BUYERS GUIDE

78BD2918-2



Weight: 18.572

O.E.M.	MAKE
43512-60150	TOYOTA
43512-60151	TOYOTA

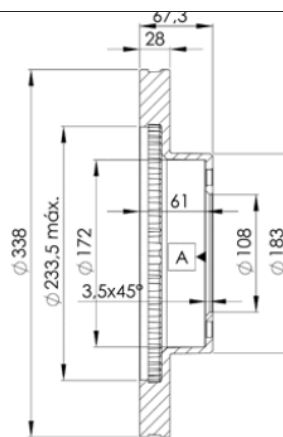
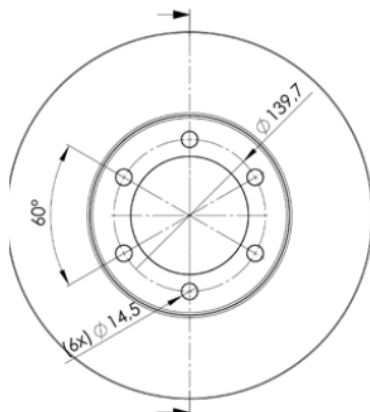

78BD2918-2



Ø338x28x67.3

MAKE
LEXUS
TOYOTA
TOYOTA (FAW)



Trac.	CC	Kw	CV
-------	----	----	----



Front / Rear

LEXUS

GX (_J12_) 11.01-11.09

SUV (Executive SUV-J Segment)

470 4WD (2UZ-FE)	Gasolina	4WD	4663	196	267	09.05-11.09	■
470 (UZJ120) (2UZ-FE)	Gasolina	4WD	4664	175	238	11.01-11.09	■
470 (UZJ120) (2UZ-FE)	Gasolina	4WD	4664	199	271	11.01-11.09	■

TOYOTA

4RUNNER IV (_N21_) 08.02-12.09

SUV (Executive SUV-J Segment)

4.0 (GRN210) (1GR-FE)	Gasolina	RWD	3956	174	237	09.05-09.09	■
4.0 (GRN215) (1GR-FE)	Gasolina	4WD	3956	174	237	09.05-09.09	■
4.0 EFI 4WD (GRN215) (1GR-FE)	Gasolina	4WD	3956	183	249	01.03-12.09	■
4.7 (UZN210_) (2UZ-FE)	Gasolina	RWD	4663	175	238	08.02-09.06	■
4.7 4WD (UZN215_) (2UZ-FE)	Gasolina	4WD	4663	175	238	08.02-09.06	■
4.7 (UZN210) (2UZ-FE)	Gasolina	RWD	4663	194	264	01.05-12.09	■
4.7 4WD (UZN215) (2UZ-FE)	Gasolina	4WD	4663	194	264	01.05-12.09	■

LAND CRUISER (_J7_ , _JL7_) 03.84-

Closed Off-Road Vehicle (Large SUV-J Segment)

4.5 TD 32V 4x4 (VDJ76, VDJ78, VDJ76R, VDJ78R) (1VD-FTV)	Diesel	4WD	4461	151	205	01.07-	■
---	--------	-----	------	-----	-----	--------	---

LAND CRUISER PRADO (_J12_) 09.02-12.10

Closed Off-Road Vehicle (Large SUV-J Segment)

2.7 (RZJ120, RZJ125) (2TR-FE)	Gasolina	4WD	2694	112	152	09.02-08.04	■
2.7 (RZJ120, RZJ125) (3RZ-FE)	Gasolina	4WD	2694	112	152	09.02-08.04	■
2.7 (TRJ120, TRJ125) (2TR-FE)	Gasolina	4WD	2694	120	163	11.03-02.10	■
3.4 (VZJ121, VZJ125, VZJ120)	Gasolina	4WD	3378	136	185	09.02-07.05	■
4.0 (GRJ120)	Gasolina	4WD	3956	173	235	11.04-06.09	■
4.0 (GRJ120) (1GR-FE)	Gasolina	4WD	3956	179	243	09.02-08.10	■

LISTA DE APLICACIONES - BUYERS GUIDE

4.0 (GRJ120, GRJ125, GRJ121) (1GR-FE)	Gasolina	4WD	3956	183	249	12.02-12.10	■
4.0 (GRJ120) (1GR-FE)	Gasolina	4WD	3956	203	276	08.05-07.09	■
4.0 V6 VVT-i (GRJ125) (1GR-FE)	Gasolina	4WD	3956	207	282	01.03-07.09	■
3.0 D (KZJ120) (1KZ-TE)	Diesel	4WD	2982	92	125	09.02-07.09	■
3.0 D (KZJ120_, KZJ120R)	Diesel	4WD	2982	96	131	08.05-07.09	■
3.0 D (KDJ120, KZJ120) (1KZ-TE)	Diesel	4WD	2982	98	133	02.03-07.09	■
3.0 D-4D (KDJ120, KDJ125, KDJ121) (1KD-FTV)	Diesel	4WD	2982	120	163	09.02-08.09	■
3.0 D-4D (KDJ120, KDJ125, KDJ121) (1KD-FTV)	Diesel	4WD	2982	122	166	07.04-08.09	■
3.0 D-4D (KDJ120, KDJ125, KDJ121) (1KD-FTV)	Diesel	4WD	2982	127	173	09.02-12.10	■
3.0 D-4D (KDJ120_) (1KD-FTV)	Diesel	4WD	2982	150	204	08.06-07.09	■
3.0 D (LJ120, LJ125) (5L-E)	Diesel	4WD	2986	70	95	09.02-02.10	■
TOYOTA (FAW)							
PRADO (_J12_) 01.03-06.10				Closed Off-Road Vehicle (Off-Road SUV-J Segment)			
4.0 A las 4 ruedas (GRJ120, GRJ121, GRJ125) (1GR-FE)	Gasolina	4WD	3956	179	243	10.03-06.10	■