

LISTA DE APLICACIONES - BUYERS GUIDE

78BD3002-2



Weight: 14.410

O.E.M.	MAKE
4721820 AC	CHRYSLER
4721820 AE	CHRYSLER
4721820 AF	CHRYSLER
5073069 AA	CHRYSLER

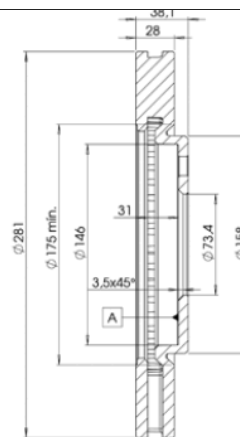
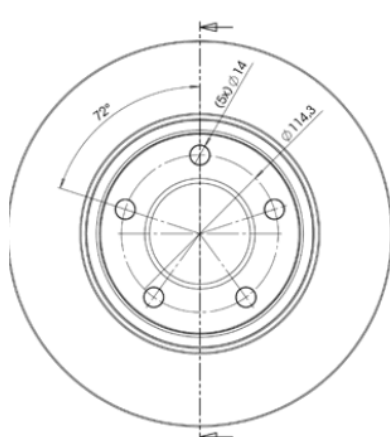

78BD3002-2

E1 90R-02C0074/0807



Ø281x28x38.1

MAKE
CHRYSLER
DODGE



Trac.	CC	Kw	CV
-------	----	----	----



Front / Rear

CHRYSLER

CARAVAN 09.94-12.00

				MPV (Large MPV-M1 Segment)			
2.4	Gasolina	FWD	2429	110	150	01.95-12.00	■
2.4	Gasolina	FWD	2429	111	151	01.95-08.00	■

GRAND VOYAGER III VAN (GS) 01.95-12.01

				Box Body/MPV (Large MPV-M1 Segment)			
2.4	Gasolina	FWD	2429	111	151	01.98-12.01	■
3.3	Gasolina	FWD	3301	116	158	01.95-03.01	■
2.5 TD	Diesel	FWD	2499	85	116	01.95-03.01	■

PROWLER 09.98-12.02

				Convertible (Sports car-S Segment)			
3.5 (EGJ)	Gasolina	RWD	3518	189	257	09.00-12.02	■

RAM VAN (RG) 11.05-07.09

				Box Body/MPV (LCVs-N1 Segment)			
2.8 CRD	Diesel	FWD	2777	110	150	11.05-07.09	■

VOYAGER III / GRAND VOYAGER III (GS_, NS_) 01.92-03.01

				MPV (Large MPV-M1 Segment)			
3.8 (EGH)	Gasolina	FWD	3778	121	165	01.95-09.00	■
3.8 (EGH)	Gasolina	FWD	3778	131	178	10.97-09.00	■
3.8 (EGH)	Gasolina	FWD	3778	134	182	09.97-12.00	■
3.8 AWD	Gasolina	4WD	3778	134	182	09.97-12.00	■

VOYAGER III VAN (GS_) 01.95-12.01

				Box Body/MPV ()			
2.4 (GSHY52)	Gasolina	FWD	2429	111	151	01.95-03.01	■
3.3 (GSHY52)	Gasolina	FWD	3301	116	158	01.95-03.01	■
3.8 AWD (GSHC52)	Gasolina	4WD	3778	122	166	10.95-09.97	■
2.5 TD (GSHY52, GSHZ52)	Diesel	FWD	2499	85	116	01.95-03.01	■

LISTA DE APLICACIONES - BUYERS GUIDE

VOYAGER IV / GRAND VOYAGER IV / TOWN & COUNTRY IV (RG, RS) 09.99-12.08					MPV (Large MPV-M1 Segment)			
2.4 (EDZ)	vehicles with ABS	Gasolina	FWD	2429	108	147	02.00-12.08	■
2.4 (EDZ)		Gasolina	FWD	2429	111	151	04.03-12.07	■
3.0		Gasolina	FWD	2972	112	152	09.99-12.00	■
3.3 (EGA)	vehicles with ABS	Gasolina	FWD	3301	128	174	02.00-12.08	■
3.3 (EGM)	vehicles with ABS	Gasolina	FWD	3301	128	174	02.00-12.08	■
3.3 AWD (EGA)	vehicles with ABS	Gasolina	4WD	3301	128	174	02.00-12.08	■
3.3 (EGM)		Gasolina	FWD	3301	131	178	10.00-09.02	■
3.3		Gasolina	FWD	3301	134	182	09.00-12.07	■
3.8 (EGH)	vehicles with ABS	Gasolina	FWD	3778	160	218	02.00-12.08	■
3.8 AWD (EGH)	vehicles with ABS	Gasolina	4WD	3778	160	218	02.00-12.08	■
3.3 Flex-Fuel	vehicles with ABS	Gasol./Etanol	FWD	3301	128	174	02.00-12.08	■
2.5 CRD (EDK)	vehicles with ABS	Diesel	FWD	2499	88	120	08.05-12.08	■
2.5 CRD (ENJ)	vehicles with ABS	Diesel	FWD	2499	105	141	02.00-12.08	■
2.8 CRD (ENR)	vehicles with ABS	Diesel	FWD	2777	110	150	06.04-12.08	■
VOYAGER IV VAN (S_) 09.99-12.08					Box Body/MPV ()			
3.3 (SYM53, SYH53)		Gasolina	FWD	3301	128	174	10.00-06.07	■
3.8 AWD (SCH53)		Gasolina	4WD	3778	160	218	10.00-06.07	■
VOYAGER / GRAND VOYAGER IV (RG) 02.00-02.08					Box Body/MPV (Large MPV-M1 Segment)			
2.8 CRD		Diesel	FWD	2777	110	150	04.04-02.08	■
DODGE								
CARAVAN III VAN (NS) 01.95-03.01					Box Body/MPV (LCVs-N1 Segment)			
3.8		Gasolina	FWD	3778	122	166	10.95-06.00	■
3.8		Gasolina	FWD	3778	131	178	10.95-06.00	■
CARAVAN IV (RG_) 02.00-12.07					MPV (Large MPV-M1 Segment)			
3.3 (EGA)	04/01-, -09/06	Gasolina	FWD	3301	128	174	02.00-12.07	■
3.3 AWD (EGA)	04/01-, -09/06	Gasolina	4WD	3301	128	174	02.00-12.07	■
3.3 (EGM)		Gasolina	FWD	3301	132	179	04.01-05.07	■
3.8 AWD (EGH)	-09/06	Gasolina	4WD	3778	153	208	04.01-12.07	■
3.8 (EGH)		Gasolina	FWD	3778	154	209	04.01-05.07	■
3.8 AWD		Gasolina	4WD	3778	154	209	04.01-05.07	■
3.8 (EGH)	04/01-, -09/06	Gasolina	FWD	3778	160	218	02.00-12.07	■
3.8 AWD (EGH)	04/01-, -09/06	Gasolina	4WD	3778	160	218	02.00-12.07	■
GRAND CARAVAN IV (U.S.A.) 09.00-12.07					Van (LCVs-N1 Segment)			
3.3 (EGA)		Gasolina	FWD	3301	126	171	09.06-12.07	■