

LISTA DE APLICACIONES - BUYERS GUIDE

78BD3215-2



Weight: 14.836

O.E.M.	MAKE
34 21 6 753 215	BMW
34 21 6 772 085	BMW

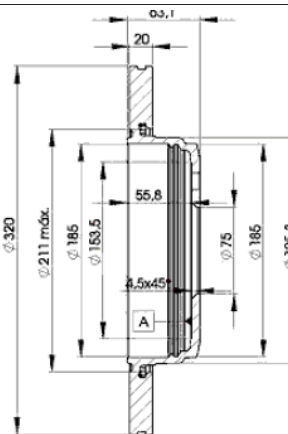
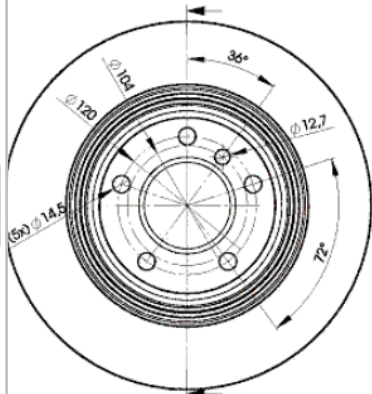

78BD3215-2

E1 90R-02C0587/0100



Ø320x20x61

MAKE
BMW
BMW (BRILLIANCE)
CHEVROLET



Trac.	CC	Kw	CV
-------	----	----	----



Front / Rear

BMW

5 Serie V (E60) 12.01-03.10

Saloon (Executive car-E Segment)

520 i (N46 B20 B)		Gasolina	RWD	1995	115	156	09.07-02.10	■
520 i (N43 B20 A)		Gasolina	RWD	1995	120	163	12.06-03.10	■
520 i (N43 B20 A)		Gasolina	RWD	1995	125	170	09.07-12.09	■
520 i (M54 B22 (226S1))		Gasolina	RWD	2171	125	170	07.03-03.10	■
525 i		Gasolina	RWD	2494	137	186	07.03-12.09	■
525 i (M54 B25 (256S5))		Gasolina	RWD	2494	141	192	09.03-02.05	■
523 i (N52 B25 A)		Gasolina	RWD	2497	130	177	10.04-02.07	■
523 i (N52 B25 B)		Gasolina	RWD	2497	130	177	10.04-02.07	■
523 i (N52 B25 BE)		Gasolina	RWD	2497	130	177	10.04-02.07	■
523 i (N52 B25 A)		Gasolina	RWD	2497	140	190	03.07-12.09	■
523 i (N52 B25 BE)		Gasolina	RWD	2497	140	190	03.07-12.09	■
523 i (N53 B25 A)		Gasolina	RWD	2497	140	190	03.07-12.09	■
525 i (N52 B25 A)		Gasolina	RWD	2497	155	211	07.05-03.10	■
525 i (N52 B25 A)		Gasolina	RWD	2497	160	218	03.05-12.09	■
525 i (N52 B25 B)		Gasolina	RWD	2497	160	218	03.05-12.09	■
525 i (N52 B25 BF)		Gasolina	RWD	2497	160	218	03.05-12.09	■
525 xi (N52 B25 A)		Gasolina	4WD	2497	160	218	04.05-02.07	■
530i (M54 B30 (30653))		Gasolina	RWD	2979	168	228	01.04-12.05	■
530i (M54 B30 (306S3))		Gasolina	RWD	2979	170	231	12.01-02.05	■
525 i (N53 B30 A)	not reinforced brak.	Gasolina	RWD	2996	155	211	01.07-03.10	■
525 i (N53 B30 A)	not government vehic	Gasolina	RWD	2996	160	218	01.07-03.10	■
525 i (N52 B30 A)		Gasolina	RWD	2996	160	218	03.05-03.07	■
525 xi (N53 B30 A)		Gasolina	4WD	2996	160	218	03.07-12.09	■

LISTA DE APLICACIONES - BUYERS GUIDE

528i (N52 B30 A)		Gasolina	RWD	2996	172	234	03.07-12.09	■
530i (N52 B30 A)		Gasolina	RWD	2996	187	254	03.05-03.10	■
530i (N52 B30 A)	not government vehic	Gasolina	RWD	2996	190	258	03.05-03.07	■
530i (N52 B30 BF)	not government vehic	Gasolina	RWD	2996	190	258	03.05-03.07	■
530 xi (N52 B30 A)		Gasolina	4WD	2996	190	258	09.04-02.07	■
530i (N53 B30 A)	not government vehic	Gasolina	RWD	2996	200	272	03.07-12.09	■
530i (N52 B30 A)	not government vehic	Gasolina	RWD	2996	200	272	03.07-12.09	■
530i (N52 B30 BF)	not government vehic	Gasolina	RWD	2996	200	272	03.07-12.09	■
520 d (M47 D20 (204D4))		Diesel	RWD	1995	110	150	09.05-02.07	■
520 d (M47 D20 (204D4))		Diesel	RWD	1995	120	163	09.05-12.09	■
520 d (N47 D20 C)		Diesel	RWD	1995	120	163	09.05-12.09	■
520 d (N47 D20 A)		Diesel	RWD	1995	125	170	09.07-12.09	■
520 d (N47 D20 A)		Diesel	RWD	1995	130	177	09.07-12.09	■
520 d (N47 D20 C)		Diesel	RWD	1995	130	177	09.07-12.09	■
525 d (M57 D25 (256D2))		Diesel	RWD	2497	120	163	12.04-03.10	■
525 d (M57 D25 (256D2))		Diesel	RWD	2497	130	177	06.04-03.10	■
525 d (M57 D30 (306D3))	not government vehic	Diesel	RWD	2993	145	197	01.07-03.10	■
530 d (M57 D30 (306D2))	not government vehic	Diesel	RWD	2993	155	211	09.02-12.09	■
530 d (M57 D30 (306D3))	not government vehic	Diesel	RWD	2993	155	211	09.02-12.09	■
530 d (M57 D30 (306D2))	not government vehic	Diesel	RWD	2993	160	218	09.02-09.05	■
530 d (M57 D30 (306D3))	not government vehic	Diesel	RWD	2993	170	231	09.05-03.07	■
530 xd (M57 D30 (306D3))		Diesel	4WD	2993	170	231	02.05-02.07	■
530 d (M57 D30 (306D3))	not government vehic	Diesel	RWD	2993	173	235	02.07-12.09	■
5 Serie V Touring (E61) 03.04-12.10					Estate (Executive car-E Segment)			
520 i (N43 B20 A)		Gasolina	RWD	1995	120	163	07.07-08.10	■
520 i (N43 B20 A)		Gasolina	RWD	1995	125	170	09.07-12.10	■
525 i (M54 B25 (256S5))		Gasolina	RWD	2494	141	192	06.04-12.10	■
523 i (N52 B25 A)		Gasolina	RWD	2497	130	177	10.04-02.07	■
523 i (N52 B25 B)		Gasolina	RWD	2497	130	177	10.04-02.07	■
523 i (N52 B25 BE)		Gasolina	RWD	2497	130	177	10.04-02.07	■
523 i (N52 B25 A)		Gasolina	RWD	2497	140	190	03.07-01.10	■
523 i (N53 B25 A)		Gasolina	RWD	2497	140	190	01.07-12.10	■
525 i (N52 B25 A)		Gasolina	RWD	2497	155	211	03.05-05.10	■
525 i (N52 B25 A)		Gasolina	RWD	2497	160	218	03.05-05.10	■
525 i (N52 B25 B)		Gasolina	RWD	2497	160	218	03.05-05.10	■
525 i (N52 B25 BF)		Gasolina	RWD	2497	160	218	03.05-05.10	■
525 xi (N52 B25 A)		Gasolina	4WD	2497	160	218	07.05-12.10	■
530i		Gasolina	FWD	2979	170	231	06.04-	■
525 i (N53 B30 A)		Gasolina	RWD	2996	155	211	01.07-12.10	■
525 i (N53 B30 A)	not government vehic	Gasolina	RWD	2996	160	218	01.07-12.10	■
525 xi (N53 B30 A)		Gasolina	4WD	2996	160	218	01.07-12.10	■
530i (N52 B30 A)		Gasolina	RWD	2996	190	258	09.04-02.07	■
530i (N52 B30 BF)		Gasolina	RWD	2996	190	258	09.04-02.07	■
530 xi (N52 B30 A)		Gasolina	4WD	2996	190	258	04.05-02.07	■
530i (N52 B30 A)	not government vehic	Gasolina	RWD	2996	200	272	09.06-03.10	■
530 xi (N52 B30 A)		Gasolina	4WD	2996	200	272	03.07-05.10	■
520 d (M47 D20 (204D4))		Diesel	RWD	1995	110	150	09.05-02.07	■
520 d (M47 D20 (204D4))		Diesel	RWD	1995	120	163	04.05-05.10	■
520 d (N47 D20 C)		Diesel	RWD	1995	120	163	04.05-05.10	■
520 d (N47 D20 A)		Diesel	RWD	1995	130	177	09.07-05.10	■
520 d (N47 D20 C)		Diesel	RWD	1995	130	177	09.07-05.10	■

LISTA DE APLICACIONES - BUYERS GUIDE

525 d (M57 D25 (256D2))		Diesel	RWD	2497	120	163	03.04-03.07	■
525 d (M57 D25 (256D2))		Diesel	RWD	2497	130	177	03.04-03.07	■
525 d (M57 D30 (306D3))	not government vehic	Diesel	RWD	2993	145	197	03.07-05.10	■
530 d (M57 D30 (306D2))	not government vehic	Diesel	RWD	2993	155	211	03.04-05.10	■
530 d (M57 D30 (306D3))	not government vehic	Diesel	RWD	2993	155	211	03.04-05.10	■
530 d (M57 D30 (306D2))	not government vehic	Diesel	RWD	2993	160	218	03.04-09.05	■
530 d (M57 D30 (306D3))	not government vehic	Diesel	RWD	2993	170	231	02.05-02.07	■
530 xd (M57 D30 (306D3))		Diesel	4WD	2993	170	231	02.05-02.07	■
530 d (M57 D30 (306D3))	not government vehic	Diesel	RWD	2993	173	235	02.07-05.10	■
6 Serie II (E64) 03.04-12.10					Convertible (Grand Tourer-S Segment)			
630 i (N52 B30 A)		Gasolina	RWD	2996	190	258	09.04-08.07	■
630 i (N52 B30 B)		Gasolina	RWD	2996	190	258	09.04-08.07	■
630 i (N52 B30 BF)		Gasolina	RWD	2996	190	258	09.04-08.07	■
630 i (N53 B30 A)		Gasolina	RWD	2996	200	272	09.07-08.10	■
630 i (N52 B30 A)		Gasolina	RWD	2996	200	272	09.07-08.10	■
630 i (N52 B30 B)		Gasolina	RWD	2996	200	272	09.07-08.10	■
630 i (N52 B30 BF)		Gasolina	RWD	2996	200	272	09.07-08.10	■
6 Serie II (E63) 09.03-12.10					Coupe (Grand Tourer-S Segment)			
630 i (N52 B30 A)		Gasolina	RWD	2996	190	258	09.04-08.07	■
630 i (N52 B30 BF)		Gasolina	RWD	2996	190	258	09.04-08.07	■
630 i (N52 B30 A)		Gasolina	RWD	2996	200	272	09.07-08.10	■
630 i (N52 B30 B)		Gasolina	RWD	2996	200	272	09.07-08.10	■
630 i (N52 B30 BF)		Gasolina	RWD	2996	200	272	09.07-08.10	■
BMW (BRILLIANCE)								
5 SERIES V (E60) 07.03-12.10					Saloon (Executive car-E Segment)			
2.0 520Li		Gasolina	FWD	1995	115	156	06.09-	■
520 i		Gasolina	RWD	2171	127	173	05.04-12.06	■
2.5 523i		Gasolina	FWD	2494	130	175	07.03-	■
2.5 523Li		Gasolina	FWD	2494	130	175	07.03-	■
525 i		Gasolina	RWD	2494	141	192	04.04-02.06	■
2.5 523Li		Gasolina	FWD	2497	120	163	01.08-	■
2.5 525Li		Gasolina	FWD	2497	160	218	01.07-	■
525 i		Gasolina	RWD	2497	160	218	01.05-01.06	■
530i		Gasolina	RWD	2979	170	231	10.03-06.05	■
3.0 530 Li		Gasolina	FWD	2996	190	258	01.08-	■
530i (N52 B30 BF)		Gasolina	RWD	2996	190	258	01.05-12.06	■
CHEVROLET								
OPALA 06.81-12.92					Saloon (Executive car-E Segment)			
2.5		Gasolina	FWD	2474	59	80	06.81-12.92	■