

LISTA DE APLICACIONES - BUYERS GUIDE

78BD3260-2

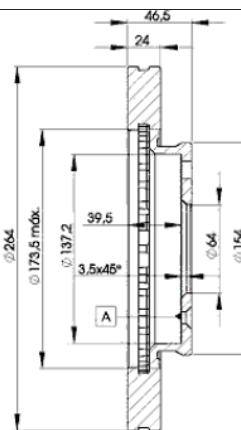

Weight: 10.730

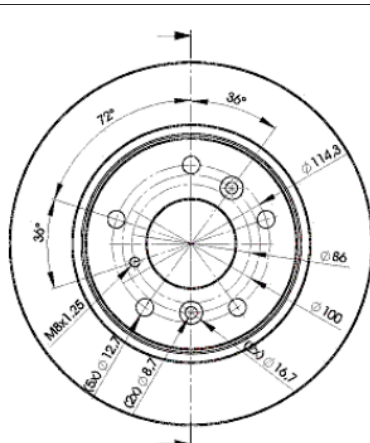

78BD3260-2

E1 90R-02C0074/0046



Ø264x24x46.5

MAKE

CHERY

FORD USA

MAZDA



Trac.	CC	Kw	CV
-------	----	----	----



Front / Rear

CHERY

TIGGO / J11 03.02-07.17

SUV (Compact SUV-J Segment)

1.6 (SQR481F)		Gasolina	FWD	1597	80	109	07.06-12.10	■
1.6 (SQR481F)		Gasolina	FWD	1597	88	120	09.10-12.14	■
S 1.6 (SQR481FG)		Gasolina	FWD	1597	110	150	09.10-12.13	■
1.6 (SQRE4G16)		Gasolina	FWD	1598	93	126	06.11-12.14	■
1.8 (SQR481FC)		Gasolina	FWD	1845	97	132	04.10-12.14	■
2.0 (SQR484F)		Gasolina	FWD	1971	95	129	09.06-12.08	■
2.0 (SQR484F)		Gasolina	FWD	1971	102	139	09.06-12.09	■
2.0 Alas 4 ruedas (SQR484F)		Gasolina	4WD	1971	102	139	09.10-12.14	■
2.0 (4G63-S4M)		Gasolina	FWD	1997	92	125	03.05-12.08	■
2.4 (4G64-S4M)		Gasolina	FWD	2350	95	129	03.05-12.08	■
2.4 A las 4 ruedas (4G64-S4M)		Gasolina	4WD	2350	95	129	11.05-12.08	■

FORD USA

PROBE (U.S.A.) 08.88-07.93

Coupe (Sports car-S Segment)

2.2		Gasolina	FWD	2184	82	112	08.88-07.93	■
2.2 GT		Gasolina	FWD	2184	108	147	08.88-12.92	■
3.0 V6		Gasolina	FWD	2979	104	141	08.88-07.93	■

MAZDA

626 III / CAPELLA / TELSTAR (GC) 11.82-10.87

Hatchback (Executive car-E Segment)

2.0 (GC10E1) (FE (8V))	08/87-	Gasolina	FWD	1998	74	101	03.83-09.87	■
------------------------	--------	----------	-----	------	----	-----	-------------	---

626 III / CAPELLA / TELSTAR (GC) 11.82-01.90

Saloon (Executive car-E Segment)

2.0 (GC10E1) (FE (8V))	08/87-	Gasolina	FWD	1998	74	101	03.83-09.87	■
------------------------	--------	----------	-----	------	----	-----	-------------	---

LISTA DE APLICACIONES - BUYERS GUIDE

626 IV / CAPELLA (GD) 06.87-05.92					Coupe (Executive car-E Segment)			
2.0 (GDEP) (FE (8V))		Gasolina	FWD	1998	66	90	09.87-10.90	■
2.0 12V (GDEP) (FE (12V))		Gasolina	FWD	1998	79	107	09.87-12.88	■
2.0 16V (GDEP) (FE (16V))		Gasolina	FWD	1998	103	140	12.87-10.90	■
2.0 16V (GDEP) (FE (16V))		Gasolina	FWD	1998	109	148	06.87-09.89	■
2.2 12V (GD102) (F2)		Gasolina	FWD	2184	85	115	04.88-12.91	■
626 IV / CAPELLA (GD) 06.87-05.92					Saloon (Executive car-E Segment)			
2.0 (GDEP) (FE (12V))		Gasolina	FWD	1998	66	90	09.87-10.90	■
2.0 (FE (12V))		Gasolina	FWD	1998	74	101	08.87-07.89	■
2.0 12V (GDEP) (FE (12V))		Gasolina	FWD	1998	79	107	09.87-05.92	■
2.0 16V (GDEP) (FE (16V))		Gasolina	FWD	1998	103	140	11.87-05.92	■
2.0 16V (GDEP) (FE (16V))		Gasolina	FWD	1998	109	148	07.87-09.89	■
2.2 12V (GD102) (F2)		Gasolina	FWD	2184	85	115	11.87-07.91	■
2.2 12V 4WD (GD102) (F2)		Gasolina	4WD	2184	85	115	01.90-05.92	■
626 IV / CAPELLA / TELSTAR (GD) 06.87-05.92					Hatchback (Executive car-E Segment)			
2.0 (GDEP) (FE (8V))		Gasolina	FWD	1998	66	90	09.87-10.90	■
2.0 12V (GDEP) (FE (12V))		Gasolina	FWD	1998	79	107	11.87-05.92	■
2.0 16V (GDEP) (FE (16V))		Gasolina	FWD	1998	103	140	11.87-10.90	■
2.0 16V (GDEP) (FE (16V))		Gasolina	FWD	1998	109	148	06.87-08.89	■
2.0 4x4 (FEFL)		Gasolina	4WD	1998	110	150	08.89-07.91	■
2.2 12V (GD102) (F2)		Gasolina	FWD	2184	85	115	06.88-04.92	■
2.2 12V 4WD (F2)		Gasolina	4WD	2184	85	115	11.87-07.90	■
626 IV / CAPELLA Station Wagon (GV) 09.87-10.98					Estate (Executive car-E Segment)			
1.8 (GV8W) (F8 (12V))		Gasolina	FWD	1789	65	88	01.88-03.92	■
1.8 (GV8W)		Gasolina	FWD	1789	66	90	10.89-03.92	■
2.0 GLX (FS)		Gasolina	FWD	1991	86	117	04.92-02.95	■
2.0 (GVEW) (FE (8V))		Gasolina	FWD	1998	66	90	10.88-09.97	■
2.0 12V (FE (12V))		Gasolina	FWD	1998	79	107	09.87-12.92	■
2.0 12V (GVEW) (FE (12V))		Gasolina	FWD	1998	81	110	09.87-01.90	■
2.0 16V (GVEW) (FE (16V))		Gasolina	FWD	1998	103	140	01.88-03.92	■
2.0 i 16V (GVEW) (FECM)		Gasolina	FWD	1998	110	150	10.88-09.97	■
2.2 12V (GV102) (F2)		Gasolina	FWD	2184	85	115	03.89-11.96	■
2.2 12V 4WD (GV102) (F2)		Gasolina	4WD	2184	85	116	05.91-11.92	■
2.2 12V 4WD (GV102) (F2L1)		Gasolina	4WD	2184	85	116	05.91-11.92	■
2.0 D (GVFW) (RF-N)		Diesel	FWD	1998	44	60	09.88-07.91	■